

165

SOUTH PRICE RD

CHANDLER, AZ 85224

**Vacant Industrial
Building For Sale**
±97,000 SF
on 16.72 Acres



**CUSHMAN &
WAKEFIELD**

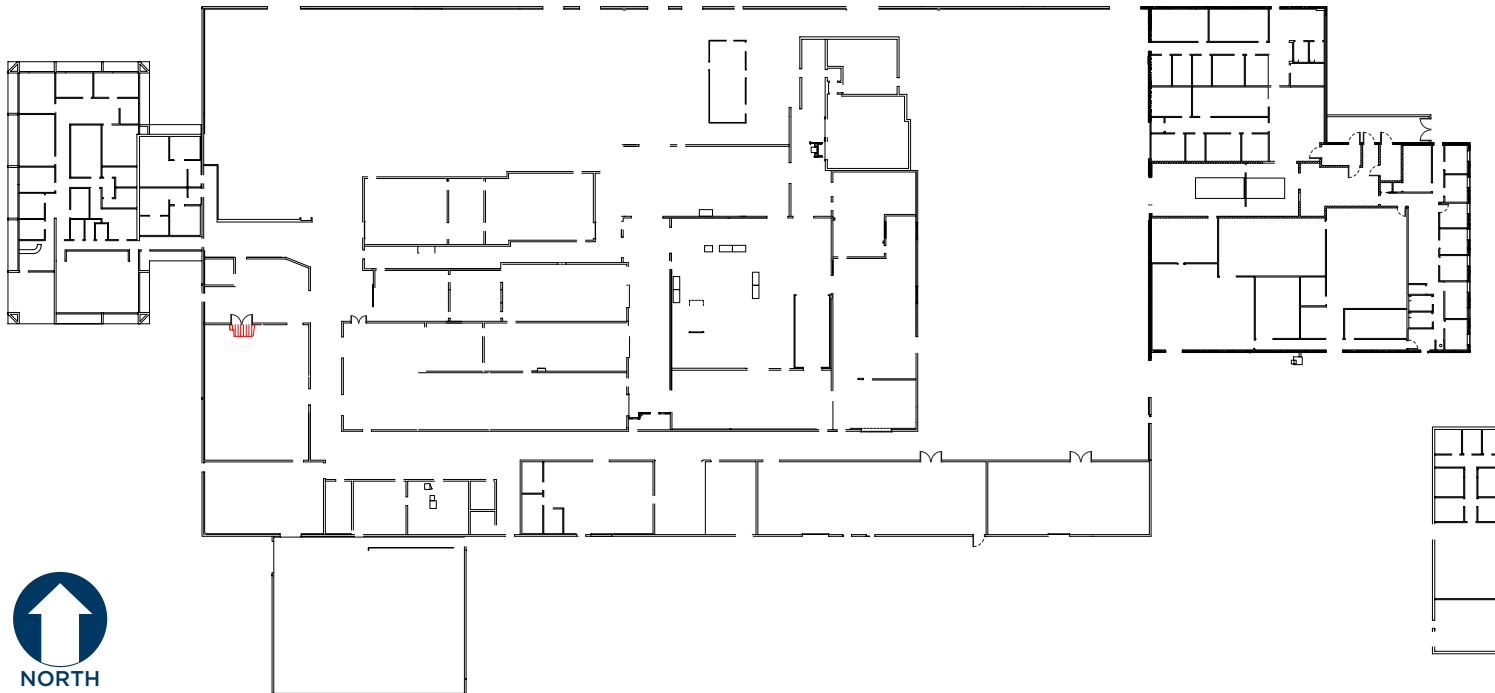

// BUILDING SPECS

BUILDING SIZE

97,000 SF

OFFICE AREA

12,446 SF

CLEAR HEIGHT

20'

LOADING

DOCKS 4
TRUCKWELLS 1
REMOTE

DRIVE-IN DOORS

7

PARKING

100 SPACES
(EXPANDABLE)

SITE SIZE

16.72 ACRES

YEAR BUILT

1982/2021

ELECTRICAL SERVICE

8400 AMPS; 277/480 V
(EXPANDABLE)

ROOF

METAL (INSULATED EPDM)

FLOOR

6" REINFORCED CONCRETE

ZONING

I-1, CITY OF CHANDLER

COOLING

100% HVAC

CLEAN ROOM

CLASS 10,000

SPRINKLERS

100% WET

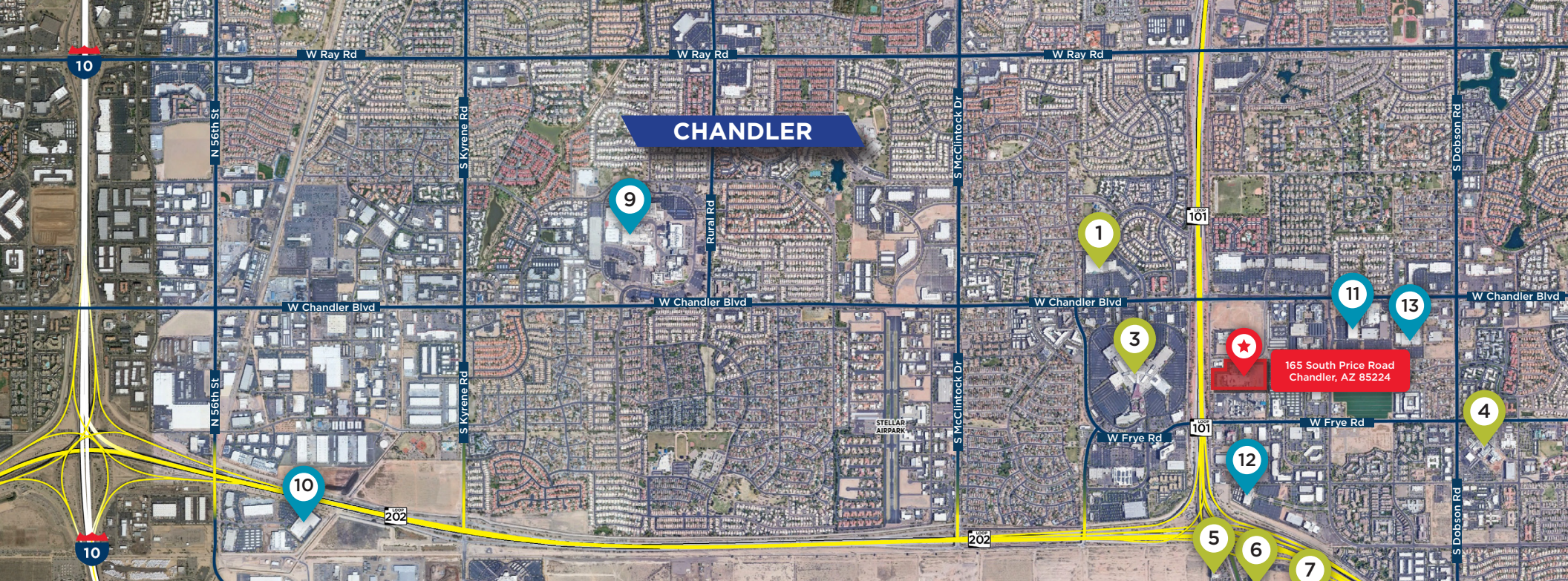

CHANDLER

165 South Price Road
Chandler, AZ 85224

DISTANCES

Loop 101	.25 Miles	I-10	5 Miles
Loop 202	.75 Miles	US 60	6 Miles

// AMENITIES & CORPORATE NEIGHBORS

- 1 **Chandler Gateway**
- 2 **Chandler Festival**
- 3 **CHANDLER FASHION CENTER**
- 4 **Chandler Regional Medical Center**
A Dignity Health Member
- 5 **COURTYARD**
BY MARRIOTT
- 6 **DRURY HOTELS**
- 7 **Hampton Inn & Suites**
by HILTON
- 8 **NORTHROP GRUMMAN**
- 9 **intel.**
- 10 **AVNET**
Reach Further™
- 11 **MICROCHIP**
- 12 **gm**
- 13 **ROGERS CORPORATION**

165
SOUTH PRICE RD

CHANDLER, AZ 85224



CONTACT INFO:

JOSHUA WYSS, SIOR

Executive Director
+ 1 602 224 4407

joshua.wyss@cushwake.com

STEVE MARDIAN

Director
+ 1 602 224 4460

steve.mardian@cushwake.com

CHRISTIAN CORAGGIO

Senior Associate
+1 602 224 4463

christian.coraggio@cushwake.com



2555 East Camelback Rd., Suite 400
Phoenix, AZ 85016
ph: +1 602 954 9000
fx: +1 602 253 0528
cushmanwakefield.com

©2024 Cushman & Wakefield. All rights reserved. The information contained in this communication is strictly confidential. This information has been obtained from sources believed to be reliable but has not been verified. NO WARRANTY OR REPRESENTATION, EXPRESS OR IMPLIED, IS MADE AS TO THE CONDITION OF THE PROPERTY (OR PROPERTIES) REFERENCED HEREIN OR AS TO THE ACCURACY OR COMPLETENESS OF THE INFORMATION CONTAINED HEREIN, AND SAME IS SUBMITTED SUBJECT TO ERRORS, OMISSIONS, CHANGE OF PRICE, RENTAL OR OTHER CONDITIONS, WITHDRAWAL WITHOUT NOTICE, AND TO ANY SPECIAL LISTING CONDITIONS IMPOSED BY THE PROPERTY OWNER(S). ANY PROJECTIONS, OPINIONS OR ESTIMATES ARE SUBJECT TO UNCERTAINTY AND DO NOT SIGNIFY CURRENT OR FUTURE PROPERTY PERFORMANCE.