



**DISTANCE TO**

<b>3</b> 1.3 Miles	<b>17</b> 1.4 Miles	<b>95</b> 2.6 Miles	<b>46</b> 4.2 Miles	<b>80</b> 4.8 Miles	<b>Lincoln Tunnel</b> 5.5 Miles	<b>GWB</b> 8.5 Miles
-----------------------	------------------------	------------------------	------------------------	------------------------	------------------------------------	-------------------------

## PROPERTY FEATURES

- Building Available: 29,500 SF
- Lot Size: 1.27 Acres
- Office Space:
  - Ground Floor - 3,632 SF
  - 2nd Floor - 3,071 SF
- Ceiling Height: 22'
- Loading:
  - Two (2) Loading Docks 10'x10' with E.O.D. Levelers
  - One (1) Drive-in 12'x12'
- Column Spacing: 32'6" x 25'
- Parking: 40 Spaces
- Wet Sprinklers
- Power: 400 Amps, 208/120 volt 3 phase
- Taxes: \$2.87 PSF
- Lease Rate: \$16.50 PSF Net
- Available: Immediately

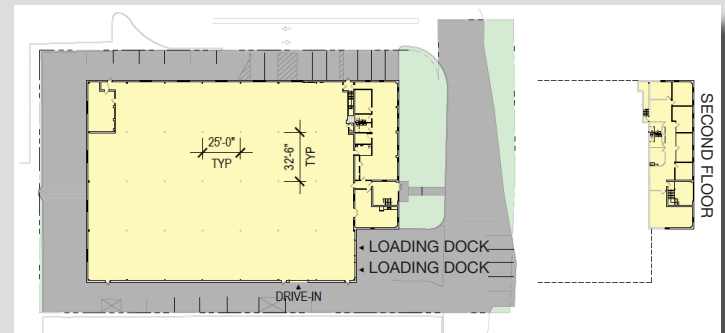

## FOR MORE INFORMATION:

**Jeffrey W. DeMagistris, SIOR**  
Senior Vice President

201 488 5800 x147 • [jdemagistris@naihanson.com](mailto:jdemagistris@naihanson.com)

**Thomas A. Vetter, SIOR**  
Senior Vice President



201 488 5800 x105 • [tvetter@naihanson.com](mailto:tvetter@naihanson.com)

**Giovanni Ramaci**  
Associate

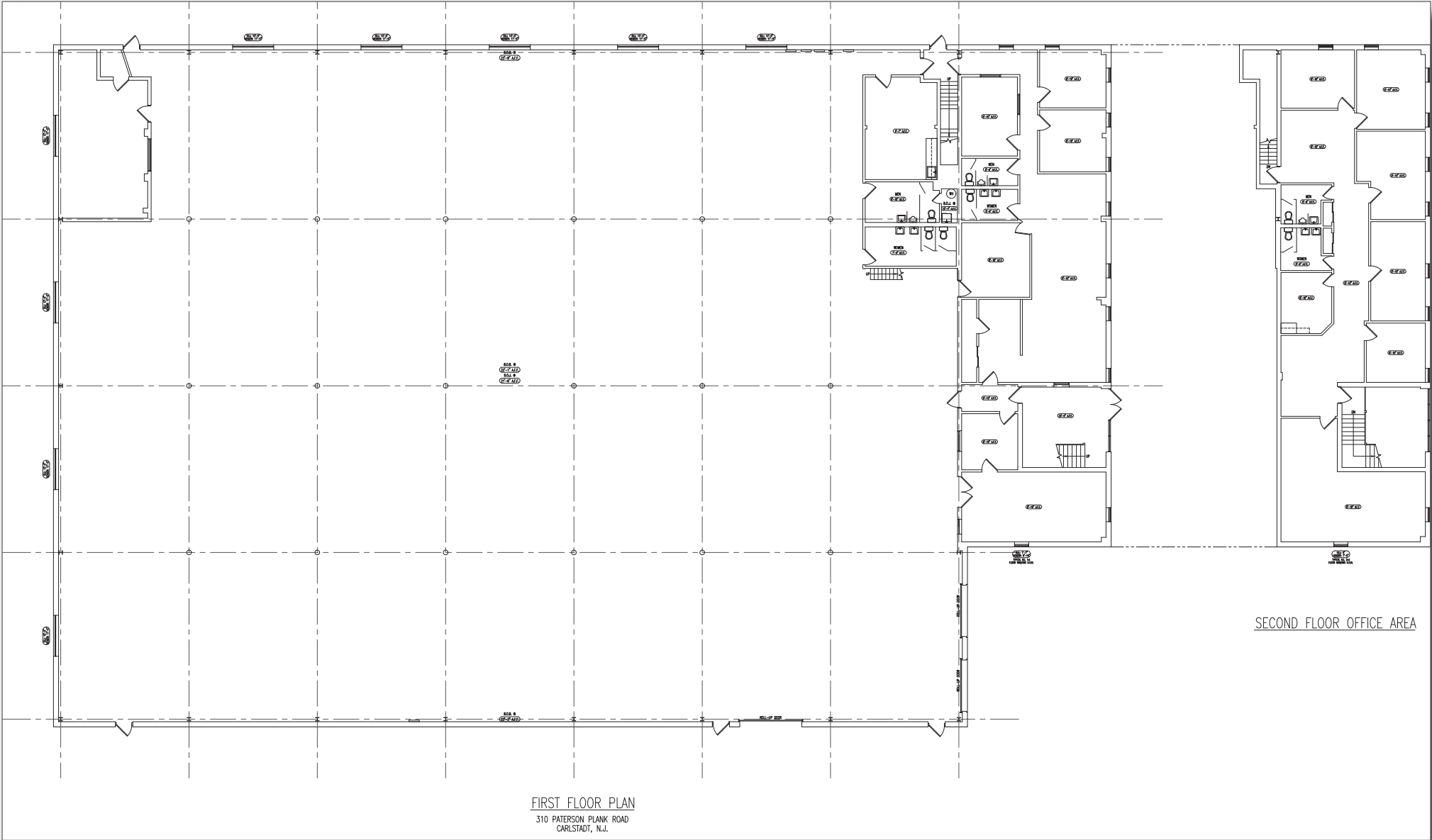
201 488 5800 x131 • [gramaci@naihanson.com](mailto:gramaci@naihanson.com)



SECOND FLOOR OFFICE AREA

FOLLOW US!      | NJ Offices: Teterboro | Parsippany | [naihanson.com](http://naihanson.com) | Member of NAI Global with +325 Offices Worldwide

SERVICES OFFERED

Brokerage • Property Management • Corporate Services • Financing • Logistics • Government Services • Healthcare • Tenant Representation • Cold Storage • Investment Services

The information contained herein has been obtained from sources considered to be reliable, but no guarantee of its accuracy is made by NAI James E. Hanson