

FOR LEASE

# Whiteland 65 Logistics Center

I-65 & Whiteland Road  
Whiteland, Indiana 46184

Two Future Speculative  
Facilities or Build-to-Suit

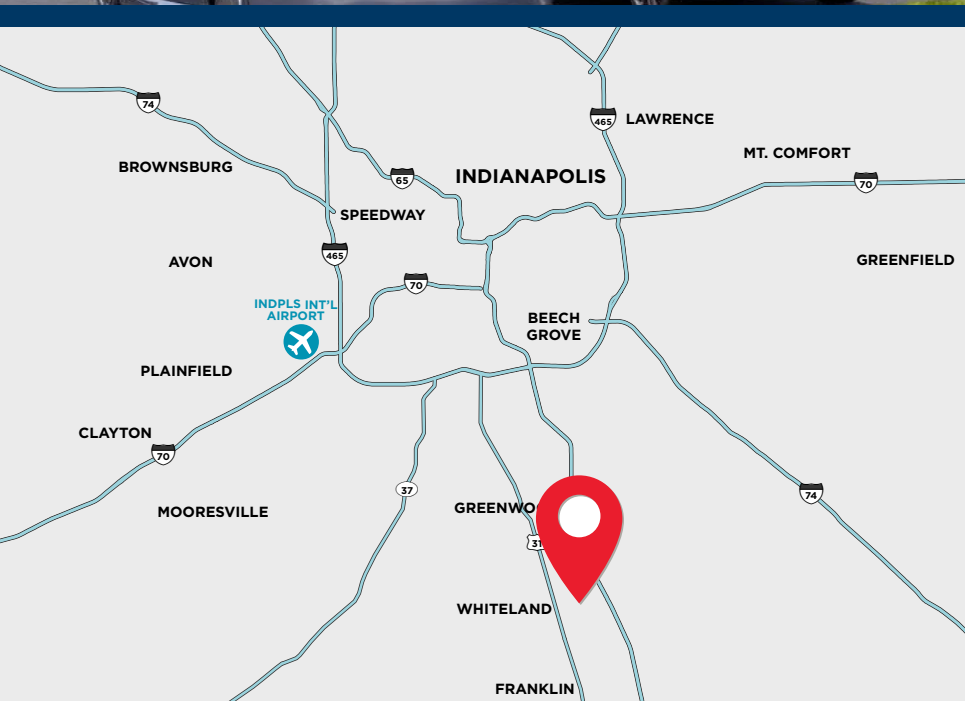

CUSTOMIZABLE  
**229,500-652,395 SF**  
OPPORTUNITY



CUSHMAN &  
WAKEFIELD

Hines



# BUILDING A SPECIFICATIONS

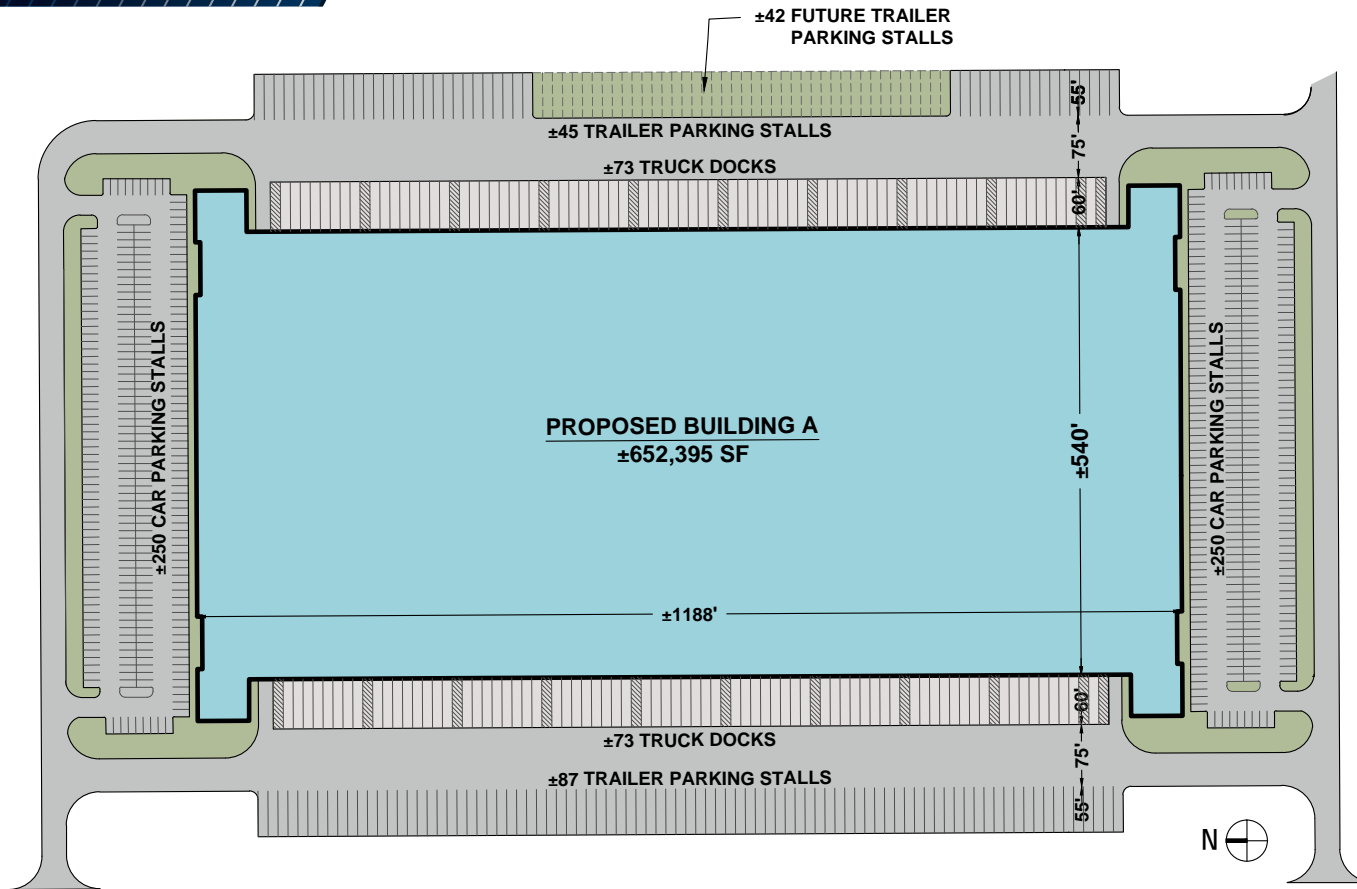

**BUILDING SIZE**  
652,395 SF



**DOCK DOORS**  
146 (9'X10')  
CROSS-DOCK



**AUTO PARKING**  
500 AUTO SPACES



**CEILING HEIGHT**  
40' CLEAR



**DRIVE-IN DOORS**  
4 (12'X14') W/ RAMPS



**TRAILER PARKING**  
132 TRAILER SPACES  
EXPANDABLE TO 174



**COLUMN SPACING**  
52' X 56'  
60' SPEED BAY

# BUILDING B SPECIFICATIONS

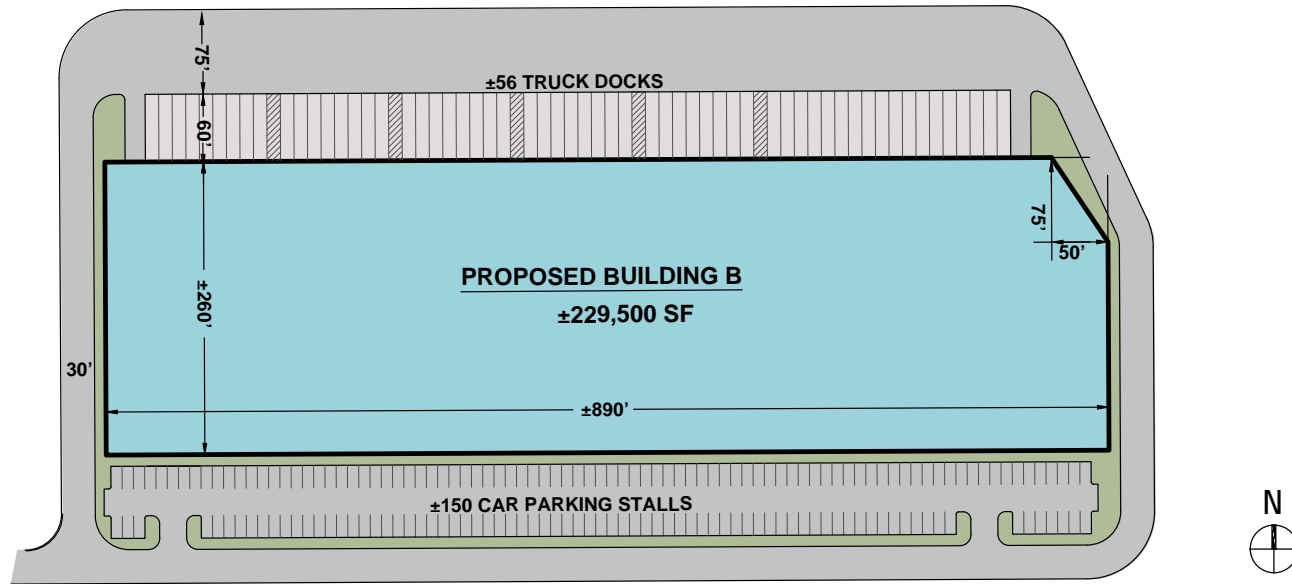

**BUILDING SIZE**  
229,500 SF



**COLUMN SPACING**  
54' X 50'  
60' SPEED BAY



**DRIVE-IN DOORS**  
2 (12'X14') W/ RAMPS



**CEILING HEIGHT**  
32' CLEAR



**DOCK DOORS**  
56 (9'X10')  
REAR-LOAD



**AUTO PARKING**  
150 AUTO SPACES



# PROPERTY LOCATION



BUILDING A  
652,395 SF

BUILDING B  
229,500 SF

INTERSTATE  
FRONTAGE



IMMEDIATE  
INTERSTATE  
ACCESS



WHITELAND ROAD



NFI Industries



**DISTANCES**

	I-465	12 mi
	Indianapolis Int'l Airport	20 mi



## CORPORATE NEIGHBORS SELECT JOHNSON COUNTY BUSINESSES





# LOCATION, LOCATION, LOCATION

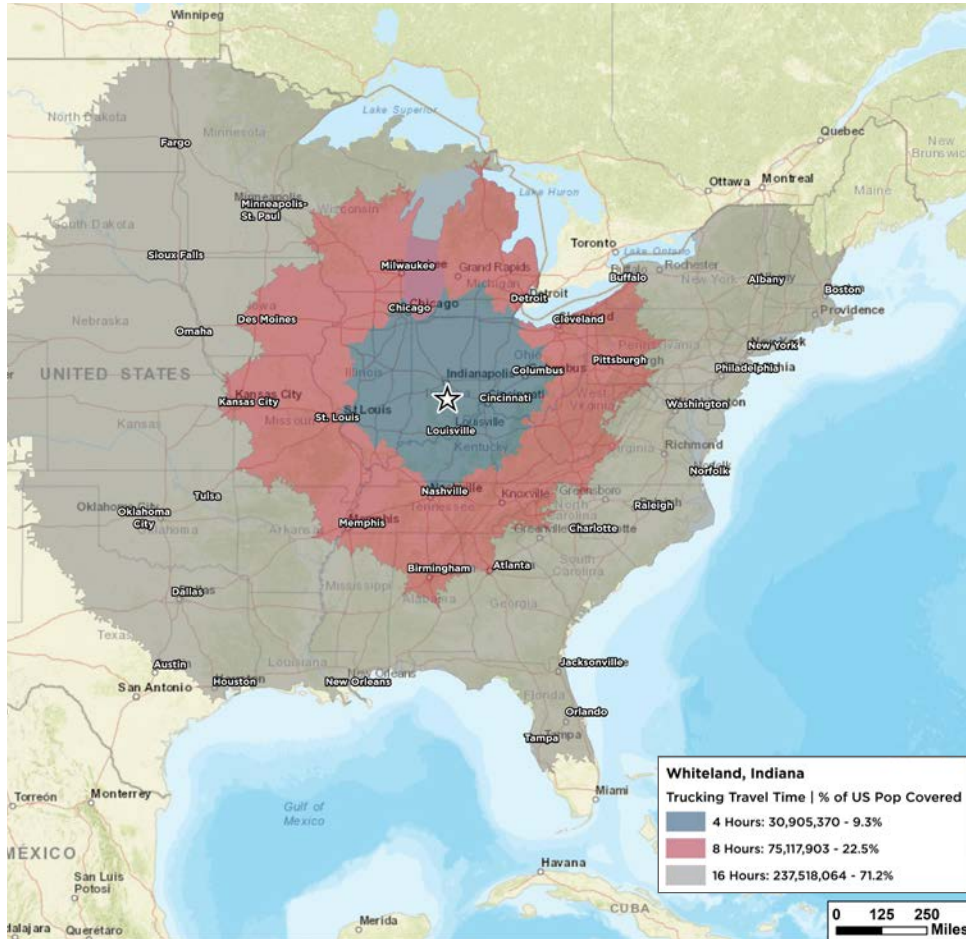

## WHITELAND / JOHNSON COUNTY, INDIANA

- Johnson County and the State of Indiana offer a nationally recognized pro-business climate. Between 2006 and 2018, **more than 60 companies have relocated to Johnson County** while an additional 57 companies chose to remain in the county and expand their business.
- Johnson county companies draw from an estimated **workforce of over 1.4 million people** within a 60-mile radius.
- The county is well connected with Indianapolis via **Interstate I-65 and U.S. 31**. From there, more interstate highways converge in Indianapolis than any other city in the United States.
- Indiana has been named in the **Top 5 U.S. States To Do Business** (*Chief Executive, 2021*)

Source: Johnson County Development Corporation ([www.aspirejohnsoncounty.com](http://www.aspirejohnsoncounty.com))

**Michael W.M. Weishaar, SIOR**  
Cushman & Wakefield  
Vice Chair  
+1 317 639 0494  
[michael.weishaar@cushwake.com](mailto:michael.weishaar@cushwake.com)

**William P. Renner**  
Hines  
Managing Director  
+1 312 419 4703  
[will.renner@hines.com](mailto:will.renner@hines.com)

