

# 851 Napa Valley Corporate Way, Napa

## Suite A ~ ±4,900 SF ~ \$1.35/SF/Mo. NNN



- High Ceilings
- 5 Private Offices
- Open Space for Cubicles
- Conference Room
- Single-Story Office
- Very Generous Full-Height Windows
- Separately Metered
- Walking Distance to Dining Options
- Located in the City of Napa
- Bus Stop Nearby

**Procuring Broker  
Fee 5%\***

**A lease of five years or more will be granted a concession of three months free Base Rent if the lease is signed by the end of 2025.**

**NOTE:** Other office suites available from ±3,303 SF - ±23,121 SF. Divisions will affect the price, but will be reasonably negotiated.

Virtual Tour: <https://www.youtube.com/watch?v=LPh30-BTnMQ>

\*For up to 5 Years, then 1.5% for any extended term.



**Michael Moffett**

License #00946472

707.479.1976

[mmoffett@cnapavalley.com](mailto:mmoffett@cnapavalley.com)

1775 Lincoln Ave.

Napa, CA 94558

**Cathy Holmes**

License #01355085

707.304.3338

[cholmes@cnapavalley.com](mailto:cholmes@cnapavalley.com)

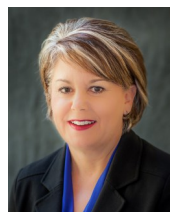

# 851 Napa Valley Corporate Way, Napa

## Suite A ~ ±4,900 SF ~ \$1.35/SF/Mo. NNN



**Michael Moffett**

License #00946472

707.479.1976

[mmoffett@cnapavalley.com](mailto:mmoffett@cnapavalley.com)

1775 Lincoln Ave.

Napa, CA 94558

**Cathy Holmes**

License #01355085

707.304.3338

[cholmes@cnapavalley.com](mailto:cholmes@cnapavalley.com)

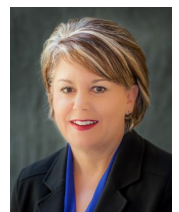



**COLDWELL BANKER  
COMMERCIAL**  
BROKERS  
OF THE VALLEY

# 851 Napa Valley Corporate Way, Napa

## Suite A ~ ±4,900 SF ~ \$1.35/SF/Mo. NNN

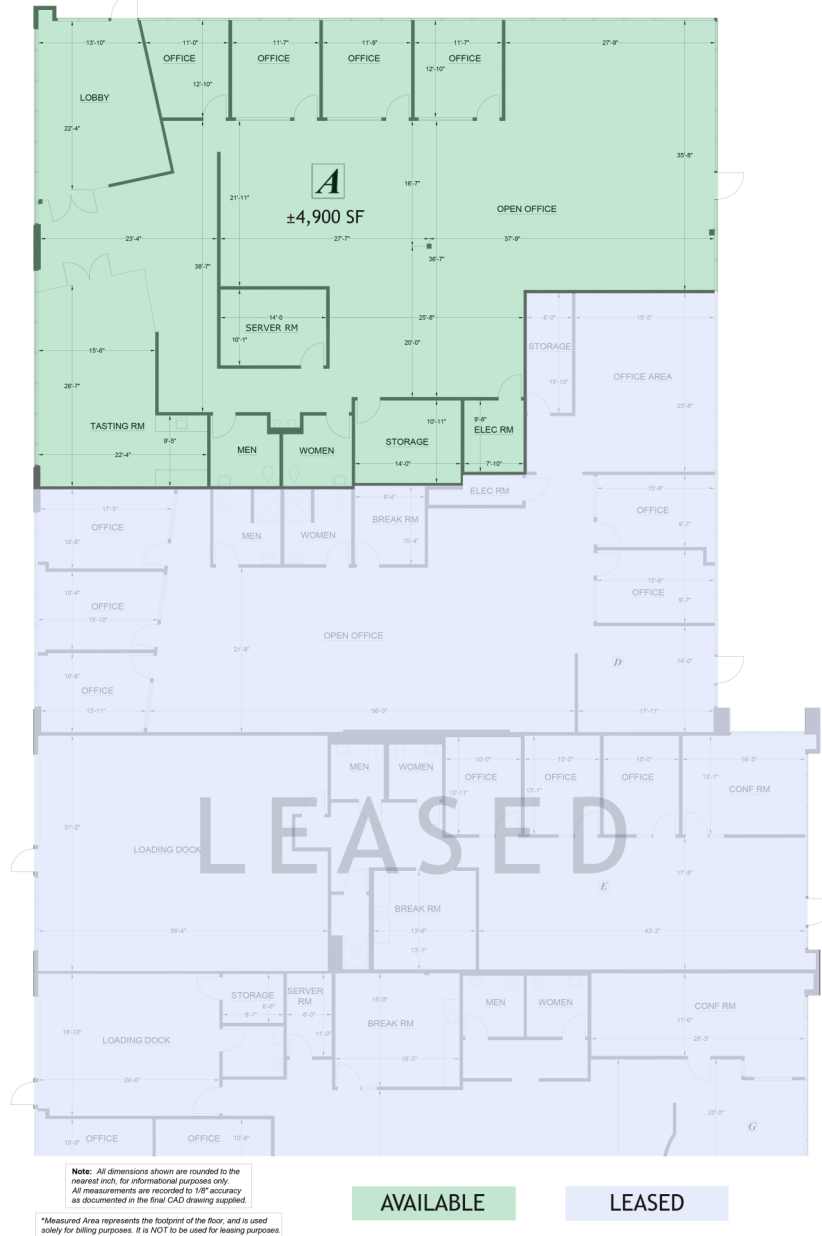

**Michael Moffett**  
License #00946472  
707.479.1976  
mmoffett@cbnapavalley.com

1775 Lincoln Ave.  
Napa, CA 94558

**Cathy Holmes**

License #01355085  
707.304.3338  
cholmes@cbnapavalley.com

