

# EMPIRE ROAD - SUITE F & G

1812 South Empire Road, Salt Lake City, Utah 84104

158,083 SF

AVAILABLE



# FOR LEASE

## PROPERTY HIGHLIGHTS

- Building Square Feet: 470,586
- Dock High Doors: 23
- Grade Level: 2
- Clear Height Suite F: 24'
- Clear Height Suite G: 25'
- Column Spacing Suite F: 30' x 30'
- Column Spacing Suite G: 48' x 55'
- Floor: 6" Thick, Reinforced, 4,000 PSI
- Electrical: 600 AMP, 480/277 v. 3 phase
- Lighting: T-5
- Heating: Gas Unit Heaters
- Fire Protection: Wet System
- Roofing: EPDM
- Office: Approx. 1,000 SF
- Space is divisible
- Lease Rate: Negotiable

## FOR MORE INFORMATION CONTACT:

**Taylor R. Thomas**

O 801.977.6329

C 801.949.8302

tthomas@freeportwest.com



1505 South Redwood Rd,  
Salt Lake City, UT 84104

# EMPIRE ROAD - SUITE F & G

1812 South Empire Road, Salt Lake City, Utah 84104

158,083 SF

AVAILABLE

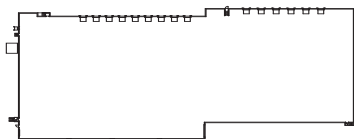
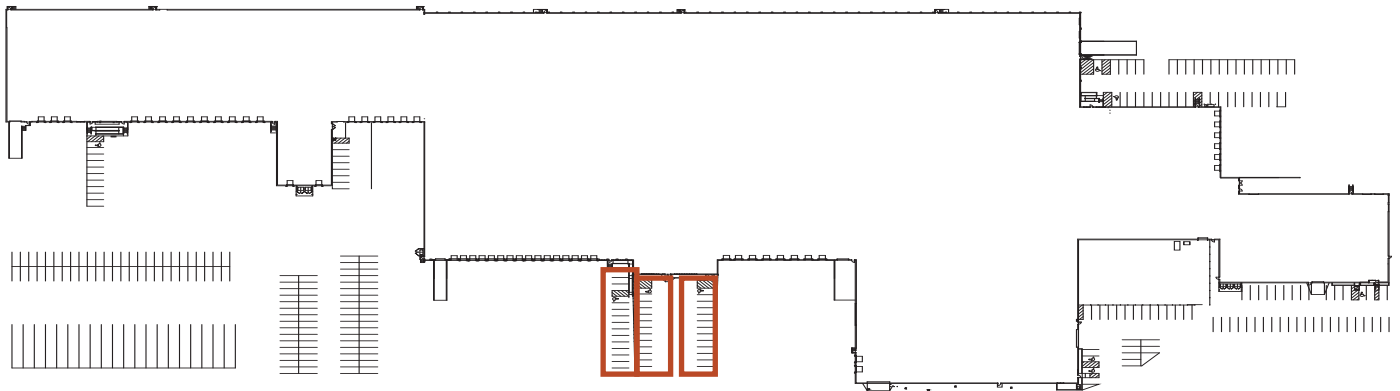
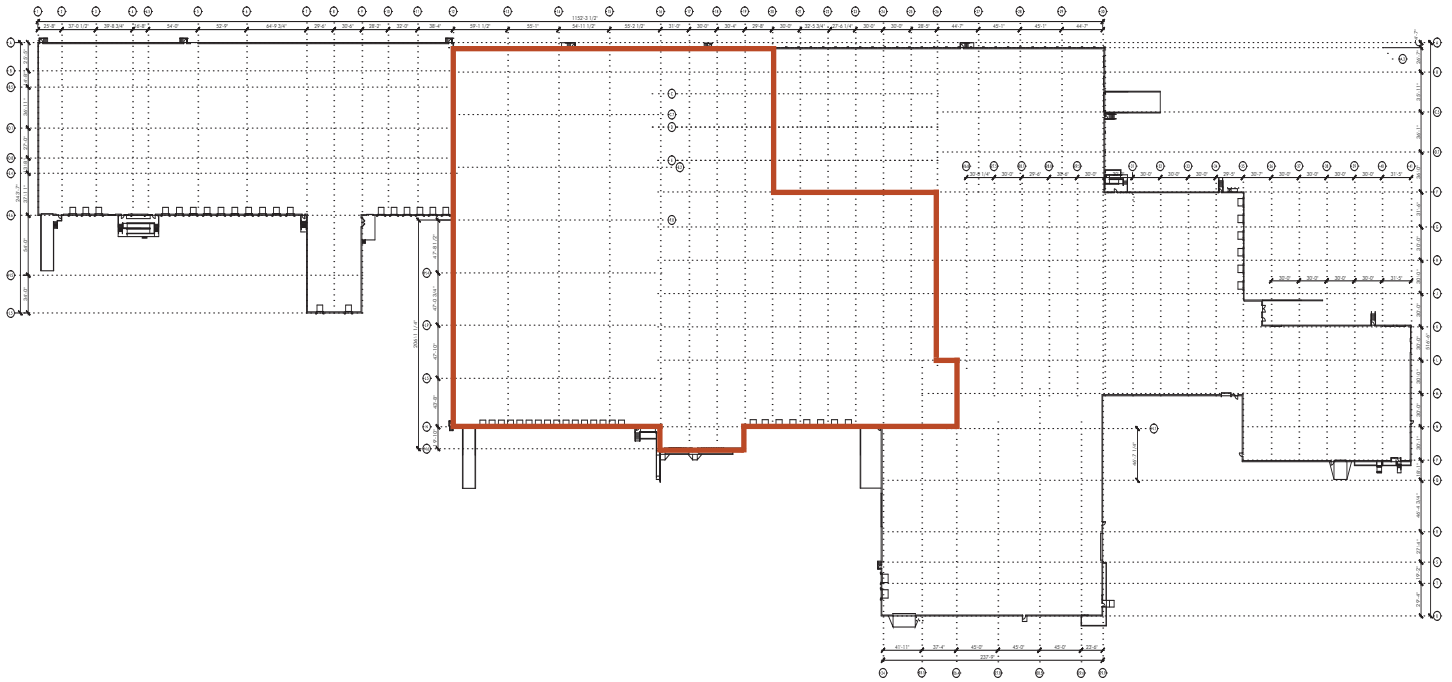

# EMPIRE ROAD - SUITE F & G

1812 South Empire Road, Salt Lake City, Utah 84104

158,083 SF

AVAILABLE

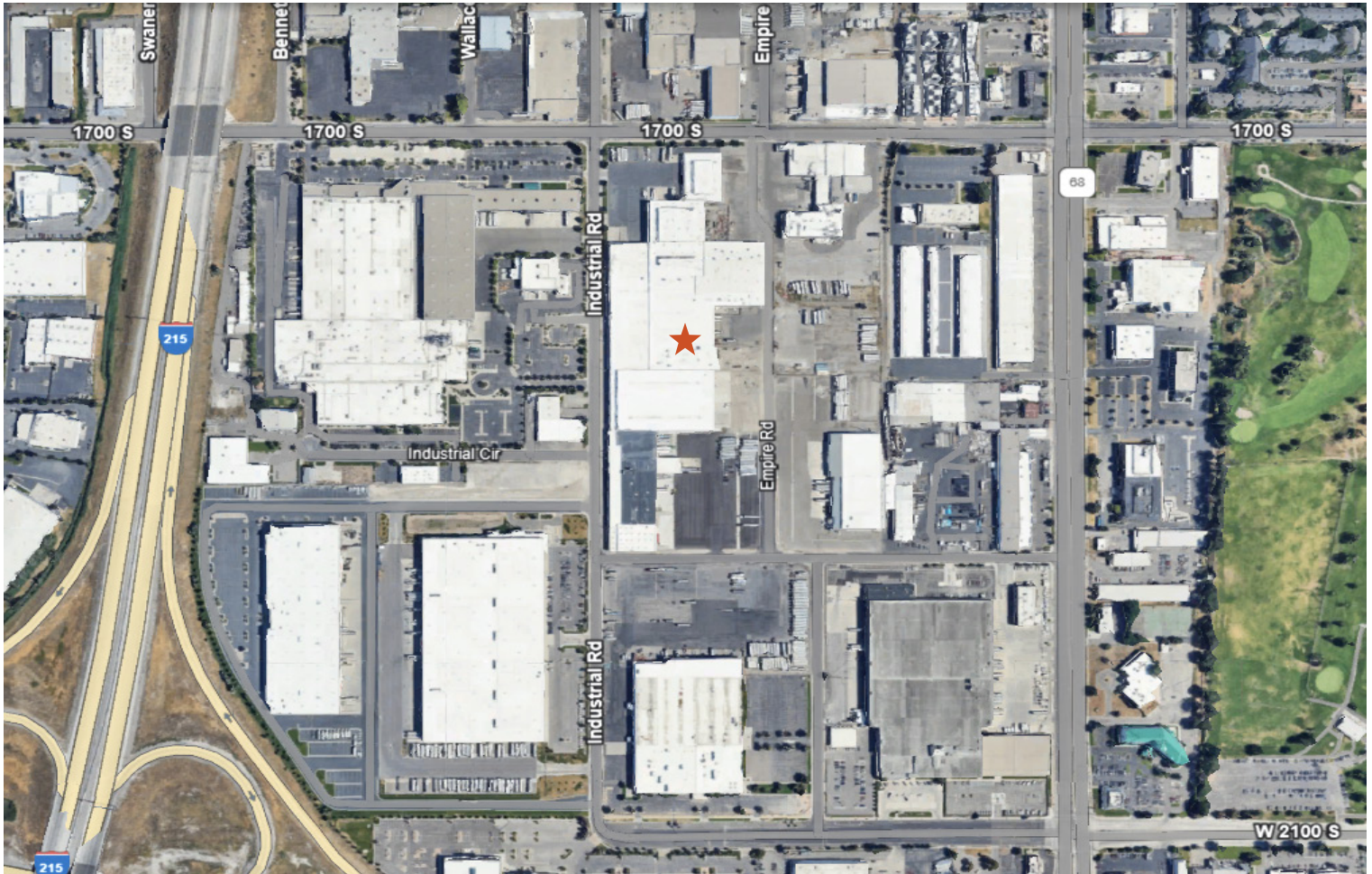

- Located near the Redwood Road and SR-201
- Minutes from I-15, I-80, I-215, and Bangerter Highway
- Five miles from Salt Lake International Airport