

VICINITY SKETCH  
NOT TO SCALE

DESCRIPTION

PART OF THE NORTHEAST QUARTER OF THE NORTHEAST QUARTER OF SECTION 1, TOWNSHIP 13 NORTH, RANGE 4 EAST, CRAIGHEAD COUNTY, ARKANSAS, BEING MORE PARTICULARLY DESCRIBED AS FOLLOWS:

BEGINNING AT THE NORTHEAST CORNER OF SECTION 1, TOWNSHIP 13 NORTH, RANGE 4 EAST, CRAIGHEAD COUNTY, ARKANSAS; THENCE SOUTH 01°28'15" EAST ALONG THE EAST LINE OF SAID SECTION, 358.49 FEET TO THE NORTHERLY RIGHT-OF-WAY LINE OF INTERSTATE #555 (FORMERLY U.S. HIGHWAY #63); THENCE ALONG SAID RIGHT-OF-WAY LINE AS FOLLOWS: NORTH 71°46'29" WEST 424.89 FEET, NORTH 60°21'03" WEST 203.04 FEET, NORTH 50°38'44" WEST 173.01 FEET, TO A POINT ON THE NORTH LINE OF SAID SECTION 1; THENCE NORTH 88°45'11" EAST ALONG SAID NORTH LINE, 704.78 FEET TO THE POINT OF BEGINNING.

CONTAINING IN ALL 151,083 SQ. FT. OR 3.47 ACRES, MORE OR LESS.

SUBJECT TO EASEMENTS, RESTRICTIONS, RESERVATIONS AND RIGHTS-OF-WAY OF RECORD.

EASEMENT DESCRIPTION

PART OF THE NORTHEAST QUARTER OF THE NORTHEAST QUARTER OF SECTION 1, TOWNSHIP 13 NORTH, RANGE 4 EAST, CRAIGHEAD COUNTY, ARKANSAS, BEING MORE PARTICULARLY DESCRIBED AS FOLLOWS:

COMMENCING AT THE NORTHEAST CORNER OF SECTION 1, TOWNSHIP 13 NORTH, RANGE 4 EAST, CRAIGHEAD COUNTY, ARKANSAS: THENCE SOUTH 01°28'15" EAST ALONG THE EAST LINE OF SAID SECTION, 358.49 FEET TO THE NORTHERLY RIGHT-OF-WAY LINE OF INTERSTATE #555 (FORMERLY U.S. HIGHWAY #63); THENCE NORTH 71°46'29" WEST ALONG SAID RIGHT-OF-WAY LINE 382.64 FEET, TO THE POINT OF BEGINNING; THENCE CONTINUE ALONG SAID RIGHT-OF-WAY LINE AS FOLLOWS: NORTH 71°46'29" WEST 42.45 FEET, NORTH 60°21'03" WEST 20.71 FEET; THENCE NORTH 39°23'06" EAST DEPARTING SAID RIGHT-OF-WAY LINE, 107.23 FEET; THENCE SOUTH 71°46'29" EAST 64.34 FEET; THENCE SOUTH 39°23'06" WEST 111.63 FEET TO THE POINT OF BEGINNING.

CONTAINING IN ALL 6,653 SQ. FT. OR 0.15 ACRES, MORE OR LESS.

SUBJECT TO EASEMENTS, RESTRICTIONS, RESERVATIONS AND RIGHTS-OF-WAY OF RECORD.

DESCRIPTION SKETCH

HALSEY LAND COMPANY, LLC

**BENCHMARK** LAND SURVEYING, INC.  
LAND SURVEYING - CONSTRUCTION LAYOUT SERVICES  
2500 ALEXANDER DR., SUITE A  
P.O. BOX 1921 - JONESBORO, AR 72403  
PH: 870-336-2060 PH: 870-336-2059

NOTE:  
THIS DRAWING DOES NOT  
REPRESENT A BOUNDARY SURVEY

DATE:	BY:	DESCRIPTION:
CADD FILE:	18249-002	SCALE: 1"=100'
DATE:	10/16/18	SHEET
DWG#:	0413011-0006	1 OF 1

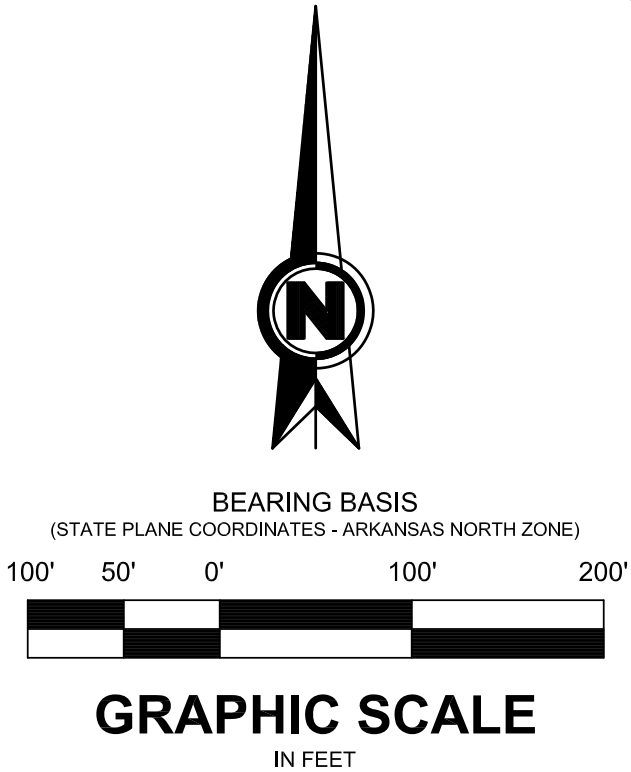

LEGEND	
—————	= BOUNDARY LINE
-----	= ADJACENT LOT LINES
- - - - -	= EASEMENT LINES