

555 MIDDLEFIELD ROAD

PALO ALTO, CALIFORNIA



FOR LEASE: First Floor: ±4,778 SF | CLASS A MEDICAL/DENTAL OFFICE WITH PARKING

Eric Rafia

HealthMed Realty
eric@healthmedrealty.com
+1 408 457 8808
LIC 01383075

Greg Pickett

Cushman & Wakefield
greg.pickett@cushwake.com
+1 650 320 0226
LIC 01846327



HealthMedRealty



CUSHMAN &
WAKEFIELD

HIGHLIGHTS

- ±4,778 SF Available
- Flexible Sizes
- Brand New, Completely Renovated Building
- Prestigious Downtown Palo Alto Location
- On Site Parking
- Landlord Can Construct and Deliver Your Ideal Layout

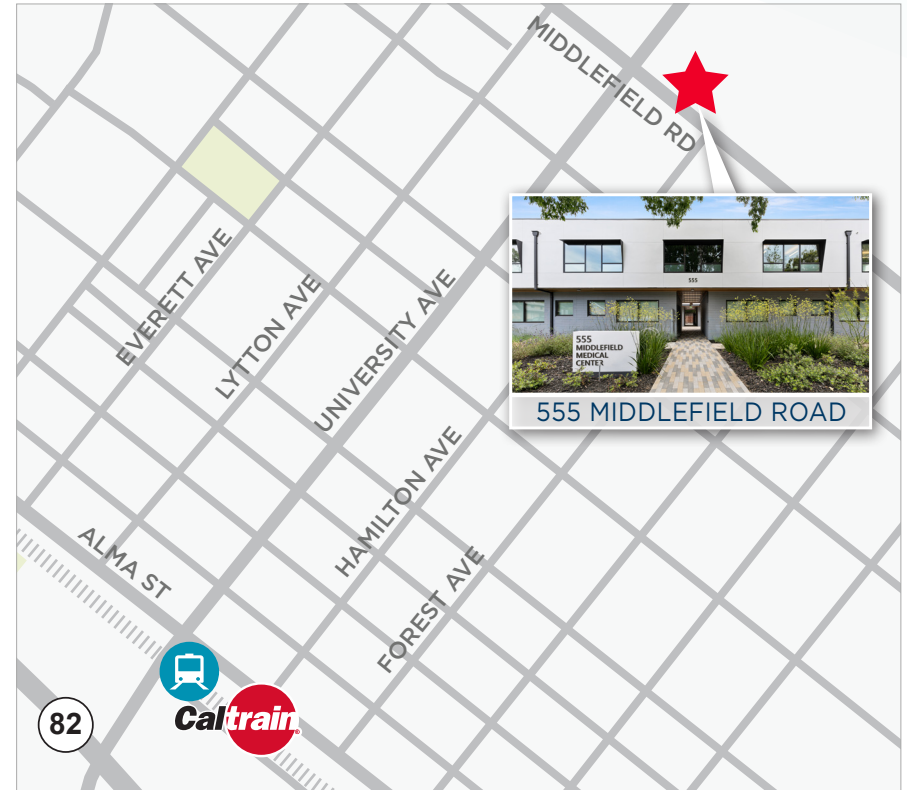

555 MIDDLEFIELD ROAD

PALO ALTO, CALIFORNIA

EXISTING FLOOR PLAN

FLOOR 1 | Multi Tenant

MIDDLEFIELD ROAD

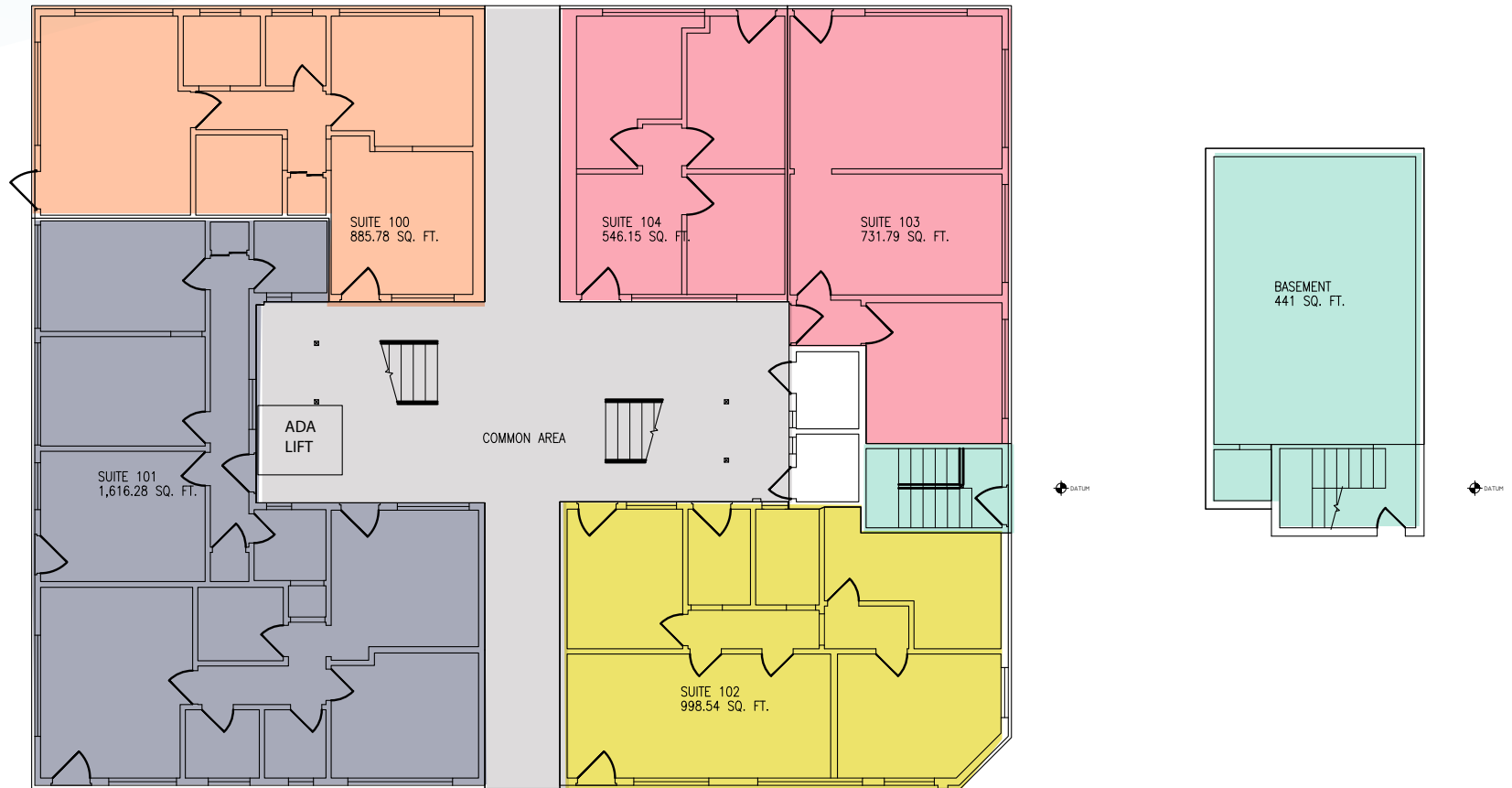

555 MIDDLEFIELD ROAD

PALO ALTO, CALIFORNIA

INTERIOR PHOTOS



555 MIDDLEFIELD ROAD

PALO ALTO, CALIFORNIA

WITHIN REACH



Restaurants

- 1 Arya Steakhouse
- 2 Bevri - Palo Alto
- 3 Bird Dog
- 4 Buca di Beppo
- 5 Cafe Venetia
- 6 Coconuts Caribbean
- 7 Crepevine Restaurants
- 8 Curry Pizza House
- 9 Curry Up Now
- 10 Il Fornaio
- 11 Joya Restaurant
- 12 Local Union 271
- 13 Mendocino Farms
- 14 New York Pizza
- 15 Nobu Palo Alto
- 16 NOLA Restaurant
- 17 Oren's Hummus
- 18 Osteria Toscana
- 19 Palo Alto Creamery

Restaurants

- 20 Pho Banh Mi
- 21 Pizzeria Delfina
- 22 ROOH Palo Alto
- 23 San Agus Cocina Urbana
- 24 SliderBar
- 25 SomiSomi
- 26 Son & Garden
- 27 Sushirrito
- 28 Sweet Maple
- 29 Tacolicious
- 30 Tai Pan
- 31 Tamarine Restaurant
- 32 Taste
- 33 Tea Time
- 34 Thyme
- 35 YAYOI
- 36 Zadna Bowl
- 37 Zola + BarZola

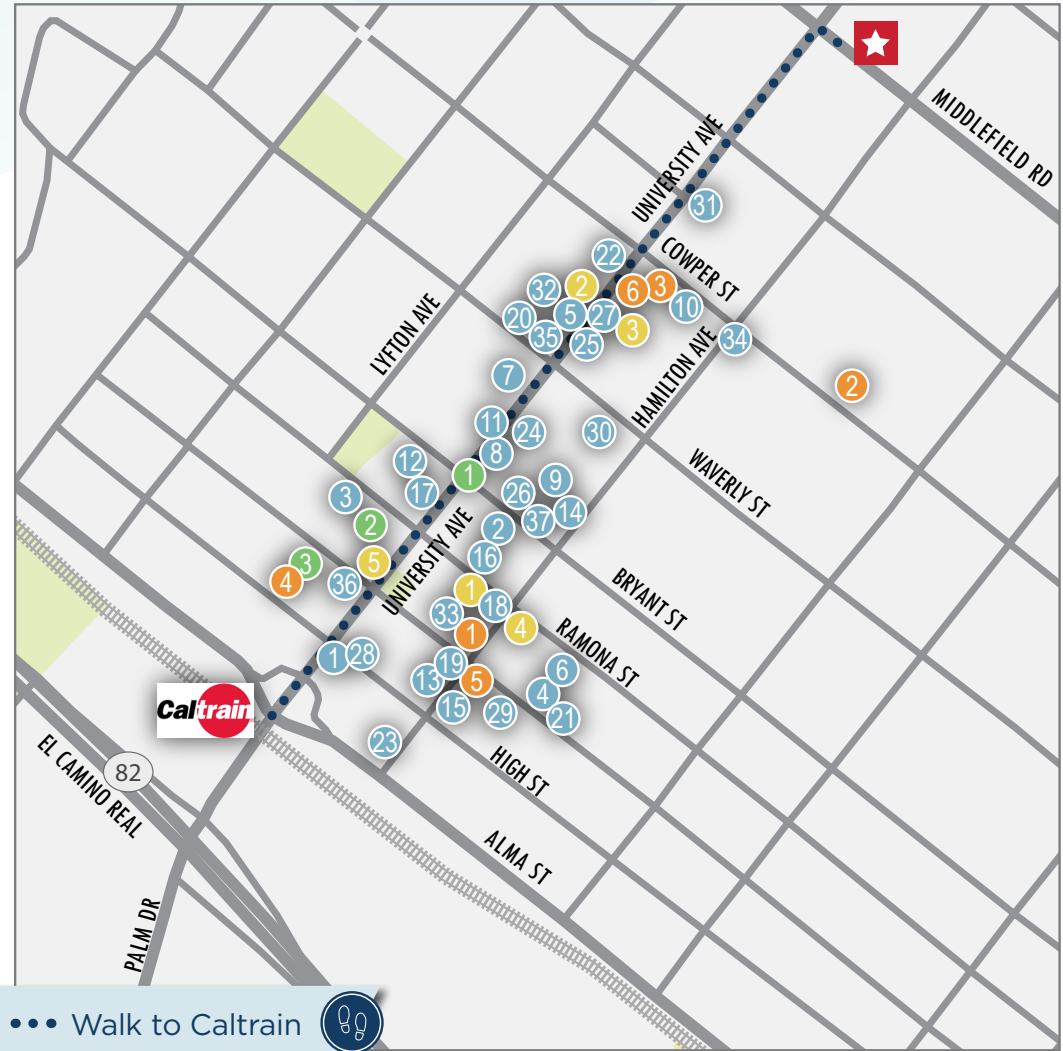

Hotels

- 1 Cardinal Hotel
- 2 Cowper Inn
- 3 el PRADO Hotel
- 4 Hotel Keen
- 5 Nobu Hotel Palo Alto
- 6 President's Terrace

Cafe

- 1 Bistro Maxine
- 2 Cafe Venetia
- 3 HanaHaus
- 4 JOE & THE JUICE
- 5 Oklava Cafe

Arts

- 1 Palo Alto Festival of the Arts
- 2 The Stanford Theatre
- 3 Aquarius Theater

555 MIDDLEFIELD ROAD

PALO ALTO, CALIFORNIA



Eric Rafia

HealthMed Realty
eric@healthmedrealty.com
+1 408 457 8808
LIC 01383075

Greg Pickett

Cushman & Wakefield
greg.pickett@cushwake.com
+1 650 320 0226
LIC 01846327



HealthMedRealty



CUSHMAN &
WAKEFIELD