



# PARK ON FIRST

1660 E First Street, Santa Ana, CA 92701

**A STREET  
PARTNERS**

# WELCOME TO PARK ON FIRST

Park on First offers a prime retail opportunity attached to a brand new multifamily development that houses 603 units. The retail units are delivered in cold shell condition providing the perfect blank canvas for almost any retail business. We are conveniently located directly off the 5 freeway and just minutes from the bustling and revitalized downtown Santa Ana. Park on First offers prominent signage on First Street which is seen by 35,000 cars per day. Reach out for more information today!



## Average Household Income

2-mile.....\$91,662  
5-mile.....\$114,787



## Population

2-mile.....139,897  
5-mile.....656,820



# RETAIL SUITES

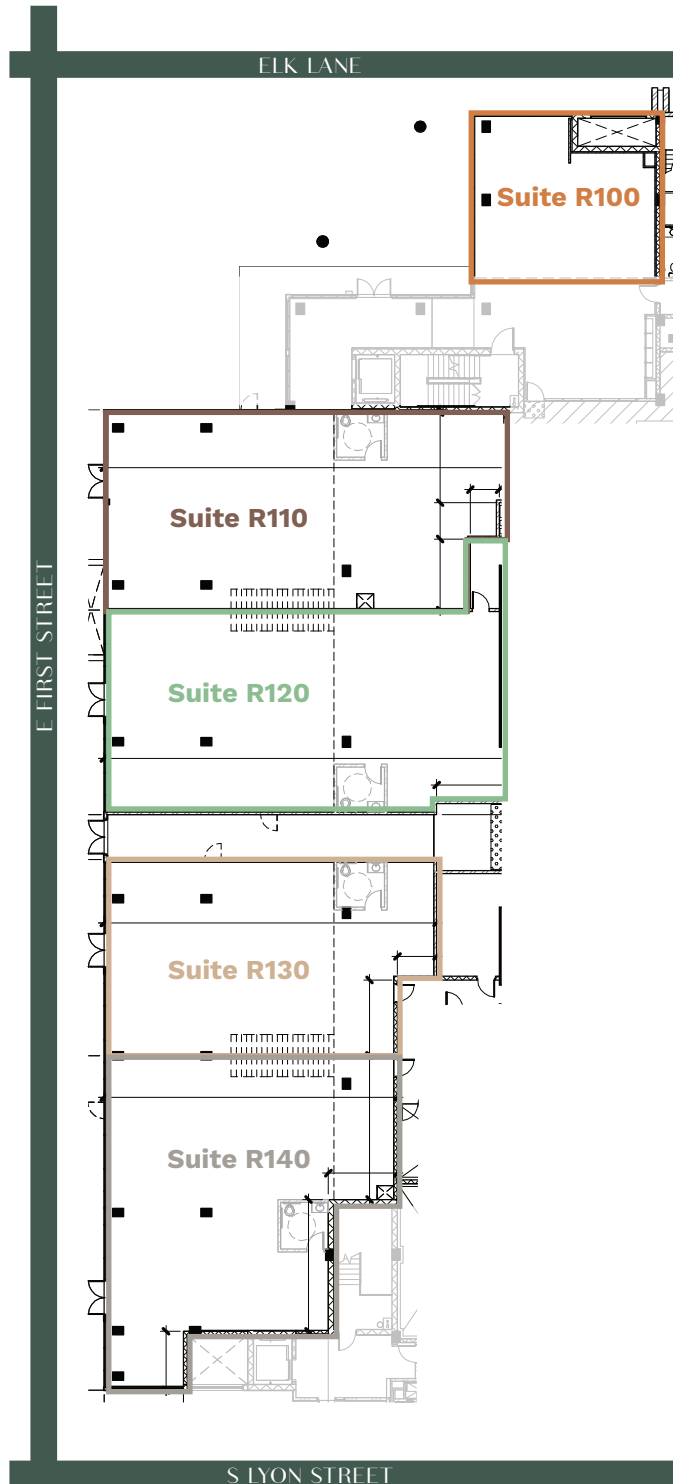

## Suite R100 - 946 RSF

Cold shell space. Brand new construction

## Suite R110 - 2,470 RSF

Cold shell space. Brand new construction

## Suite R120 - 2,602 RSF

Cold shell space. Brand new construction

## Suite R130 - 1,982 RSF

Cold shell space. Brand new construction

## Suite R140 - 2,432 RSF

Cold shell space. Brand new construction





FOR LEASING INFORMATION, CONTACT A STREET PARTNERS AT 949 381 5100

Blaine Annett

PARTNER

[blaine@astreetpartners.com](mailto:blaine@astreetpartners.com)

License No. 01861733

Morgan Lieber

SENIOR ASSOCIATE

[morgan@astreetpartners.com](mailto:morgan@astreetpartners.com)

License No. 01967995

Cory Smith

Associate

[cory@astreetpartners.com](mailto:cory@astreetpartners.com)

License No. 02195878

**A STREET  
PARTNERS**

The accuracy of all information regardless of source, including but not limited to square footages and lot size, is deemed reliable but is not guaranteed and should be independently verified through personal inspection by and/or with the appropriate professionals.