

FOR LEASE

8531 Whitaker Street
Buena Park, CA

±4,500 SF

**FREESTANDING INDUSTRIAL BUILDING
STREET FRONTAGE**



PROPERTY HIGHLIGHTS

- **600 Amp, 277/480 Volt Power** (verify)
- Approx. 750 SF Office
- Small Fenced Yard
- Whitaker Street Frontage
- 2 Restrooms
- Approx. 14' Clear Height
- Parking 2:1
- Excellent Access to 5 & 91 Freeways



Mark Hintergardt

Principal | Lee & Associates

714.272.0080

DRE# 00865136

mhintergardt@lee-associates.com

All information contained herein has been provided by Seller/Lessor and/or third parties, but has not been independently verified by Lee & Associates or its agent(s). Buyer/Lessee and interested parties should independently verify all information communicated by these sources.

FOR LEASE

8531 Whitaker Street
Buena Park, CA

±4,500 SF

FREESTANDING INDUSTRIAL BUILDING
STREET FRONTAGE

SITE PLAN

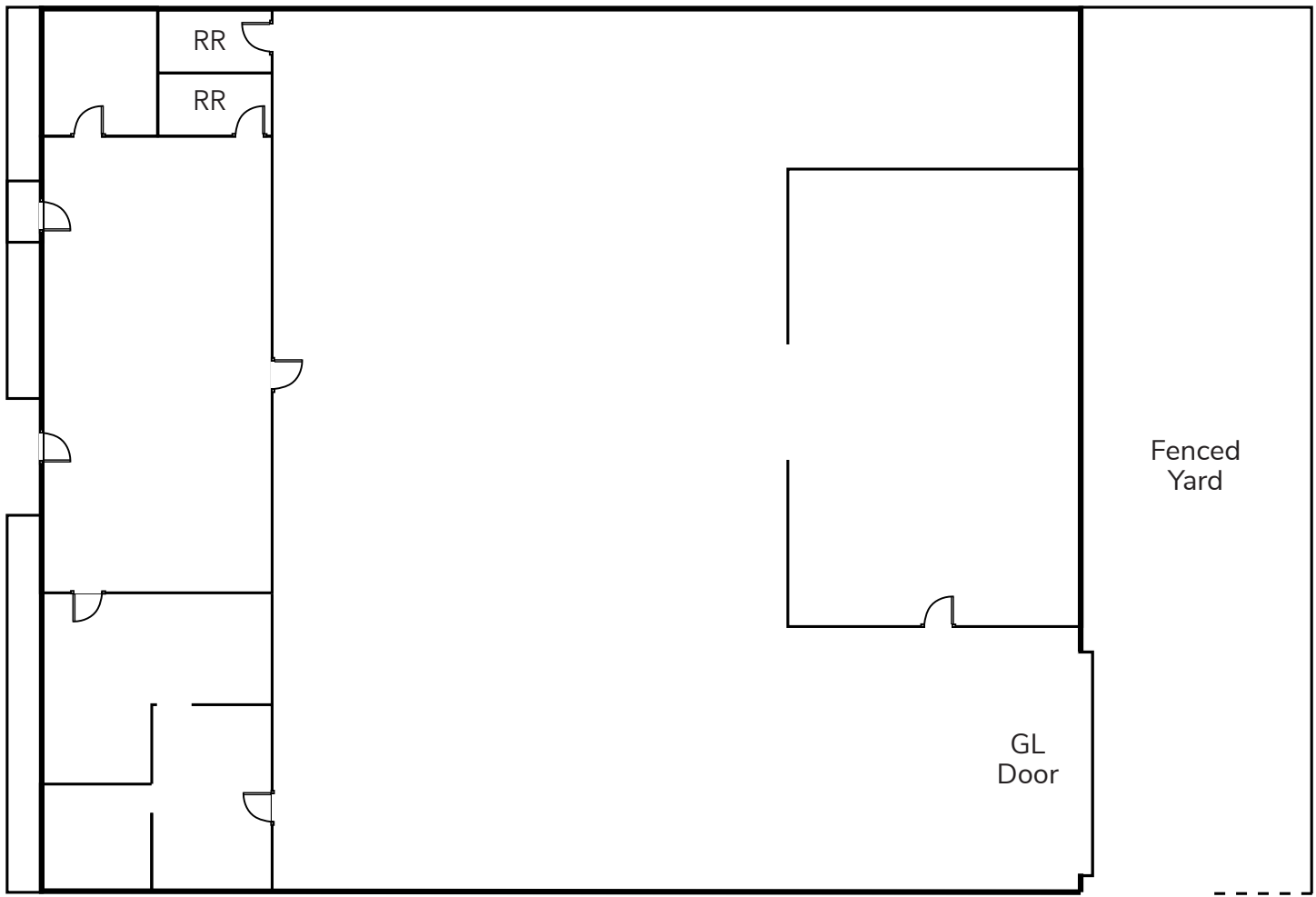

Not to Scale



Mark Hintergardt

Principal | Lee & Associates

714.272.0080

DRE# 00865136

mhintergardt@lee-associates.com

All information contained herein has been provided by Seller/Lessor and/or third parties, but has not been independently verified by Lee & Associates or its agent(s). Buyer/Lessee and interested parties should independently verify all information communicated by these sources.