

FOR SALE



**0 JOHN STREET
CAMDEN, ME 04843**

PROPERTY HIGHLIGHTS

- Two flat, vacant lots within walking distance of downtown Camden and Hannaford.
- Access via right of way along John Street with planned public utility extension.
- Sale Price: \$395,000 (\$91,860 per acre)



**THE BOULOS
COMPANY**

COMMERCIAL REAL ESTATE

PROPERTY DETAILS

OWNER OF RECORD	Camden Partners LLC
ADDRESS	0 John Street, Camden
LOT SIZE	4.3± acres
MAP/LOT	2 Lots: Map 117, Lot 32 Map 117, Lot 32-1
BOOK/PAGE	6101/200
LOT FRONTAGE	20' on John Street
ELECTRIC SERVICE	Single-phase on John Street
ZONING	117-32 is in Village 117-32-1 is in B-3
SALE PRICE	\$395,000

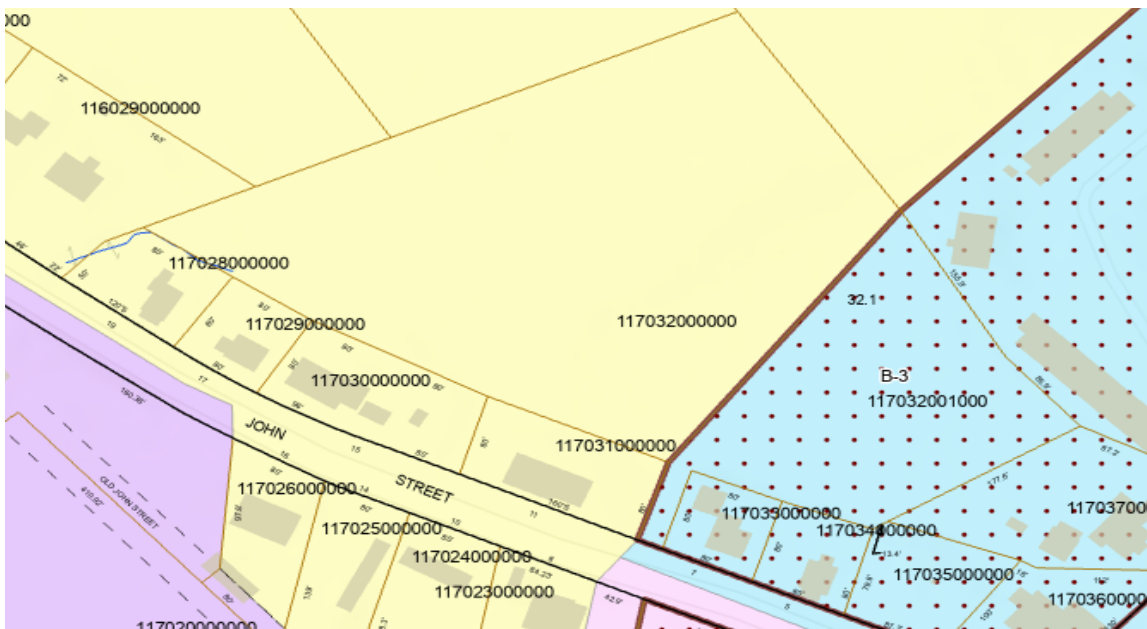

DIMENSIONAL STANDARDS

B-3 TRANSITIONAL BUSINESS ZONE (LOT 117-32-1)

Type of Use	Sewer	No Sewer
Minimum lot area		
Residential	10,000 square feet	40,000 square feet
Nonresidential	20,000 square feet	20,000 square feet
Minimum lot area per dwelling unit		
Single-family	3,333 square feet	20,000 square feet
Accessory apartments	No increase in lot area required	No increase in lot area required
Two-family dwellings	3,333 square feet	20,000 square feet
Multifamily dwellings	3,333 square feet	Not permitted
Multifamily dwellings (as part of an affordable housing development)	See § 290-8.17	Not permitted
Congregate housing	3,000 square feet	Not permitted
Minimum street frontage		
Residential	75 feet	100 feet
Nonresidential	100 feet	100 feet
Minimum setbacks		
Residential		

VILLAGE ZONE (LOT 117-32):

Type of Use	Requirement
Minimum lot area	
Residential	10,000 square feet
Nonresidential	10,000 square feet
Minimum lot area per dwelling unit	
Single-family	3,333 square feet
Accessory apartments	No increase in lot area required (see definition)
Two-family dwellings	3,333 square feet
Multifamily dwellings	3,333 square feet
Multifamily dwellings (as part of an affordable housing development)	See § 290-8.17
Congregate housing	3,000 square feet
Minimum street frontage	
Residential	75 feet
Nonresidential	75 feet
Minimum setbacks	
Residential	

0 JOHN STREET CAMDEN, ME 04843



CONTACT US



ROY DONNELLY
Associate Broker
+1 207.356.1327 C
+1 207.553.1736 D
rdonnelly@boulos.com

©2024 The Boulos Company, Inc. All rights reserved. This information has been obtained from sources believed reliable, but has not been verified for accuracy or completeness. You should conduct a careful, independent investigation of the property and verify all information. Any reliance on this information is solely at your own risk. The Boulos Company and The Boulos Company logo are service marks of The Boulos Company, Inc. All other marks displayed on this document are the property of their respective owners. Photos herein are the property of their respective owners. Use of these images without the express written consent of the owner is prohibited.