



PRICE: \$1,300,000

PLEASE DO NOT DISTURB EXISTING TENANT

5,075 SF FULL-SERVICE RESTAURANT AVAILABLE FOR SALE

4029 167TH ST / COUNTRY CLUB HILLS, IL



MID-AMERICA®
Real Estate Corporation

4029 167TH ST / COUNTRY CLUB HILLS, IL

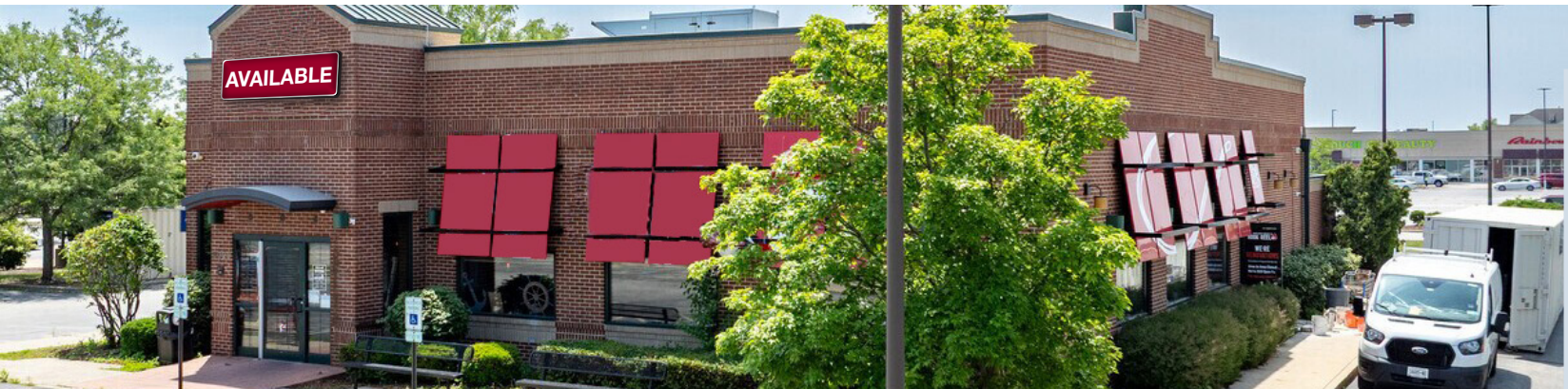

AVAILABLE FOR SALE / PRICE: \$1,300,000

5,075 sf restaurant building
±1.136 acre lot

FEATURES

- Full-Service restaurant building with excellent visibility from 167th Street (16,000 VPD) available for sale.
- Strategically located off the I-57 access ramp provides the site with excellent connectivity to surrounding markets by way of I-80 & I-294.
- Signalized access from Kilbourne St and full access from Crawford Ave.
- Monument Signage on 167th St and 84 Parking Stalls.
- Located in Country Club Plaza (4.7M visits/yr), shadow anchored by Walmart (2.2M visits/yr) & Marcus Theaters (471.9K Visits/yr). *Placer.ai*

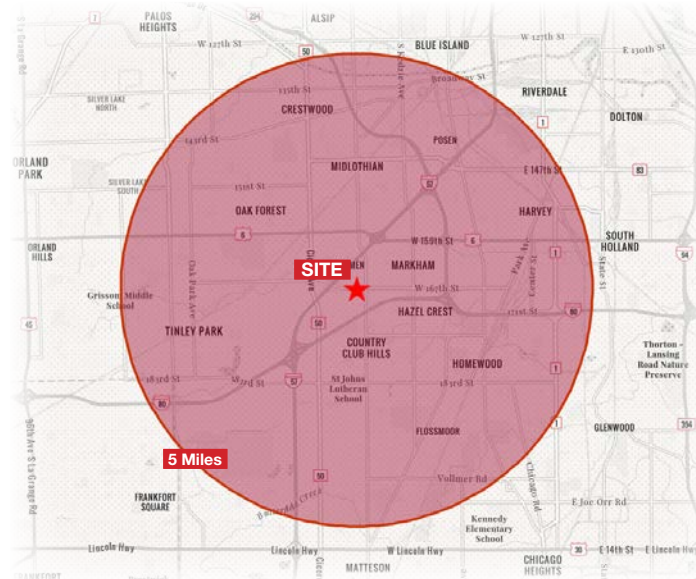

DEMOGRAPHICS WITHIN 5 MILES



Total Population

202,005



Avg HH Income

\$99,527



Daytime Population

192,147

AREA TENANTS

Walmart ✱
Supercenter

FIFTH THIRD BANK

Wendy's

ALDI

McDonald's

MARCUS THEATRES

STARBUCKS

PANDA EXPRESS CHINESE KITCHEN



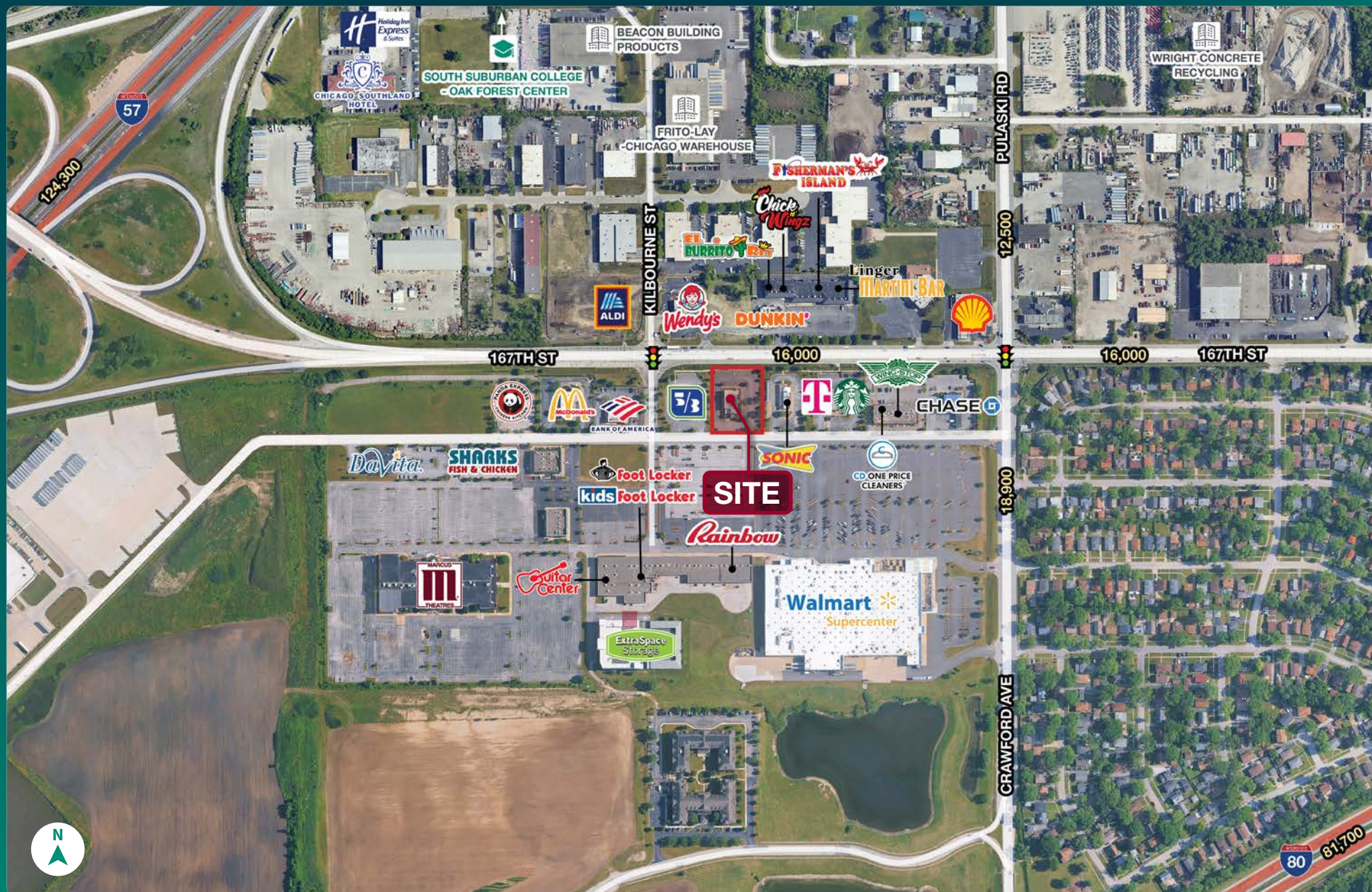

4029 167TH ST / COUNTRY CLUB HILLS, IL



4029 167TH ST / COUNTRY CLUB HILLS, IL



167TH ST — 16,000 VPD

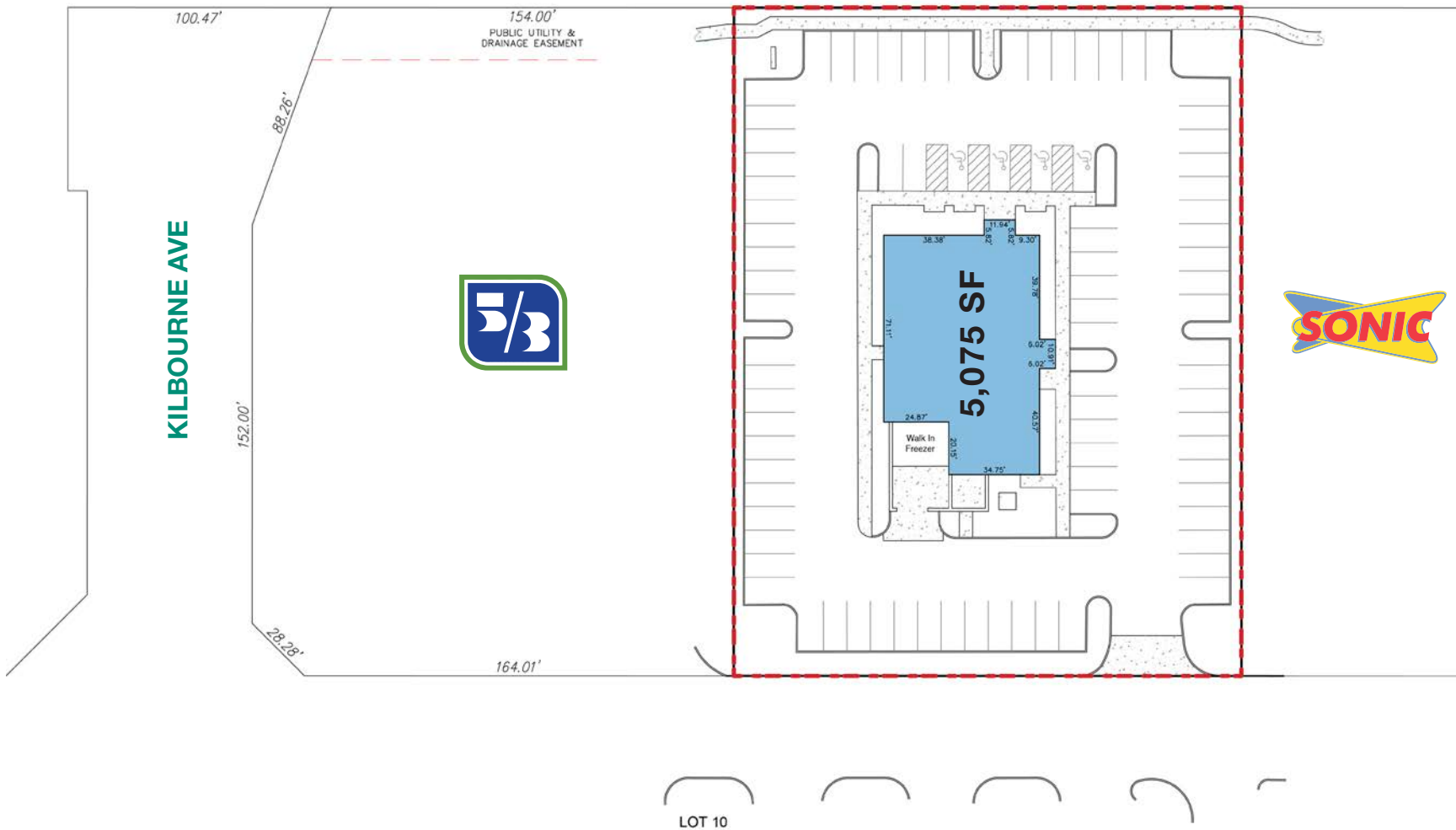

LOT 10

© 2014 C. J. & S. J. COMPANY

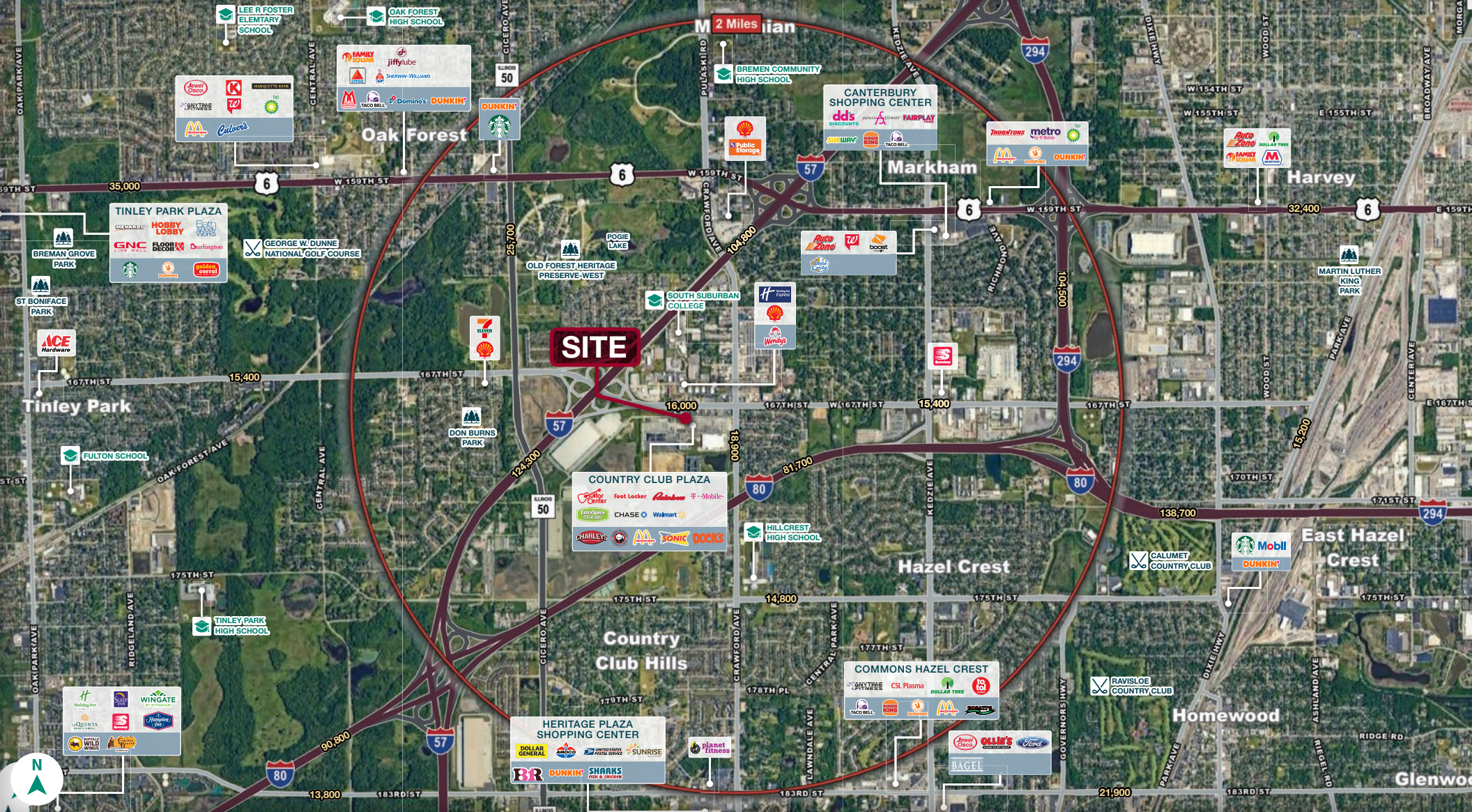

COUNTRY CLUB HILLS, ILLINOIS



TRAFFIC COUNTS & GENERATORS

TRAFFIC COUNTS

167TH ST: 16,000 VPD

I-57: 124,300 VPD

CRAWFORD AVE: 18,900 VPD

GENERATORS

COUNTRY CLUB PLAZA

(4.7M VISITS/YEAR) Placer.ai

SOUTH SUBURBAN COLLEGE

(3,905/STUDENTS)

4029 167TH ST / COUNTRY CLUB HILLS, IL

CONTACT US FOR
MORE INFORMATION

STEVE FRISHMAN

Mid-America Real Estate Corp.

SFrishman@MidAmericaGRP.com

630.954.7325

BRIAN ADAMS

Mid-America Real Estate Corp.

BAdams@MidAmericaGRP.com

630.954.7512

**MID-AMERICA KNOWS
RETAIL PROPERTY SALES & LEASING**



MID-AMERICA®
Real Estate Corporation

410 N Michigan Ave, Suite 1100 / Chicago, Illinois 60611

MidAmericaGrp.com