

2013 Cedar Bridge Ave

Lakewood, New Jersey

FOR LEASE



732.one.9898 | wer1re.com | infower1re.com







Property Overview

Available April 2024



Find your new office space at 2013 Cedar Bridge Ave. Newly constructed class A space for lease. Units ranging from 1,900 to 4,500 square feet, available April 2024. With its iconic design, beautiful amenities, spacious parking lot and incredible location, 2013 Cedar Bridge is the office space you need to take your business to the next level.

Space Summary



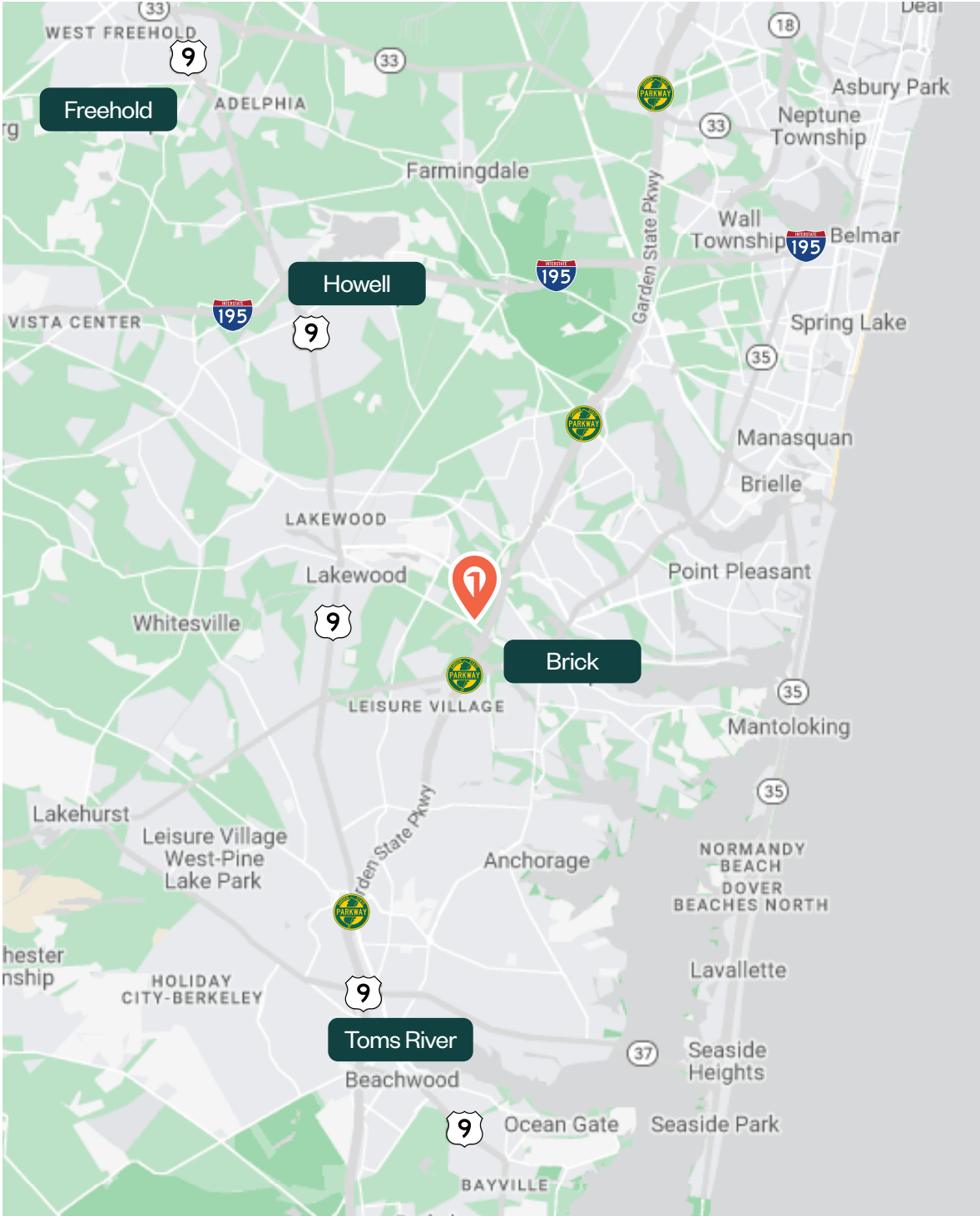

-  1,900 - 4,500 Square Foot units available
-  4 Stories
-  Class A Office Space



2013 CEDAR BRIDGE AVE | LAKEWOOD, NJ

10 Minutes to Toms River
 5 Minutes to Brick
 18 Minutes to Howell
 22 Minutes to Jackson

-  5 Minutes to Route 9
-  10 Minutes to I-195
-  1 Minute to the G.S.P.
-  3 Minutes to I-195
-  8 Minutes to I-195



732.ONE.9898 | INFO@WER1RE.COM | WER1RE.COM



FIRST FLOOR PLAN

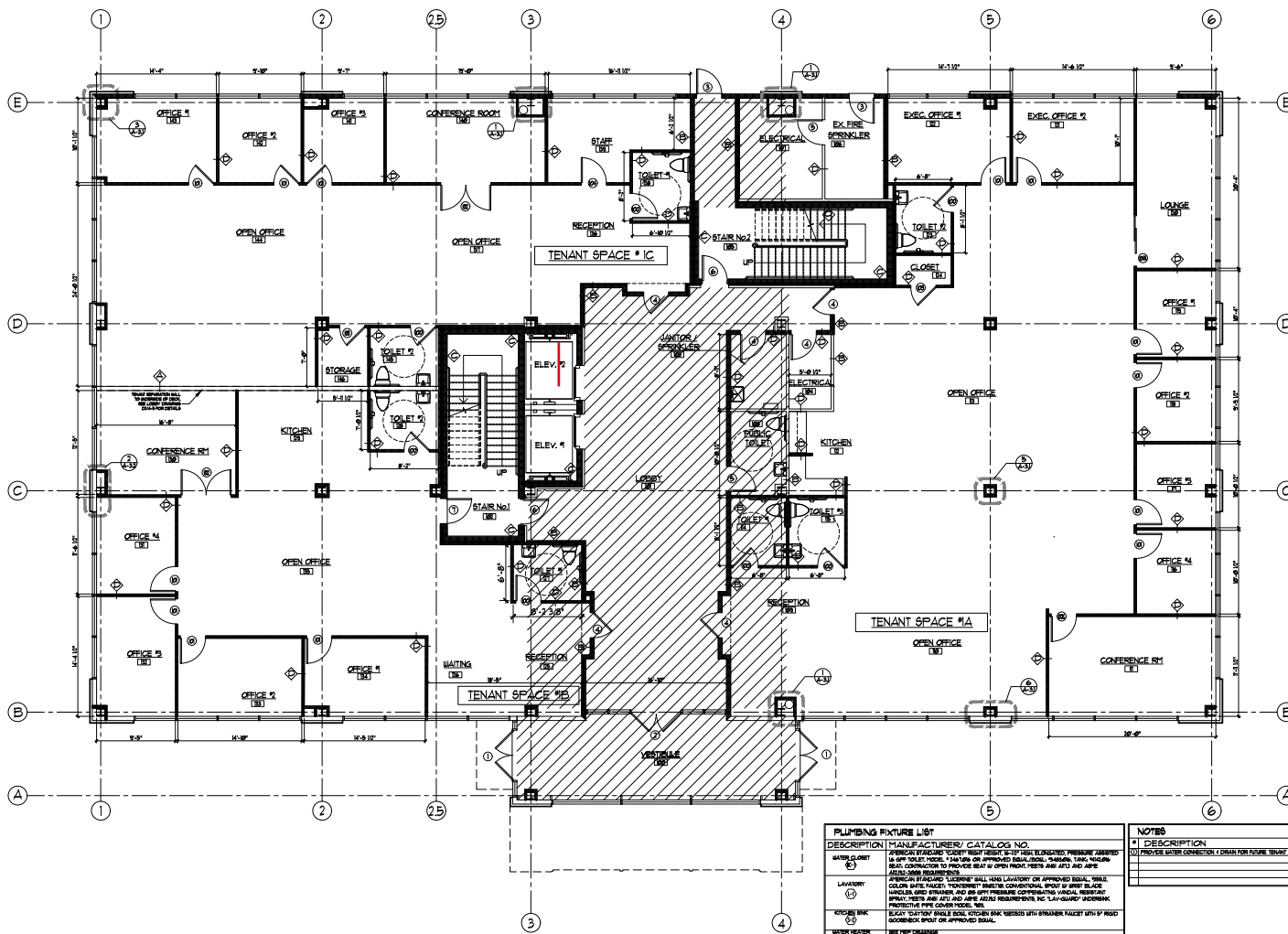

PLUMBING FIXTURE LIST	
DESCRIPTION	MANUFACTURER / CATALOG NO.
WATER CLOSET (WC)	1" BRASS BRANDED "CROMPTON" SIFON WITH 1/2" BUBBLED PRESSURE AIRSPACE & 1/2" AIR TEST HOLES. 1/2" AIR OR APPROVED EQUIVALENT. MAXIMUM 100' VACUUM. BEANS CONTRACTOR TO PROVIDE SEAT & OPEN FRONT. FITS AMF JETS AND AMPE (SEE OTHER REQUIREMENTS)
LAVATORY (LV)	APPROX BRANDED "CROMPTON" SINK AND LAVATORY OR APPROVED EQUAL. 1/2" BRASS. COLOR WHITE. FINISH: POLYURETHANE CONFORMAL. BRUSH BRASS GLASS. INCLUDE GRID STRAINER AND AN OBT. PRESSURE COMPENSATING VALVE. RESISTANT FINISH. FITS AMF JETS AND AMPE (SEE OTHER REQUIREMENTS). NO LAVATORY SINKING. PROTECTIVE FIBER COVER HOLES. 1/2"
TOILET SINK (TS)	ELCOT "CANTON" SINK. 1/2" BRASS. BRASS WITH SWANNEK FALZET 1/2" x 1/2" ROUND. 1/2" BUBBLED. BRUSH OR APPROVED EQUAL.
WATER FIXTURE (WF)	SEE TYP. DRAWING

NOTES	
1	DESCRIPTION
1	PROVIDE WATER CONNECTION L-DRAIN FOR DOUBLE TROUNT USE

1 FIRST FLOOR PLAN
3/8" = 1'-0"

DATE: 9/1/2023
 DRAWN BY: DJL
 CHECKED BY: JLC
 PROJECT NO.: 230502C
 SCALE: AS NOTED
 REVISIONS:

PROPOSED NEW LEVEL FITUPS FOR:
CEDAR BRIDGE MEDICAL CENTER - 2
 1000 W. WOODLAND AVENUE
 LAKEWOOD, NEW JERSEY
 BLOCK: 1608 LOTS: 1 & 2
 BUILDING #2

1000 W. WOODLAND AVENUE
 LAKEWOOD, NEW JERSEY
 07035-4000
 PH: 908.462.4377
 WWW.PUREZ+RADOSI.COM

Purez + Radosi
 Architecture
 Interior Design

DRAWING TITLE
 FIRST FLOOR
 SHEET NUMBER
A-1.0
 1 OF 11

SECOND FLOOR PLAN

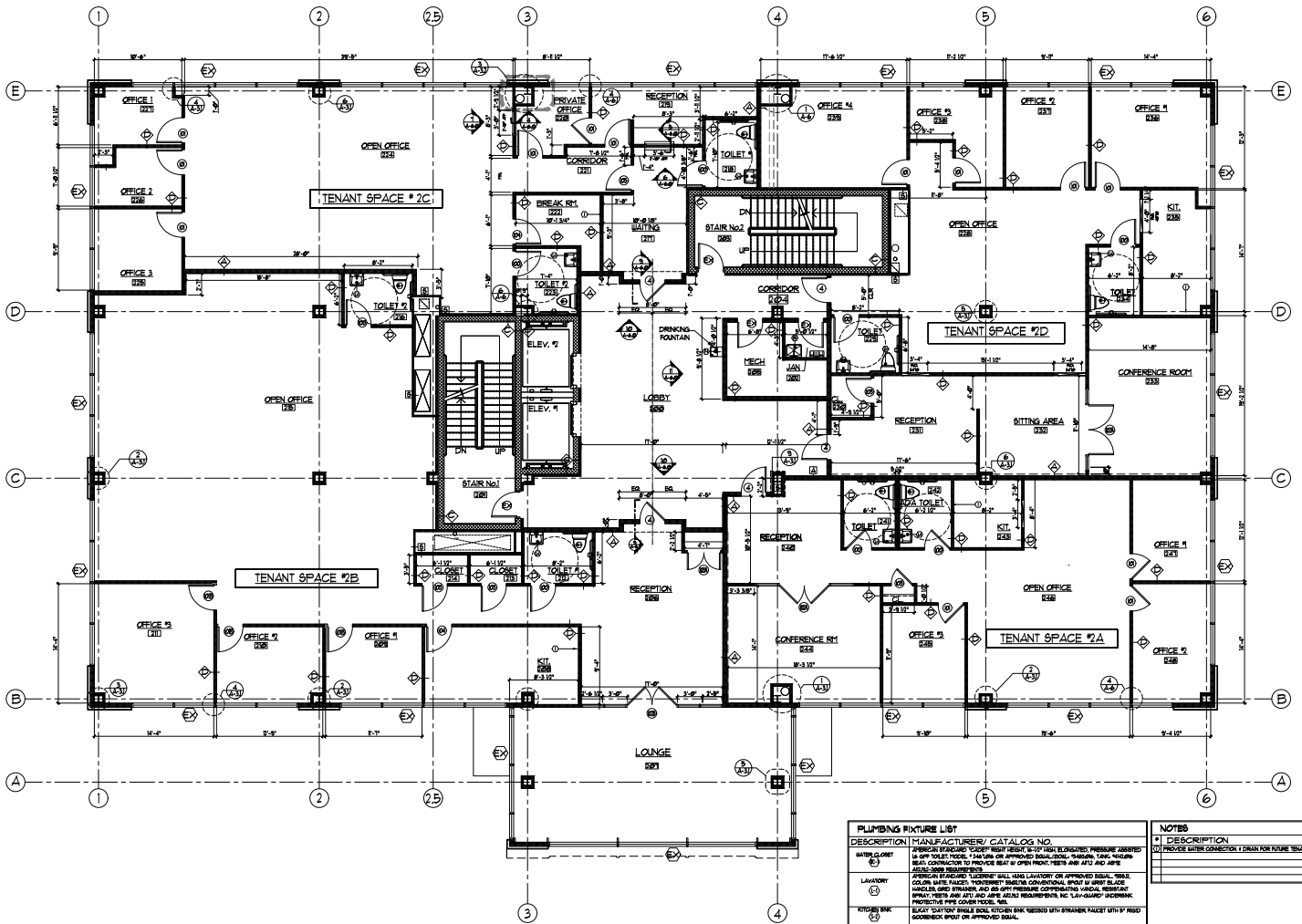

PLUMBING FIXTURE LIST	
DESCRIPTION	MANUFACTURER/ CATALOG NO.
WATER CLOSET (WC)	AMERICAN STANDARD "GEM" BOWL FRONT 12" X 18" HALL RELIEF PRESSURE ABSORBING 1/2" UP TOILET TOILET. 1/2" IN DIA. ON APPROVED BRASS/STAINLESS. VARIANTS: TONGUE AND GROOVE SEAT. CONTRACTOR TO PROVIDE SEAT & OPEN FRONT. SEATS ARE APTJ AND APPE. SEE GENERAL REQUIREMENTS.
LAUNDRY (L)	AMERICAN STANDARD "LUGER" WALL MOUNT LAUNDRY ON APPROVED BRASS. 18" X 24" X 34" H. 1/2" IN DIA. ON APPROVED BRASS/STAINLESS. VARIANTS: TONGUE AND GROOVE SEAT. CONTRACTOR TO PROVIDE SEAT & OPEN FRONT. SEATS ARE APTJ AND APPE. SEE GENERAL REQUIREMENTS.
KITCHEN SINK (KS)	AMERICAN STANDARD "LUGER" WALL MOUNT LAUNDRY ON APPROVED BRASS. 18" X 24" X 34" H. 1/2" IN DIA. ON APPROVED BRASS/STAINLESS. VARIANTS: TONGUE AND GROOVE SEAT. CONTRACTOR TO PROVIDE SEAT & OPEN FRONT. SEATS ARE APTJ AND APPE. SEE GENERAL REQUIREMENTS.
WATER HEATER (WH)	SEE MEP DRAWING

NOTES
1. DESCRIPTION
2. PROVIDE WATER CONNECTION & DRAIN FOR HOUSE TUBS USE

1 SECOND FLOOR PLAN
3/8" = 1'-0"

DATE: 08/01/2023
 DRAWN BY: J.S.
 CHECKED BY: J.S.
 PROJECT NO.: 230506
 SCALE: AS SHOWN
 REVISIONS:

PROPOSED NEW LEVEL 2 OFFICE FITUPS FOR:
CEDAR BRIDGE OFFICE CENTER - 2
 1999 CEDAR BRIDGE AVENUE
 LAKEWOOD, NEW JERSEY
 BLOCK: 1608 BUILDING #2

Architect: **Radost + Radost**
 1000 North 10th Street, Suite 200
 Lakewood, CO 80401
 Phone: 303.440.1000
 radost.com

MEP Architect: **Radost + Radost**
 1000 North 10th Street, Suite 200
 Lakewood, CO 80401
 Phone: 303.440.1000
 radost.com

DRAWING TITLE: MECHANICAL
 SHEET NUMBER: A-1.0
 2 OF 11

THIRD FLOOR PLAN

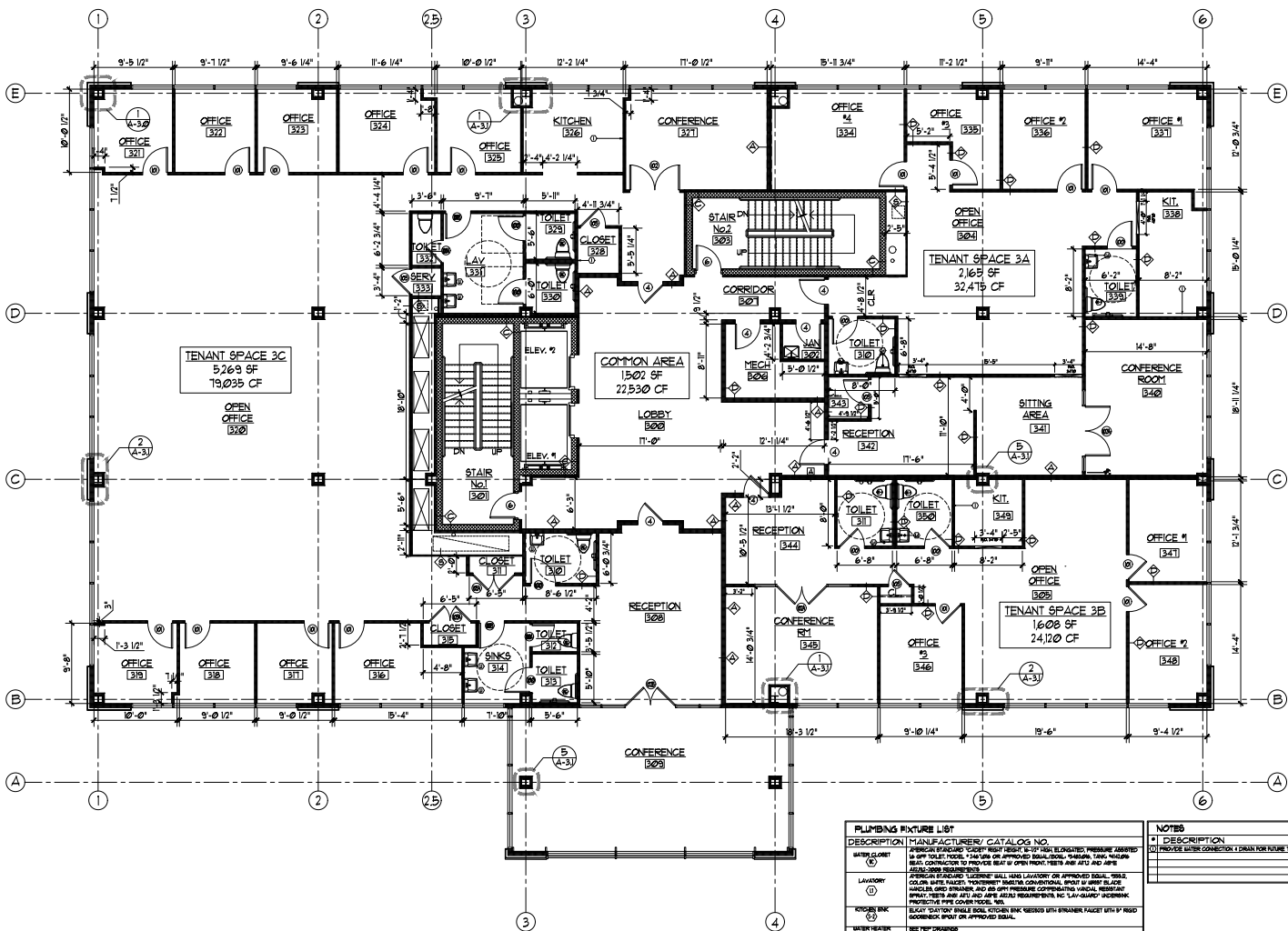

PLUMBING FIXTURE LIST	
DESCRIPTION	MANUFACTURER / CATALOG NO.
WATER CLIENT (C)	AMERICAN STANDARD "LIFE"® "BOST"® 1/2" HP 1/2" HUB ELONGATED PRESSURE ASSISTED 16 SPIN TOILET. 1/2" HUB OR APPROVED EQUAL. VARIANTS: TONGUE AND GROOVE SEAT. CONTRACTOR TO PROVIDE SEAT OR OPEN FRONT. MEETS ANSI A111 AND A112. SEE GENERAL REQUIREMENTS.
LAUNDRY (L)	AMERICAN STANDARD "LUCERNE"® 1/2" HUB LAUNDRY OR APPROVED EQUAL. NOTE: 1/2" HUB LAUNDRY. 1/2" HUB OR APPROVED EQUAL. VARIANTS: TONGUE AND GROOVE SEAT. CONTRACTOR TO PROVIDE SEAT OR OPEN FRONT. MEETS ANSI A111 AND A112. SEE GENERAL REQUIREMENTS.
KITCHEN SINK (K)	AMERICAN STANDARD "LUCERNE"® 1/2" HUB LAUNDRY OR APPROVED EQUAL. NOTE: 1/2" HUB LAUNDRY. 1/2" HUB OR APPROVED EQUAL. VARIANTS: TONGUE AND GROOVE SEAT. CONTRACTOR TO PROVIDE SEAT OR OPEN FRONT. MEETS ANSI A111 AND A112. SEE GENERAL REQUIREMENTS.
TOILET (T)	AMERICAN STANDARD "LIFE"® "BOST"® 1/2" HP 1/2" HUB ELONGATED PRESSURE ASSISTED 16 SPIN TOILET. 1/2" HUB OR APPROVED EQUAL. VARIANTS: TONGUE AND GROOVE SEAT. CONTRACTOR TO PROVIDE SEAT OR OPEN FRONT. MEETS ANSI A111 AND A112. SEE GENERAL REQUIREMENTS.
SHOWER (S)	AMERICAN STANDARD "LUCERNE"® 1/2" HUB LAUNDRY OR APPROVED EQUAL. NOTE: 1/2" HUB LAUNDRY. 1/2" HUB OR APPROVED EQUAL. VARIANTS: TONGUE AND GROOVE SEAT. CONTRACTOR TO PROVIDE SEAT OR OPEN FRONT. MEETS ANSI A111 AND A112. SEE GENERAL REQUIREMENTS.
WATER HEATER (WH)	SEE MEP DRAWING.

NOTES	
NO.	DESCRIPTION
01	PROVIDE WATER CONNECTION AND DRAIN FOR THESE TOILETS USE

1 THIRD FLOOR PLAN
3/8" = 1'-0"

DATE: 01/25/2023
 DRAWN BY: JLD
 CHECKED BY: JLD
 PROJECT NO.: 250514
 SCALE: AS NOTED
 REVISIONS:

PROPOSED NEW LEVEL 3 OFFICE FITUPS FOR:
CEDAR BRIDGE OFFICE CENTER - 2
 1000 CEDAR BRIDGE DRIVE
 LAKEWOOD, NEW JERSEY
 BLOCK: 1608 LOTS: 1 & 2
 BUILDING #2

PEREZ + RADOSKI
 ARCHITECTURE
 INTERIOR DESIGN
 375 BRIDGE PLAZA, SUITE 308, CORNELL, NY 14851
 TEL: 607.443.5277

Perez + Radoski
 Architecture
 Interior Design
 375 BRIDGE PLAZA, SUITE 308, CORNELL, NY 14851
 TEL: 607.443.5277

DRAWING TITLE
 1000 CEDAR BRIDGE DRIVE
 SHEET NUMBER
A-1.0
 1 OF 11

All rights reserved. The information contained in this document is proprietary to One Real Estate Group LLC and shall be used solely for the purposes of evaluating this proposal. All such documentation and information remains the property of One Real Estate Group LLC and shall be kept confidential. Reproduction of any part of this document is authorized only to the extent necessary for its evaluation. It is not to be shown to any third party without the prior written authorization of One Real Estate Group LLC. All information contained herein is from sources deemed reliable; however, no representative or warranty is made as to the accuracy thereof.



 **732.ONE.9898** |  **INFO@WER1RE.COM**
 **347.351.4665** |  **CHAYAKLEIN@WER1RE.COM**

200 BOULEVARD OF THE AMERICAS, SUITE 101 | LAKEWOOD, NJ 08701