

RETAIL/RESTAURANT/OFFICE SPACE FOR LEASE

Antelope Tower – 1900 K Street



PROPERTY FEATURES

- 17,000 SF first floor commercial space for lease or sale
- Retail/Restaurant/Office
- \$16.00 SF, \$45 TI Allowance
- Part of the new exciting Telegraph District
- Located in an Opportunity Zone that offers great tax incentives to purchase
- High daily traffic counts of 17,850 on K and 15,570 on L
- 93 Apartment units in the same building
- Near the State Capitol, federal building, government offices and UNL City Campus
- 174 off street parking stalls
- Ask us about purchase options

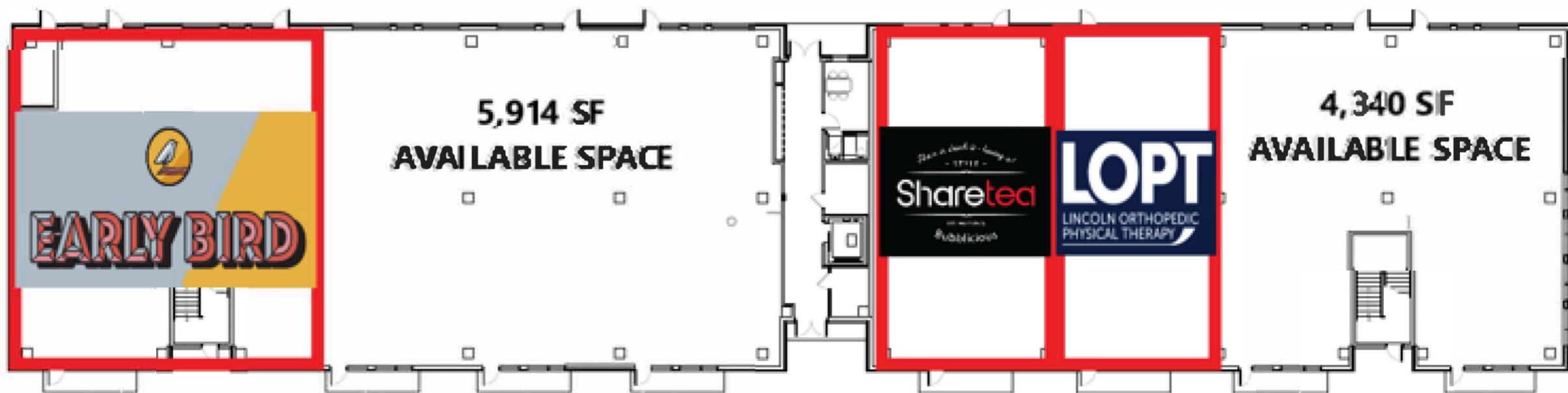

Each bay is approximately 2,000 SF

JOSH NEILL
COMMERCIAL LEASING/SALES AGENT

JOHN HOPPE JR.
BROKER

1900 K STREET

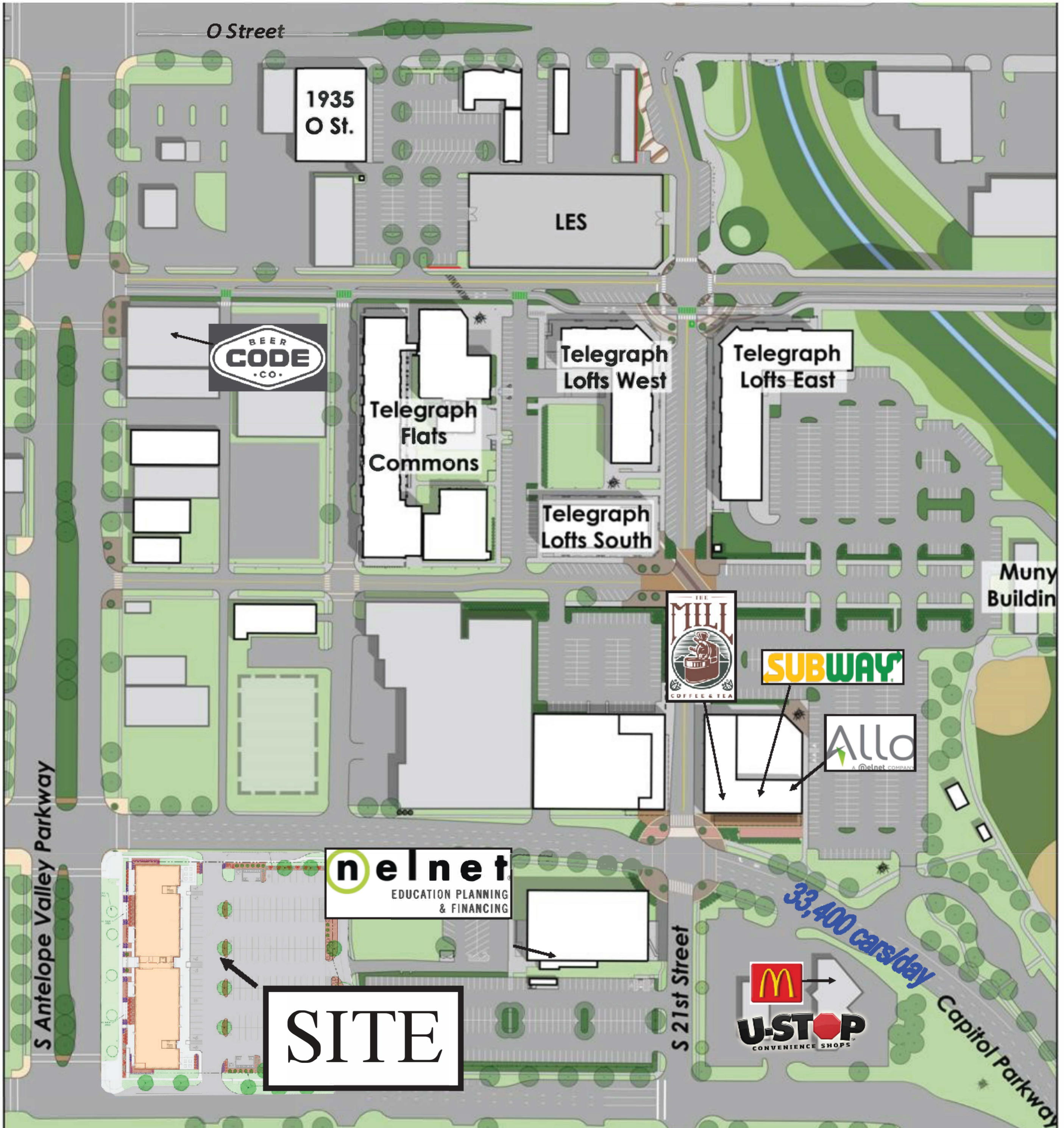

JOSH NEILL

COMMERCIAL LEASING/SALES AGENT

JOHN HOPPE JR.

BROKER



PHONE 402-441-4085

EMAIL josh@primesites.org

CELL 402-202-0587

WEB primesitesrealestate.com

All information is deemed reliable but is not guaranteed by listing agent.