

3157 EAST ELWOOD STREET







PHOENIX, ARIZONA

INDUSTRIAL BUILDING

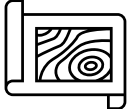

ARIZONA  COMMERCIAL
MANAGEMENT

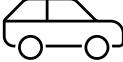
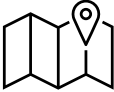
PROPERTY HIGHLIGHTS

	TOTAL SIZE: 76,135 SF		AVAILABLE: +/- 45,723 SF Multiple Configurations*
	CEILING HEIGHT: +/- 21' Clear		ZONING: A-2 ZONING Industrial
	POWER: 3,000 Amps		PARKING: 292 Stalls
	LOCATION: Sky Harbor Airport Region		LOADING DOCKS: 3 Dock High Doors 4 Grade Level Truck Wells



AVAILBILITIES:

SUITE	SF	NOTES
1	+/- 26,092 SF	<ul style="list-style-type: none"> • 2 Grade Level Doors • 1 Dock High Door • 2 Kitchens
2	+/- 19,631 SF	<ul style="list-style-type: none"> • 1 Grade Level Door • 1 Dock High Door • 1 Kitchen

PROPERTY HIGHLIGHTS

- **Flexible** configurations
- Both suites have **warehouse, offices & kitchens/breakrooms**
- Ample parking (**292 stalls**)
- **7** brand new loading docks
- Building visible to **I-10** commuters
- Excellent freeway access:
 - **I-10**
 - **Loop 202**
 - **SR-143**
- Proximity:
 - **4** miles to airport
 - **5** miles to Tempe
 - **6** miles to Phoenix



GALLERY



ENTRANCE



OPEN OFFICE



KITCHEN



CONFERENCE ROOM

SITE PLAN

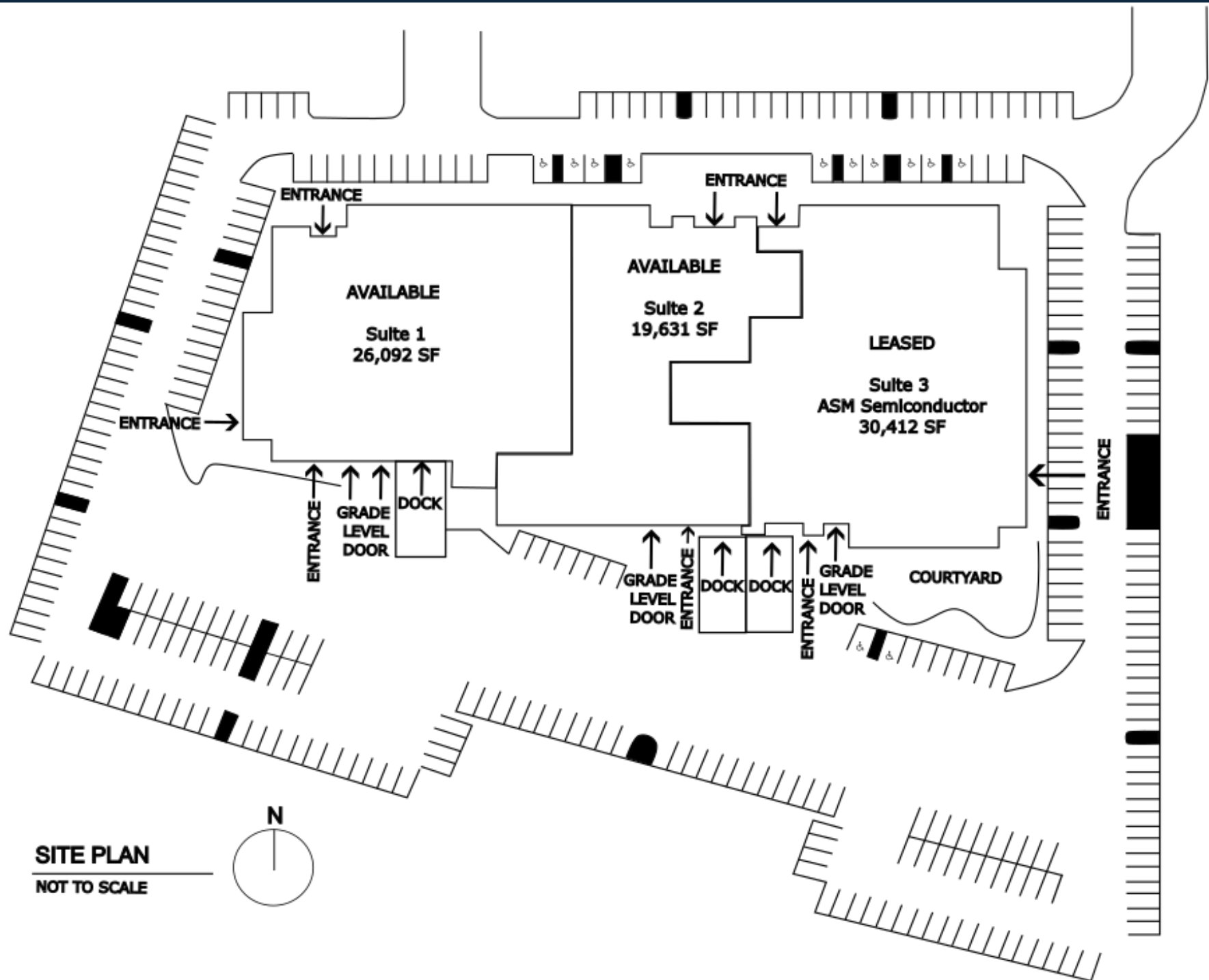

FLOOR PLAN

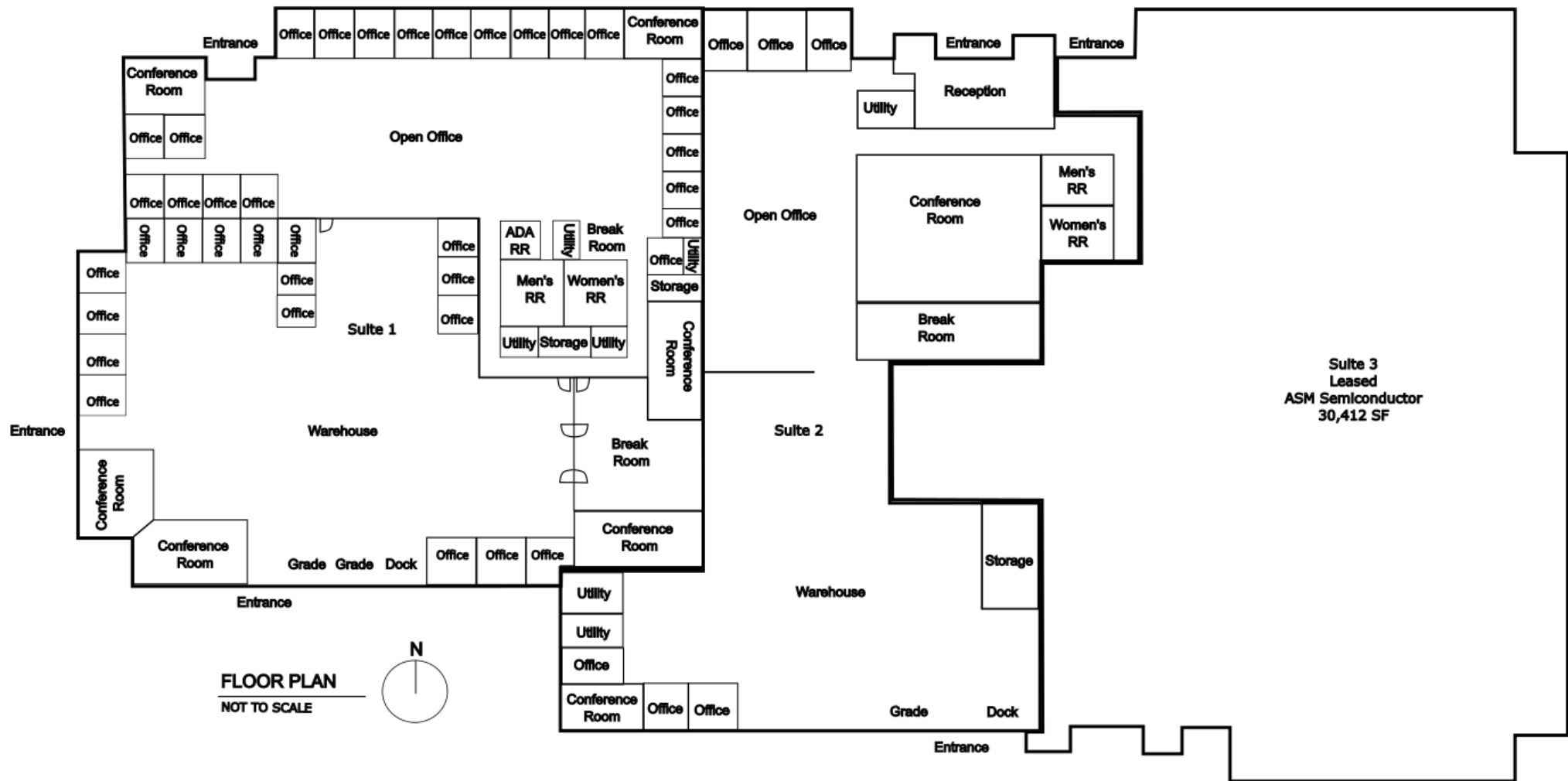

SUITE 1 - FLOOR PLAN

- 2 Grade Level Door
- 1 Dock Door
- 2 Kitchens
- +/- 26,092 SF

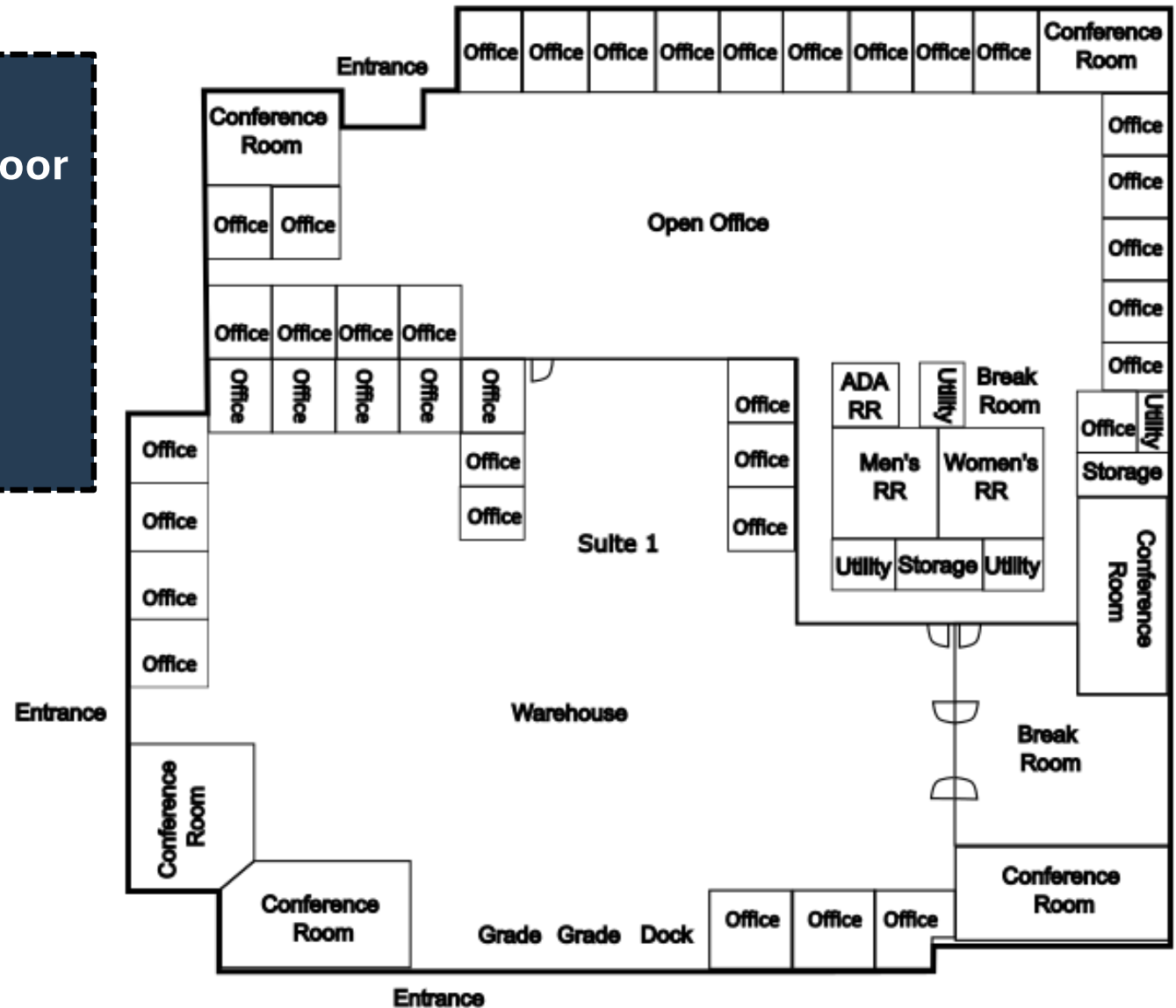

FLOOR PLAN
NOT TO SCALE

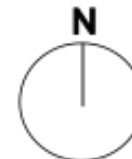

SUITE 2 – FLOOR PLAN

- 1 Grade Level Door
- 1 Dock Door
- 1 Kitchens
- +/- 19,631 SF

FLOOR PLAN
NOT TO SCALE

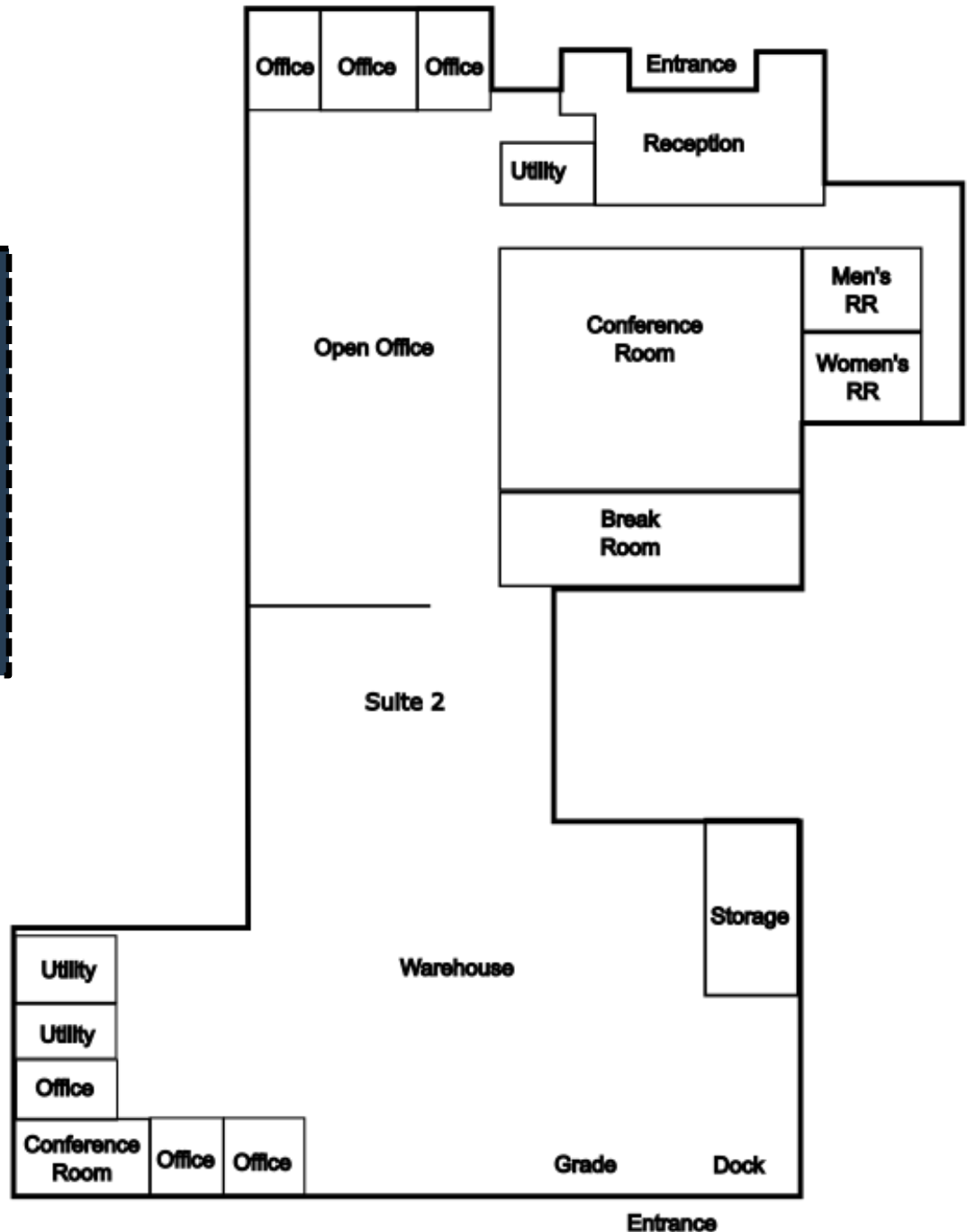
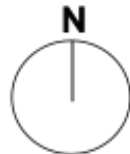

LOCATION HIGHLIGHTS

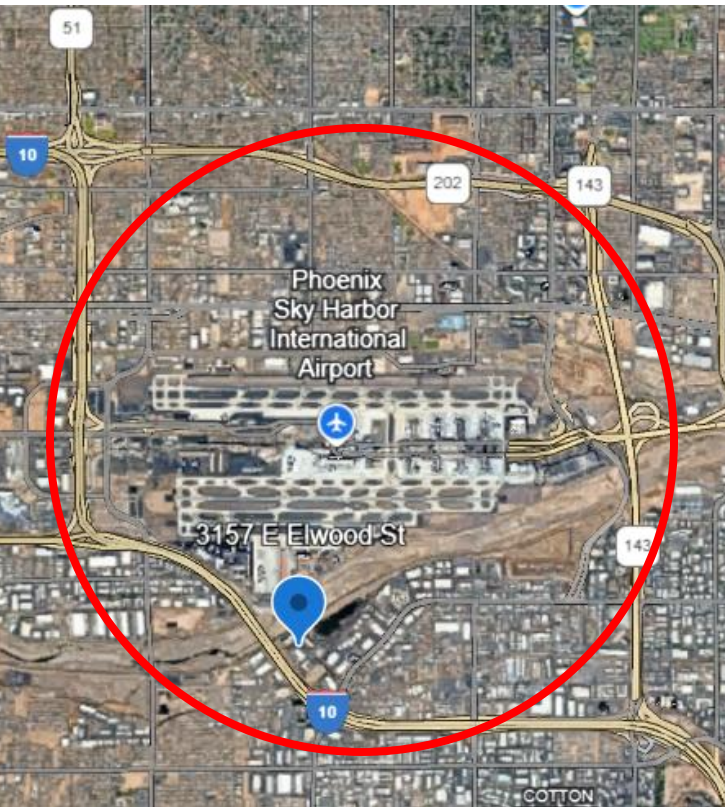



Mindy L Bacharach

Owner/Agent

925.466.4422

mlbrealestateservices@gmail.com

Dara L Chavez

Property Manager

623.341.6380

dchavez@arizonacommercial.net

