

→ ± 628 SQUARE FOOT 1ST FLOOR RETAIL SPACE FOR LEASE



**2936** LINCOLN  
AVENUE  
SAN DIEGO, CA 92104

**KRIS BOEHMER**

Senior Advisor, Investment Sales & Leasing  
(858) 243-7757  
Kris@PacificCoastCommercial.com  
Lic. 01890240

**PACIFIC COAST COMMERCIAL**

10721 Trenea Street, Suite 200  
San Diego, CA 92131  
(619) 469-3600  
www.PacificCoastCommercial.com  
Lic. 01209930





# PROPERTY DESCRIPTION



## PROPERTY

2936 Lincoln Avenue, San Diego, CA 92104



## SIZE

± 628 Square Foot Retail Space



## PARKING

Ample Street Parking



## LOCATION

Conveniently Located Near the Intersection of Lincoln Avenue and 30th Street



## ACCESSIBILITY

Good Freeway Access to I-805, I-8 and Hwy-163



## LEASE RATE

\$2.40/SF = \$1,507/Month  
Plus \$100/Month for Water and Common Area Fee;  
Plus Tenant Electricity



## AVAILABILITY

January 1, 2024, Upon Completion of Improvements

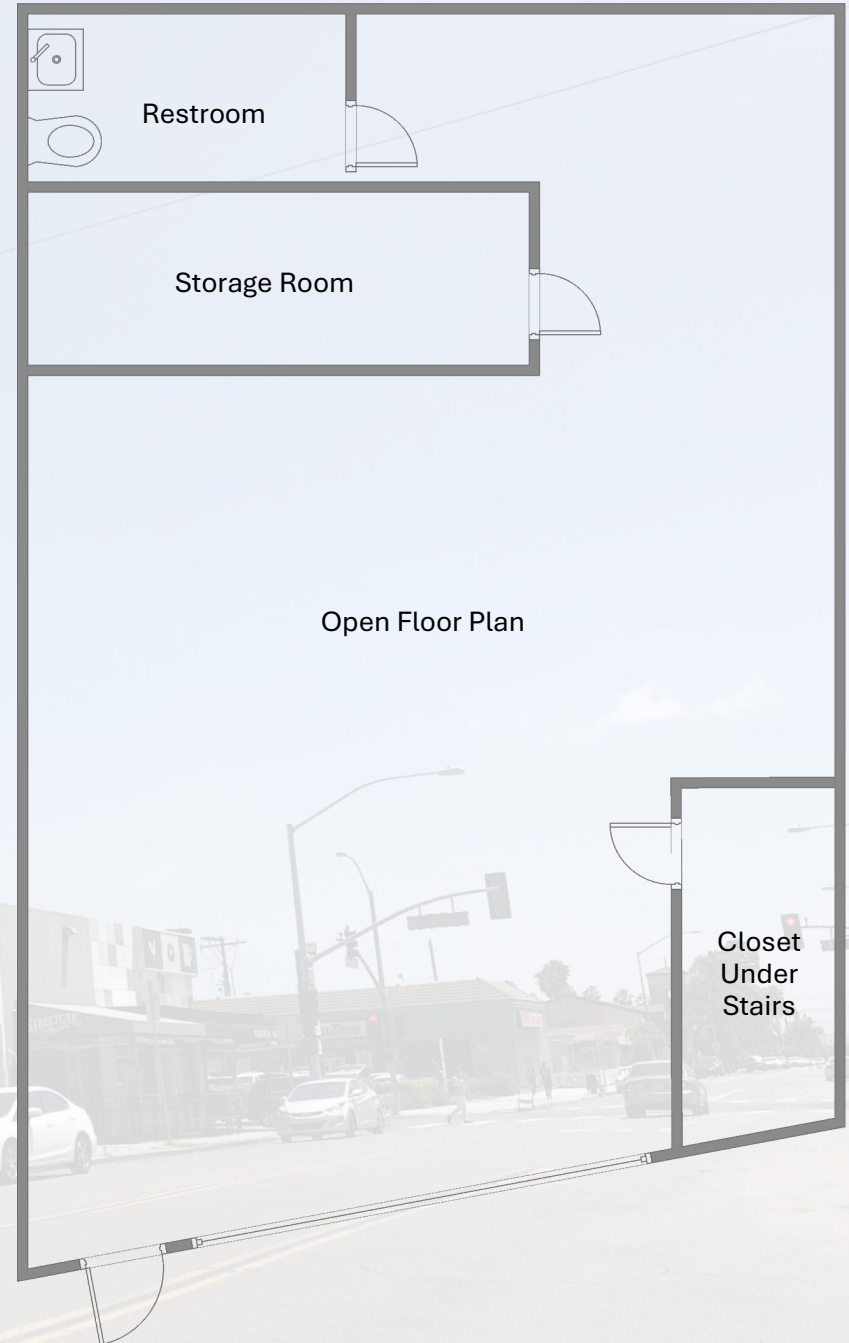

## CONTACT INFORMATION



**KRIS BOEHMER**

Senior Advisor, Investment Sales & Leasing  
(858) 243-7757  
Kris@PacificCoastCommercial.com  
Lic. 01890240

## PACIFIC COAST COMMERCIAL

10721 Treena Street, Suite 200  
San Diego, CA 92131  
(619) 469-3600  
[www.PacificCoastCommercial.com](http://www.PacificCoastCommercial.com)  
Lic. 01209930



2936 LINCOLN AVENUE  
SAN DIEGO, CA 92104