

9474 KVR

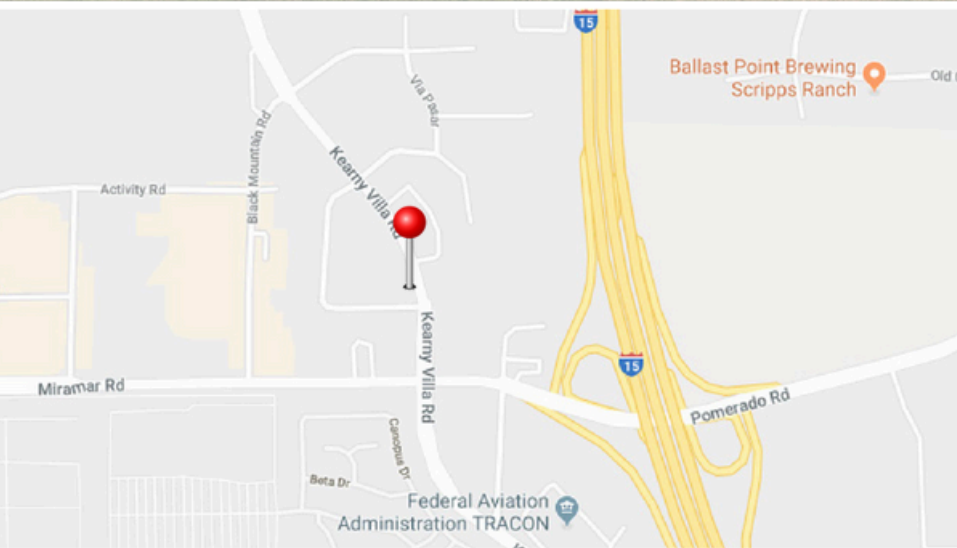

FOR LEASE
Office Space

9474 Kearny Villa Road | San Diego, CA 92126



Property Description

Address	9474 Kearny Villa Road San Diego, CA 92126
Building Type	Office Building
Year Built	1987
Land Area	1.07 AC
Building Size	±17,124 SF
Parking	±3.62/1000 SF
APN	341-230-80
Signage	Building Signage & Monument Signage
Stories	2
Access	Elevator and Multiple Stairways
Freeway Access	2 Blocks from I-15
Electric	Separate Electric Meters
Windows	Operable
Location	The building is centrally located off of Interstate 15 and Kearny Villa Road in the Mira Mesa/Miramar Submarket

Office Space FOR LEASE

Suite 215

SUITE 215 | ±1,653 SF



\$1.90/SF Modified Gross

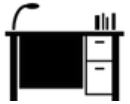

Window Lined Corner Unit with
Conference Room, Kitchen,
and Large Open Area



Available Now

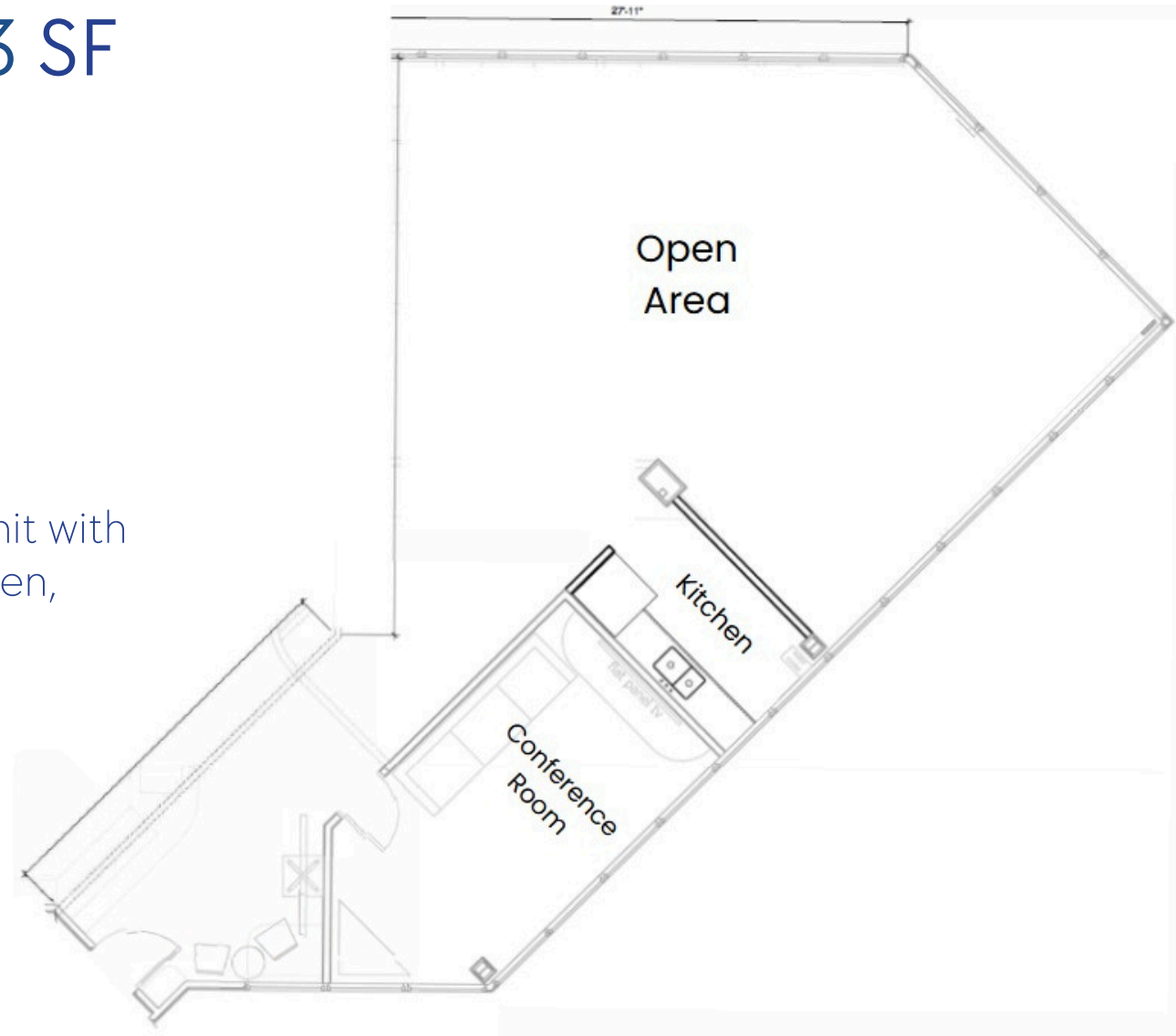

9474 KVR

FOR MORE
INFORMATION PLEASE
CONTACT

--

Mark Silverman

Executive Vice President, SIOR
619.857.2813
msilverman@naisandiego.com

NAI San Diego

9820 Willow Creek Road, Suite 100
San Diego, CA 92131 619.497.2255



NO WARRANTY OR REPRESENTATION, EXPRESS OR IMPLIED, IS MADE AS TO THE ACCURACY OF THE INFORMATION CONTAINED HEREIN, AND THE SAME IS SUBMITTED SUBJECT TO ERRORS, OMISSIONS, CHANGE OF PRICE, RENTAL OR OTHER CONDITIONS, PRIOR SALE, LEASE OR FINANCING, OR WITHDRAWAL WITHOUT NOTICE, AND OF ANY SPECIAL LISTING CONDITIONS IMPOSED BY OUR PRINCIPALS NO WARRANTIES OR REPRESENTATIONS ARE MADE AS TO THE CONDITION OF THE PROPERTY OR ANY HAZARDS CONTAINED THEREIN ARE ANY TO BE IMPLIED.