



Ranked in Top 50  
Commercial Firms in U.S.



# FOR SALE OR LEASE

297 – 305 New Britain Avenue, Plainville, CT

8.52± ACRES (2.5± ACRES BUILDABLE) in the GC ZONE

**SALE PRICE: \$1,350,000 | LEASE RATE: \$100,000/ACRE NNN**

## HIGHLIGHTS

- Highly Visible Retail Site
- Signalized Driveway Easement
- 8.52 acres (2.5 acres Buildable)
- Dense retail/residential area
- High Traffic: 18,500± ADT
- Property Cleared
- General Commercial Zone
- Immediate highway access

## CONTACTS

**Thomas Wilks | (860) 761-6018**

[twilks@orlcommercial.com](mailto:twilks@orlcommercial.com)

**Jay L. Morris | (860) 721-0033**

[jmorris@orlcommercial.com](mailto:jmorris@orlcommercial.com)



[WWW.ORLCOMMERCIAL.COM](http://WWW.ORLCOMMERCIAL.COM)



2430 Silas Deane Highway, Rocky Hill, CT 06067 | ☎ (860) 721-0033 | 📠 (860) 721-7882

2 Summit Place, Branford, CT 06450 | ☎ (203) 488-1555 | 📠 (203) 315-4046

Broker of Record: Jay Morris | 860.721.0033 | [jmorris@orlcommercial.com](mailto:jmorris@orlcommercial.com) | License: REB.0755257

While the information contained herein has been obtained from sources deemed to be reliable, no guarantee is made as to its accuracy.





# FOR SALE/LEASE

SALE PRICE: \$1,350,000

LEASE RATE: \$100,000/ACRE NNN

297-305 New Britain Ave, Plainville, CT

8.52± ACRES (2.5± ACRES BUILDABLE)

## SITE INFORMATION – 297-299 New Britain Ave

MAP ADDRESS: 21-A-01

TOTAL SITE AREA: 8.25 acres

TOTAL USUABLE AREA: 2.60 acres

FRONTAGE: 194'

## SITE INFORMATION – 305 New Britain Ave

MAP ADDRESS: 2-A-02

TOTAL SITE AREA: 0.27 acre

TOTAL USUABLE AREA: 0.27 acre

FRONTAGE: 33'

## ZONING

ZONE: GC - General Commercial

PERMITTED USES: Commercial or retail, bank, service, daycare, restaurant, Hotel, theatre, fitness club, recreation, etc

SITE PLAN APPROVAL: No

WETLANDS: Partial

MAX BUILDING COVERAGE: 60,000 SF

SITE IMPROVEMENTS: Tear down residential

TOPOGRAPHY: Sloping, cleared

ABUTTING LAND FOR SALE: No

## UTILITIES

WATER: At Street

SEWER: At Street

GAS: At Street

## LOCATION

VISIBILITY: Excellent, opposite 570,000± SF Power Center

HIGHWAY ACCESS: I-84, Rt. 72, Rt. 372

TRAFFIC VOLUME: 18,500± ADT

SIGNAGE: TBD

## TAXES

ASSESSMENT: TBD

MILL RATE: TBD

TAXES: TBD

## EXPENSES

RE TAXES: ☒ Tenant ☐ Landlord

UTILITIES: ☒ Tenant ☐ Landlord

INSURANCE: ☒ Tenant ☐ Landlord

MAINTENANCE: ☒ Tenant ☐ Landlord

JANITORIAL: ☒ Tenant ☐ Landlord

NNN EXPENSES: \$TBD±

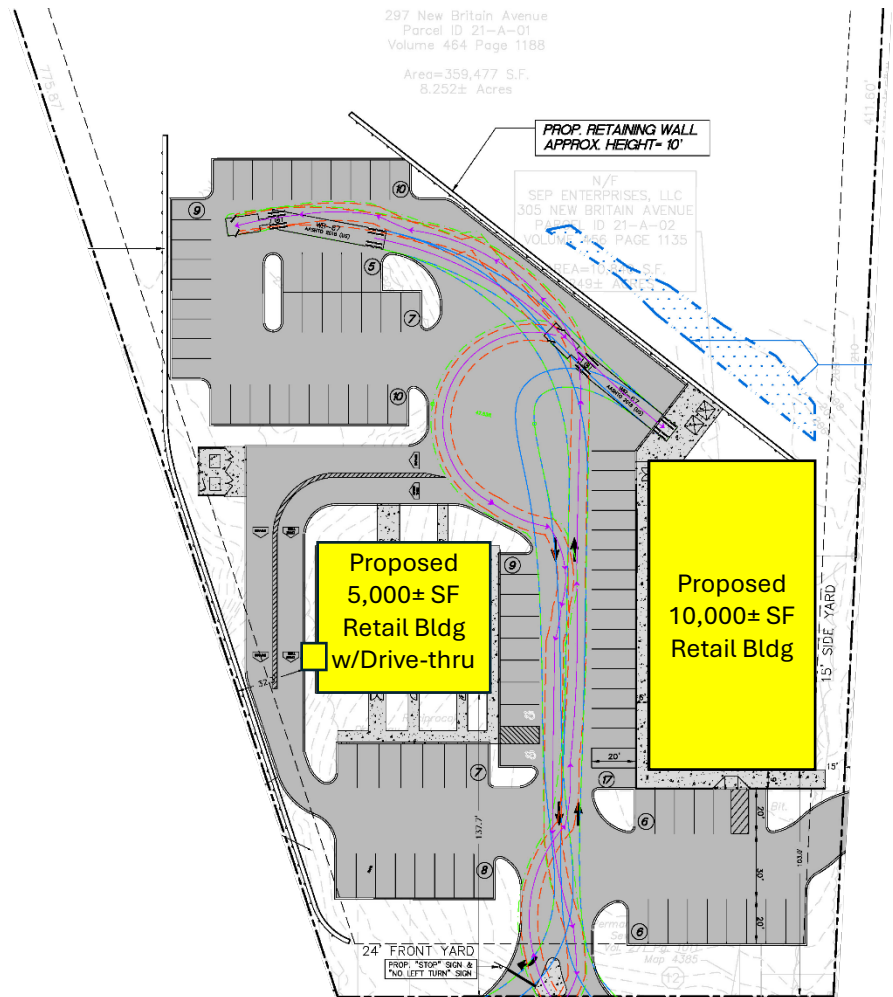

Radius	1 mile	3 miles	5 miles
<strong>Population</strong>			
2020 Population	4,705	59,687	161,682
2024 Population	4,745	59,627	161,401
Average Age	43.40	41.00	40.70
<strong>Households</strong>			
2020 Households	2,016	24,848	66,334
2024 Households	2,020	24,732	65,961
Annual Growth 2020-2024	0.7%	0.1%	0.1%
Avg Household Income	\$99,020	\$83,614	\$90,095
Median Household Income	\$84,773	\$63,672	\$67,081
<strong>Housing</strong>			
Median Home Value	\$241,518	\$224,822	\$239,087
Median Year Built	1964	1959	1963

## CONTACT

Thomas Wilks | (860) 761-6018

[twilks@orlcommercial.com](mailto:twilks@orlcommercial.com)

Jay L. Morris | (860) 721-0033

[jmorris@orlcommercial.com](mailto:jmorris@orlcommercial.com)



[WWW.ORLCOMMERCIAL.COM](http://WWW.ORLCOMMERCIAL.COM)



2430 Silas Deane Highway, Rocky Hill, CT 06067 | ☎ (860) 721-0033 | 📠 (860) 721-7882

2 Summit Place, Branford, CT 06450 | ☎ (203) 488-1555 | 📠 (203) 315-4046

Broker of Record: Jay Morris | 860.721.0033 | [jmorris@orlcommercial.com](mailto:jmorris@orlcommercial.com) | License: REB.0755257

While the information contained herein has been obtained from sources deemed to be reliable, no guarantee is made as to its accuracy.