

1002 1st Ave  
Rock Falls, IL 61071

**\$3-\$12/sq. ft. NNN**

\*NNN includes but not limited to Real Estate Taxes, Insurance, and CAM (such as parking lot maintenance, snow removal, lawn care, etc.)

**RETAIL SPACE FOR LEASE**

**Aerial - Site View**



Suites available from 2,000 sq. ft. to 10,800 with Dollar General, Rent-A-Center, and Second Chance  
Can be combined or split as needed  
Lease price based upon tenant specs and frontage

**Population Density Shading**

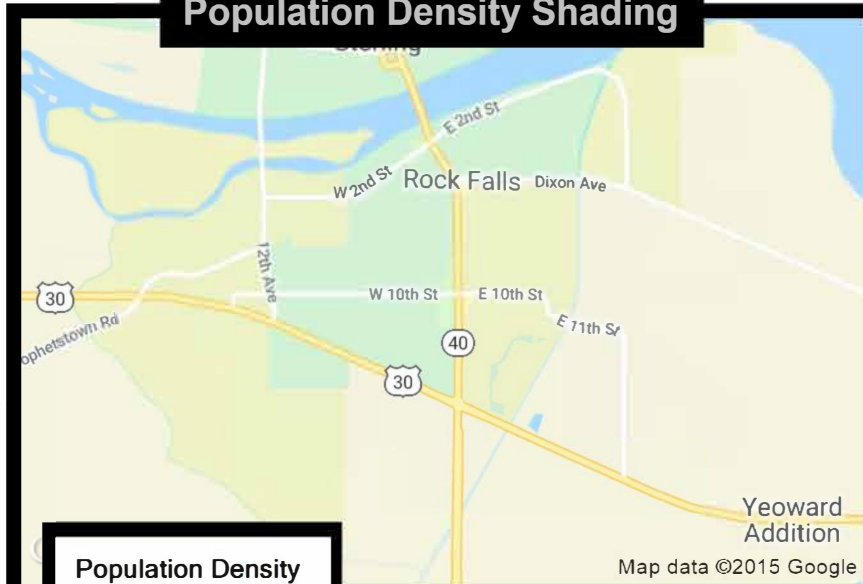

**Population Density**

By Blockgroups

- 7,500 or more
- 5,000 to 7,500
- 2,500 to 5,000
- 1,000 to 2,500
- Less than 1,000

**Demographic Data**

	1 mi radius	3 mi radius	5 mi radius
Population (2019)	7,250	27,487	31,439
Households (2019)	3,210	11,975	13,616
Median household income (2019)	\$49,763	\$51,977	\$55,488
Total Employees	3,190	12,639	16,625
Total Establishments	329	1,181	1,343

**JABE Companies**

James J Wilding Jr.  
412-606-9795  
jw@jabecompanies.com

This map was produced using data from private and government sources deemed to be reliable. The information herein is provided without representation or warranty.

# OVERALL BUILDING

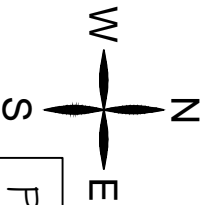
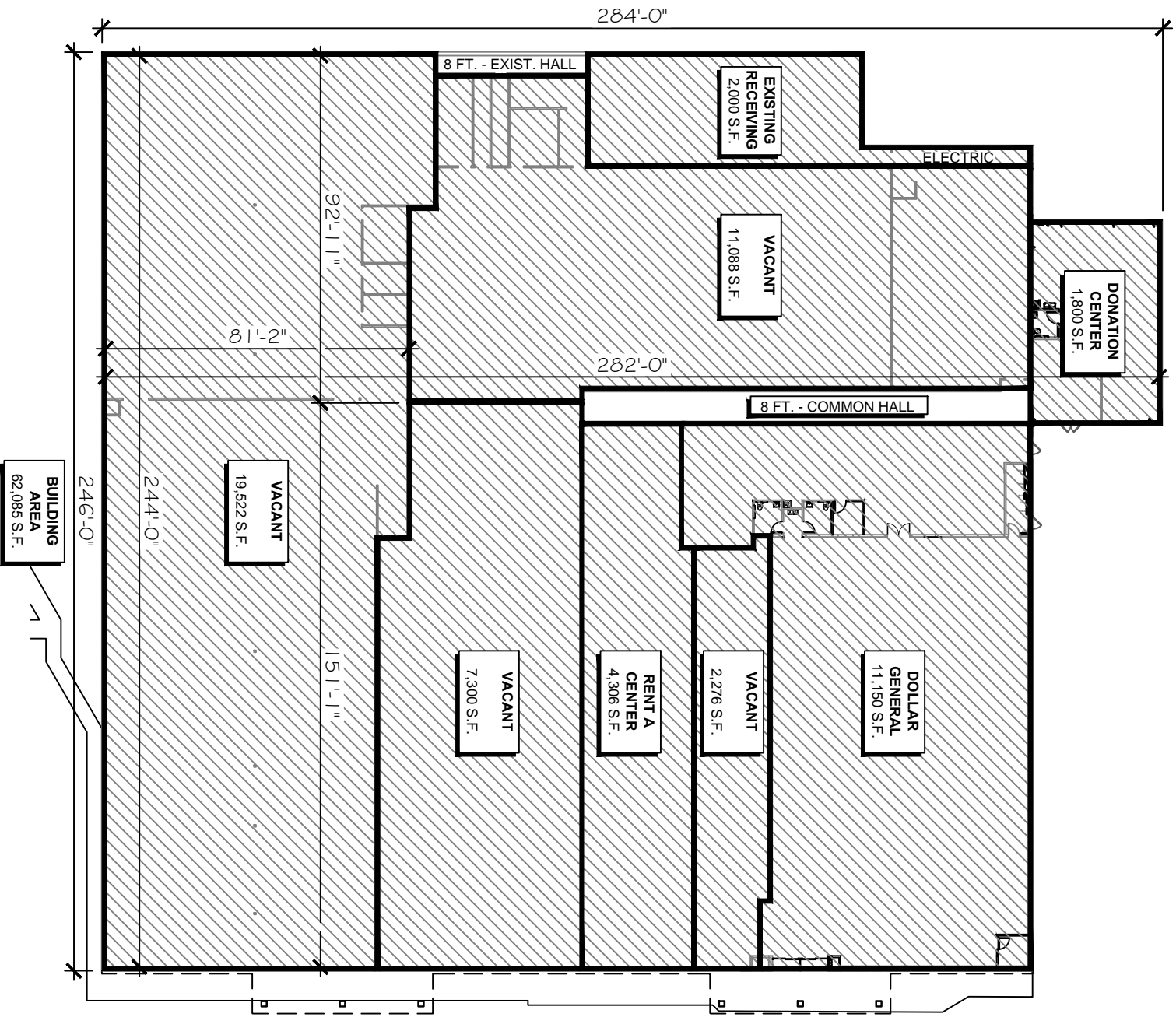

SCALE: 1" = 40'-0"

PRELIMINARY SITE PLAN		CITY, STATE - STREET: 5. FIRST AVE. ROCK FALLS, IL. 61071 WHITESIDE COUNTY	
AVAILABLE SPACE	DEVELOPER	DESIGNER	DATE:
TENANT: 12,873 SF	COMPANY: COCCA DEVELOPMENT	COMPANY: COCCA DEVELOPMENT	3 / 6 / 14
PROPOSED SUITE: 62,085 SF	NAME: ANTONY COCCA	NAME: BILL SCHROEDER	9 / 26 / 18
TOTAL BUILDING: -- ACRES	PHONE #: 330-729-1010	PHONE #: 330-729-1010	
SITE AREA: --			
PARKING SPACES: --			

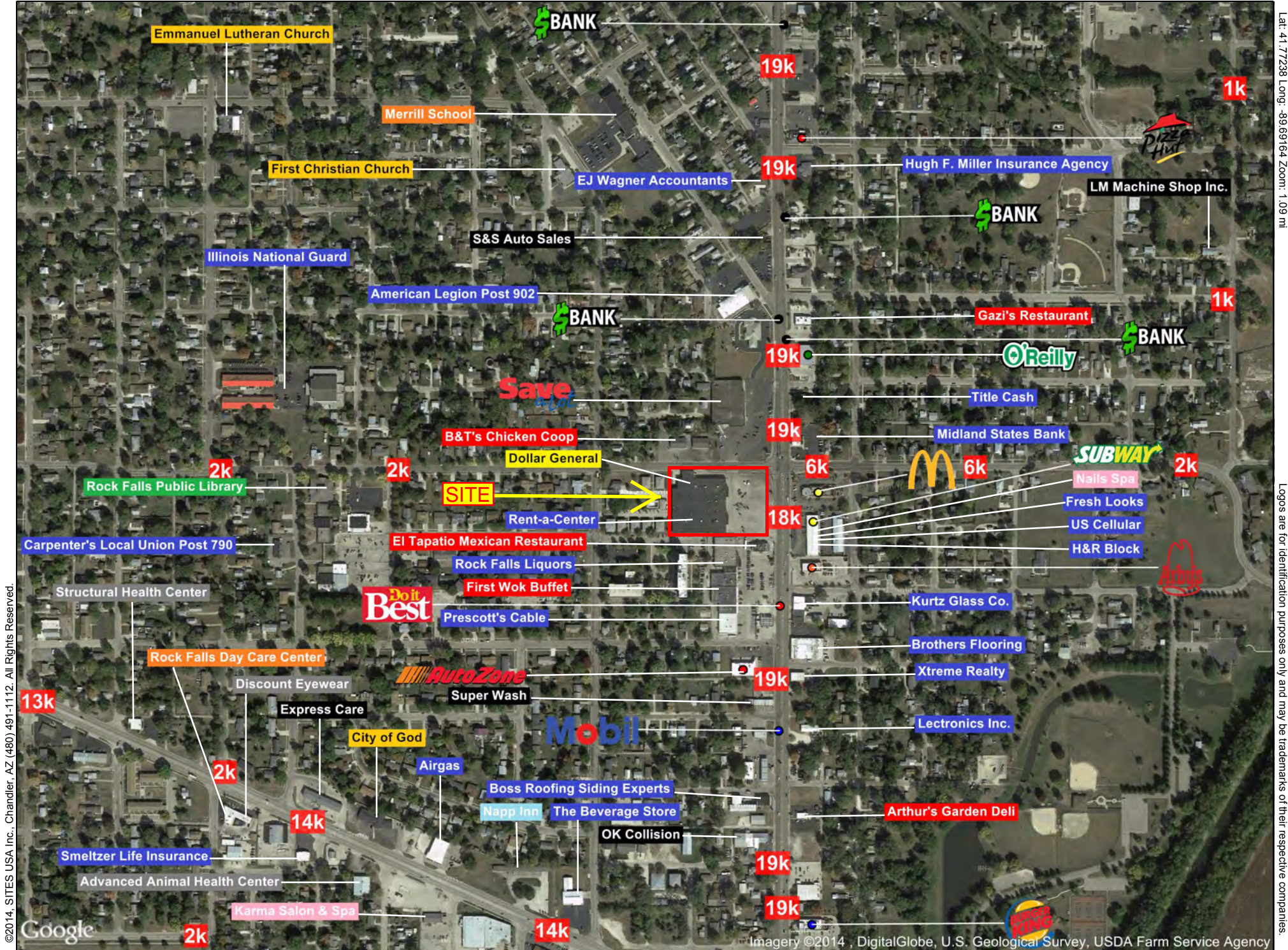

©2014, SITES USA Inc., Chandler, AZ (480) 491-1112. All Rights Reserved.

Lat: 41.77238 Long: -89.69164 Zoom: 1.09 m

Logos are for identification purposes only and may be trademarks of their respective companies.

This map was produced using data from private and government sources deemed to be reliable. The information herein is provided without representation or warranty

1002 1st Ave  
Rock Falls, IL 61071

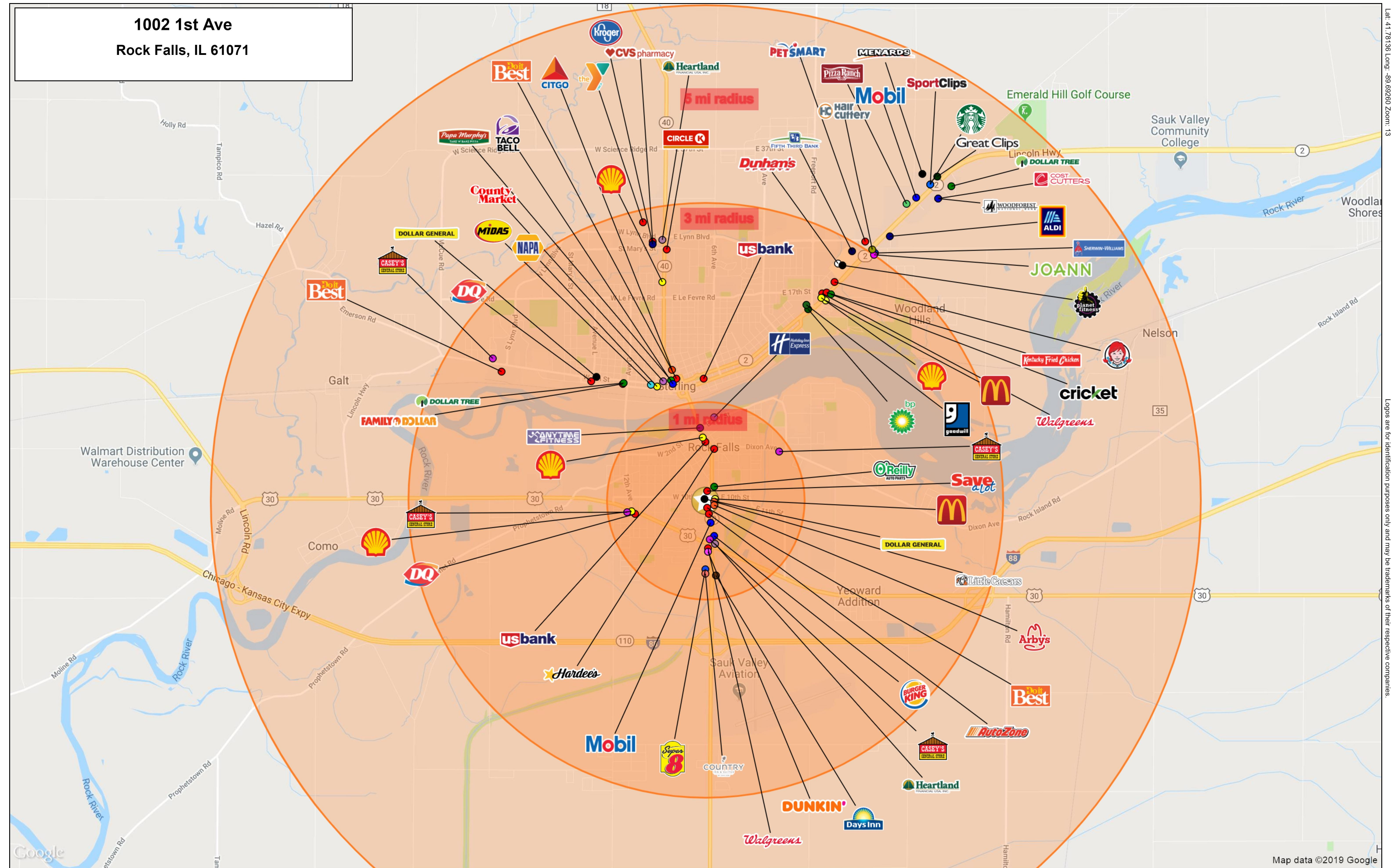

Lat: 41.78136 Long: -89.69250 Zoom: 13

Logos are for identification purposes only and may be trademarks of their respective companies.

# GRAPHIC PROFILE

2000-2010 Census, 2019 Estimates with 2024 Projections

Calculated using Weighted Block Centroid from Block Groups

Lat/Lon: 41.7719/-89.6906

RGRAP3

## 1002 1st Ave

### Rock Falls, IL 61071

1 mi radius

3 mi radius

5 mi radius

#### Population

Estimated Population (2019)	7,250	27,487	31,439
Projected Population (2024)	7,079	26,765	30,537
Census Population (2010)	7,931	29,314	33,420
Census Population (2000)	8,406	30,488	34,587
Projected Annual Growth (2019-2024)	-171 -0.5%	-722 -0.5%	-902 -0.6%
Historical Annual Growth (2010-2019)	-681 -1.0%	-1,827 -0.7%	-1,981 -0.7%
Historical Annual Growth (2000-2010)	-475 -0.6%	-1,174 -0.4%	-1,167 -0.3%
Estimated Population Density (2019)	2,309 <i>psm</i>	973 <i>psm</i>	400 <i>psm</i>
Trade Area Size	3.1 <i>sq mi</i>	28.3 <i>sq mi</i>	78.5 <i>sq mi</i>

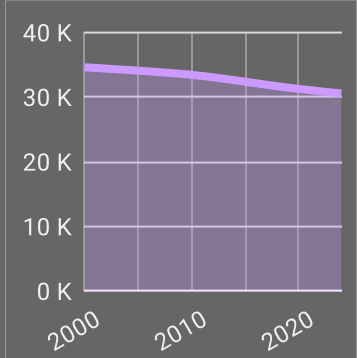
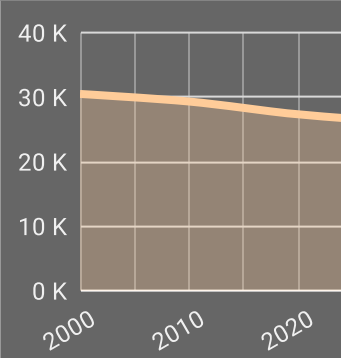
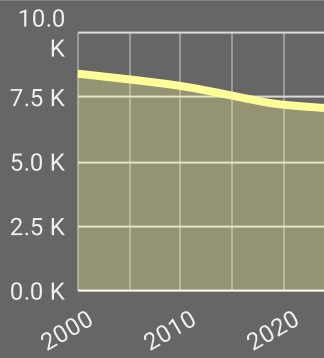

#### Race and Ethnicity (2019)

Not Hispanic or Latino Population	6,070 83.7%	21,755 79.1%	25,331 80.6%
White	5,754 94.8%	20,275 93.2%	23,721 93.6%
Black or African American	140 2.3%	800 3.7%	856 3.4%
American Indian or Alaska Native	14 0.2%	33 0.2%	41 0.2%
Asian	29 0.5%	175 0.8%	204 0.8%
Hawaiian or Pacific Islander	- -	- -	- -
Other Race	3 -	20 -	20 -
Two or More Races	131 2.2%	453 2.1%	488 1.9%
Hispanic or Latino Population	1,180 16.3%	5,732 20.9%	6,108 19.4%
White	795 67.4%	3,166 55.2%	3,417 55.9%
Black or African American	22 1.9%	117 2.0%	118 1.9%
American Indian or Alaska Native	16 1.3%	70 1.2%	74 1.2%
Asian	2 0.2%	9 0.2%	9 0.1%
Hispanic Hawaiian or Pacific Islander	5 0.4%	6 0.1%	6 -
Other Race	242 20.5%	1,810 31.6%	1,898 31.1%
Two or More Races	98 8.3%	555 9.7%	586 9.6%

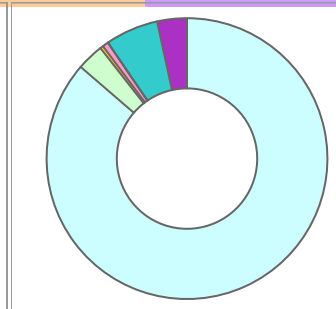
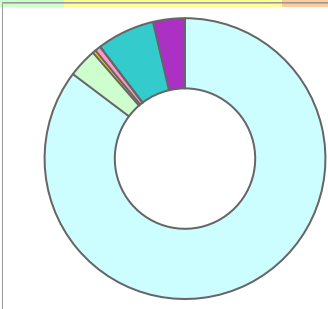
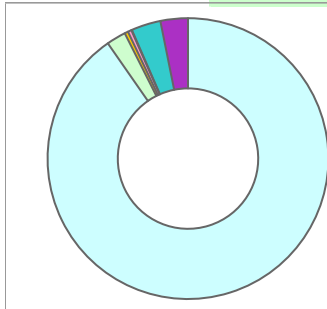

White Black or African American American Indian or Alaska Native Asian Hawaiian or Pacific Islander Other Race 2+ Races

This report was produced using data from private and government sources deemed to be reliable. The information herein is provided without representation or warranty.

# GRAPHIC PROFILE

2000-2010 Census, 2019 Estimates with 2024 Projections

Calculated using Weighted Block Centroid from Block Groups

Lat/Lon: 41.7719/-89.6906

RGRAP3

1002 1st Ave

Rock Falls, IL 61071

1 mi radius

3 mi radius

5 mi radius

## Age Distribution (2019)

Age Group	1 mi radius	3 mi radius	5 mi radius
Age Under 5 Years	486 6.7%	1,733 6.3%	1,914 6.1%
Age 5 to 9 Years	460 6.3%	1,719 6.3%	1,933 6.1%
Age 10 to 14 Years	448 6.2%	1,736 6.3%	1,981 6.3%
Age 15 to 19 Years	428 5.9%	1,705 6.2%	1,942 6.2%
Age 20 to 24 Years	486 6.7%	1,830 6.7%	1,990 6.3%
Age 25 to 29 Years	476 6.6%	1,758 6.4%	1,924 6.1%
Age 30 to 34 Years	438 6.0%	1,646 6.0%	1,836 5.8%
Age 35 to 39 Years	408 5.6%	1,571 5.7%	1,782 5.7%
Age 40 to 44 Years	410 5.6%	1,510 5.5%	1,717 5.5%
Age 45 to 49 Years	427 5.9%	1,612 5.9%	1,857 5.9%
Age 50 to 54 Years	459 6.3%	1,659 6.0%	1,945 6.2%
Age 55 to 59 Years	503 6.9%	1,848 6.7%	2,197 7.0%
Age 60 to 64 Years	493 6.8%	1,821 6.6%	2,163 6.9%
Age 65 to 69 Years	434 6.0%	1,593 5.8%	1,873 6.0%
Age 70 to 74 Years	325 4.5%	1,240 4.5%	1,478 4.7%
Age 75 to 79 Years	224 3.1%	999 3.6%	1,152 3.7%
Age 80 to 84 Years	168 2.3%	710 2.6%	811 2.6%
Age 85 Years or Over	177 2.4%	797 2.9%	944 3.0%
Median Age	39.0	39.6	40.6

## Generation (2019)

Generation	1 mi radius	3 mi radius	5 mi radius
iGeneration (Age Under 15 Years)	1,394 19.2%	5,188 18.9%	5,828 18.5%
Generation 9/11 Millennials (Age 15 to 34 Years)	1,828 25.2%	6,938 25.2%	7,692 24.5%
Gen Xers (Age 35 to 49 Years)	1,245 17.2%	4,693 17.1%	5,356 17.0%
Baby Boomers (Age 50 to 74 Years)	2,215 30.5%	8,161 29.7%	9,656 30.7%
Silent Generation (Age 75 to 84 Years)	391 5.4%	1,709 6.2%	1,963 6.2%
G.I. Generation (Age 85 Years or Over)	177 2.4%	797 2.9%	944 3.0%

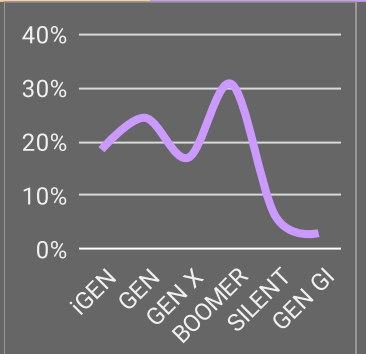
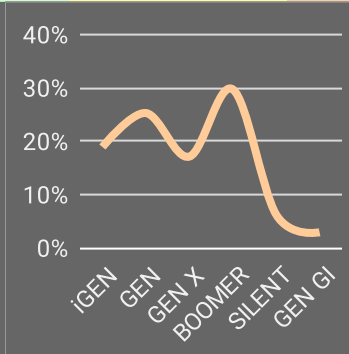
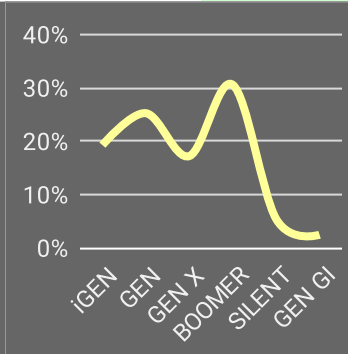

This report was produced using data from private and government sources deemed to be reliable. The information herein is provided without representation or warranty.

# GRAPHIC PROFILE

2000-2010 Census, 2019 Estimates with 2024 Projections

Calculated using Weighted Block Centroid from Block Groups

Lat/Lon: 41.7719/-89.6906

RGRAP3

## 1002 1st Ave

### Rock Falls, IL 61071

1 mi radius

3 mi radius

5 mi radius

#### Household Type (2019)

	1 mi radius	3 mi radius	5 mi radius
Total Households	3,210	11,975	13,616
Family Households	1,911 59.5%	7,330 61.2%	8,498 62.4%
Family Households with Children	914 47.8%	3,461 47.2%	3,880 45.7%
Family Households No Children	997 52.2%	3,869 52.8%	4,619 54.3%
Non-Family Households	1,298 40.5%	4,645 38.8%	5,117 37.6%
Non-Family Households with Children	18 1.4%	67 1.4%	76 1.5%
Non-Family Households No Children	1,280 98.6%	4,579 98.6%	5,041 98.5%

- Family Households with Children
- Family Households No Children
- Non-Family Households with Children
- Non-Family Households No Children

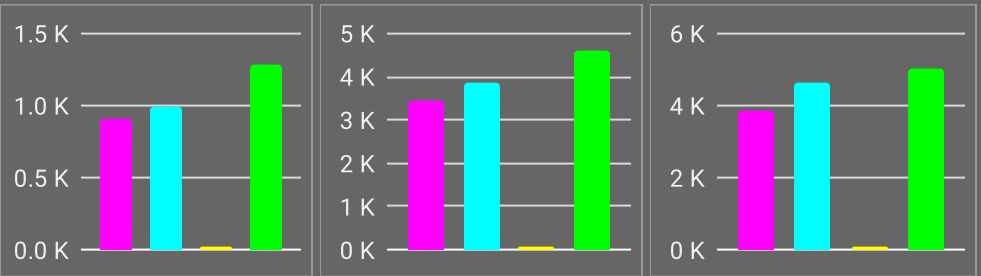

#### Education Attainment (2019)

	1 mi radius	3 mi radius	5 mi radius
Elementary or Some High School	770 15.6%	2,447 13.0%	2,656 12.3%
High School Graduate	2,059 41.7%	6,690 35.7%	7,512 34.7%
Some College or Associate Degree	1,646 33.3%	6,694 35.7%	7,841 36.2%
Bachelor or Graduate Degree	467 9.4%	2,933 15.6%	3,670 16.9%

- Elementary or Some High School
- High School Graduate
- Some College or Associate Degree
- Bachelor or Graduate Degree

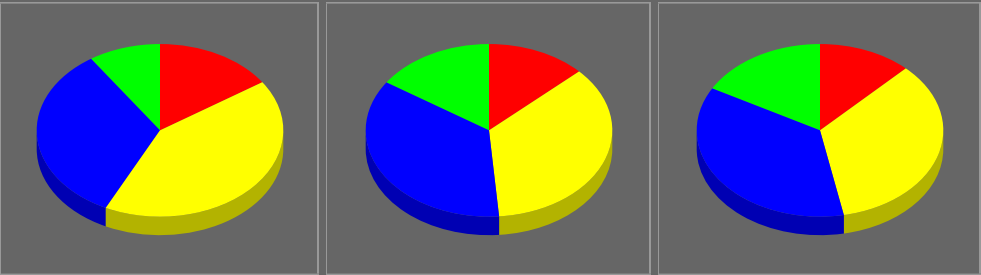

#### Household Income (2019)

	1 mi radius	3 mi radius	5 mi radius
Estimated Average Household Income	\$58,201	\$67,279	\$71,755
Estimated Median Household Income	\$49,763	\$51,977	\$55,488
HH Income Under \$10,000	200 6.2%	573 4.8%	608 4.5%
HH Income \$10,000 to \$34,999	966 30.1%	3,618 30.2%	3,890 28.6%
HH Income \$35,000 to \$49,999	533 16.6%	1,730 14.4%	1,889 13.9%
HH Income \$50,000 to \$74,999	758 23.6%	2,631 22.0%	2,959 21.7%
HH Income \$75,000 to \$99,999	498 15.5%	1,737 14.5%	2,015 14.8%
HH Income \$100,000 to \$149,999	159 5.0%	955 8.0%	1,267 9.3%
HH Income \$150,000 or More	97 3.0%	730 6.1%	988 7.3%

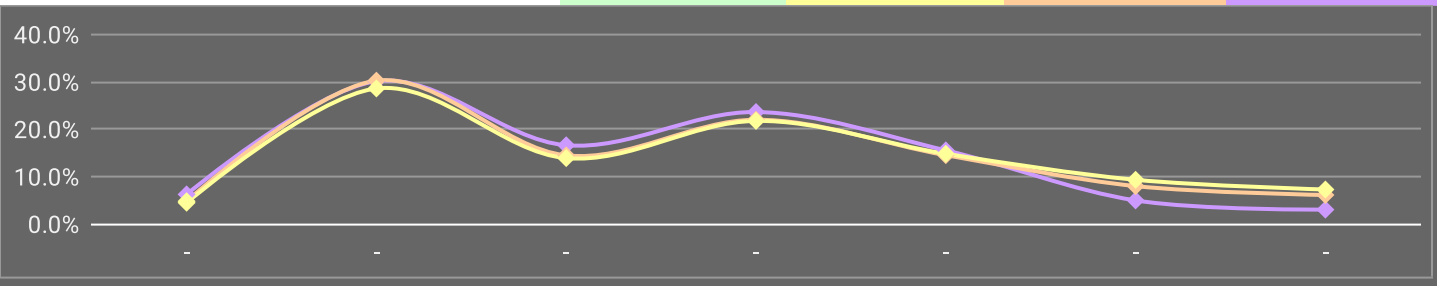

This report was produced using data from private and government sources deemed to be reliable. The information herein is provided without representation or warranty.

# EXPANDED PROFILE

2000-2010 Census, 2019 Estimates with 2024 Projections

Calculated using Weighted Block Centroid from Block Groups

Lat/Lon: 41.7719/-89.6906

RF5

## 1002 1st Ave

## Rock Falls, IL 61071

### Population

	1 mi radius		3 mi radius		5 mi radius	
Estimated Population (2019)	7,250		27,487		31,439	
Projected Population (2024)	7,079		26,765		30,537	
Census Population (2010)	7,931		29,314		33,420	
Census Population (2000)	8,406		30,488		34,587	
Projected Annual Growth (2019 to 2024)	-171	-0.5%	-722	-0.5%	-902	-0.6%
Historical Annual Growth (2010 to 2019)	-681	-1.0%	-1,827	-0.7%	-1,981	-0.7%
Historical Annual Growth (2000 to 2010)	-475	-0.6%	-1,174	-0.4%	-1,167	-0.3%
Estimated Population Density (2019)	2,309 psm		973 psm		400 psm	
Trade Area Size	3.1 sq mi		28.3 sq mi		78.5 sq mi	

### Households

Estimated Households (2019)	3,210		11,975		13,616	
Projected Households (2024)	3,242		12,059		13,672	
Census Households (2010)	3,300		12,008		13,608	
Census Households (2000)	3,437		12,248		13,727	
Estimated Households with Children (2019)	933	29.1%	3,527	29.5%	3,955	29.1%
Estimated Average Household Size (2019)	2.25		2.26		2.27	

### Average Household Income

Estimated Average Household Income (2019)	\$58,201		\$67,279		\$71,755	
Projected Average Household Income (2024)	\$69,192		\$81,480		\$87,936	
Estimated Average Family Income (2019)	\$66,834		\$81,231		\$86,761	

### Median Household Income

Estimated Median Household Income (2019)	\$49,763		\$51,977		\$55,488	
Projected Median Household Income (2024)	\$57,442		\$60,697		\$64,602	
Estimated Median Family Income (2019)	\$55,888		\$65,057		\$69,267	

### Per Capita Income

Estimated Per Capita Income (2019)	\$25,798		\$29,402		\$31,171	
Projected Per Capita Income (2024)	\$31,726		\$36,805		\$39,470	
Estimated Per Capita Income 5 Year Growth	\$5,928	23.0%	\$7,403	25.2%	\$8,299	26.6%
Estimated Average Household Net Worth (2019)	\$268,121		\$372,208		\$412,271	

### Daytime Demos (2019)

Total Businesses	329		1,181		1,343	
Total Employees	3,190		12,639		16,625	
Company Headquarter Businesses	5	1.4%	11	0.9%	14	1.1%
Company Headquarter Employees	161	5.0%	1,537	12.2%	1,787	10.8%
Employee Population per Business	9.7		10.7		12.4	
Residential Population per Business	22.0		23.3		23.4	

This report was produced using data from private and government sources deemed to be reliable. The information herein is provided without representation or warranty.



# EXPANDED PROFILE

2000-2010 Census, 2019 Estimates with 2024 Projections

Calculated using Weighted Block Centroid from Block Groups

Lat/Lon: 41.7719/-89.6906

RF5

## 1002 1st Ave

### Rock Falls, IL 61071

#### Race & Ethnicity

	1 mi radius		3 mi radius		5 mi radius	
White (2019)	6,549	90.3%	23,440	85.3%	27,139	86.3%
Black or African American (2019)	162	2.2%	916	3.3%	974	3.1%
American Indian or Alaska Native (2019)	29	0.4%	103	0.4%	115	0.4%
Asian (2019)	31	0.4%	184	0.7%	213	0.7%
Hawaiian or Pacific Islander (2019)	5	-	6	-	6	-
Other Race (2019)	246	3.4%	1,830	6.7%	1,918	6.1%
Two or More Races (2019)	229	3.2%	1,007	3.7%	1,075	3.4%
Not Hispanic or Latino Population (2019)	6,070	83.7%	21,755	79.1%	25,331	80.6%
Hispanic or Latino Population (2019)	1,180	16.3%	5,732	20.9%	6,108	19.4%
Not Hispanic or Latino Population (2024)	5,871	82.9%	20,872	78.0%	24,266	79.5%
Hispanic or Latino Population (2024)	1,208	17.1%	5,893	22.0%	6,271	20.5%
Not Hispanic or Latino Population (2010)	6,740	85.0%	23,806	81.2%	27,585	82.5%
Hispanic or Latino Population (2010)	1,191	15.0%	5,509	18.8%	5,835	17.5%
Not Hispanic or Latino Population (2000)	7,405	88.1%	25,890	84.9%	29,714	85.9%
Hispanic or Latino Population (2000)	1,001	11.9%	4,598	15.1%	4,873	14.1%
Projected Hispanic Annual Growth (2019 to 2024)	28	0.5%	161	0.6%	163	0.5%
Historic Hispanic Annual Growth (2000 to 2019)	179	0.9%	1,134	1.3%	1,235	1.3%

#### Age Distribution (2019)

Age Under 5	486	6.7%	1,733	6.3%	1,914	6.1%
Age 5 to 9 Years	460	6.3%	1,719	6.3%	1,933	6.1%
Age 10 to 14 Years	448	6.2%	1,736	6.3%	1,981	6.3%
Age 15 to 19 Years	428	5.9%	1,705	6.2%	1,942	6.2%
Age 20 to 24 Years	486	6.7%	1,830	6.7%	1,990	6.3%
Age 25 to 29 Years	476	6.6%	1,758	6.4%	1,924	6.1%
Age 30 to 34 Years	438	6.0%	1,646	6.0%	1,836	5.8%
Age 35 to 39 Years	408	5.6%	1,571	5.7%	1,782	5.7%
Age 40 to 44 Years	410	5.6%	1,510	5.5%	1,717	5.5%
Age 45 to 49 Years	427	5.9%	1,612	5.9%	1,857	5.9%
Age 50 to 54 Years	459	6.3%	1,659	6.0%	1,945	6.2%
Age 55 to 59 Years	503	6.9%	1,848	6.7%	2,197	7.0%
Age 60 to 64 Years	493	6.8%	1,821	6.6%	2,163	6.9%
Age 65 to 74 Years	759	10.5%	2,832	10.3%	3,351	10.7%
Age 75 to 84 Years	391	5.4%	1,709	6.2%	1,963	6.2%
Age 85 Years or Over	177	2.4%	797	2.9%	944	3.0%
Median Age	39.0		39.6		40.6	

#### Gender Age Distribution (2019)

Female Population	3,684	50.8%	14,091	51.3%	16,068	51.1%
Age 0 to 19 Years	876	23.8%	3,385	24.0%	3,808	23.7%
Age 20 to 64 Years	2,064	56.0%	7,627	54.1%	8,697	54.1%
Age 65 Years or Over	743	20.2%	3,079	21.9%	3,563	22.2%
Female Median Age	40.4		41.4		42.2	
Male Population	3,566	49.2%	13,396	48.7%	15,371	48.9%
Age 0 to 19 Years	947	26.5%	3,508	26.2%	3,962	25.8%
Age 20 to 64 Years	2,036	57.1%	7,629	56.9%	8,714	56.7%
Age 65 Years or Over	584	16.4%	2,259	16.9%	2,695	17.5%
Male Median Age	37.6		37.8		38.9	

This report was produced using data from private and government sources deemed to be reliable. The information herein is provided without representation or warranty.

# EXPANDED PROFILE

2000-2010 Census, 2019 Estimates with 2024 Projections

Calculated using Weighted Block Centroid from Block Groups

Lat/Lon: 41.7719/-89.6906

RF5

## 1002 1st Ave

### Rock Falls, IL 61071

#### Household Income Distribution (2019)

	1 mi radius		3 mi radius		5 mi radius	
HH Income \$200,000 or More	53	1.7%	403	3.4%	537	3.9%
HH Income \$150,000 to \$199,999	43	1.3%	328	2.7%	451	3.3%
HH Income \$100,000 to \$149,999	159	5.0%	955	8.0%	1,267	9.3%
HH Income \$75,000 to \$99,999	498	15.5%	1,737	14.5%	2,015	14.8%
HH Income \$50,000 to \$74,999	758	23.6%	2,631	22.0%	2,959	21.7%
HH Income \$35,000 to \$49,999	533	16.6%	1,730	14.4%	1,889	13.9%
HH Income \$25,000 to \$34,999	333	10.4%	1,443	12.0%	1,558	11.4%
HH Income \$15,000 to \$24,999	424	13.2%	1,601	13.4%	1,731	12.7%
HH Income Under \$15,000	410	12.8%	1,147	9.6%	1,209	8.9%
HH Income \$35,000 or More	2,043	63.7%	7,784	65.0%	9,118	67.0%
HH Income \$75,000 or More	753	23.5%	3,422	28.6%	4,270	31.4%

#### Housing (2019)

	1 mi radius		3 mi radius		5 mi radius	
Total Housing Units	3,494		12,975		14,732	
Housing Units Occupied	3,210	91.8%	11,975	92.3%	13,616	92.4%
Housing Units Owner-Occupied	2,004	62.4%	7,901	66.0%	9,329	68.5%
Housing Units, Renter-Occupied	1,206	37.6%	4,073	34.0%	4,286	31.5%
Housing Units, Vacant	285	8.9%	1,000	8.4%	1,117	8.2%

#### Marital Status (2019)

	1 mi radius		3 mi radius		5 mi radius	
Never Married	1,887	32.2%	6,820	30.6%	7,552	29.5%
Currently Married	2,336	39.9%	9,440	42.3%	11,363	44.4%
Separated	266	4.5%	905	4.1%	963	3.8%
Widowed	424	7.2%	1,729	7.8%	2,022	7.9%
Divorced	942	16.1%	3,404	15.3%	3,712	14.5%

#### Household Type (2019)

	1 mi radius		3 mi radius		5 mi radius	
Population Family	5,694	78.5%	21,664	78.8%	24,947	79.4%
Population Non-Family	1,527	21.1%	5,403	19.7%	5,960	19.0%
Population Group Quarters	29	0.4%	420	1.5%	532	1.7%
Family Households	1,911	59.5%	7,330	61.2%	8,498	62.4%
Non-Family Households	1,298	40.5%	4,645	38.8%	5,117	37.6%
Married Couple with Children	448	19.2%	1,855	19.6%	2,173	19.1%
Average Family Household Size	3.0		3.0		2.9	

#### Household Size (2019)

	1 mi radius		3 mi radius		5 mi radius	
1 Person Households	1,117	34.8%	4,035	33.7%	4,443	32.6%
2 Person Households	1,048	32.6%	4,105	34.3%	4,827	35.4%
3 Person Households	454	14.2%	1,603	13.4%	1,801	13.2%
4 Person Households	326	10.1%	1,260	10.5%	1,442	10.6%
5 Person Households	179	5.6%	625	5.2%	708	5.2%
6 or More Person Households	87	2.7%	348	2.9%	395	2.9%

#### Household Vehicles (2019)

	1 mi radius		3 mi radius		5 mi radius	
Households with 0 Vehicles Available	366	11.4%	1,216	10.2%	1,285	9.4%
Households with 1 Vehicles Available	1,364	42.5%	4,643	38.8%	5,028	36.9%
Households with 2 or More Vehicles Available	1,480	46.1%	6,116	51.1%	7,302	53.6%
Total Vehicles Available	4,928		19,890		23,399	
Average Vehicles Per Household	1.5		1.7		1.7	

This report was produced using data from private and government sources deemed to be reliable. The information herein is provided without representation or warranty.

# EXPANDED PROFILE

2000-2010 Census, 2019 Estimates with 2024 Projections

Calculated using Weighted Block Centroid from Block Groups

Lat/Lon: 41.7719/-89.6906

RF5

## 1002 1st Ave

### Rock Falls, IL 61071

#### Labor Force (2019)

	1 mi radius		3 mi radius		5 mi radius	
Estimated Labor Population Age 16 Years or Over	5,768		21,971		25,233	
Estimated Civilian Employed	3,414	59.2%	12,926	58.8%	14,805	58.7%
Estimated Civilian Unemployed	246	4.3%	610	2.8%	658	2.6%
Estimated in Armed Forces	1	-	36	0.2%	36	0.1%
Estimated Not in Labor Force	2,106	36.5%	8,399	38.2%	9,734	38.6%
Unemployment Rate	4.3%		2.8%		2.6%	

#### Occupation (2019)

	1 mi radius		3 mi radius		5 mi radius	
Occupation: Population Age 16 Years or Over	3,414		12,926		14,805	
Management, Business, Financial Operations	200	5.8%	1,011	7.8%	1,280	8.6%
Professional, Related	337	9.9%	2,044	15.8%	2,461	16.6%
Service	815	23.9%	2,573	19.9%	2,844	19.2%
Sales, Office	757	22.2%	3,226	25.0%	3,709	25.1%
Farming, Fishing, Forestry	14	0.4%	93	0.7%	98	0.7%
Construct, Extraction, Maintenance	247	7.2%	779	6.0%	944	6.4%
Production, Transport Material Moving	1,044	30.6%	3,201	24.8%	3,469	23.4%
White Collar Workers	1,294	37.9%	6,280	48.6%	7,450	50.3%
Blue Collar Workers	2,120	62.1%	6,646	51.4%	7,355	49.7%

#### Consumer Expenditure (2019)

	1 mi radius		3 mi radius		5 mi radius	
Total Household Expenditure	\$155.27 M		\$637.57 M		\$756.13 M	
Total Non-Retail Expenditure	\$81.98 M	52.8%	\$336.63 M	52.8%	\$399.1 M	52.8%
Total Retail Expenditure	\$73.29 M	47.2%	\$300.94 M	47.2%	\$357.03 M	47.2%
Apparel	\$5.33 M	3.4%	\$22.02 M	3.5%	\$26.17 M	3.5%
Contributions	\$4.79 M	3.1%	\$20.21 M	3.2%	\$24.21 M	3.2%
Education	\$4.06 M	2.6%	\$17.35 M	2.7%	\$20.89 M	2.8%
Entertainment	\$8.48 M	5.5%	\$35.25 M	5.5%	\$42.05 M	5.6%
Food and Beverages	\$23.22 M	15.0%	\$94.73 M	14.9%	\$112.06 M	14.8%
Furnishings and Equipment	\$5.28 M	3.4%	\$21.95 M	3.4%	\$26.17 M	3.5%
Gifts	\$3.55 M	2.3%	\$15.03 M	2.4%	\$18.01 M	2.4%
Health Care	\$13.69 M	8.8%	\$55.77 M	8.7%	\$65.93 M	8.7%
Household Operations	\$5.99 M	3.9%	\$24.81 M	3.9%	\$29.51 M	3.9%
Miscellaneous Expenses	\$2.92 M	1.9%	\$12.03 M	1.9%	\$14.29 M	1.9%
Personal Care	\$2.08 M	1.3%	\$8.54 M	1.3%	\$10.14 M	1.3%
Personal Insurance	\$1 M	0.6%	\$4.26 M	0.7%	\$5.13 M	0.7%
Reading	\$338.23 K	0.2%	\$1.4 M	0.2%	\$1.66 M	0.2%
Shelter	\$33.01 M	21.3%	\$134.91 M	21.2%	\$159.59 M	21.1%
Tobacco	\$1.1 M	0.7%	\$4.28 M	0.7%	\$4.96 M	0.7%
Transportation	\$28.17 M	18.1%	\$115.79 M	18.2%	\$137.47 M	18.2%
Utilities	\$12.25 M	7.9%	\$49.25 M	7.7%	\$57.9 M	7.7%

#### Educational Attainment (2019)

	1 mi radius		3 mi radius		5 mi radius	
Adult Population Age 25 Years or Over	4,941		18,764		21,679	
Elementary (Grade Level 0 to 8)	301	6.1%	983	5.2%	1,085	5.0%
Some High School (Grade Level 9 to 11)	469	9.5%	1,464	7.8%	1,571	7.2%
High School Graduate	2,059	41.7%	6,690	35.7%	7,512	34.7%
Some College	1,208	24.5%	4,950	26.4%	5,792	26.7%
Associate Degree Only	438	8.9%	1,744	9.3%	2,049	9.4%
Bachelor Degree Only	308	6.2%	1,842	9.8%	2,256	10.4%
Graduate Degree	158	3.2%	1,091	5.8%	1,414	6.5%

This report was produced using data from private and government sources deemed to be reliable. The information herein is provided without representation or warranty.

# EXPANDED PROFILE

2000-2010 Census, 2019 Estimates with 2024 Projections

Calculated using Weighted Block Centroid from Block Groups

Lat/Lon: 41.7719/-89.6906

RF5

## 1002 1st Ave

### Rock Falls, IL 61071

#### Units In Structure (2019)

	1 mi radius		3 mi radius		5 mi radius	
1 Detached Unit	2,483	75.3%	8,869	73.9%	10,324	75.9%
1 Attached Unit	64	1.9%	318	2.6%	338	2.5%
2 to 4 Units	217	6.6%	1,061	8.8%	1,085	8.0%
5 to 9 Units	145	4.4%	492	4.1%	519	3.8%
10 to 19 Units	21	0.6%	212	1.8%	218	1.6%
20 to 49 Units	27	0.8%	156	1.3%	179	1.3%
50 or More Units	208	6.3%	537	4.5%	577	4.2%
Mobile Home or Trailer	43	1.3%	324	2.7%	371	2.7%
Other Structure	1	-	5	-	5	-

#### Homes Built By Year (2019)

Homes Built 2010 or later	12	0.4%	146	1.2%	177	1.3%
Homes Built 2000 to 2009	115	3.5%	722	6.0%	907	6.7%
Homes Built 1990 to 1999	110	3.3%	815	6.8%	1,022	7.5%
Homes Built 1980 to 1989	225	6.8%	680	5.7%	854	6.3%
Homes Built 1970 to 1979	578	17.5%	1,939	16.1%	2,322	17.1%
Homes Built 1960 to 1969	508	15.4%	2,071	17.2%	2,315	17.0%
Homes Built 1950 to 1959	609	18.5%	2,192	18.3%	2,402	17.6%
Homes Built Before 1949	1,051	31.8%	3,410	28.4%	3,617	26.6%

#### Home Values (2019)

Home Values \$1,000,000 or More	-	-	-	-	1	-
Home Values \$500,000 to \$999,999	9	0.4%	117	1.5%	136	1.5%
Home Values \$400,000 to \$499,999	3	0.1%	40	0.5%	64	0.7%
Home Values \$300,000 to \$399,999	15	0.7%	233	2.9%	320	3.4%
Home Values \$200,000 to \$299,999	29	1.4%	395	5.0%	679	7.3%
Home Values \$150,000 to \$199,999	76	3.6%	685	8.6%	965	10.3%
Home Values \$100,000 to \$149,999	225	10.9%	1,358	17.1%	1,707	18.3%
Home Values \$70,000 to \$99,999	789	38.1%	2,694	33.9%	2,933	31.4%
Home Values \$50,000 to \$69,999	504	24.3%	1,422	17.9%	1,501	16.1%
Home Values \$25,000 to \$49,999	305	14.7%	703	8.8%	736	7.9%
Home Values Under \$25,000	39	1.9%	242	3.0%	274	2.9%
Owner-Occupied Median Home Value	\$76,606		\$91,988		\$100,879	
Renter-Occupied Median Rent	\$476		\$518		\$521	

#### Transportation To Work (2019)

Drive to Work Alone	2,831	81.4%	10,865	82.9%	12,514	83.6%
Drive to Work in Carpool	383	11.0%	1,369	10.4%	1,487	9.9%
Travel to Work by Public Transportation	14	0.4%	77	0.6%	79	0.5%
Drive to Work on Motorcycle	-	-	10	-	10	-
Walk or Bicycle to Work	117	3.4%	348	2.7%	363	2.4%
Other Means	64	1.8%	159	1.2%	174	1.2%
Work at Home	67	1.9%	282	2.1%	350	2.3%

#### Travel Time (2019)

Travel to Work in 14 Minutes or Less	1,694	48.7%	7,009	53.5%	7,865	52.5%
Travel to Work in 15 to 29 Minutes	1,073	30.9%	3,690	28.1%	4,342	29.0%
Travel to Work in 30 to 59 Minutes	374	10.8%	1,341	10.2%	1,499	10.0%
Travel to Work in 60 Minutes or More	209	6.0%	603	4.6%	752	5.0%
Average Minutes Travel to Work	14.1		13.3		13.4	

This report was produced using data from private and government sources deemed to be reliable. The information herein is provided without representation or warranty.