



# 254 Park Avenue South

Northwest corner of 20th street

## Former Duane Reade Available for Sublease

### Space

Ground Floor: 3,646 sf

Lower Level: 5,981 sf

Total: 9,627 sf

### Frontage

126' on East 20th Street

39' on Park Avenue South

### Possession

Immediate

### Term

Through 1/31/2026

### Asking Rent

\$475,000 per annum gross

### Highlights

- Selling lower level
- Located in Flatiron between Madison Square Park and Union Square
- Anchoring the base of a luxury residential building
- Area includes mixture of office and residential population supporting day-time and nighttime traffic
- Steps from subway access **6 N Q R**

### Neighbors



Former Duane Reade store #14435



Michael Riley

+1 212 812 5901

Michael.Riley@am.jll.com

Patrick A. Smith

+1 212 812 5888

PatrickA.Smith@am.jll.com

# 254 Park Avenue South

## Ground Floor

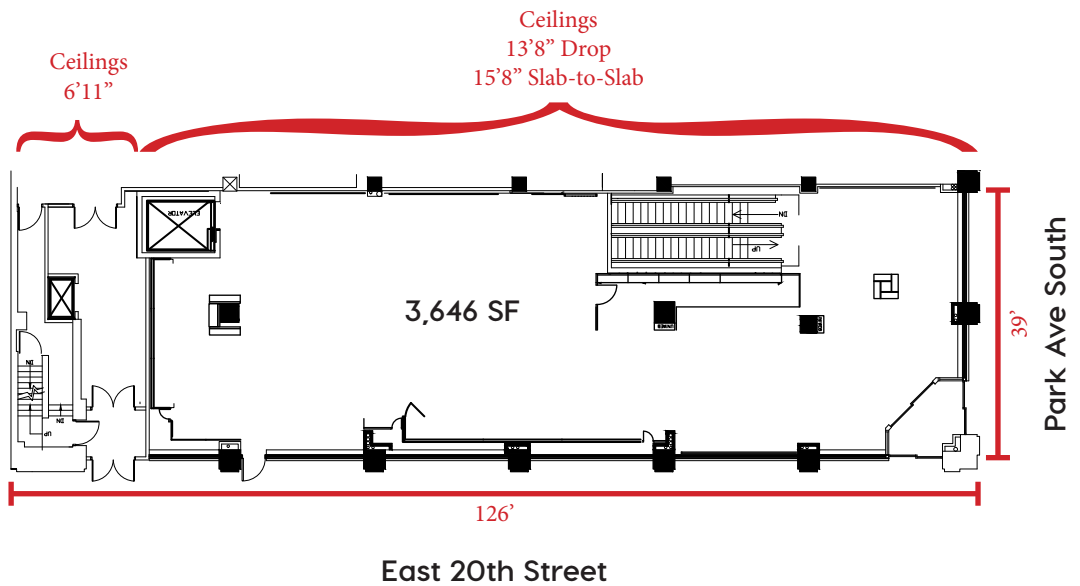

## Lower Level

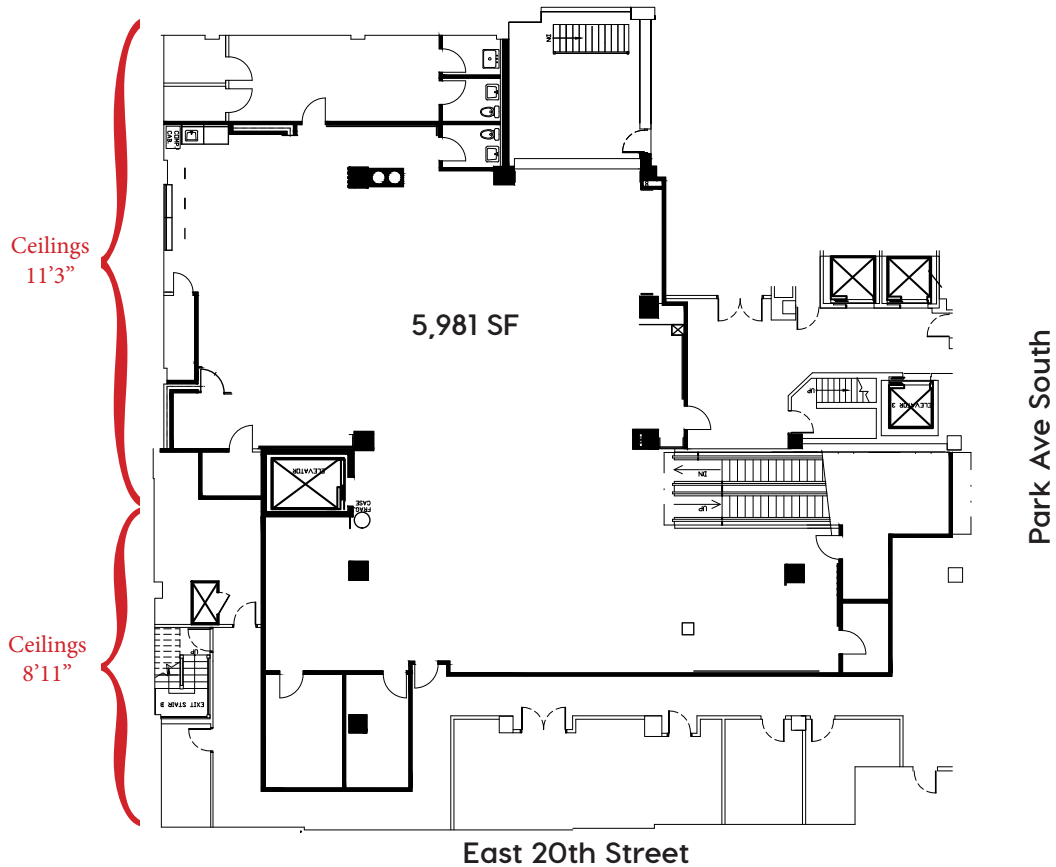

# 254 Park Avenue South



Jones Lang LaSalle Brokerage, Inc. | 330 Madison Avenue New York, NY 10017  
DISCLAIMER

Although information has been obtained from sources deemed reliable, neither Owner nor JLL makes any guarantees, warranties or representations, express or implied, as to the completeness or accuracy as to the information contained herein. Any projections, opinions, assumptions or estimates used are for example only. There may be differences between projected and actual results, and those differences may be material. The Property may be withdrawn without notice. Neither Owner nor JLL accepts any liability for any loss or damage suffered by any party resulting from reliance on this information. If the recipient of this information has signed a confidentiality agreement regarding this matter, this information is subject to the terms of that agreement.

©2021 Jones Lang LaSalle IP, Inc. All rights reserved.

