

Orlando Central Park

2100 Premier Row
Orlando, FL 32809

±7,000 SF Total | Two Dock High Doors | One Ramp Door | Six Auto Parking Spaces



DOES NOT
INCLUDE
YARD/IOS



Asking: \$12,000/Month Modified Gross

SUITE FEATURE

- + ±7,000 SF Total
- + Two (2) Dock High Doors
- + One (1) Ramp Door
- + New LED Warehouse Lights
- + Spec Office TBD
- + 10' x 10' Loading Doors
- + 16' Clear Height
- + 3-Phase Power

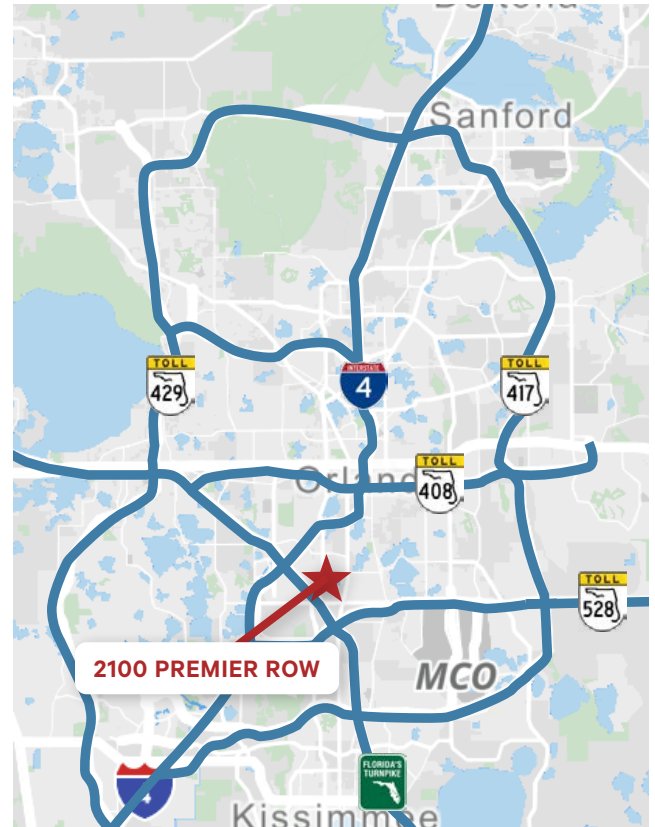
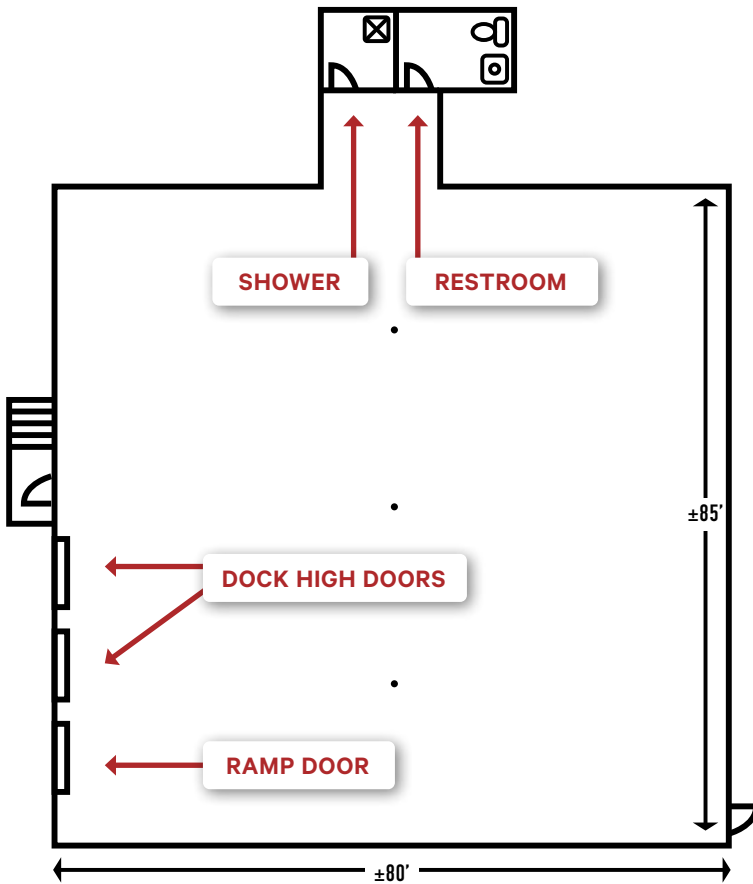

Cameron Thomas

Senior Associate
407 404 5078
cameron.thomas@cbre.com

Alex Eastwood

Senior Associate
407 404 5074
alex.eastwood@cbre.com

Jose Rivera

Associate
407 404 5067
jose.rivera1@cbre.com

© 2026 CBRE, Inc. All rights reserved. This information has been obtained from sources believed reliable, but has not been verified for accuracy or completeness. You should conduct a careful, independent investigation of the property and verify all information. Any reliance on this information is solely at your own risk. CBRE and the CBRE logo are service marks of CBRE, Inc. All other marks displayed on this document are the property of their respective owners, and the use of such logos does not imply any affiliation with or endorsement of CBRE. Photos herein are the property of their respective owners. Use of these images without the express written consent of the owner is prohibited.