

FOR LEASE

**NEW MARKET PRICE
ADJUSTMENT
\$16.00 PSF**

9800 MANCHESTER ROAD
ST. LOUIS, MO 63119



\$5,000 BROKER BONUS
for cooperating broker who brings a lease for at least 5 years

49FIFTY
REAL ESTATE

139 W. Monroe Ave, Suite 200
St. Louis, MO 63122
www.4950RealEstate.com

John T. McDonald, Jr.
314.394.3380 Office
314.495.1039 Mobile
john@4950realestate.com

FOR LEASE

9800 MANCHESTER ROAD
ST. LOUIS, MO 63119

PROPERTY HIGHLIGHTS

- + Last space remaining at high profile center on Manchester Rd.
- + Endcap Space 2,300 +/- SF
- + Rare availability with prime frontage on Manchester Rd.
- + Ample parking with ratio of 5.21/1,000 SF
- + New lighted intersection from Manchester Road
- + Adjacent to Hacienda and other well known retailers and amenities
- + Monument signage
- + Highly visible location on Manchester with over 25,000 VPD
- + Tenants include Papa Johns, Complete Care Chiropractic, and Greenlight Dispensary
- + **REDUCED LEASE RATE: \$16.00 PSF NNN**
"PRICE SELLS RETAIL SPACE"

DEMOGRAPHICS	1 MILE	3 MILES	5 MILES
Population	9,925	81,624	237,022
Households	3,890	35,378	100,501
Median HH Income	\$69,510	\$63,375	\$62,095
Median Home Value	\$324,649	\$207,063	\$199,524
Daytime Population	7,299	84,239	243,472

FLOOR PLAN

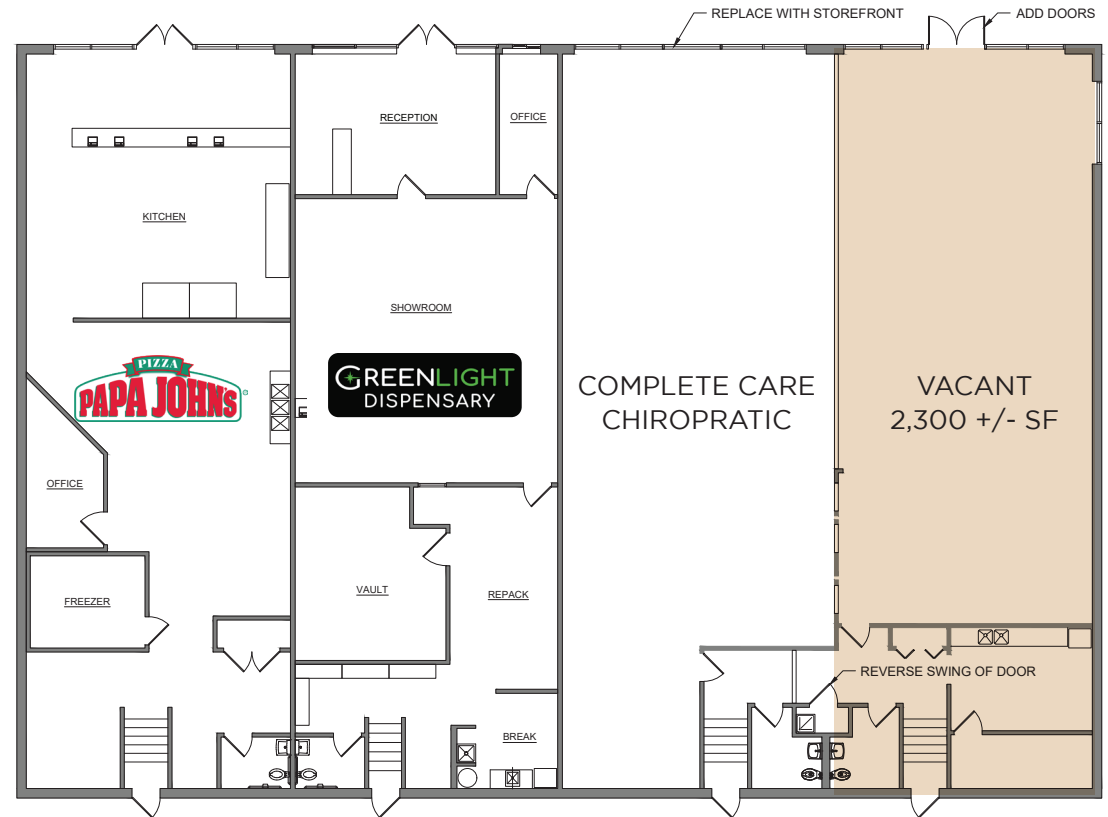

FOR LEASE

9800 MANCHESTER ROAD
ST. LOUIS, MO 63119

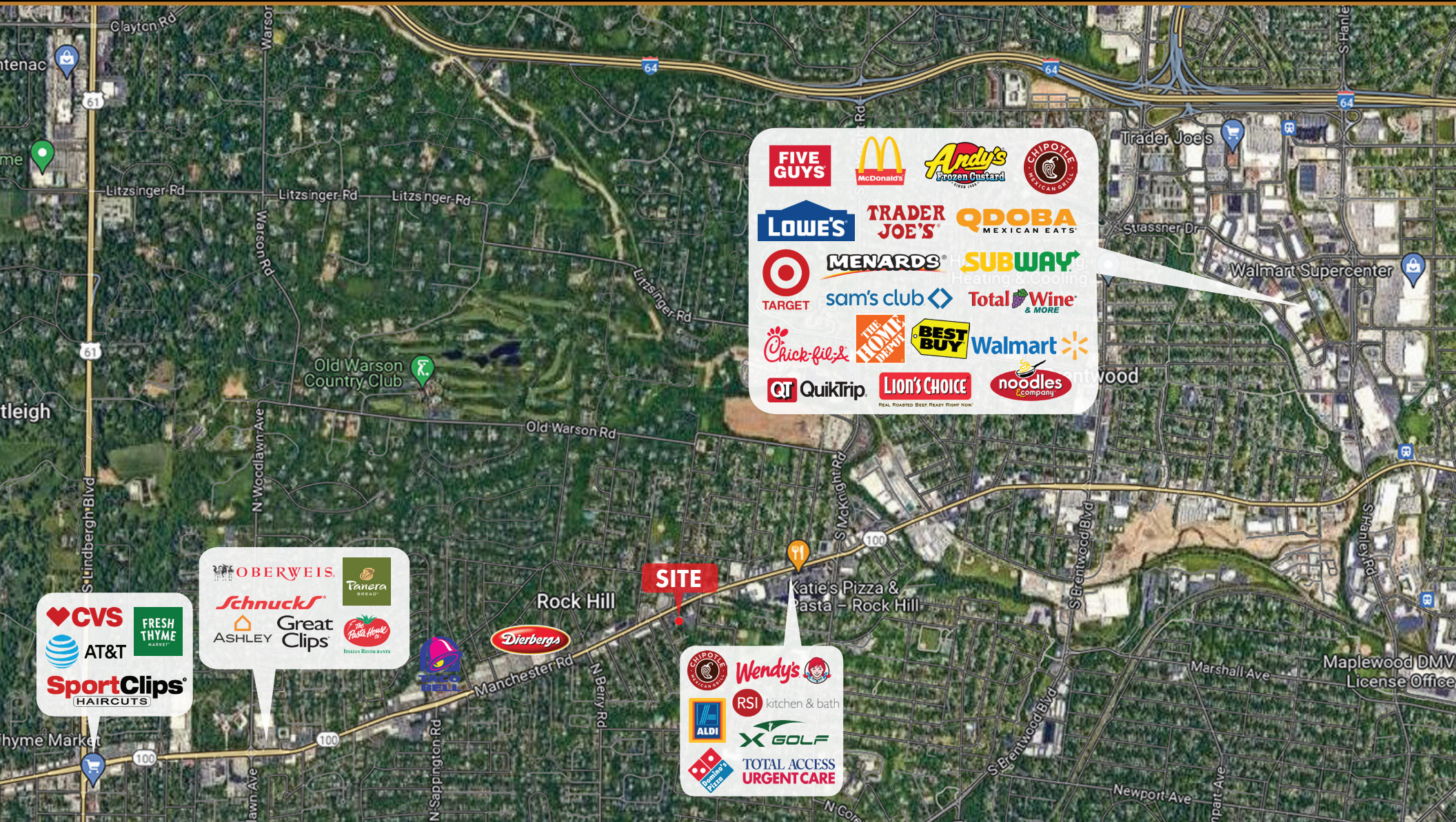

49FIFTY
REAL ESTATE

139 W. Monroe Ave, Suite 200
St. Louis, MO 63122
www.4950RealEstate.com

John T. McDonald, Jr.
314.394.3380 Office
314.495.1039 Mobile
john@4950realestate.com

The information above has been obtained from sources we believe to be reliable. However, we have not verified its accuracy and make no guarantee, warranty or representation about it. It is submitted subject to the possibility of errors, omissions, change of price, rental or other conditions, prior sale, lease or financing, or withdrawal without notice. We include projections, opinions, assumptions or estimates for example only, and they may not represent current or future performance of the property. You and your tax and legal advisors should conduct your own investigation of the property and transaction.