



# FOR LEASE

7630 South US Highway 1

7630 South US Highway 1 Port St. Lucie, FL 34952

### PROPERTY OVERVIEW

Located in a highly visible and accessible area along US-1, this retail strip center offers substantial exposure and is set to undergo a comprehensive facelift beginning in Q1 2025. The upcoming renovations will include a full exterior repaint, updated signage, enhanced walkway lighting, new parking lot lighting, repaved parking surfaces, and refreshed landscaping, all designed to elevate the property's appeal and functionality.

The center benefits from a 48,500 daily traffic count, ensuring your business will enjoy constant visibility. Both building signage and monument street signage will be available, providing added marketing opportunities to attract potential customers. This prime commercial space is situated within a soon-to-be vibrant shopping center, making it a desirable location for retail, service, and office tenants alike.

### OFFERING SUMMARY

Building Size:	16,680 SF
Land Size:	1.21 Acres
Available Size:	900 - 4,050 SF
Zoning:	GC - General Commercial
Traffic Count:	48,500 AADT

LEASE RATE \$20.00 - 22.00 SF/yr (NNN)



KATIE PARADA  
ASSOCIATE  
Mobile 772.577.8970  
katie@slccommercial.com

772.220.4096 | slccommercial.com



SLC Commercial  
Realty & Development



# Property Details & Highlights

KINGS PLAZA

FOR LEASE

Property Name:	Kings Plaza
Property Address:	7630 South US Highway 1, Port St. Lucie, FL 34952
Property Type:	Retail
APN:	3422-441-0001-0502
Lot Size:	1.21 AC
Building Size:	16,680 SF
Zoning:	GC - General Commercial
Parking Ratio:	3.5
Cross Streets:	Prima Vista Blvd



## LOCATION OVERVIEW

Located on US Highway 1 just south of Prima Vista Blvd lighted intersection. Nearby retailers include Walgreens, McDonalds, Dunkin Donuts and more.

[Click for Permitted Uses](#)

## LEASE HIGHLIGHTS

- Prime location on South US Highway 1
- High visibility with excellent signage opportunities
- Ample parking for customers and employees
- Versatile layout that accommodates various businesses
- Remodel to begin 2025
- Flexible lease terms to suit your business needs
- Strong existing tenant mix for added foot traffic
- Professional property management and maintenance services

# Renovation Comparison

KINGS PLAZA

FOR LEASE



Existing Building



Proposed Renovation

# Available Spaces

KINGS PLAZA

FOR LEASE



<b>Unit 7630</b>	\$20.00 SF/yr	NNN	4,050 SF	Negotiable
<b>Unit 7634</b>	\$20.00 SF/yr	NNN	3,050 SF	Negotiable
<b>Unit 7640</b>	\$21.00 SF/yr	NNN	1,800 SF	Negotiable
<b>Unit 7646</b>	\$22.00 SF/yr	NNN	900 SF	Negotiable

# Building Sketch

KINGS PLAZA

FOR LEASE

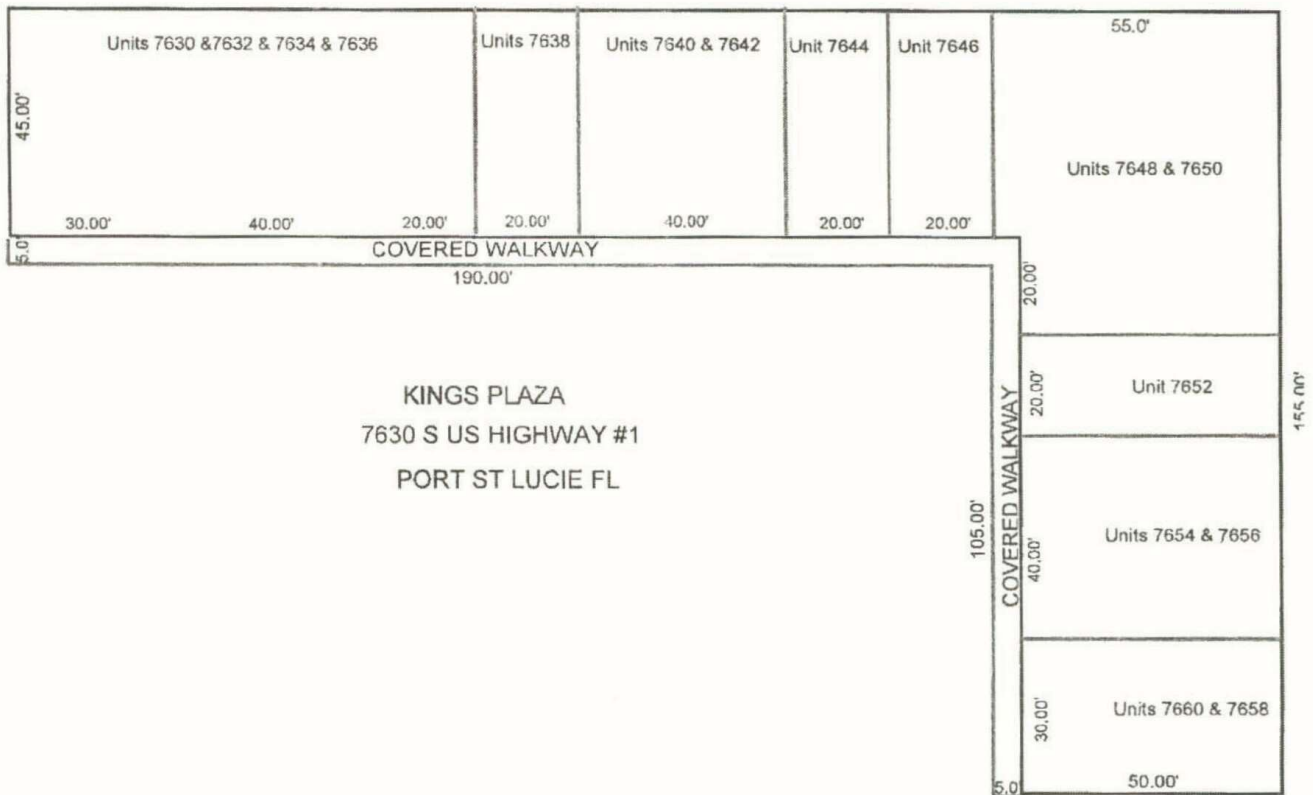

# Plaza Vicinity

KINGS PLAZA

FOR LEASE

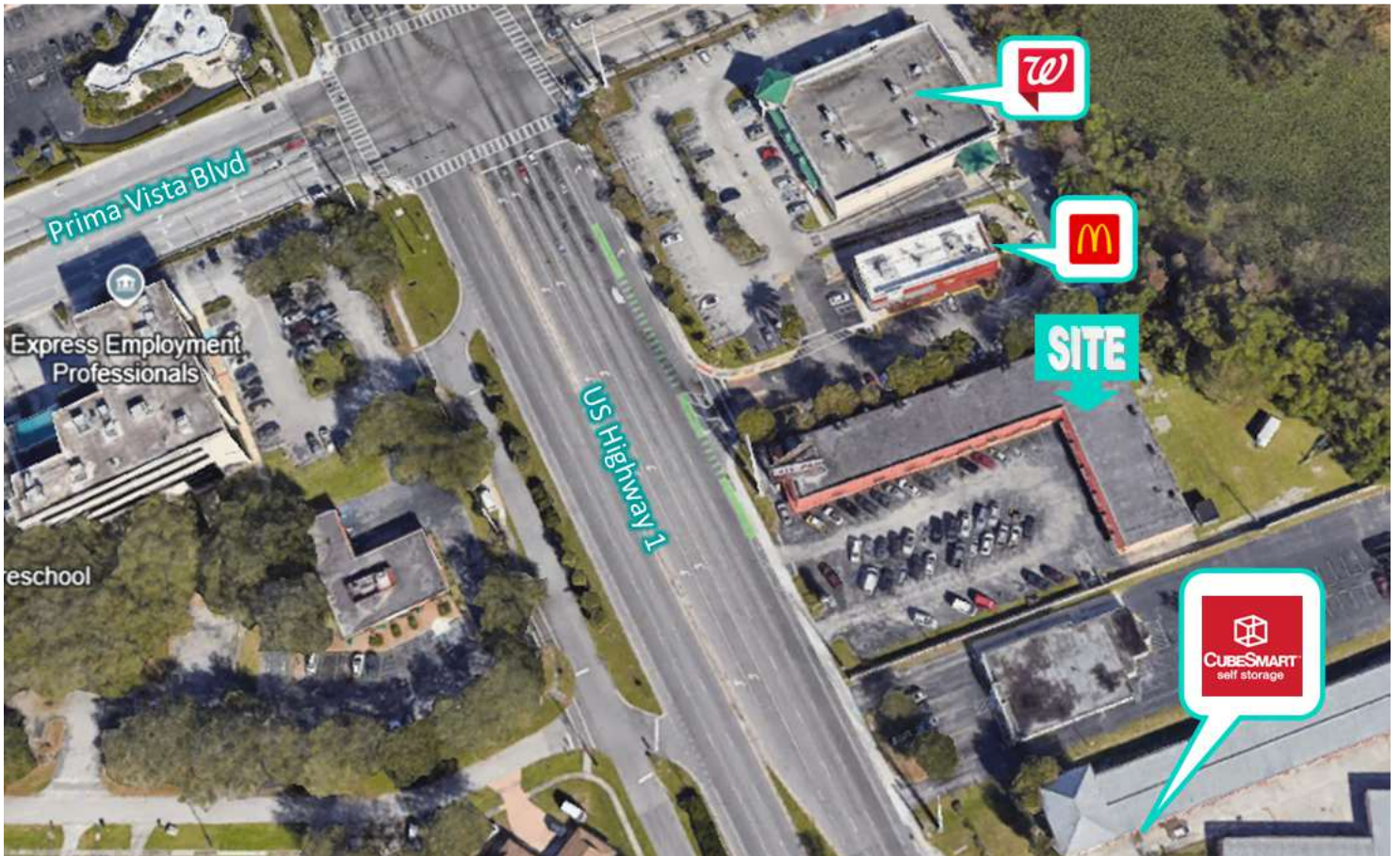

# Retailer Map

KINGS PLAZA

FOR LEASE

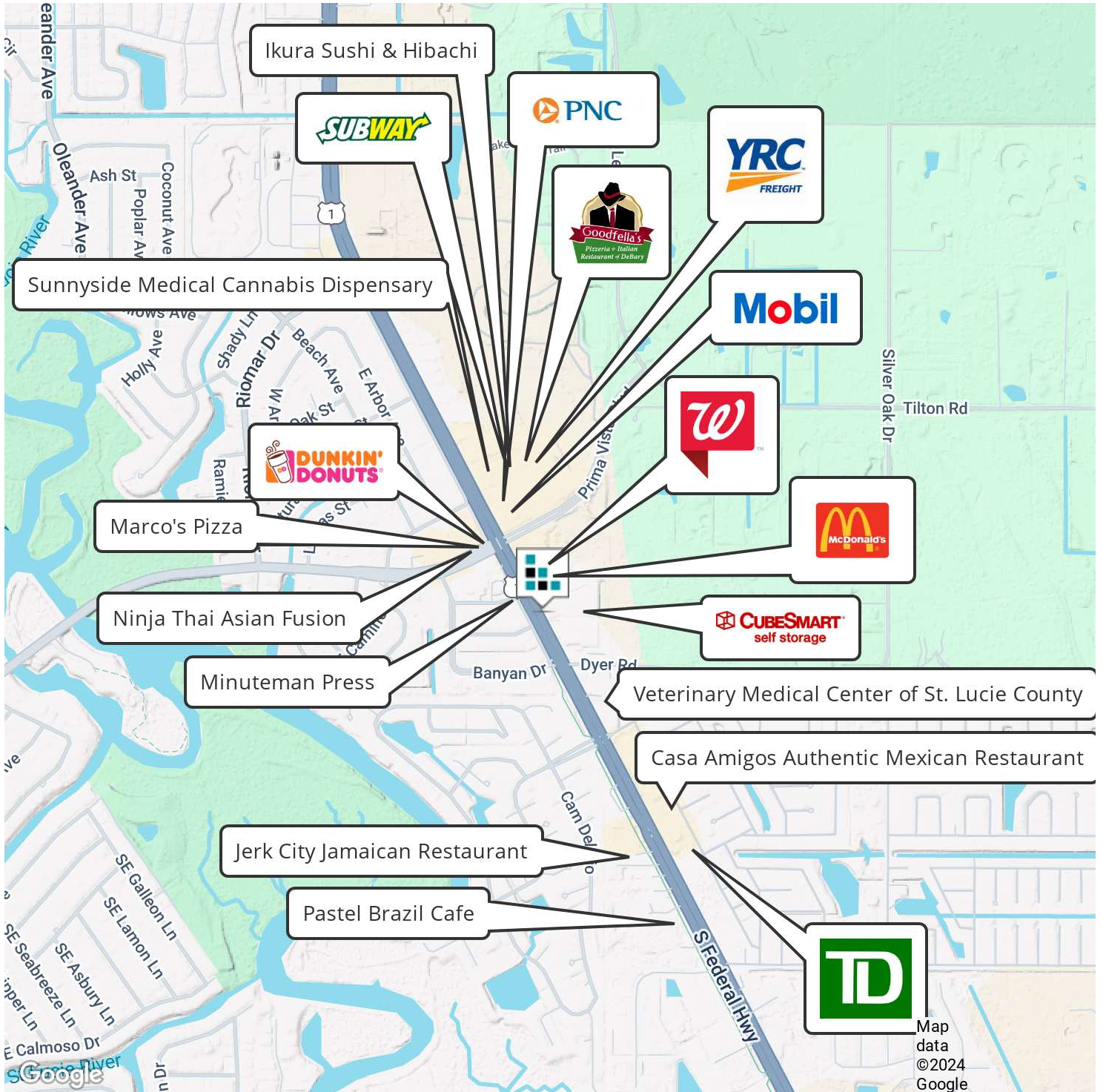

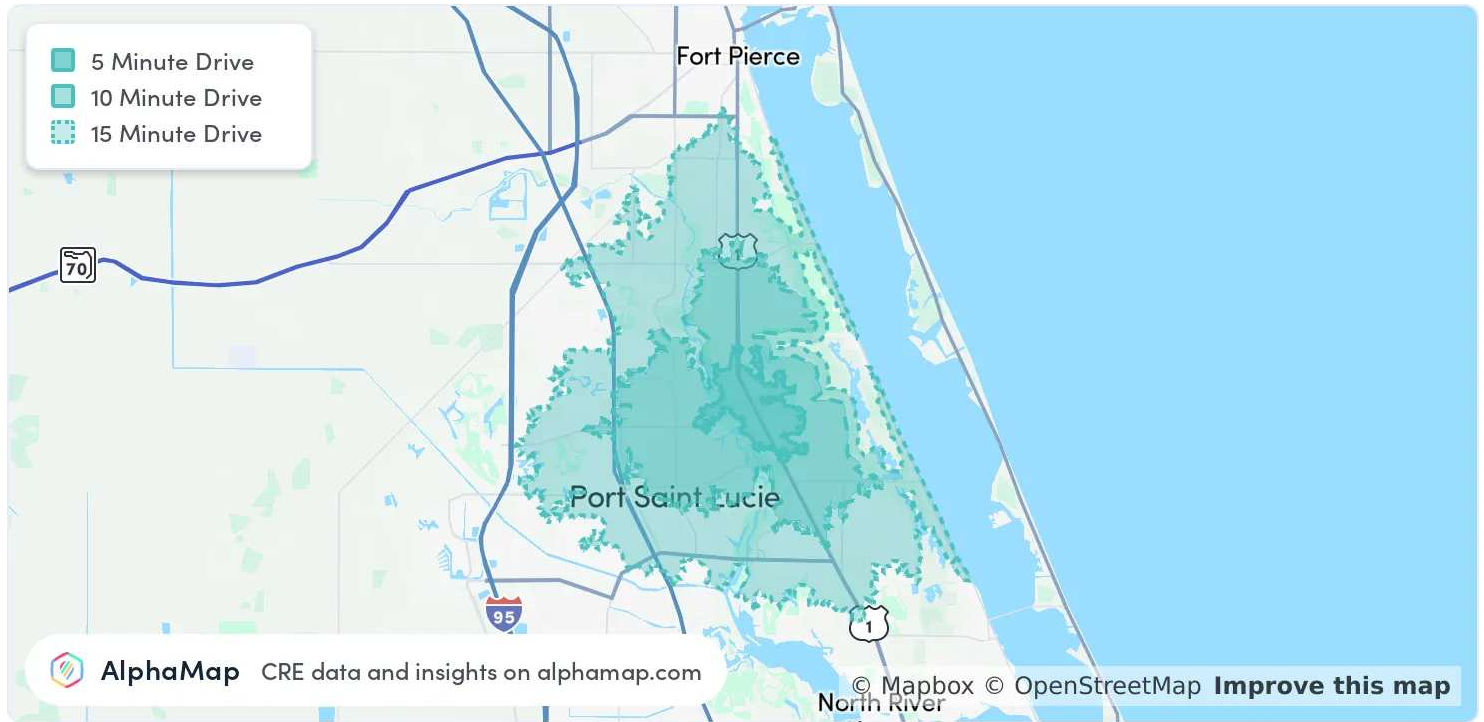

POPULATION	5 MINUTES	10 MINUTES	15 MINUTES
Total Population	7,991	60,741	146,043
Average Age	56	46	46
Average Age (Male)	55	45	44
Average Age (Female)	57	48	47

HOUSEHOLD & INCOME	5 MINUTES	10 MINUTES	15 MINUTES
Total Households	4,086	25,072	58,514
Persons per HH	2	2.4	2.5
Average HH Income	\$72,785	\$80,065	\$82,487
Average House Value	\$233,813	\$289,451	\$313,714
Per Capita Income	\$36,392	\$33,360	\$32,994

Map and demographics data derived from AlphaMap



# Disclaimer

KINGS PLAZA

FOR LEASE

This presentation package has been prepared by the company representing the property for informational purposes only and does not purport to contain all information necessary to reach a purchase decision.

The information herein has been given by the Owner or other sources believed to be reliable, but it has not necessarily been independently verified by the Company representing the property and neither its accuracy nor its completeness is guaranteed.

This information is subject to errors, omissions, changes, prior sale or withdrawal without notice by the Company representing the property and does not constitute a recommendation, endorsement or advice as to the value for the purchase of any property. Each prospective lessee or purchaser is to rely upon his/her own investigation, evaluation and judgment as to the advisability of leasing or purchasing the property.

Furthermore, any financial information and calculations presented in this analysis are believed to be accurate, but are not guaranteed and are intended for the purposes of projection and analysis only. The user of this financial information contained herein should consult a tax specialist concerning his/her particular circumstances before making any investment.