

# DISTRIBUTION WAREHOUSE

2143 Enterprise Dr. | Independence, KS 67301

FOR SALE/LEASE

Contact Broker



SCAN TO VIEW VIDEO

**SITE SIZE**  
4.656 A±

**BUILDING SIZE**  
23,830 SF (PER COUNTY RECORDS)

**AVAILABLE SF**  
23,830 SF

**ZONING**  
M-2, HEAVY INDUSTRIAL

**CEILING HEIGHT**  
14'-18'

**YEAR BUILT**  
2011, 2012

**CONSTRUCTION**  
METAL ON STEEL

**DOCK DOORS**  
6

**OVERHEAD DOORS**  
MULTIPLE

**PARKING**  
AUTO - 79 SPACES±  
TRUCK - AMPLE

**2023 TAXES (\$3.53/SF)**  
GENERALS: \$84,120.52 SPECIALS: \$0.00

## PROPERTY HIGHLIGHTS

- Distribution warehouse available for purchase or lease in Independence, KS.
- Excellent access to US Highways 75 and 160.
- Multiple, drive-in, overhead and dock doors.
- Good ceiling height.
- Floor drain.
- Heavy power.
- Outside parking/trailer storage.



Offered by: **Grant Tidemann, SIOR**  
316-292-3908 | tidemann@weigand.com

**Bradley Tidemann, SIOR**  
316-650-8853 | btidemann@weigand.com

# DISTRIBUTION WAREHOUSE

2143 Enterprise Dr. | Independence, KS 67301

FOR SALE/LEASE

Contact Broker

## INTERIOR PHOTOS



Offered by: **Grant Tidemann, SIOR**

316-292-3908 | [tidemann@weigand.com](mailto:tidemann@weigand.com)

**Bradley Tidemann, SIOR**

316-650-8853 | [btidemann@weigand.com](mailto:btidemann@weigand.com)

# DISTRIBUTION WAREHOUSE

2143 Enterprise Dr. | Independence, KS 67301

FOR SALE/LEASE

Contact Broker

## OVERALL FLOOR PLAN

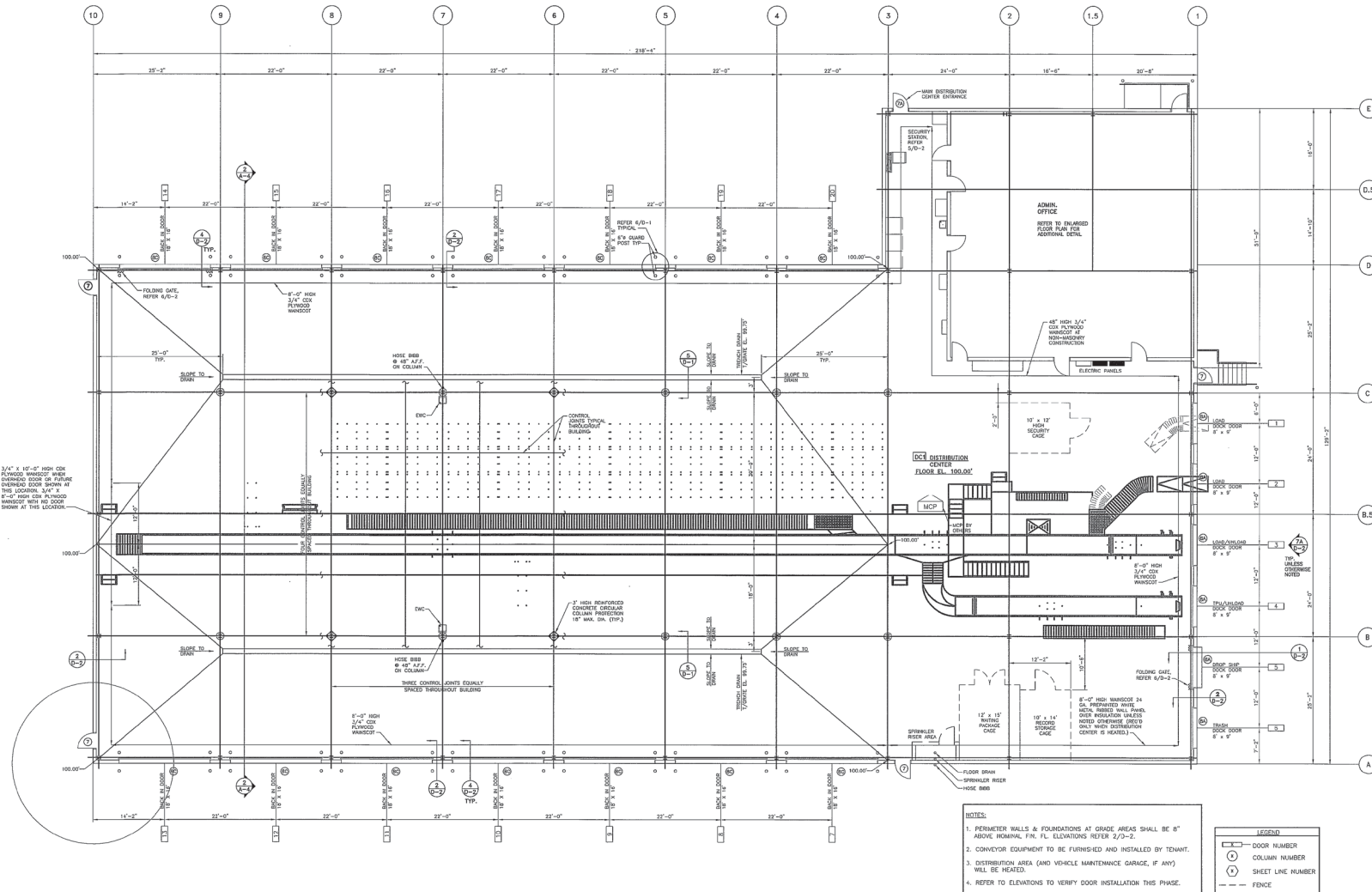

Offered by: **Grant Tidemann, SIOR**  
316-292-3908 | tidemann@weigand.com

**Bradley Tidemann, SIOR**  
316-650-8853 | btidemann@weigand.com

# DISTRIBUTION WAREHOUSE

2143 Enterprise Dr. | Independence, KS 67301

FOR SALE/LEASE

Contact Broker

## OFFICE FLOOR PLAN

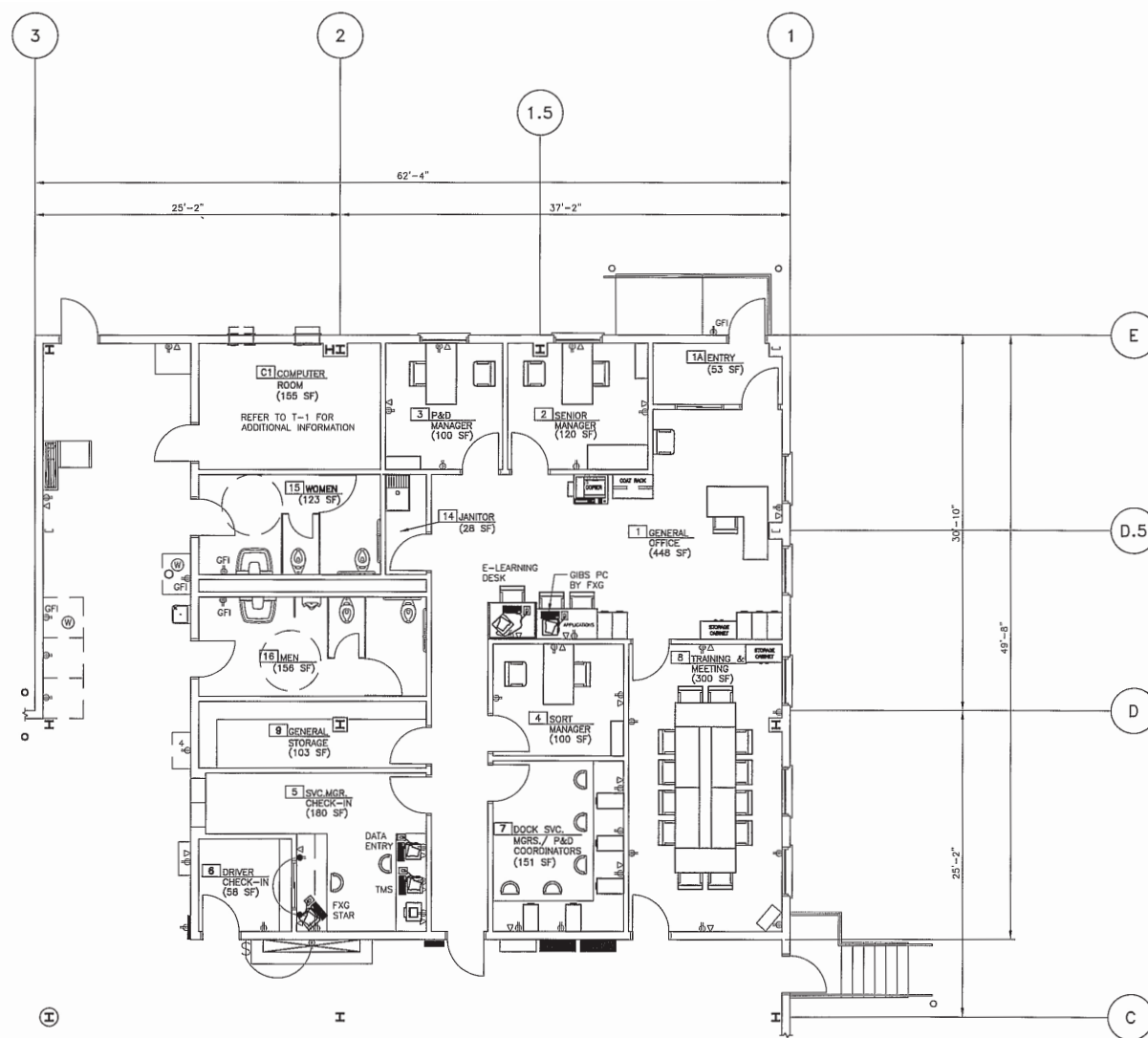

Offered by: **Grant Tidemann, SIOR**

316-292-3908 | [tidemann@weigand.com](mailto:tidemann@weigand.com)

**Bradley Tidemann, SIOR**

316-650-8853 | [btidemann@weigand.com](mailto:btidemann@weigand.com)

# DISTRIBUTION WAREHOUSE

2143 Enterprise Dr. | Independence, KS 67301

FOR SALE/LEASE

Contact Broker



All information furnished regarding property for sale, lease, exchange or financing is from sources deemed reliable but no guarantee is made or responsibility assumed as to its accuracy or completeness and you are advised to make your own analysis and verification. Agent hereby notifies prospective buyer/lessee that (a) Agent will be acting as a designated agent of seller/lessor with the duty to represent seller/lessor's interest; and (b) Information given to Agent will be disclosed to seller/lessor.



Offered by: **Grant Tidemann, SIOR**

316-292-3908 | [tidemann@weigand.com](mailto:tidemann@weigand.com)

**Bradley Tidemann, SIOR**

316-650-8853 | [btidemann@weigand.com](mailto:btidemann@weigand.com)