

# INDUSTRIAL BUILDING FOR SUBLEASE

9838 Geary Blvd, Santa Fe Springs, CA 90670



## BUILDING & SITE SUMMARY

- \$1.29 Industrial Gross!
- Sublease Through June 30, 2025
- 53,995 SF On Approx 2.55 Acres
- Approximately 6,000 SF of OfficeSpace
- Approximately 400 Amps Of 277/480 Volt 3 Phase/4 Wire power(Please Verify)
- 4 Ground Level Doors
- 24' Warehouse Clearance
- Fully Sprinklered
- Large Private Yard



ALL INFORMATION CONTAINED HEREIN HAS BEEN PROVIDED BY SELLER, LANDLORD, AND/OR THIRD PARTIES, BUT HAS NOT BEEN INDEPENDENTLY VERIFIED BY LEE & ASSOCIATES OR ITS AGENT(S). BUYER, TENANT AND/OR INTERESTED PARTIES SHOULD INDEPENDENTLY VERIFY ALL INFORMATION COMMUNICATED BY THESE SOURCES.

EXCLUSIVELY REPRESENTED BY:

## Team Location Advice



**Allen C. Buchanan, SIOR**

**714-564-7104**

Principal | Lee & Associates  
DRE License# 00870947

[abuchanan@lee-associates.com](mailto:abuchanan@lee-associates.com)

**Joshua K. Harper**

**714-564-7116**

Agent | Lee & Associates  
DRE License# 01956294

[jharper@lee-associates.com](mailto:jharper@lee-associates.com)



# INDUSTRIAL BUILDING FOR SUBLEASE

9838 Geary Blvd, Santa Fe Springs, CA 90670

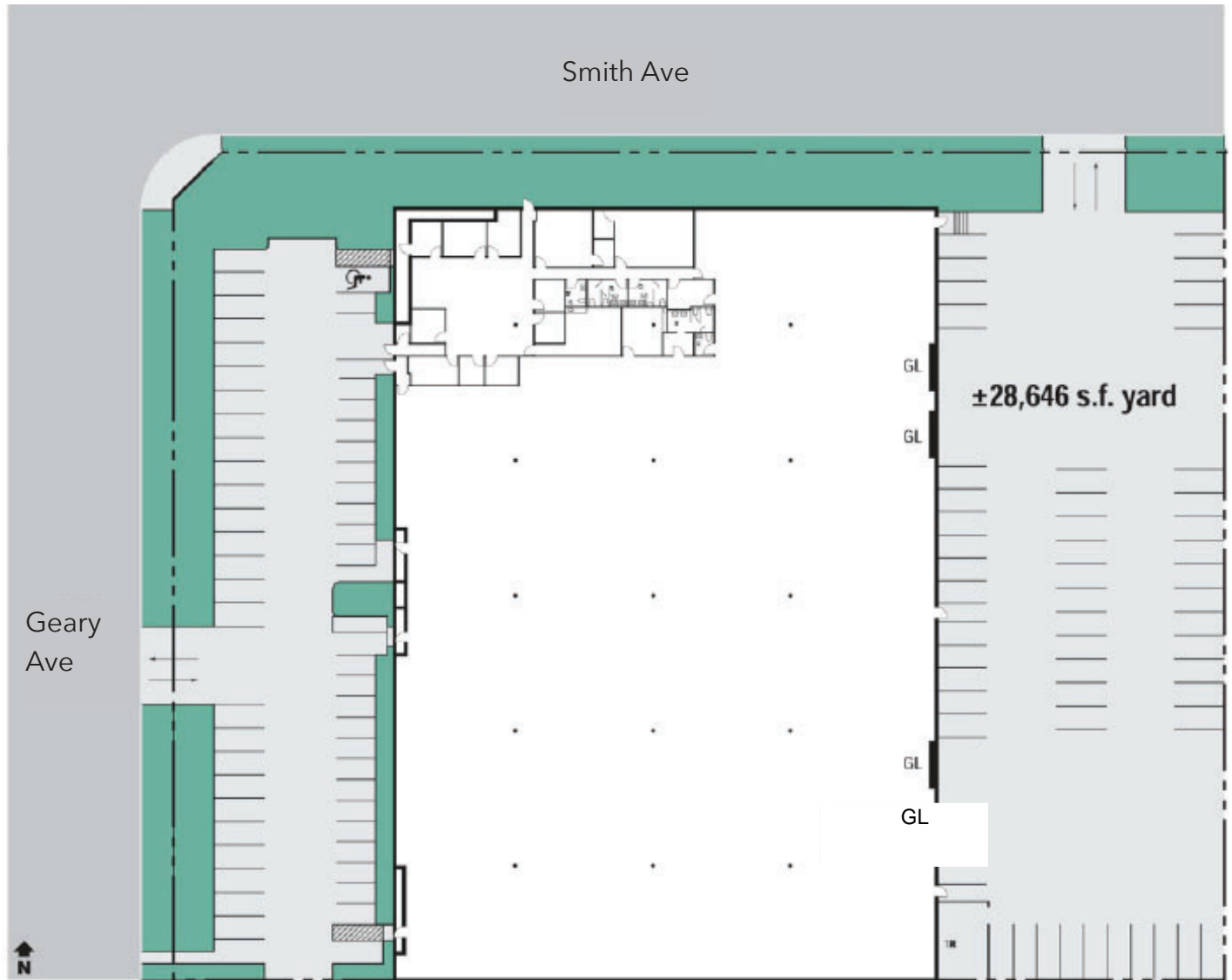

ALL INFORMATION CONTAINED HEREIN HAS BEEN PROVIDED BY SELLER, LANDLORD, AND/OR THIRD PARTIES, BUT HAS NOT BEEN INDEPENDENTLY VERIFIED BY LEE & ASSOCIATES OR ITS AGENT(S). BUYER, TENANT AND/OR INTERESTED PARTIES SHOULD INDEPENDENTLY VERIFY ALL INFORMATION COMMUNICATED BY THESE SOURCES.

EXCLUSIVELY REPRESENTED BY:

## Team Location Advice



**Allen C. Buchanan, SIOR**

**714-564-7104**

Principal | Lee & Associates  
DRE License# 00870947

[abuchanan@lee-associates.com](mailto:abuchanan@lee-associates.com)

**Joshua K. Harper**

**714-564-7116**

Agent | Lee & Associates  
DRE License# 01956294

[jharper@lee-associates.com](mailto:jharper@lee-associates.com)

