

LOCATION

7375 South Ave, Boardman, OH 44512

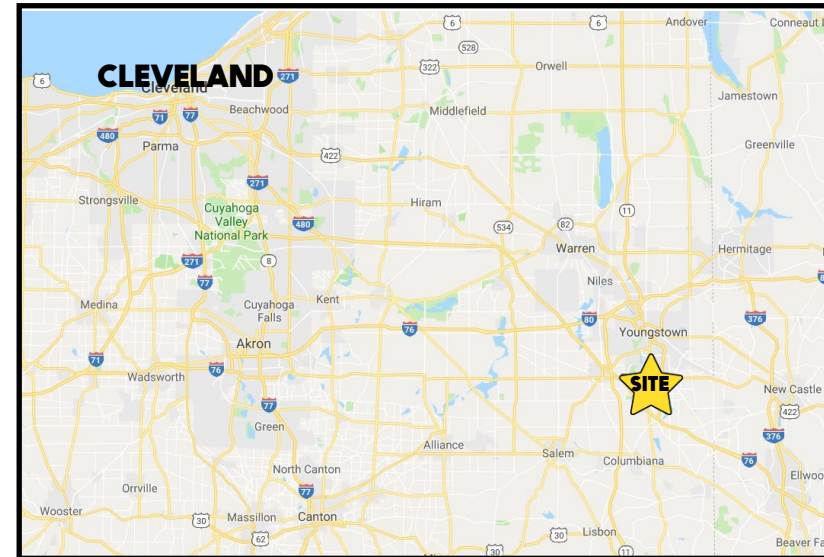

HIGHLIGHTS

- Retail or fast food opportunity in the heart of Boardman
- Rear drive-in door
- Located on South Ave, just south of US 224
- High traffic count
- Close to Chick-Fil-A, Starbucks, Popeyes, Marshalls

TRAFFIC

South Ave = 18,355 VPD
Boardman Poland Rd = 32,589 VPD

CONTACT

GARY LASKO

330.509.4546

glasko@platzrealtygroup.com

Office: 330.757.4889 | Fax: 330.294.5622 | 3768 Boardman Canfield Rd, Canfield, OH 44406

www.PLATZREALTYGROUP.com



Office: 330.757.4889 | Fax: 330.294.5622 | 3768 Boardman Canfield Rd, Canfield, OH 44406

www.PLATZREALTYGROUP.com

The information presented was obtained from sources believed to be true and reliable. The Platz Realty Group makes no warranties or guarantees to the accuracy of the information.



Office: 330.757.4889 | Fax: 330.294.5622 | 3768 Boardman Canfield Rd, Canfield, OH 44406

www.PLATZREALTYGROUP.com

The information presented was obtained from sources believed to be true and reliable. The Platz Realty Group makes no warranties or guarantees to the accuracy of the information.

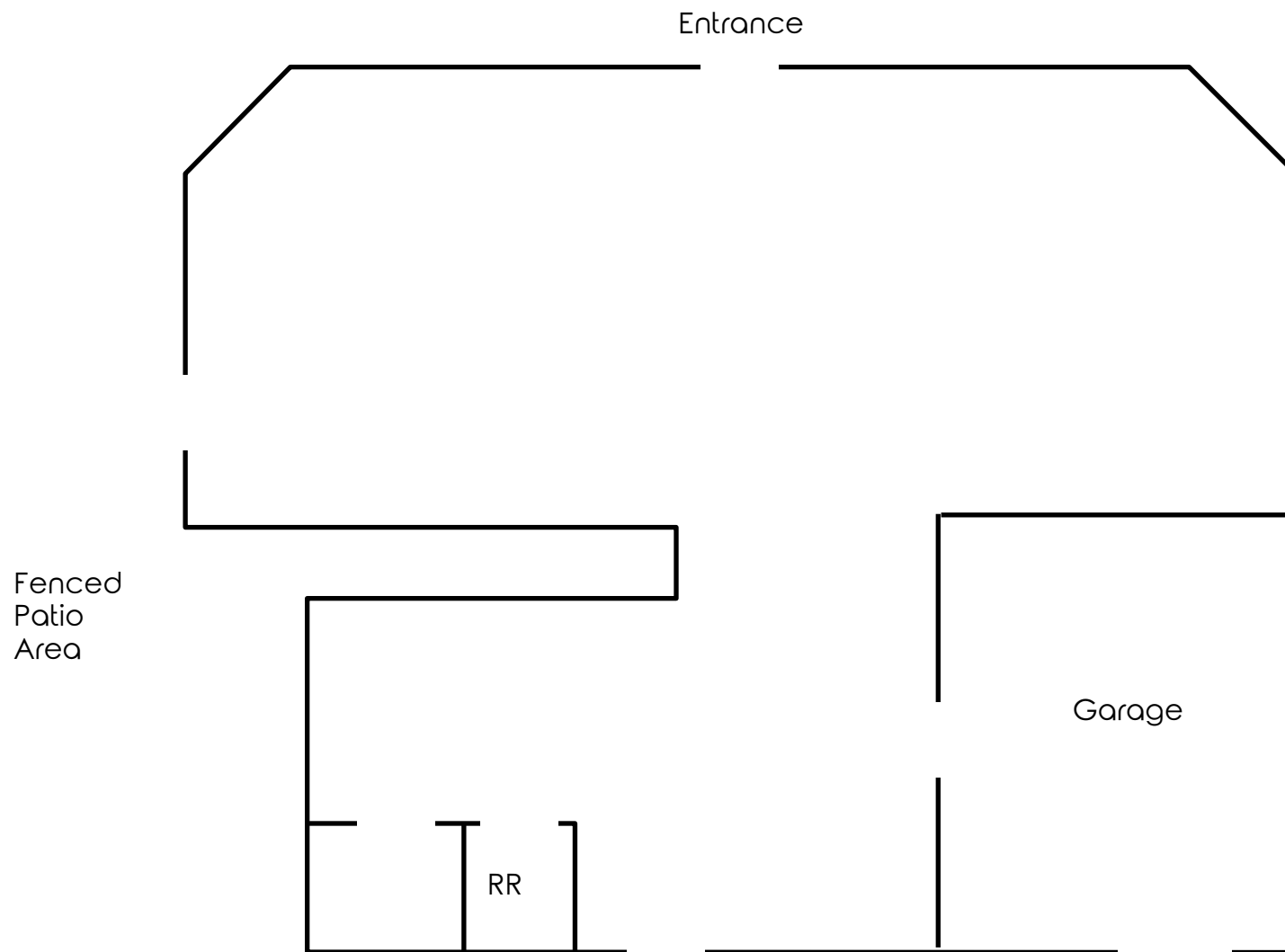

Office: 330.757.4889 | Fax: 330.294.5622 | 3768 Boardman Canfield Rd, Canfield, OH 44406

www.PLATZREALTYGROUP.com



Office: 330.757.4889 | Fax: 330.294.5622 | 3768 Boardman Canfield Rd, Canfield, OH 44406

www.PLATZREALTYGROUP.com

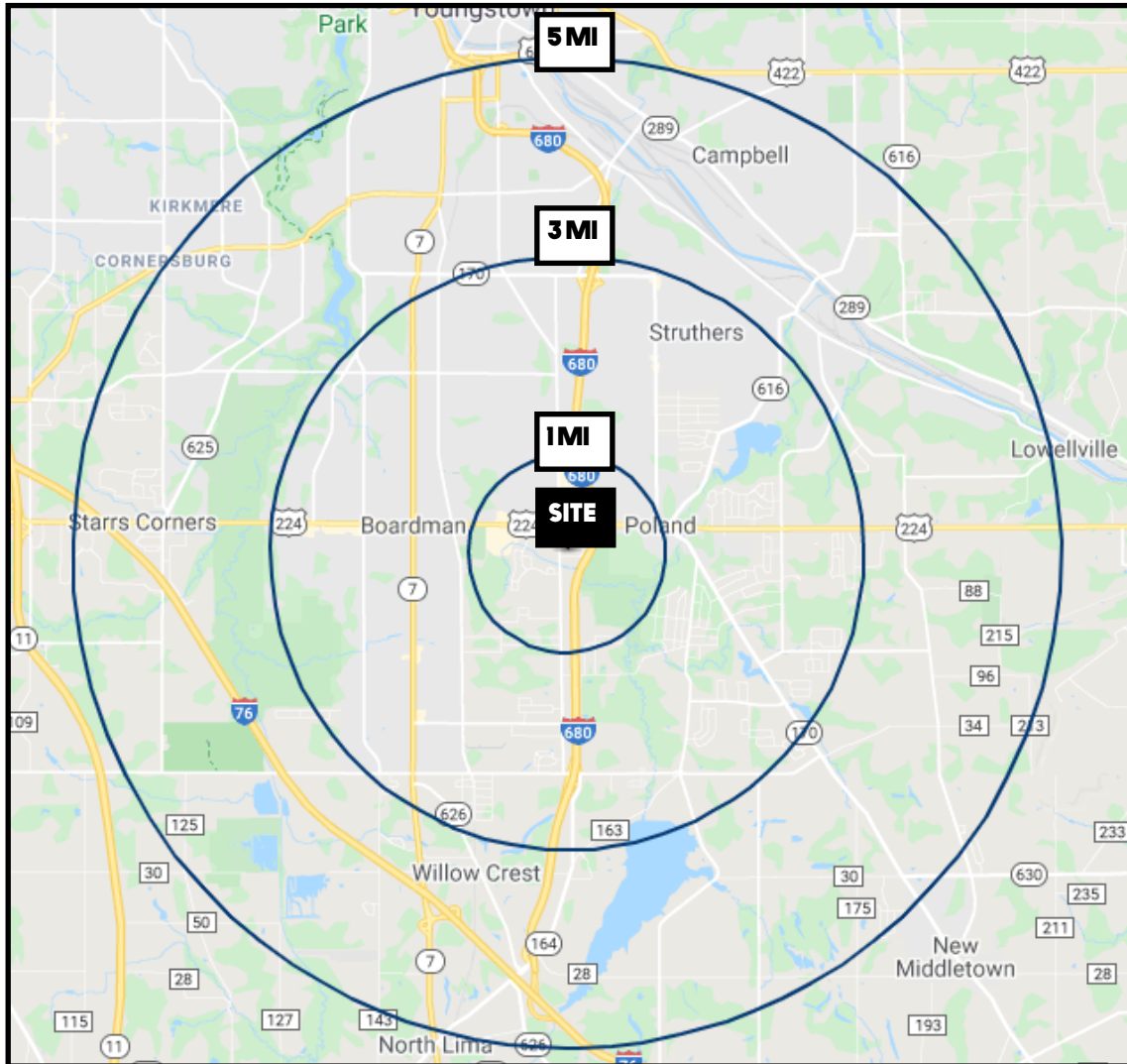

DEMOGRAPHICS	1 MI	3 MI	5 MI
POPULATION	3,669	55,079	105,729
HOUSEHOLDS	1,573	23,595	44,407
MEDIAN AGE	50	45	43
AVERAGE HH INCOME	\$86,619	\$73,563	\$66,687

SITE INFORMATION

LOCATION	Boardman Township Mahoning County
PROPERTY TYPE	Freestanding Retail
SIZE	3,772 SF on .48 acres
UTILITIES	All
YEAR RENOVATED	1984
SIGNAGE	Building and Pylon
RENT	\$17.50/SF NNN (As Is) NNN Charges: \$3.00/SF

Office: 330.757.4889 | Fax: 330.294.5622 | 3768 Boardman Canfield Rd, Canfield, OH 44406