

CRP

COMMERCIAL REALTY PARTNERS
A VETERAN OWNED BUSINESS

195 CARTER DRIVE
EDISON, NJ 08817

INDUSTRIAL FOR LEASE: ±140,000 SF
Divisible 35,000 SF 70,000 SF



For Leasing Information:

Joe Puleo, VP
908-294-0776
jpuleo@crpnj.com

Nicholas Nitti, VP
201-615-0880
nnitti@crpnj.com

All information is from sources deemed reliable. No representation or warranty is made to the accuracy thereof.

INDUSTRIAL FOR LEASE: ±140,000 SF
Divisible 35,000 SF 70,000 SF

Total Building Size: ±163,665 SF

±140,000 SF Available

±3,500 quality office space

Loading Capabilities:

Fourteen (14) loading docks

Two (2) 11' x 13' drive in doors

Ceiling Height:

±24' clear

Column Spacing:

40'x36

Sprinkler: High Density 0.32/2,000

Power (AMPS): 1000

Car Parking: 75

Trailer Parking: 20

Zoning: I - Industrial

Racking: Included

Estimated CAM: ±\$1.18 PSF

Estimated Taxes: ±\$1.80 PSF

Year Built/Renovated: 1988/2005

Occupancy: 6/01/2023



For Leasing Information:

Joe Puleo, VP
908-294-0776
jpuleo@crpnj.com

Nicholas Nitti, VP
201-615-0880
nnitti@crpnj.com

INDUSTRIAL FOR LEASE: ±140,000 SF

Divisible 35,000 SF 70,000 SF

Site Plan

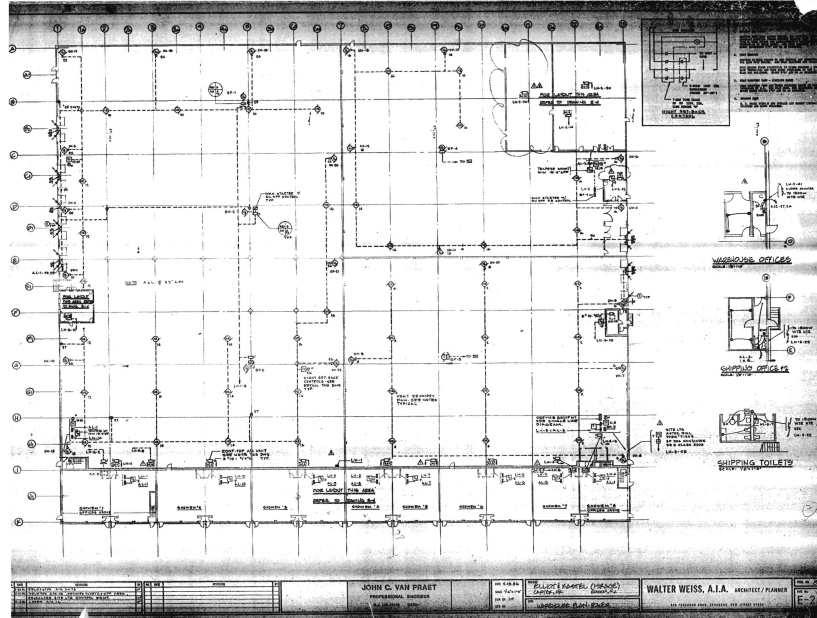
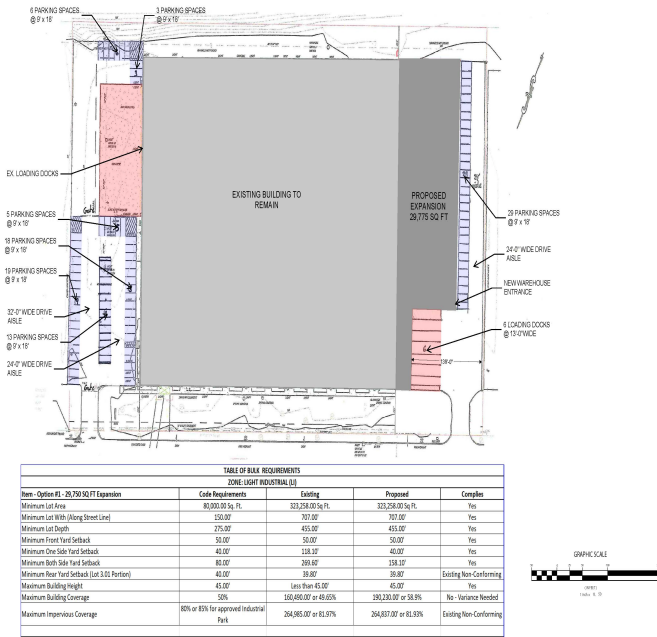

Racking Plan

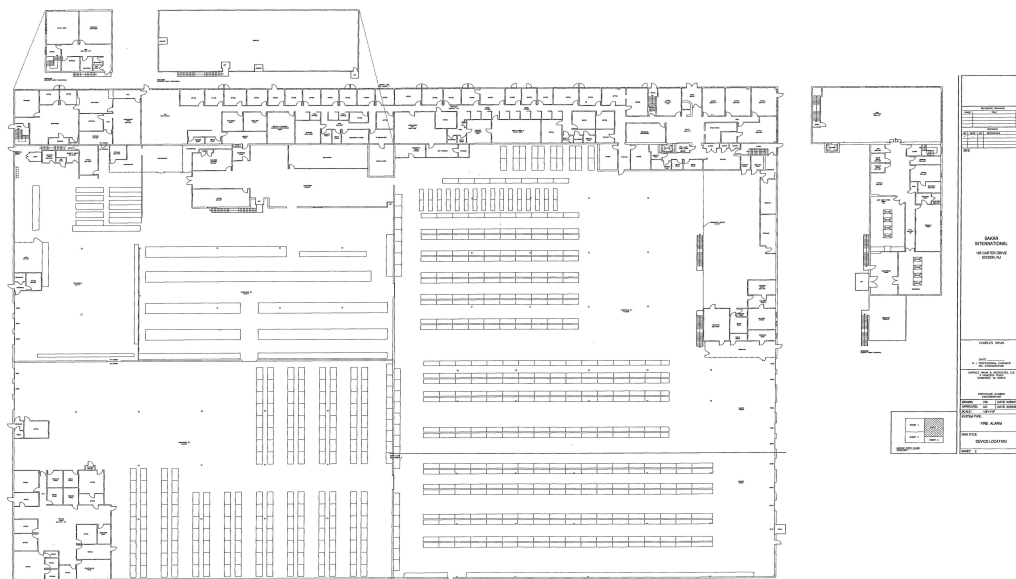

For Leasing Information:

Joe Puleo, VP
908-294-0776
jpuleo@crpnj.com

Nicholas Nitti, VP
201-615-0880
nnitti@crpnj.com

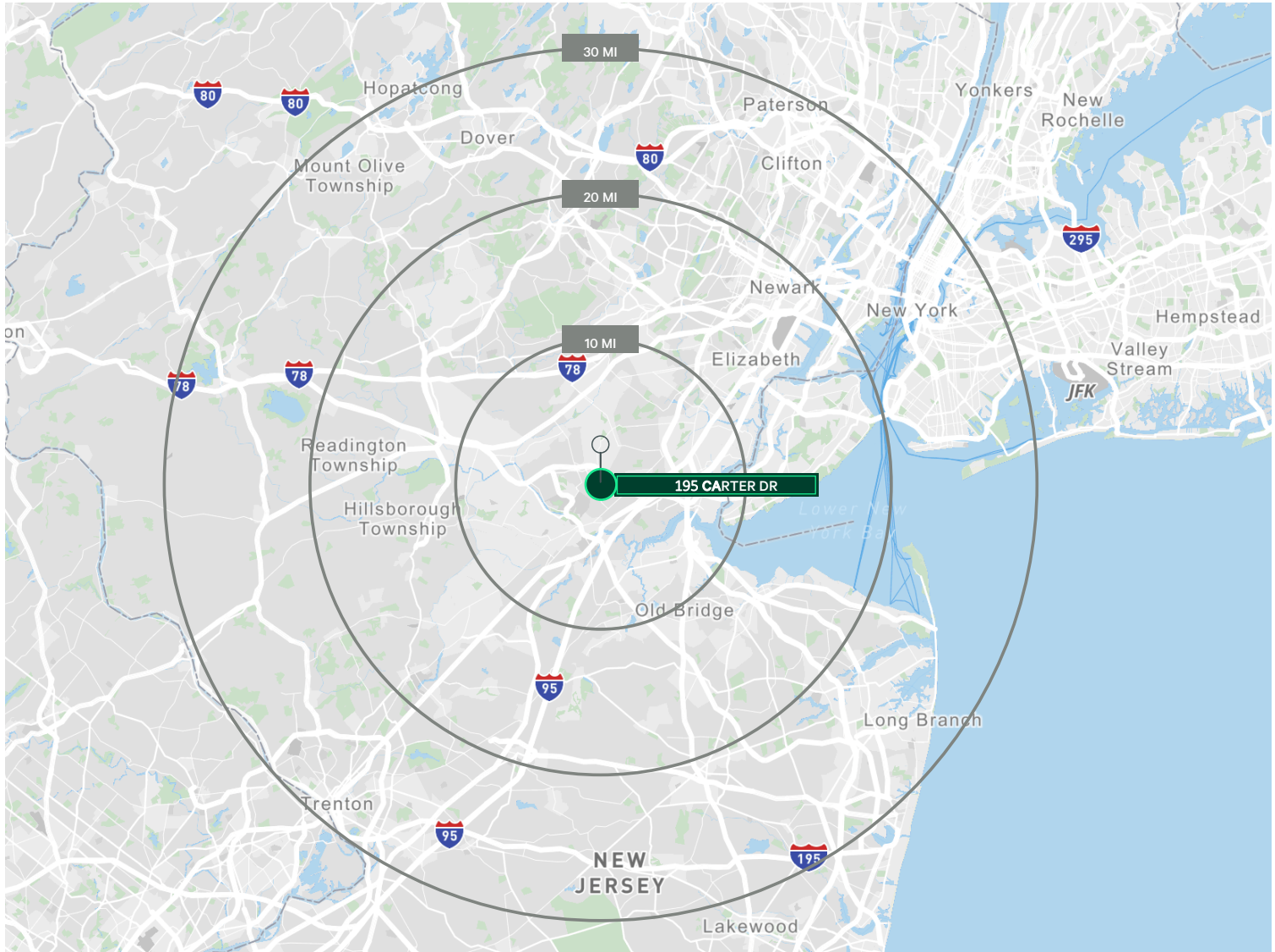

+ Highway access includes:

- I-287
- Route 27
- Route 1 & 9
- Route 440/Outerbridge Crossing
- New Jersey Turnpike
- Garden State Parkway

- Access to:

- Newark Liberty International Airport
- John F. Kennedy International Airport
- Port Newark/Elizabeth
- New York City

+ Area Amenities include:

- Shopping
- Restaurants

© 2023 CRP LLC. All rights reserved. This information has been obtained from sources believed reliable, but has not been verified for accuracy or completeness. Photos herein are the property of their respective owners. Use of these images without the express written consent of the owner is prohibited.

For Leasing Information:

Joe Puleo, VP
908-294-0776
jpuleo@crpnj.com

Nicholas Nitti, VP
201-615-0880
nnitti@crpnj.com

All information is from sources deemed reliable. No representation or warranty is made to the accuracy thereof.