

2930 AMWILER COURT, SUITE B

Atlanta, GA 30360

91,333 SF – FOR LEASE

AMWILER GWINNETT INDUSTRIAL PARK



SUITE INFORMATION

Property Type:	Distribution
Total Building Size:	101,348 SF
Available Size:	91,333 SF
Front office:	2,970 SF (approx.)
Loading Doors:	19 docks; 1 drive-in
Dock Equipment:	19 pit levelers
Column Spacing:	25'x40'
Clear Height:	22'-24'
Sprinkler:	Wet System
Fenced:	Yes
Endcap:	Yes



Joseph Kriss
678.904.1910
josephhk@seefriedproperties.com

Tripp Ausband
770.825.3391 Direct
tausband@seefriedproperties.com



Seefried Industrial Properties
3333 Riverwood Parkway, Suite 200 | Atlanta, GA 30339
404.233.0204 | www.seefriedproperties.com

OWNED BY:
GID

LEASED BY:
SEEFRIED
INDUSTRIAL PROPERTIES

No guarantee, warranty or representation, express or implied, is made as to the accuracy of the information contained herein, and same is submitted subject to errors, omissions, change of price, rental or other conditions, or withdrawal without notice.

2930 AMWILER COURT, SUITE B, ATLANTA, GA 30360 | 91,333 SF – FOR LEASE

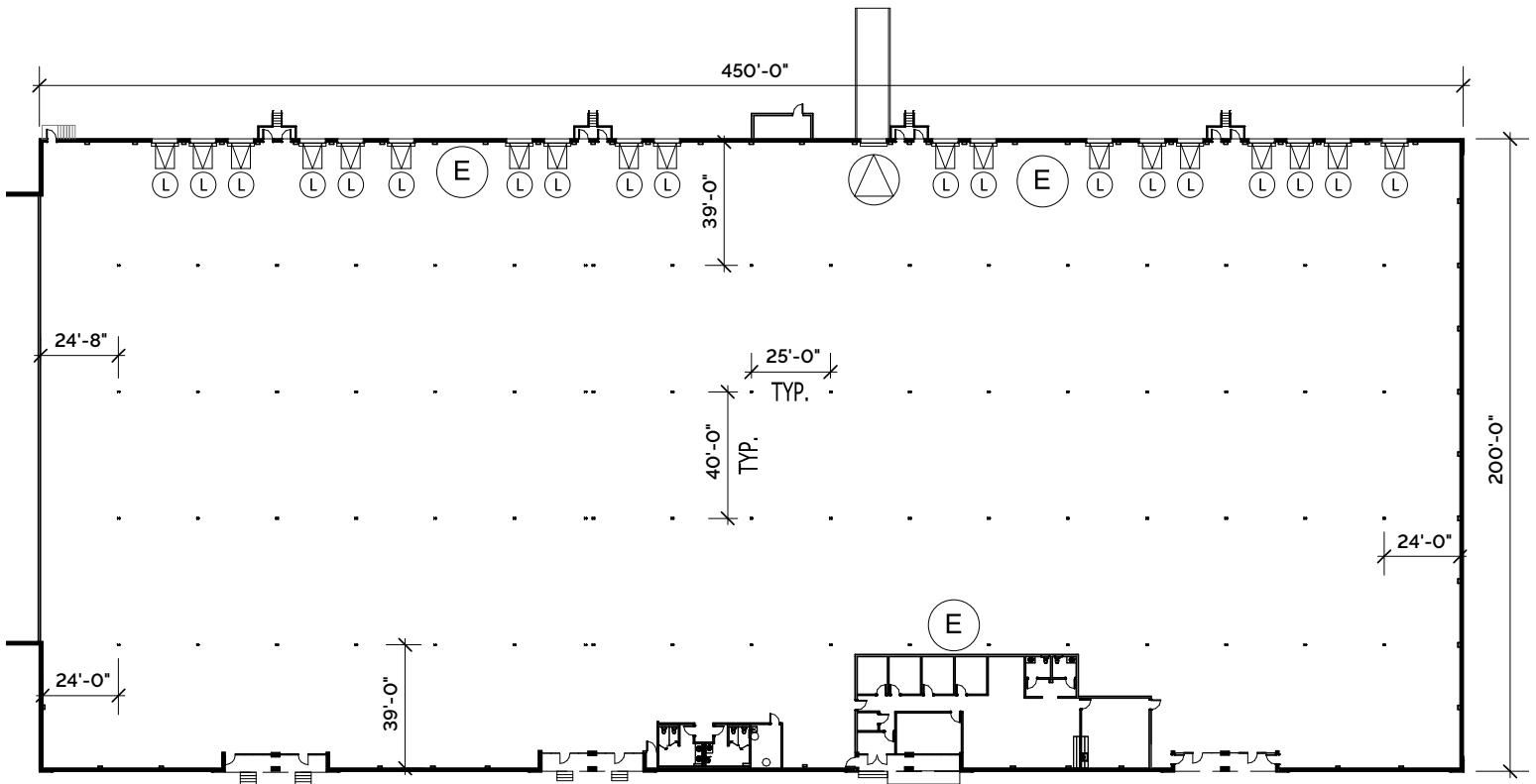

Joseph Kriss
678.904.1910
josephk@seefriedproperties.com

Tripp Ausband
770.825.3391 Direct
tausband@seefriedproperties.com



Seefried Industrial Properties
3333 Riverwood Parkway, Suite 200 | Atlanta, GA 30339
404.233.0204 | www.seefriedproperties.com

OWNED BY:
GID

LEASED BY:
SEEFRIED
INDUSTRIAL PROPERTIES

No guarantee, warranty or representation, express or implied, is made as to the accuracy of the information contained herein, and same is submitted subject to errors, omissions, change of price, rental or other conditions, or withdrawal without notice.