



4395 Pidgeon Roost Rd

Memphis, Tennessee 38118

Property Features

- 25,280 SF available
- Front park, rear load, office/warehouse facility
- Attractive concrete tilt wall panel
- 22' clear ceiling height
- 100'x260'
- 48'x40' column spacing
- Built up roof system
- Office space approximately 2,750 square feet
- Class III sprinkler system
- 5-8'x10' dock high overhead doors

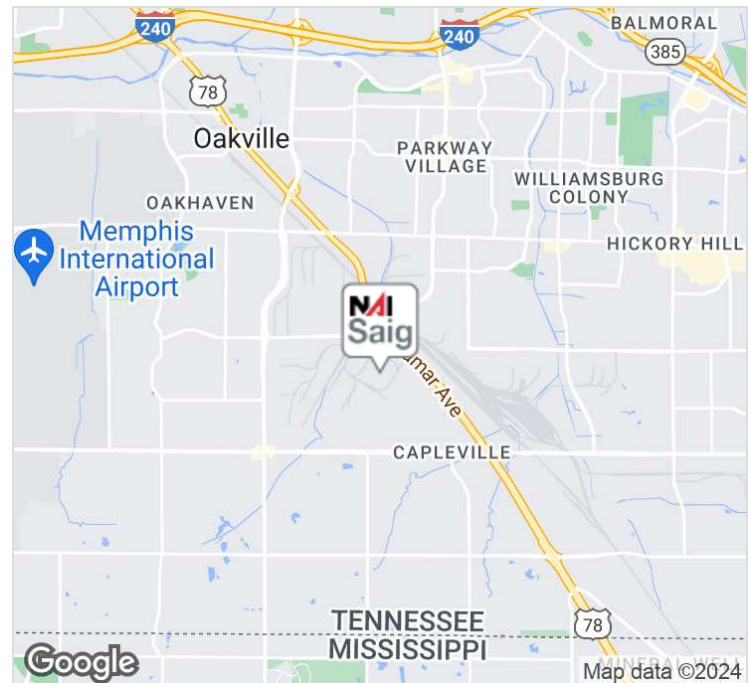

For more information:

Hank Martin, SIOR

901 526 3100 • hmartin@saigcompany.com

NO WARRANTY OR REPRESENTATION, EXPRESS OR IMPLIED, IS MADE AS TO THE ACCURACY OF THE INFORMATION CONTAINED HEREIN, AND THE SAME IS SUBMITTED SUBJECT TO ERRORS, OMISSIONS, CHANGE OF PRICE, RENTAL OR OTHER CONDITIONS, PRIOR SALE, LEASE OR FINANCING, OR WITHDRAWAL WITHOUT NOTICE, AND OF ANY SPECIAL LISTING CONDITIONS IMPOSED BY OUR PRINCIPALS NO WARRANTIES OR REPRESENTATIONS ARE MADE AS TO THE CONDITION OF THE PROPERTY OR ANY HAZARDS CONTAINED THEREIN ARE ANY TO BE IMPLIED.

NAI Saig Company

6263 Poplar Avenue Suite 150, Memphis, TN 38119

901 526 3100

saigcompany.com

For Lease

Industrial

AVAILABLE

4395 Pidgeon Roost, Memphis, Tennessee

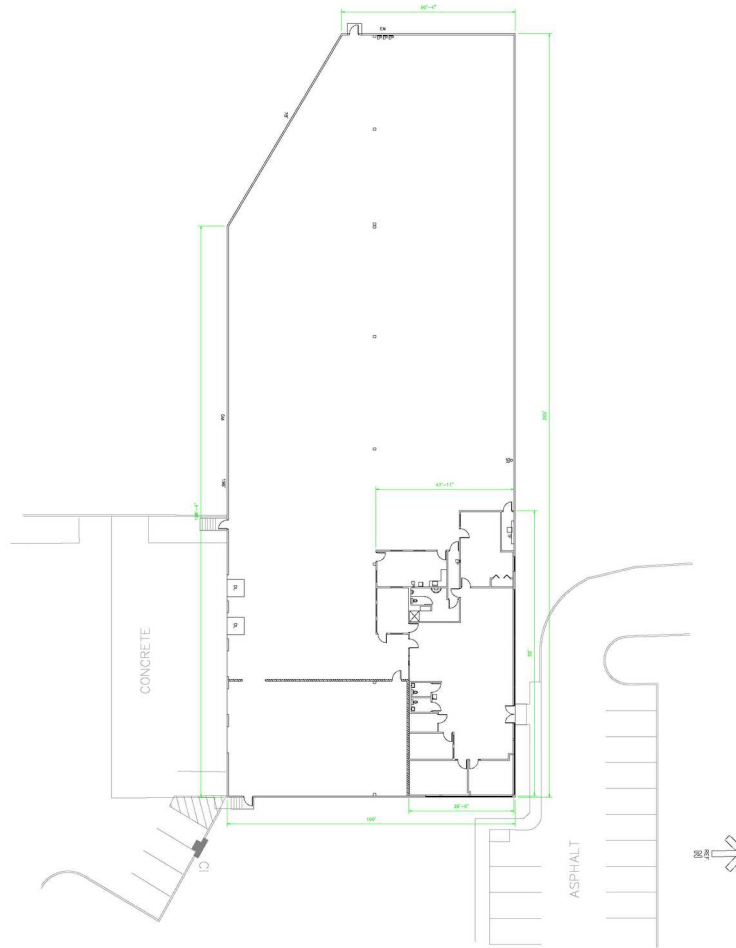

SPACE SUMMARY

LEASABLE AREA	25,280 sq. ft.
OFFICE AREA	3,700 sq. ft.

LEGEND

EP	Electric Panel
TP	Telephone Panel

For Information Contact:

SEALY REAL ESTATE SERVICES
318-222-8700



333 Texas Street, Suite 1050 ■ Shreveport, Louisiana 71101

THIS PLAN IS INTENDED FOR REPRESENTATIONAL PURPOSES ONLY. ALL INFORMATION IS SUBJECT TO CHANGE.

For Lease

Industrial

