

Office | For Lease

CBRE

755 College Road East

Princeton, NJ 08540

Fully Furnished | Plug & Play Office

20,300 RSF | Class A Office





Newly Renovated Common Areas / Building:

- Nespresso High-End Coffee Barista Bar in Lobby
- Fitness Center
- Townhall and Training Room
- Covered Solar Parking
- Electric Vehicle Charging Stations
- Building Storage Available
- Exceptional Landscaping & Newly Paved Parking Lot
- Manned Security Station (6:00am -10:00pm)
- Carbon neutral – 100% green energy





Plug & Play Office Includes:

- Adjustable Height Desks & Screens
- Glass-Wall Executive Offices
- Efficient Open Floor Plan
- Collaboration Tables
- Flatscreen TV Viewing Areas

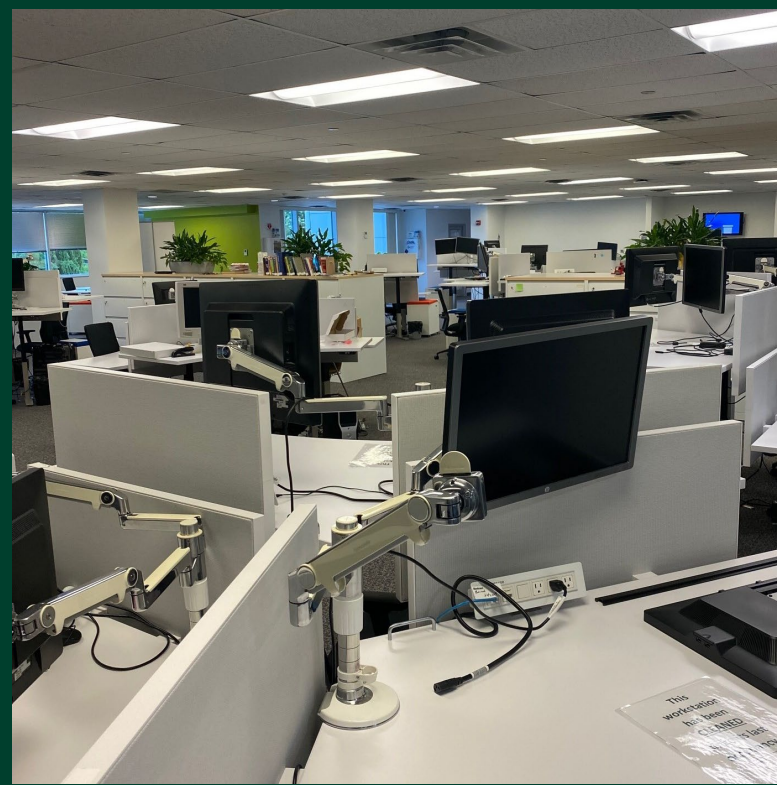

Contact Us

Wesley K. Moore
 Senior Vice President
Wesley.Moore@cbre.com
 M: 732.245.0784

Jeffrey C. Babikian
 Vice Chairman
Jeffrey.Babikian@cbre.com
 M: 201.259.1820

Local Amenities

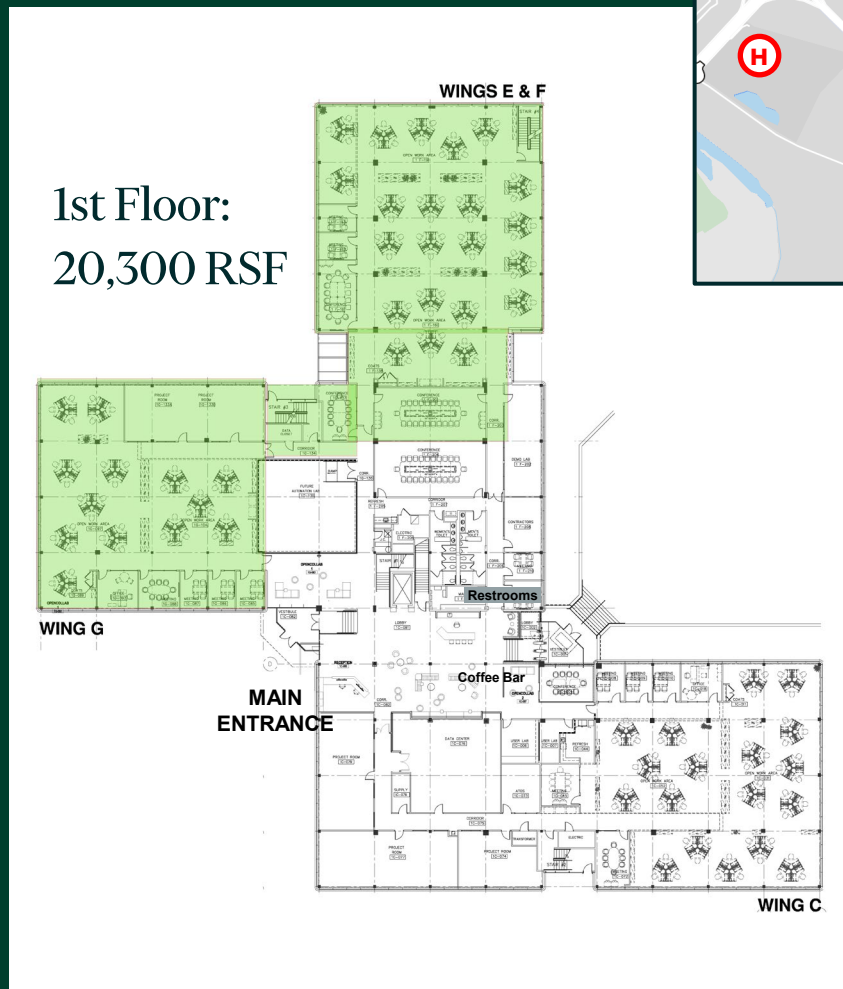
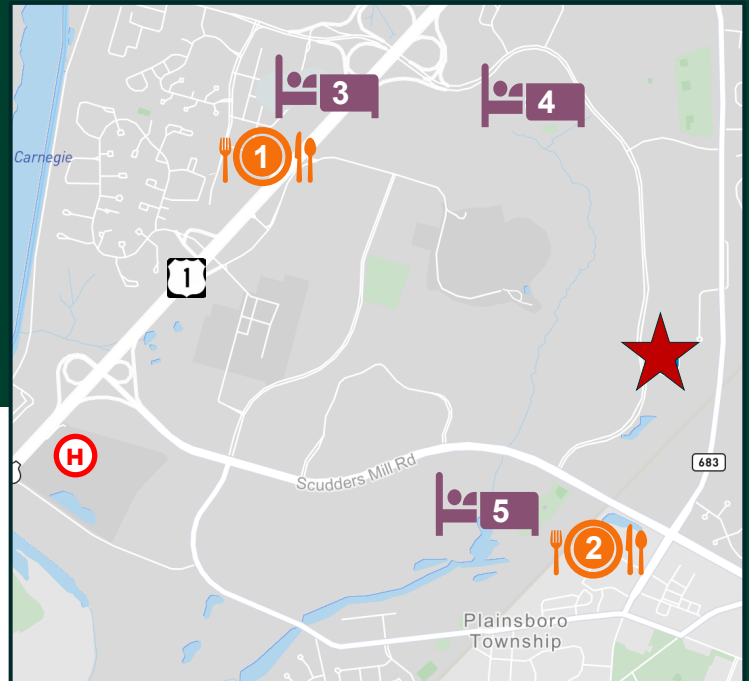

- Princeton Forrestal Village – Food / Shops
- Plainsboro Plaza – Food / Shops
- Westin Hotel
- Marriott Hotel
- Crowne Plaza Hotel
- Penn Medicine Hospital
- Site: 755 College Road East
- Route 1..... 3 Minutes
- NJ Turnpike.....20 Minutes

© 2022 CBRE, Inc. All rights reserved. This information has been obtained from sources believed reliable but has not been verified for accuracy or completeness. CBRE, Inc. makes no guarantee, representation or warranty and accepts no responsibility or liability as to the accuracy, completeness, or reliability of the information contained herein. You should conduct a careful, independent investigation of the property and verify all information. Any reliance on this information is solely at your own risk. CBRE and the CBRE logo are service marks of CBRE, Inc. All other marks displayed on this document are the property of their respective owners, and the use of such marks does not imply any affiliation with or endorsement of CBRE. Photos herein are the property of their respective owners. Use of these images without the express written consent of the owner is prohibited.