



FOR LEASE

1470 CADER LANE

Petaluma, CA 94954



Nick Egide
CA LIC #01859524
(415) 451-4900 x113
nick@meridiancommercial.com

615A E. Washington St.
Petaluma, CA 94952
(415) 451-4900
www.meridiancommercial.com

FOR LEASE

1470 CADER LANE

Petaluma, CA 94954

EXECUTIVE SUMMARY



OFFERING SUMMARY

Property Type: Industrial

Available SF: ± 15,000 SF

Lease Rate: \$1.15 SF/month (NNN)

Building Size: ± 80,000 SF

LOCATION OVERVIEW

Located in the Oakmead Business Park, 1470 Cader represents incredibly hard to find Class A Warehouse Space for lease. Great location for Shipping Distribution with easy access off Highway 116 to both Highway 101 and Highway 80 for trucking. The property is a short distance from Adobe Creek Shopping Center which boasts great dining amenities such as Mr. Pickles, Pub Republic and Starbucks.

PROPERTY OVERVIEW

Newly constructed Warehouse building, Project was completed in August of 2017 by Devcon Construction. 28' clear height, large parking lot, easy truck access and state of the art lighting make 1470 Cader the best in class for Warehouse facilities in Petaluma.

PROPERTY HIGHLIGHTS

- 28' clear height
- 2 grade level doors
- Large parking lot with EV charging stations
- Racking available
- Private entry



Nick Egide
CA LIC #01859524
(415) 451-4900 x113
nick@meridiancommercial.com

615A E. Washington St.
Petaluma, CA 94952
(415) 451-4900

www.meridiancommercial.com

The information herein has not been independently verified by the real estate brokers. Interested parties should have experts of their choice inspect and verify all information. Real estate brokers are not experts with respect to building construction, environmental, legal, tax, and other such matters.

FOR LEASE

1470 CADER LANE
Petaluma, CA 94954

ADDITIONAL PHOTOS



Nick Egide
CA LIC #01859524
(415) 451-4900 x113
nick@meridiancommercial.com

615A E. Washington St.
Petaluma, CA 94952
(415) 451-4900
www.meridiancommercial.com

The information herein has not been independently verified by the real estate brokers. Interested parties should have experts of their choice inspect and verify all information. Real estate brokers are not experts with respect to building construction, environmental, legal, tax, and other such matters.

FOR LEASE

1470 CADER LANE

Petaluma, CA 94954

FLOOR PLANS

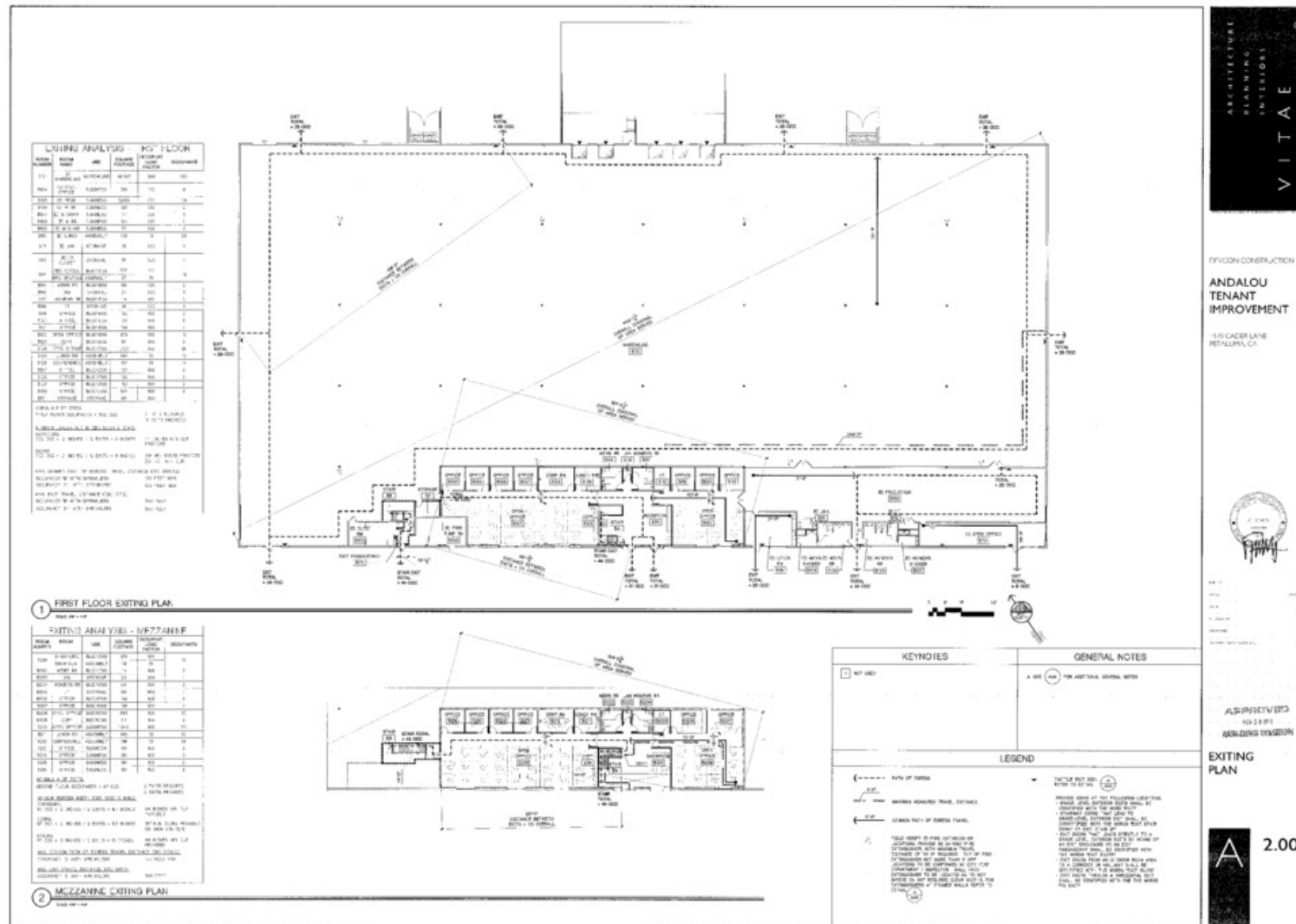

FOR LEASE

1470 CADER LANE

Petaluma, CA 94954

LOCATION MAPS



Nick Egide
CA LIC #01859524
(415) 451-4900 x113
nick@meridiancommercial.com

615A E. Washington St.
Petaluma, CA 94952
(415) 451-4900
www.meridiancommercial.com

The information herein has not been independently verified by the real estate brokers. Interested parties should have experts of their choice inspect and verify all information. Real estate brokers are not experts with respect to building construction, environmental, legal, tax, and other such matters.

FOR LEASE

1470 CADER LANE

Petaluma, CA 94954

RETAILER MAP



Nick Egide
CA LIC #01859524
(415) 451-4900 x113
nick@meridiancommercial.com

615A E. Washington St.
Petaluma, CA 94952
(415) 451-4900
www.meridiancommercial.com

The information herein has not been independently verified by the real estate brokers. Interested parties should have experts of their choice inspect and verify all information. Real estate brokers are not experts with respect to building construction, environmental, legal, tax, and other such matters.

FOR LEASE

1470 CADER LANE

Petaluma, CA 94954

DEMOGRAPHICS MAP & REPORT

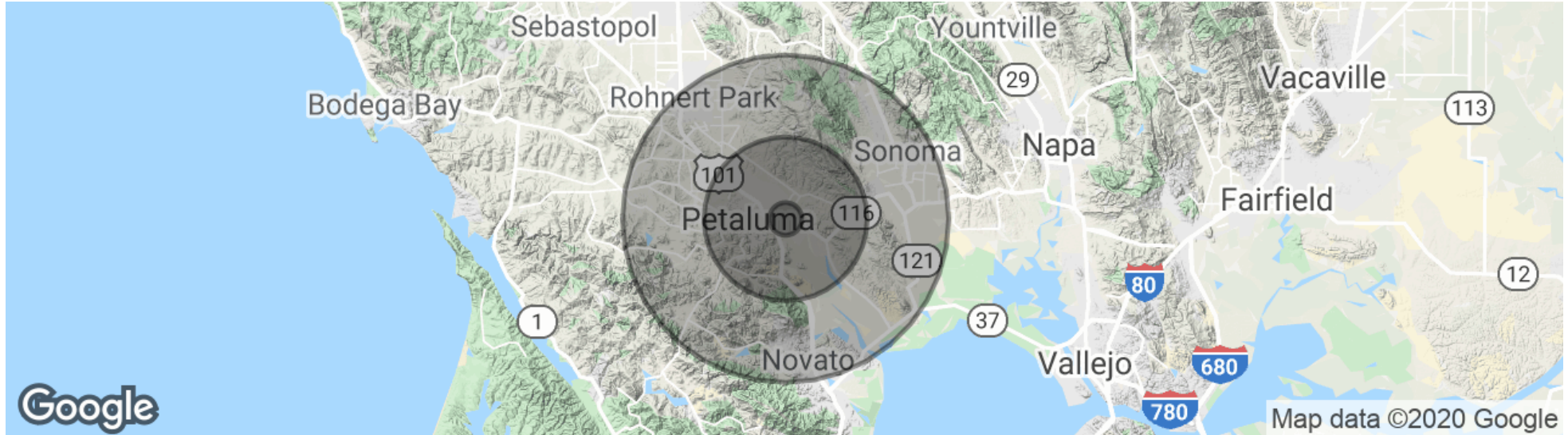

POPULATION

	1 MILE	5 MILES	10 MILES
Total population	7,765	69,005	183,187
Median age	39.9	39.7	39.9
Median age (Male)	38.5	38.2	38.5
Median age (Female)	40.9	41.2	41.4

HOUSEHOLDS & INCOME

	1 MILE	5 MILES	10 MILES
Total households	2,764	25,890	70,040
# of persons per HH	2.9	2.7	2.6
Average HH income	\$92,471	\$90,691	\$92,258
Average house value	\$630,522	\$611,156	\$638,739



Nick Egide
CA LIC #01859524
(415) 451-4900 x113
nick@meridiancommercial.com

615A E. Washington St.
Petaluma, CA 94952
(415) 451-4900
www.meridiancommercial.com

The information herein has not been independently verified by the real estate brokers. Interested parties should have experts of their choice inspect and verify all information. Real estate brokers are not experts with respect to building construction, environmental, legal, tax, and other such matters.