

**Bloomington Avenue Outparcel**  
**SEC of Bloomington and John Moore Road**  
**35,754 +/- net usable area**

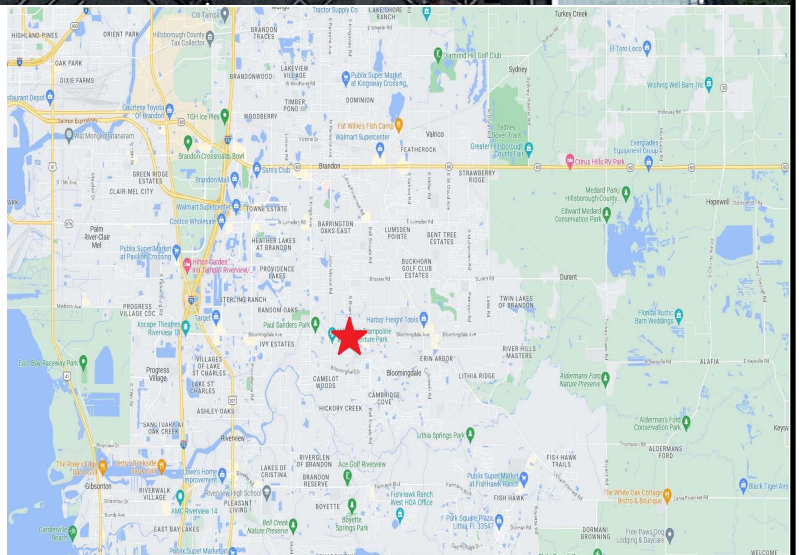

**About the Property**

- Previously approved for 4,000 square feet
- High traffic counts - 40,500 AADT
- Dense and affluent market
- All utilities are to the plaza
- Perfect for coffee, restaurant or medical
- Cross parking likely available
- \$75,000 annually - NNN terms.



**Patrick Turtle**  
**Cell: 813-340-6894**  
**Email: [patrick@patrickturtleinc.com](mailto:patrick@patrickturtleinc.com)**

