

MEDICAL OFFICE

3,400 SQ FT ON TUALATIN VALLEY HWY

4095 SOUTHWEST 144TH AVENUE, BEAVERTON, OR 97005



FOR LEASE

PRESENTED BY:

**CAMERON SCHWAB**

Oregon Licensed Commercial Broker

O: (503) 451-0745

[schwab@kwcommercial.com](mailto:schwab@kwcommercial.com)

License #: 201220872

**SCHWAB COMMERCIAL**

16365 Boones Ferry Rd

Lake Oswego, OR 97068

**kw** PORTLAND  
PREMIERE  
KELLERWILLIAMS. REALTY

Each Office Independently Owned and Operated

We obtained the information above from sources we believe to be reliable. However, we have not verified its accuracy and make no guarantee, warranty or representation about it. It is submitted subject to the possibility of errors, omissions, change of price, rental or other conditions, prior sale, lease or financing, or withdrawal without notice. We include projections, opinions, assumptions or estimates for example only, and they may not represent current or future performance of the property. You and your tax and legal advisors should conduct your own investigation of the property and transaction.

# EXECUTIVE SUMMARY

4095 SOUTHWEST 144TH AVENUE



## OFFERING SUMMARY

|                     |                              |
|---------------------|------------------------------|
| LEASE RATE:         | Call Broker                  |
| BUILDING SF:        | 7,600                        |
| RENTABLE SF:        | 3,422                        |
| AVAILABLE SF:       | 1,600 - 3,422                |
| RENOVATED:          | 2011                         |
| FLOORS:             | 1                            |
| CLIMATE CONTROL:    | HVAC                         |
| OFF-STREET PARKING: | 26 Vehicles                  |
| STREET PARKING EST. | 25+ Vehicles                 |
| PARKING RATIO:      | 3.42 Off-Street / 6.71 Total |
| ZONING:             | GC - General Commercial      |

## PROPERTY OVERVIEW

4095 SW 144th Ave is a multi-tenant medical office building in central Beaverton. It features a 26 stall parking lot and ample street parking on 144th.

The building is evenly divided into a north and south wing, with shared lobby, bathrooms, and service rooms between them. The north half of the building is vacant and available for lease; it includes two suites, which are available separately or combined.

The eastern available space features numerous open spaces, private offices, a kitchenette, and a reception area. The western space includes a mix of open plan and private offices with one private bathroom. Previous uses include dental, senior living office, and orthodontics.

4095 SW 144th offers spaces ranging from approx. 1,600 Sq Ft up to 3422 Sq Ft. It is perfect for medical and professional tenants, including counseling services, clinics, spas, chiropractors, and more.

## LOCATION OVERVIEW

Beaverton is a major suburb of Portland featuring major companies like Nike, Tektronix, IBM, and Reser's Fine Foods. 4095 SW 144th is on SW Tualatin Valley Hwy, one of the primary arterial roads of Washington County. It is surrounded by high density apartments, restaurants, and auto dealerships.



# LEASE OPTIONS

4095 SOUTHWEST 144TH AVENUE



## Layout 1



## Layout 2

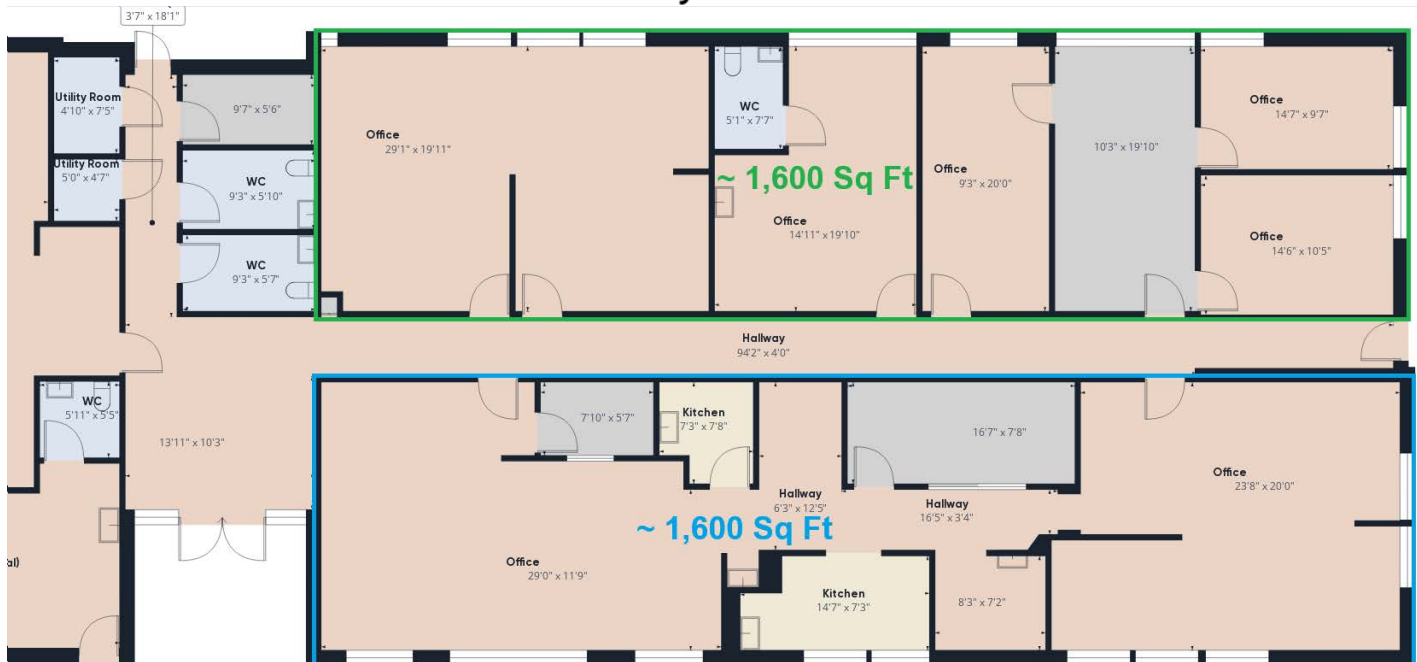

### CAMERON SCHWAB

Oregon Licensed Commercial Broker  
O: (503) 451-0745  
schwab@kwcommercial.com  
License #: 201220872

### SCHWAB COMMERCIAL

16365 Boones Ferry Rd  
Lake Oswego, OR 97068

# EAST SUITE PHOTOS

4095 SOUTHWEST 144TH AVENUE





# EAST SUITE PHOTOS

4095 SOUTHWEST 144TH AVENUE



# WEST SUITE PHOTOS

4095 SOUTHWEST 144TH AVENUE





# COMMON AREA PHOTOS

4095 SOUTHWEST 144TH AVENUE

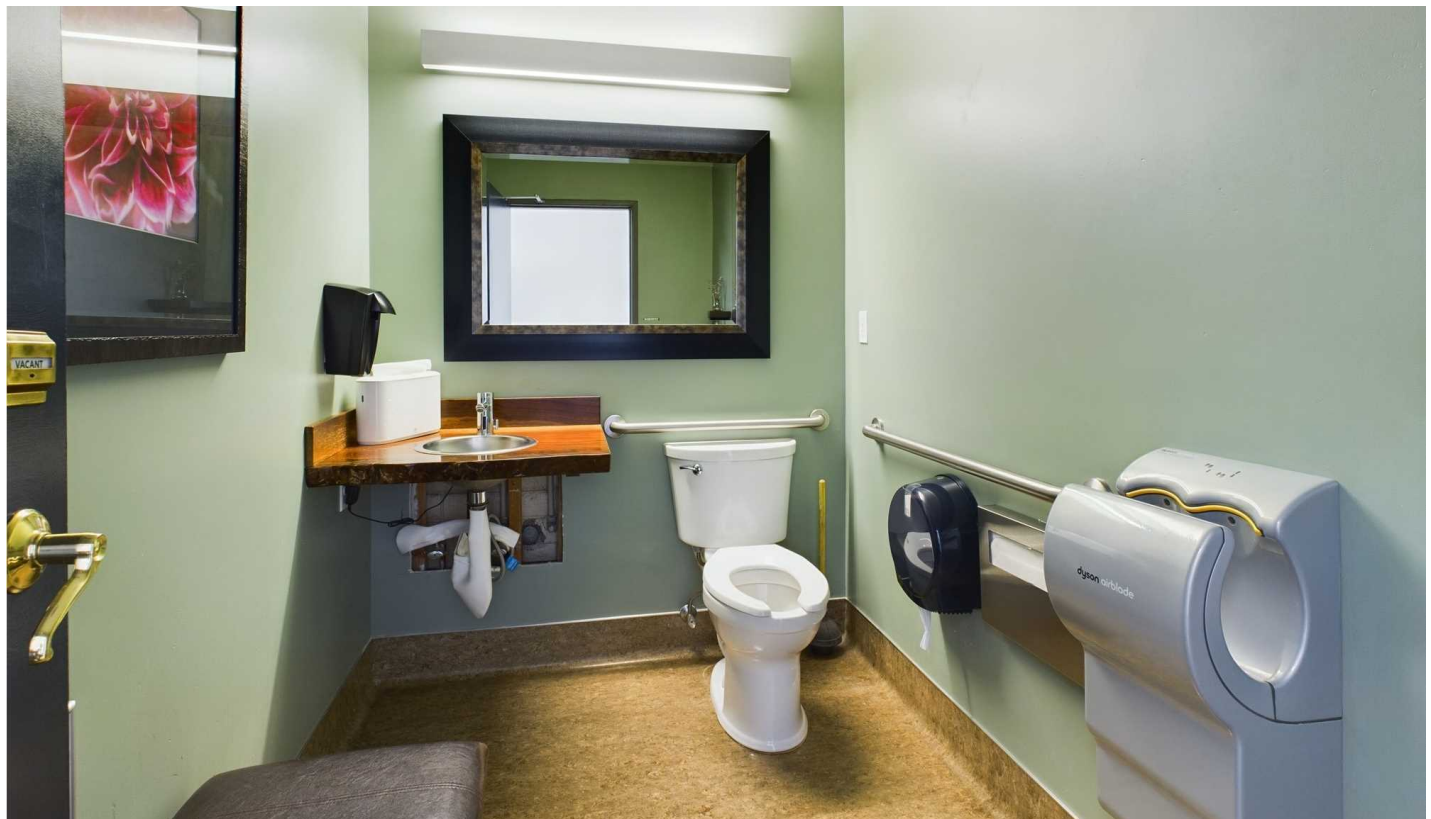
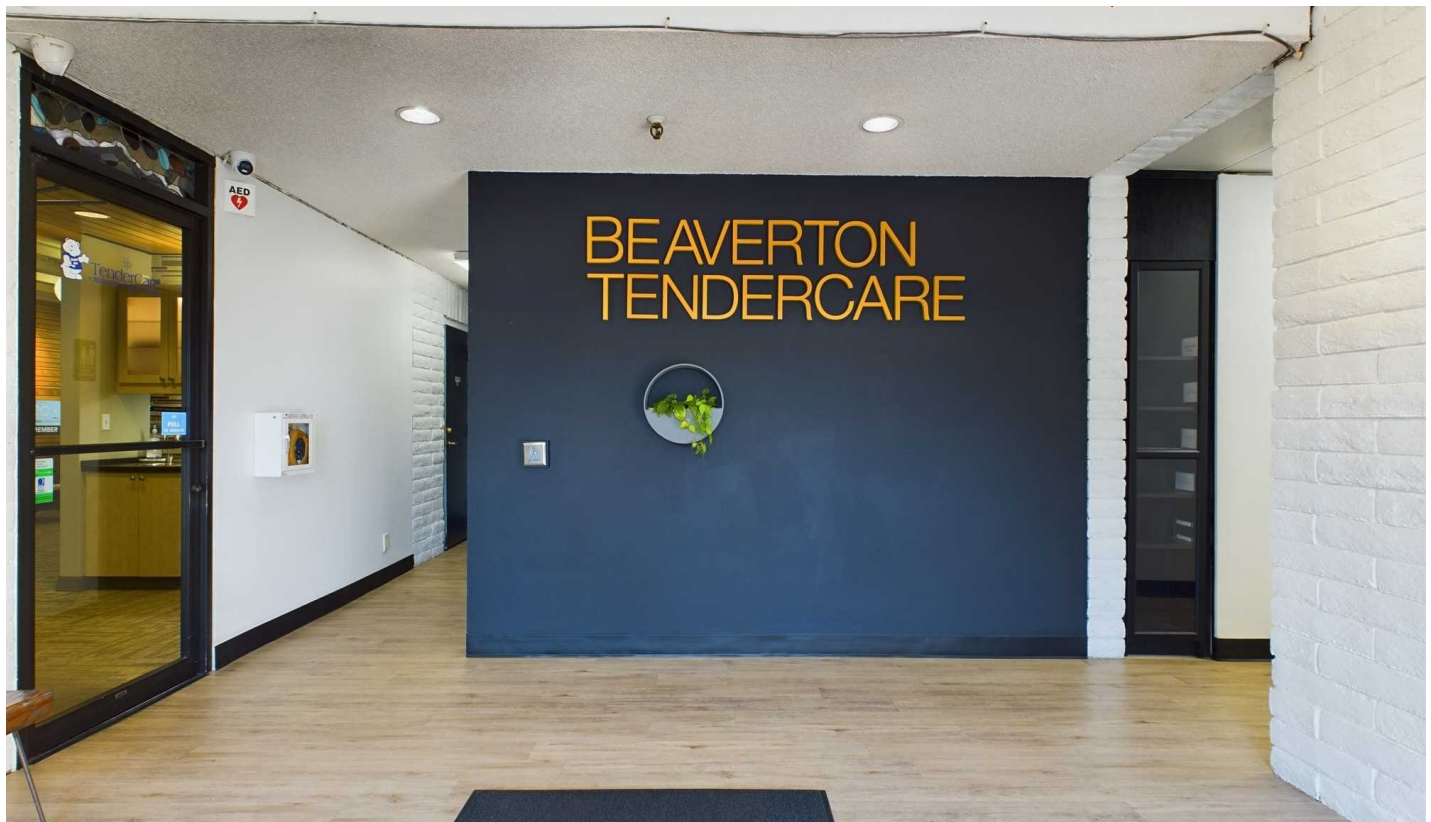

## CAMERON SCHWAB

Oregon Licensed Commercial Broker  
O: (503) 451-0745  
schwab@kwcommercial.com  
License #: 201220872

## SCHWAB COMMERCIAL

16365 Boones Ferry Rd  
Lake Oswego, OR 97068



# EXTERIOR PHOTOS

4095 SOUTHWEST 144TH AVENUE



## CAMERON SCHWAB

Oregon Licensed Commercial Broker  
O: (503) 451-0745  
schwab@kwcommercial.com  
License #: 201220872

## SCHWAB COMMERCIAL

16365 Boones Ferry Rd  
Lake Oswego, OR 97068



# LOCATION MAPS

4095 SOUTHWEST 144TH AVENUE

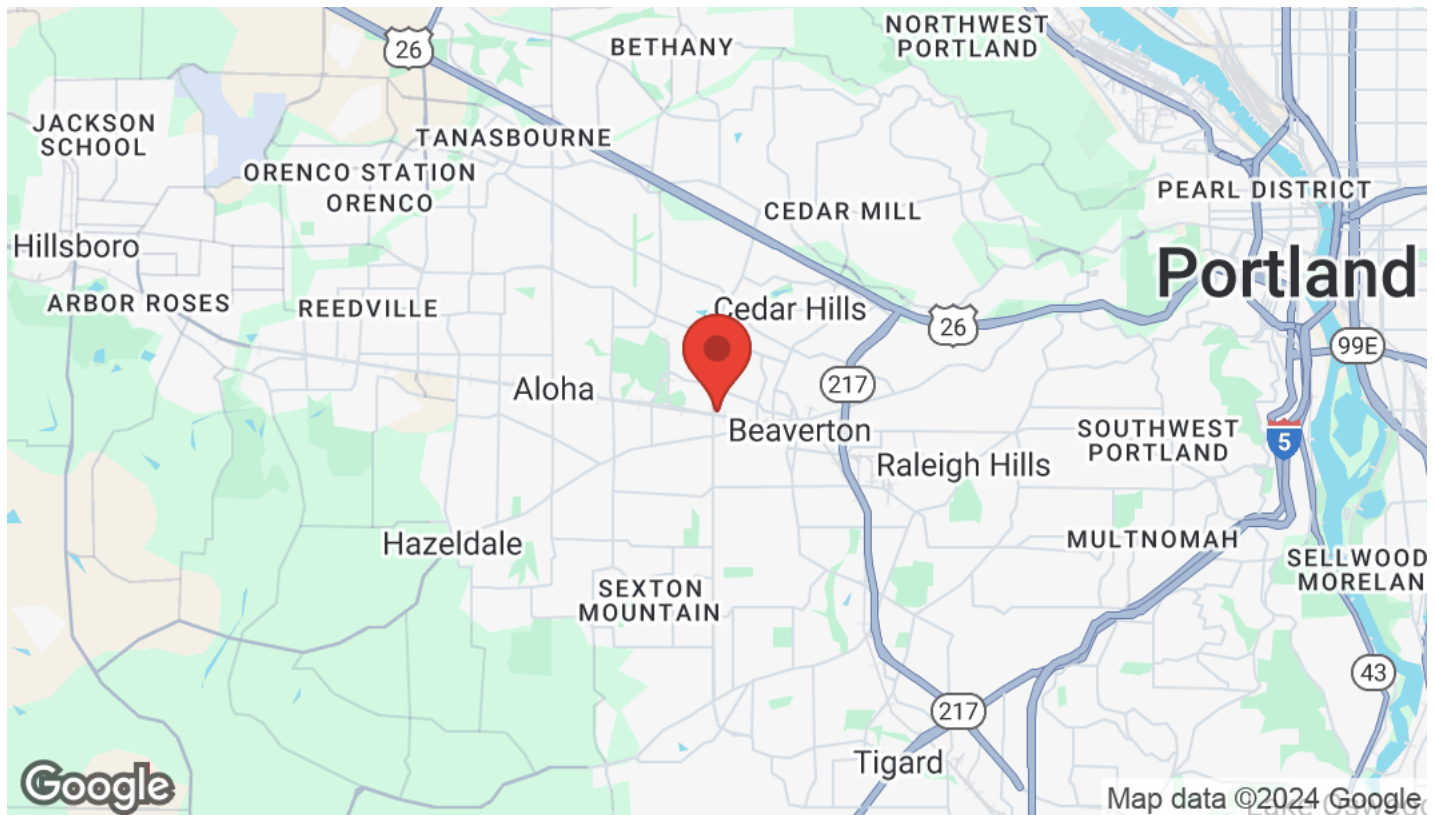
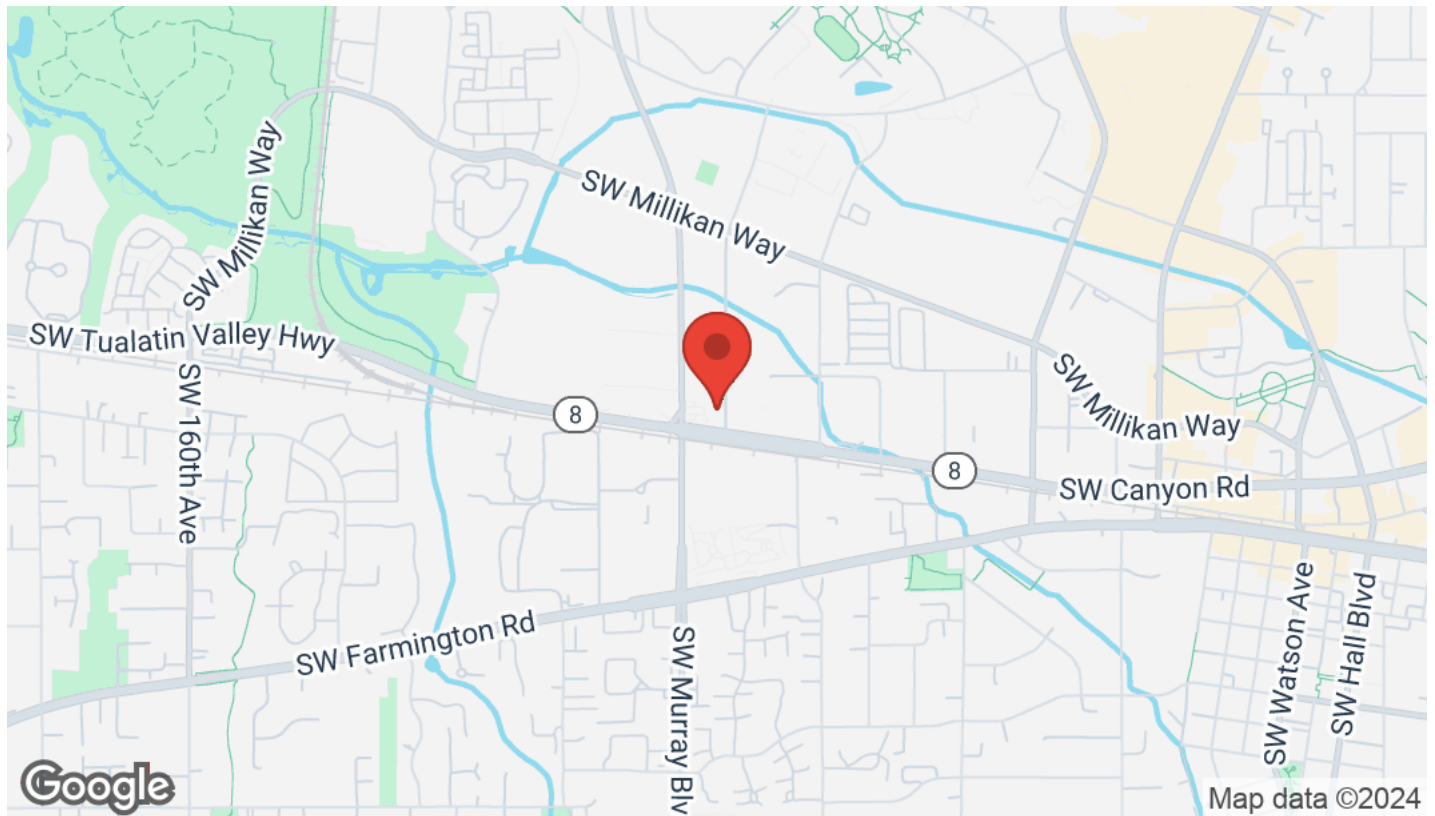

## CAMERON SCHWAB

Oregon Licensed Commercial Broker  
O: (503) 451-0745  
schwab@kwcommercial.com  
License #: 201220872

## SCHWAB COMMERCIAL

16365 Boones Ferry Rd  
Lake Oswego, OR 97068



# AERIAL MAP

4095 SOUTHWEST 144TH AVENUE

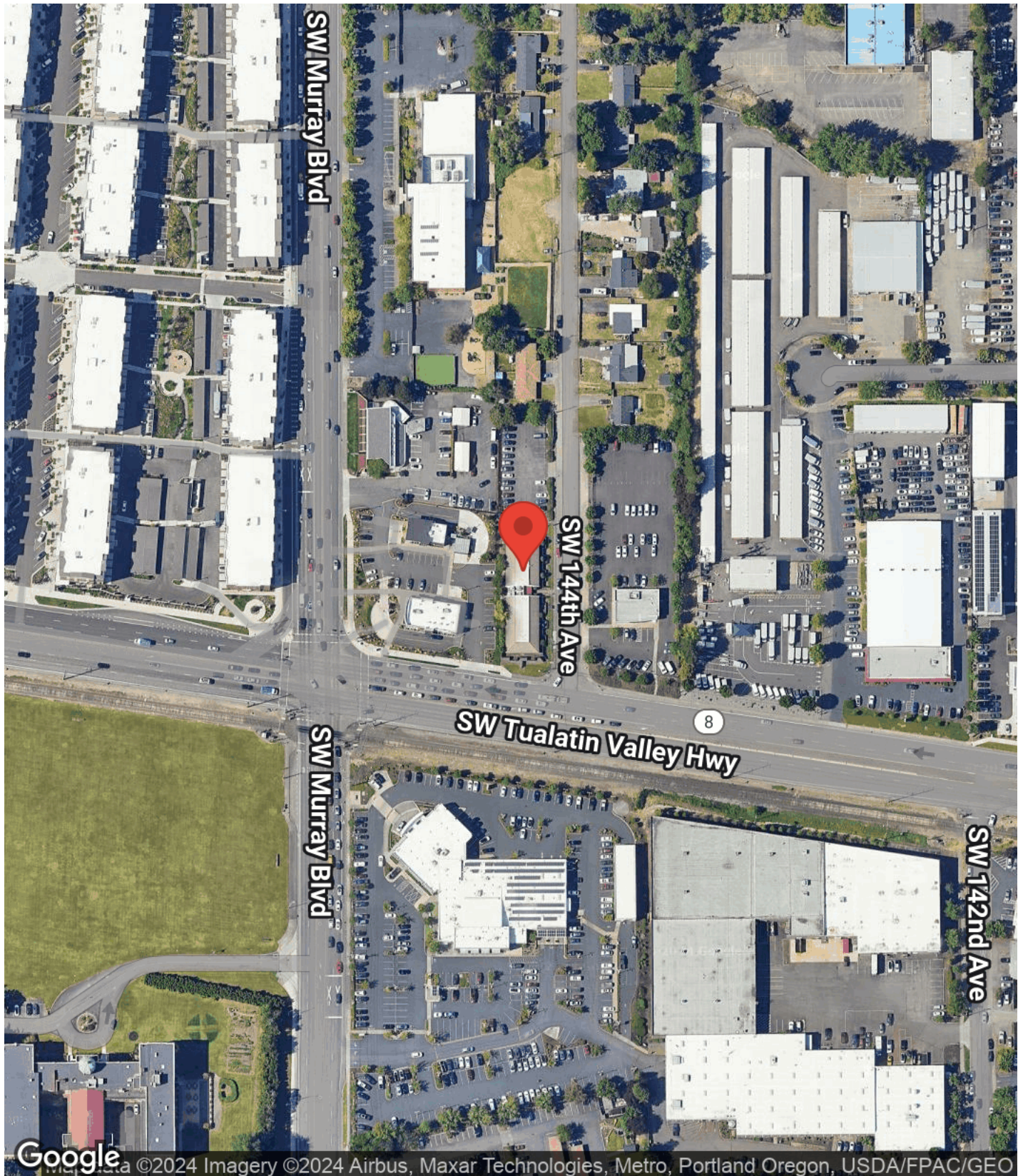

## CAMERON SCHWAB

Oregon Licensed Commercial Broker  
O: (503) 451-0745  
schwab@kwcommercial.com  
License #: 201220872

## SCHWAB COMMERCIAL

16365 Boones Ferry Rd  
Lake Oswego, OR 97068





# BUSINESS MAP

4095 SOUTHWEST 144TH AVENUE





 LA Fitness

 Century Theater

 Nike Company Store

 Ross

 Burn Boot Camp

 Office Depot

 Sushi Hana

 7-Eleven

 SeaSweets Poke

 New Seasons Market

 Cafe Yumm!

 Vstar Nails & Spa

 Chase Bank

 Mikiko Mochi Donuts

 Prime Tap House

 Cascade Bikes

 Portland Cider Company

 Kaady Car Washes

 The Human Bean

 Carl's Jr.

 The BedMart Outlet

 Black Bear Diner

 Plaid Pantry

 7-Eleven

# DEMOGRAPHICS

4095 SOUTHWEST 144TH AVENUE

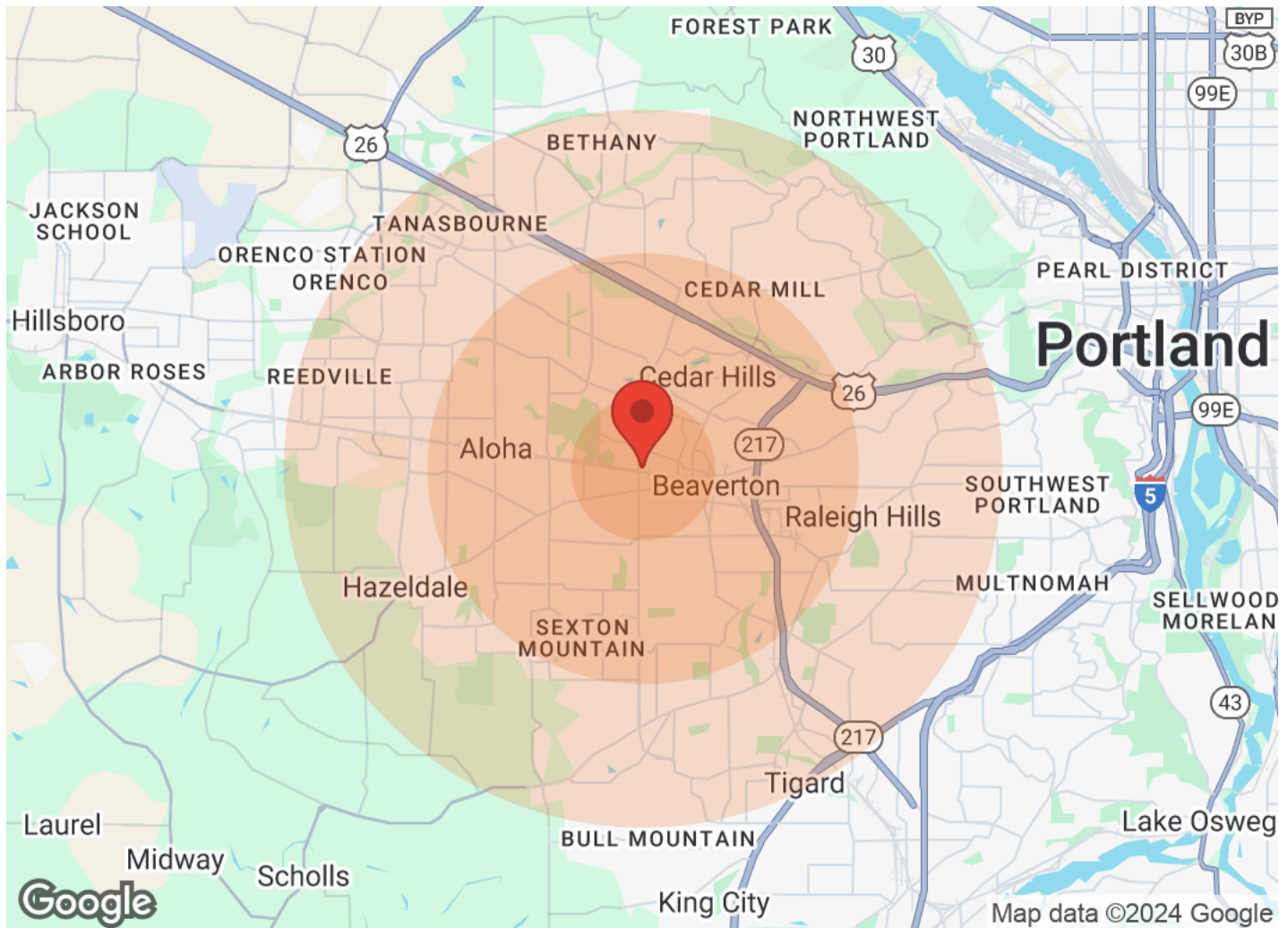

| Population       | 1 Mile | 3 Miles | 5 Miles | Income              | 1 Mile   | 3 Miles  | 5 Miles  |
|------------------|--------|---------|---------|---------------------|----------|----------|----------|
| Male             | 8,830  | 75,601  | 176,663 | Median              | \$41,107 | \$58,773 | \$65,059 |
| Female           | 9,514  | 79,046  | 182,287 | < \$15,000          | 1,384    | 5,390    | 10,695   |
| Total Population | 18,344 | 154,647 | 358,950 | \$15,000-\$24,999   | 1,077    | 5,350    | 10,725   |
|                  |        |         |         | \$25,000-\$34,999   | 1,128    | 6,309    | 13,009   |
|                  |        |         |         | \$35,000-\$49,999   | 1,330    | 9,031    | 18,749   |
|                  |        |         |         | \$50,000-\$74,999   | 1,411    | 12,401   | 26,583   |
|                  |        |         |         | \$75,000-\$99,999   | 620      | 7,867    | 19,441   |
|                  |        |         |         | \$100,000-\$149,999 | 500      | 8,422    | 22,998   |
|                  |        |         |         | \$150,000-\$199,999 | 85       | 3,199    | 9,232    |
|                  |        |         |         | > \$200,000         | 137      | 2,170    | 8,709    |
|                  |        |         |         |                     |          |          |          |
| Age              | 1 Mile | 3 Miles | 5 Miles | Housing             | 1 Mile   | 3 Miles  | 5 Miles  |
| Ages 0-14        | 4,012  | 31,846  | 73,414  | Total Units         | 7,896    | 63,391   | 149,222  |
| Ages 15-24       | 2,130  | 19,904  | 48,074  | Occupied            | 7,457    | 59,768   | 141,030  |
| Ages 25-54       | 7,823  | 62,444  | 143,967 | Owner Occupied      | 2,124    | 33,754   | 85,153   |
| Ages 55-64       | 1,791  | 18,676  | 44,563  | Renter Occupied     | 5,333    | 26,014   | 55,877   |
| Ages 65+         | 2,588  | 21,777  | 48,932  | Vacant              | 439      | 3,623    | 8,192    |
|                  |        |         |         |                     |          |          |          |
| Race             | 1 Mile | 3 Miles | 5 Miles |                     |          |          |          |
| White            | 11,574 | 114,827 | 273,819 |                     |          |          |          |
| Black            | 699    | 2,837   | 5,317   |                     |          |          |          |
| Am In/AK Nat     | 73     | 381     | 686     |                     |          |          |          |
| Hawaiian         | 14     | 123     | 492     |                     |          |          |          |
| Hispanic         | 6,144  | 31,658  | 52,510  |                     |          |          |          |
| Multi-Racial     | 9,354  | 47,096  | 81,140  |                     |          |          |          |

**CAMERON SCHWAB**  
Oregon Licensed Commercial Broker  
O: (503) 451-0745  
schwab@kwcommercial.com  
License #: 201220872

**SCHWAB COMMERCIAL**  
16365 Boones Ferry Rd  
Lake Oswego, OR 97068



# DISCLAIMER

4095 SOUTHWEST 144TH AVENUE



All materials and information received or derived from KW Commercial its directors, officers, agents, advisors, affiliates and/or any third party sources are provided without representation or warranty as to completeness, veracity, or accuracy, condition of the property, compliance or lack of compliance with applicable governmental requirements, developability or suitability, financial performance of the property, projected financial performance of the property for any party's intended use or any and all other matters.

Neither KW Commercial its directors, officers, agents, advisors, or affiliates makes any representation or warranty, express or implied, as to accuracy or completeness of the materials or information provided, derived, or received. Materials and information from any source, whether written or verbal, that may be furnished for review are not a substitute for a party's active conduct of its own due diligence to determine these and other matters of significance to such party. KW Commercial will not investigate or verify any such matters or conduct due diligence for a party unless otherwise agreed in writing.

EACH PARTY SHALL CONDUCT ITS OWN INDEPENDENT INVESTIGATION AND DUE DILIGENCE.

Any party contemplating or under contract or in escrow for a transaction is urged to verify all information and to conduct their own inspections and investigations including through appropriate third-party independent professionals selected by such party. All financial data should be verified by the party including by obtaining and reading applicable documents and reports and consulting appropriate independent professionals. KW Commercial makes no warranties and/or representations regarding the veracity, completeness, or relevance of any financial data or assumptions. KW Commercial does not serve as a financial advisor to any party regarding any proposed transaction.

All data and assumptions regarding financial performance, including that used for financial modeling purposes, may differ from actual data or performance. Any estimates of market rents and/or projected rents that may be provided to a party do not necessarily mean that rents can be established at or increased to that level. Parties must evaluate any applicable contractual and governmental limitations as well as market conditions, vacancy factors and other issues in order to determine rents from or for the property. Legal questions should be discussed by the party with an attorney. Tax questions should be discussed by the party with a certified public accountant or tax attorney. Title questions should be discussed by the party with a title officer or attorney. Questions regarding the condition of the property and whether the property complies with applicable governmental requirements should be discussed by the party with appropriate engineers, architects, contractors, other consultants, and governmental agencies. All properties and services are marketed by KW Commercial in compliance with all applicable fair housing and equal opportunity laws.

**kw** PORTLAND  
PREMIERE  
KELLERWILLIAMS. REALTY  
Each Office Independently Owned and Operated

## PRESENTED BY:

**CAMERON SCHWAB**  
Oregon Licensed Commercial Broker  
O: (503) 451-0745  
schwab@kwcommercial.com  
License #: 201220872

**SCHWAB COMMERCIAL**  
16365 Boones Ferry Rd  
Lake Oswego, OR 97068

The calculations and data presented are deemed to be accurate, but not guaranteed. They are intended for the purpose of illustrative projections and analysis. The information provided is not intended to replace or serve as substitute for any legal, accounting, investment, real estate, tax or other professional advice, consultation or service. The user of this software should consult with a professional in the respective legal, accounting, tax or other professional area before making any decisions.