

# For Lease Or Ground Lease:

7300 E. McDowell Road, Scottsdale

2.12 Acres

Perfect For Auto Sales or Redevelopment Project

Highly Coveted McDowell Road Corridor



SOUTHWEST RETAIL GROUP, INC.

7527 East First Street  
Scottsdale, AZ 85251  
480.946.6609

[southwestretail.com](http://southwestretail.com)

Call For Pricing  
Trent J. Goulette  
[Trent@southwestretail.com](mailto:Trent@southwestretail.com)

No warranty or representation, expressed or implied, is made as to the accuracy of the information herein and same is submitted to errors, omissions, change in pricing, rates, or other conditions. It is the responsibility of the recipient to independently confirm its accuracy and completeness.

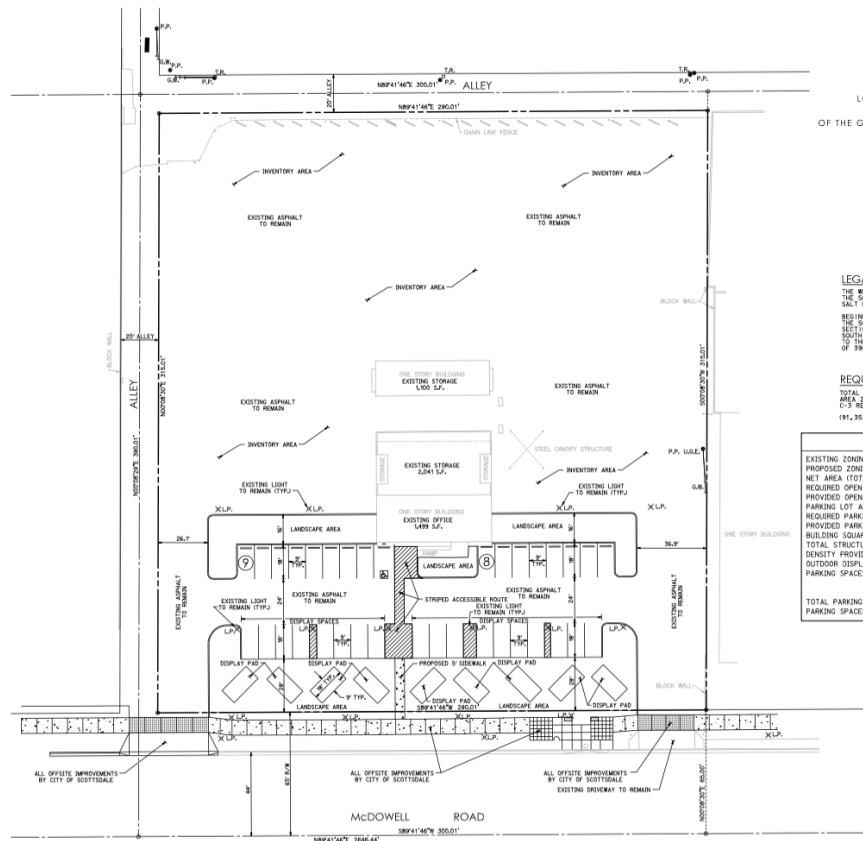

7300 E. MCDOWELL ROAD  
SCOTTSDALE, ARIZONA 85257  
LOCATED IN A PORTION OF THE SOUTHWEST QUARTER OF  
SECTION 35, TOWNSHIP 2 NORTH, RANGE 4 EAST  
OF THE GILA AND SALT RIVER MERIDIAN, MARICOPA COUNTY, ARIZONA

PARCEL ADDRESS:  
7300 E. MCDOWELL ROAD  
SCOTTSDALE, AZ 85257

**LEGAL DESCRIPTION:**

THE BEST TWO FEET OF THAT PORTION OF THE SOUTHWEST QUARTER OF THE SOUTHWEST QUARTER OF SECTION 35, TOWNSHIP 2 NORTH, RANGE 4 EAST OF THE GILA AND SALT RIVER MERIDIAN, MARICOPA COUNTY, ARIZONA, DESCRIBED AS FOLLOWS:  
BEGINNING AT THE SOUTHWEST CORNER OF THE SOUTHWEST QUARTER OF THE SOUTHWEST QUARTER OF SECTION 35, TOWNSHIP 2 NORTH, RANGE 4 EAST OF THE GILA AND SALT RIVER MERIDIAN, MARICOPA COUNTY, ARIZONA, THENCE EAST, ALONG THE SOUTH LINE OF SAID SECTION 35, A DISTANCE OF 481 FEET TO A POINT, THENCE NORTH, AT A RIGHT ANGLE TO THE SOUTH LINE OF SAID SECTION 35, A DISTANCE OF 390 FEET TO A POINT, THENCE WEST, PARALLEL TO THE SOUTH LINE OF SAID SECTION 35, A DISTANCE OF 481 FEET, THENCE SOUTH A DISTANCE OF 390 FEET TO THE POINT OF BEGINNING.

**REQUIRED OPEN SPACE CALCULATION:**

TOTAL AREA = 91,353 SF  
AREA ADJUSTED FOR 10% BUFFER OF  
OPEN SPACE REQUIRED FOR OPEN SPACE  
(91,353 X 0.10) = 9,135 SF

**PROJECT DATA**

EXISTING ZONING	C-3
PROPOSED ZONING	C-3
NET AREA (TOTAL PARCEL)	91,353 SQ. FT. OR 2.097 AC
REQUIRED OPEN SPACE	9,135 SQ. FT. 10.00%
PROVIDED OPEN SPACE	9,207 SQ. FT. 10.08%
PARKING LOT AREA	8,494 SQ. FT.
REQUIRED PARKING LANDSCAPE	1,274 SQ. FT. 15.00%
PROVIDED PARKING LANDSCAPE	1,283 SQ. FT. 15.15%
BUILDING SQUARE FOOTAGE	1,499 SQ. FT.
TOTAL STRUCTURE SQUARE FOOTAGE	1,499 SQ. FT.
DENSITY PROVIDED	5.08%
OUTDOOR DISPLAY SPACES	27 SPACES
PARKING SPACES REQUIRED	1/200 S.F. (EMPLOYEE), 8 SPACES
TOTAL PARKING SPACES REQUIRED	1/200 OUTDOOR DISPLAY (EMPLOYEE), 2 SPACES
PARKING SPACES PROVIDED (INCLUDING 1 ADA SPACE)	17 SPACES



SOUTHWEST RETAIL GROUP, INC.

7527 East First Street  
Scottsdale, AZ 85251  
480.946.6609

[southwestretail.com](http://southwestretail.com)

Trent J. Goulette  
[Trent@southwestretail.com](mailto:Trent@southwestretail.com)

No warranty or representation, expressed or implied, is made as to the accuracy of the information herein and same is submitted to errors, omissions, change in pricing, rates, or other conditions. It is the responsibility of the recipient to independently confirm its accuracy and completeness.