

KENT WEST

CORPORATE PARK

FOR LEASE
47,821 SF

AVAILABLE NOW



THE ANDOVER
COMPANY, INC.

CORFAC INTERNATIONAL

BRIAN BRUININKS, CCIM
(206) 336-5324
bbruininks@andoverco.com

SHANE MAHVI
(206) 336-5338
smahvi@andoverco.com

SITE PLAN

AVAILABLE:

47,821 SF - SUITE 21901

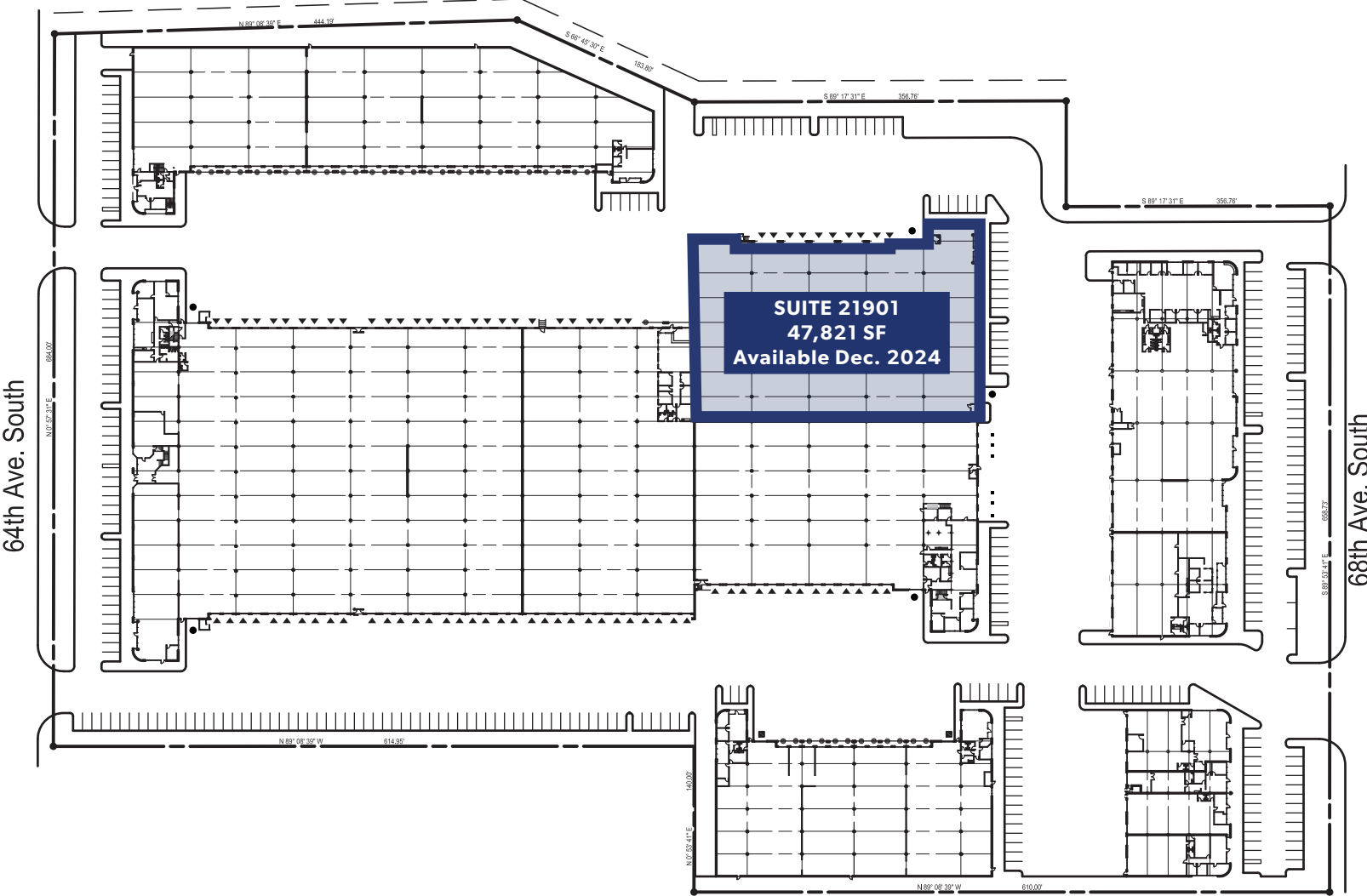

The information contained herein has been obtained from reliable sources, but is not guaranteed. A prospective buyer/tenant should verify each item relating to this property and all information contained herein.



47,821 SF TOTAL

Size: **47,821 SF TOTAL**

Office Space: **76 SF (RESTROOMS)**

Clear Height: **24'**

Docks: **10 (5 Pit Levelers, 1 Edge of Dock Levelers)**

Grade Level: **2 (1 oversized 12' x 14')**

Available: **Now**

Notes: **End cap space with unopposed truck court.**
Please call Brian and Shane for rates, operating expenses and to arrange a site visit.

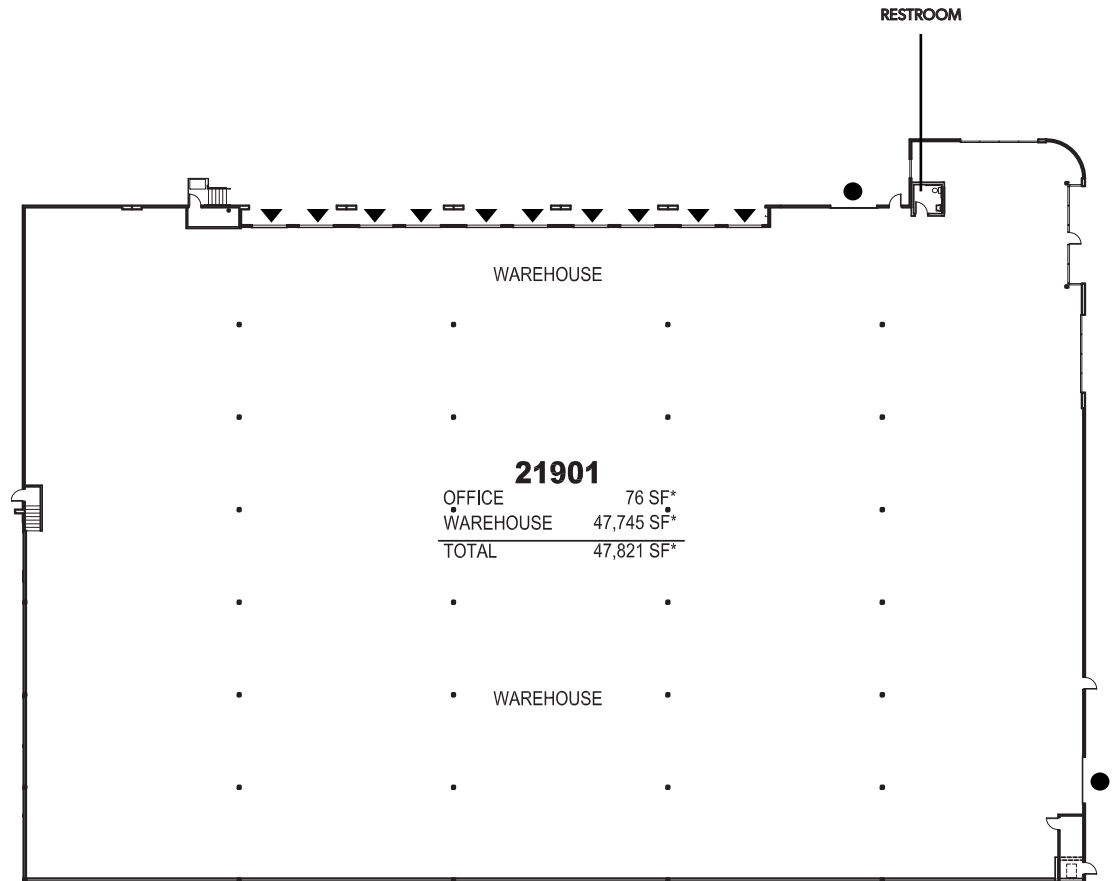
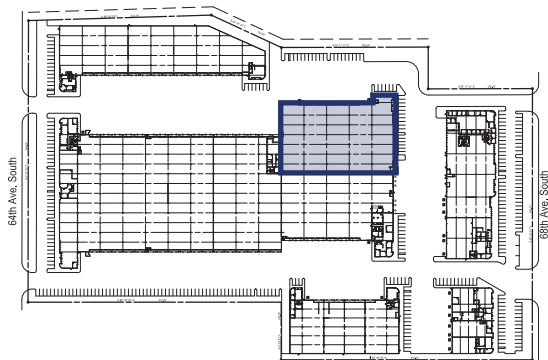

21901	
OFFICE	76 SF*
WAREHOUSE	47,745 SF*
TOTAL	47,821 SF*

- ▲ Dock high door
- Drive-in door

21901 67TH AVE S
KENT, WA

BRIAN BRUININKS, CCIM
(206) 336-5324
bbuininks@andoverco.com

SHANE MAHVI
(206) 336-5338
smahvi@andoverco.com

THE ANDOVER
COMPANY, INC.
CORFAC INTERNATIONAL

CONVENIENT COMMUTE

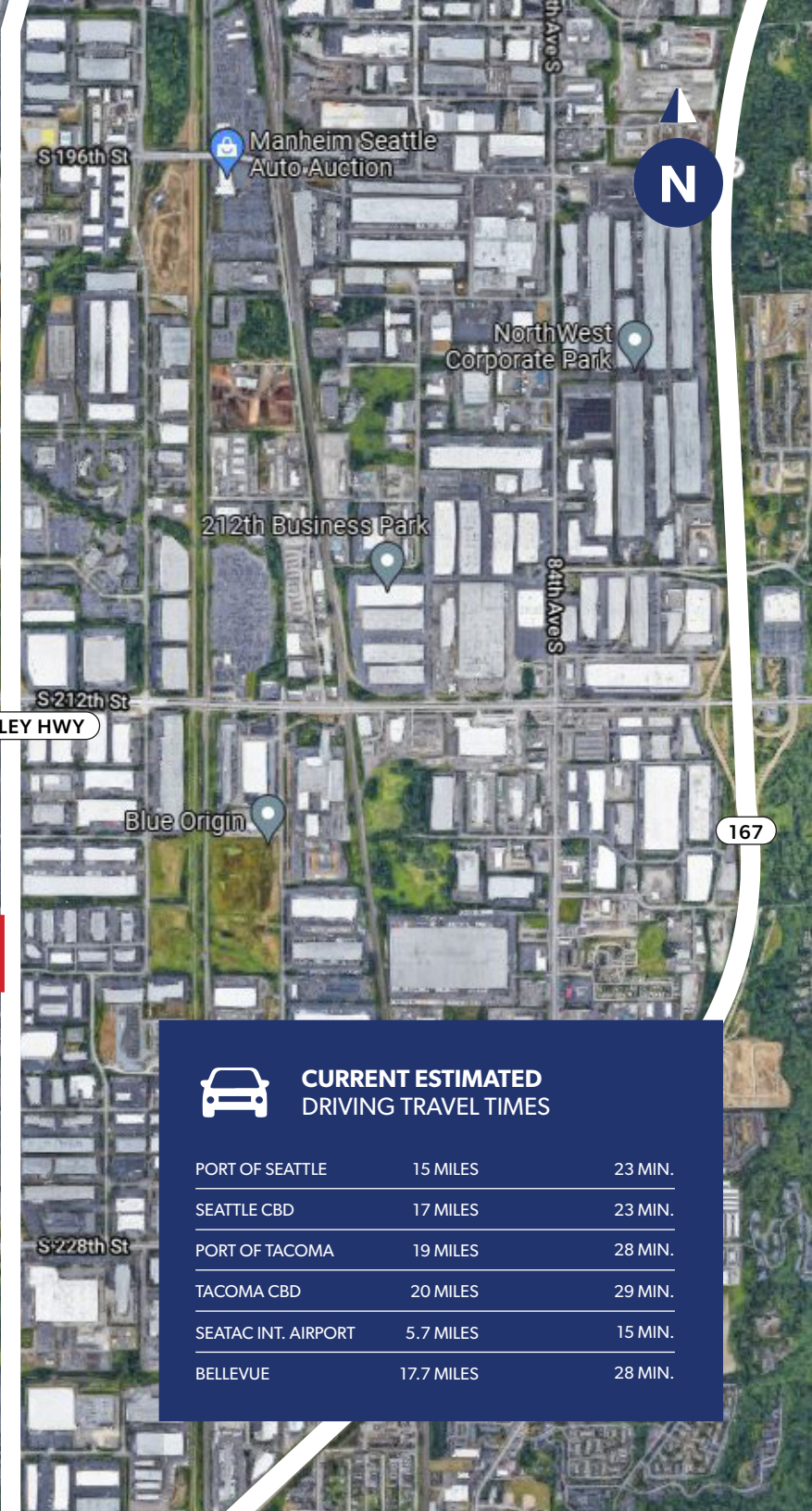

CURRENT ESTIMATED DRIVING TRAVEL TIMES		
PORT OF SEATTLE	15 MILES	23 MIN.
SEATTLE CBD	17 MILES	23 MIN.
PORT OF TACOMA	19 MILES	28 MIN.
TACOMA CBD	20 MILES	29 MIN.
SEATAC INT. AIRPORT	5.7 MILES	15 MIN.
BELLEVUE	17.7 MILES	28 MIN.

KENT WEST

CORPORATE PARK



BRIAN BRUININKS, CCIM
(206) 336-5324
bbruininks@andoverco.com

SHANE MAHVI
(206) 336-5338
smahvi@andoverco.com