



# 76,259 SF INDUSTRIAL SPEC BUILDING

## SWC 7TH ST & PINNACLE PEAK | DEER VALLEY

FOR MORE INFORMATION PLEASE CONTACT:

**BOB LUNDSTEDT**  
First Vice President

O: 602.575.2311 | C: 602.363.7238

E: [RLundstedt@daumcre.com](mailto:RLundstedt@daumcre.com)

**SKIP CORLEY**  
Executive Vice President

O: 602.575.2303 | C: 602.469.5340

E: [SCorley@daumcre.com](mailto:SCorley@daumcre.com)

**CHASE HEINEMANN**  
Vice President

O: 602.575.2333 | C: 602.689.4071

E: [CHeinemann@daumcre.com](mailto:CHeinemann@daumcre.com)

 **DAUM**  
COMMERCIAL REAL ESTATE SERVICES

Although all information is furnished regarding for sale, rental or financing is from sources deemed reliable, such information has not been verified and no express representation is made nor is any to be implied as to the accuracy thereof, and it is submitted subject to errors, omissions, changes of price, rental or other conditions, prior sale, lease or financing, or withdrawal without notice. All Maps provided courtesy of Google Maps, Bing Maps, and Google Earth. D/AQ Corp. # 01129558



## PROPERTY HIGHLIGHTS



76,259 SF  
(DIVISIBLE)



5.74  
ACRES



209-01-013  
APN



A-1  
ZONING



NEIGHBORING  
224 ACRE  
TSMC SUPPLIER SITE

## SITE PLAN

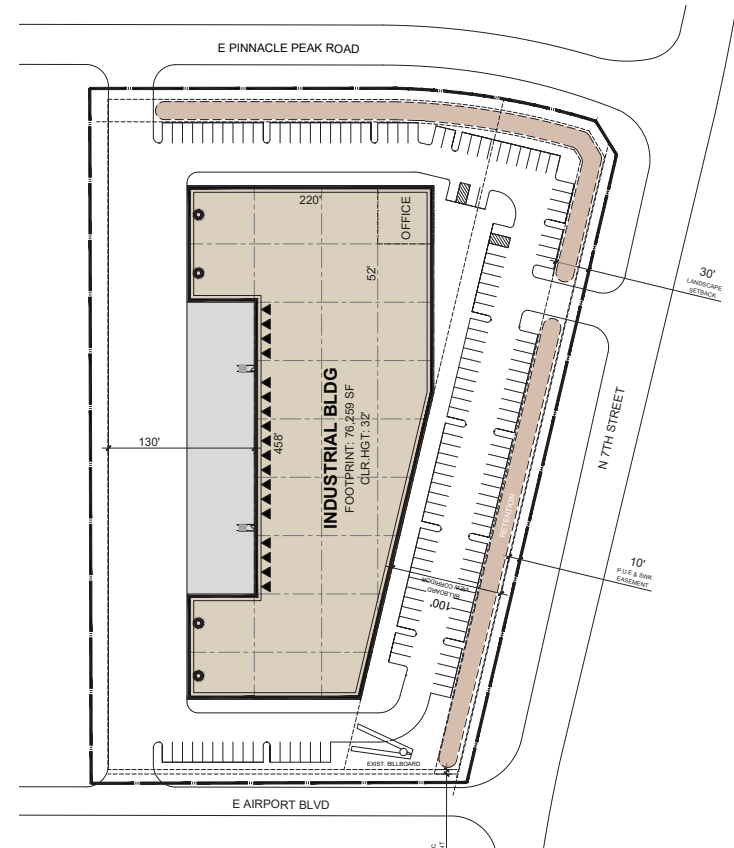

# 76,259 SF INDUSTRIAL SPEC BUILDING SWC 7TH ST & PINNACLE PEAK | DEER VALLEY

## ABOUT

FOR MORE INFORMATION PLEASE CONTACT:

**BOB LUNDSTEDT**  
First Vice President

O: 602.575.2311 | C: 602.363.7238

E: [RLundstedt@daumcre.com](mailto:RLundstedt@daumcre.com)

**SKIP CORLEY**  
Executive Vice President

O: 602.575.2303 | C: 602.469.5340

E: [SCorley@daumcre.com](mailto:SCorley@daumcre.com)

**CHASE HEINEMANN**  
Vice President

O: 602.575.2333 | C: 602.689.4071

E: [CHeinemann@daumcre.com](mailto:CHeinemann@daumcre.com)

**DAUM**  
COMMERCIAL REAL ESTATE SERVICES

Although all information is furnished regarding for sale, rental or financing is from sources deemed reliable, such information has not been verified and no express representation is made nor is any to be implied as to the accuracy thereof, and it is submitted subject to errors, omissions, changes of price, rental or other conditions, prior sale, lease or financing, or withdrawal without notice. All Maps provided courtesy of Google Maps, Bing Maps, and Google Earth. D/AQ Corp. # 01129558





# 76,259 SF INDUSTRIAL SPEC BUILDING

## SWC 7TH ST & PINNACLE PEAK | DEER VALLEY

AERIAL

FOR MORE INFORMATION PLEASE CONTACT:

**BOB LUNDSTEDT**  
First Vice President  
O: 602.575.2311 | C: 602.363.7238  
E: RLundstedt@daumcre.com

**SKIP CORLEY**  
Executive Vice President  
O: 602.575.2303 | C: 602.469.5340  
E: SCorley@daumcre.com

**CHASE HEINEMANN**  
Vice President  
O: 602.575.2333 | C: 602.689.4071  
E: CHeinemann@daumcre.com

**DAUM**  
COMMERCIAL REAL ESTATE SERVICES

Although all information is furnished regarding for sale, rental or financing is from sources deemed reliable, such information has not been verified and no express representation is made nor is any to be implied as to the accuracy thereof, and it is submitted subject to errors, omissions, changes of price, rental or other conditions, prior sale, lease or financing, or withdrawal without notice. All Maps provided courtesy of Google Maps, Bing Maps, and Google Earth. D/AQ Corp. # 01129558



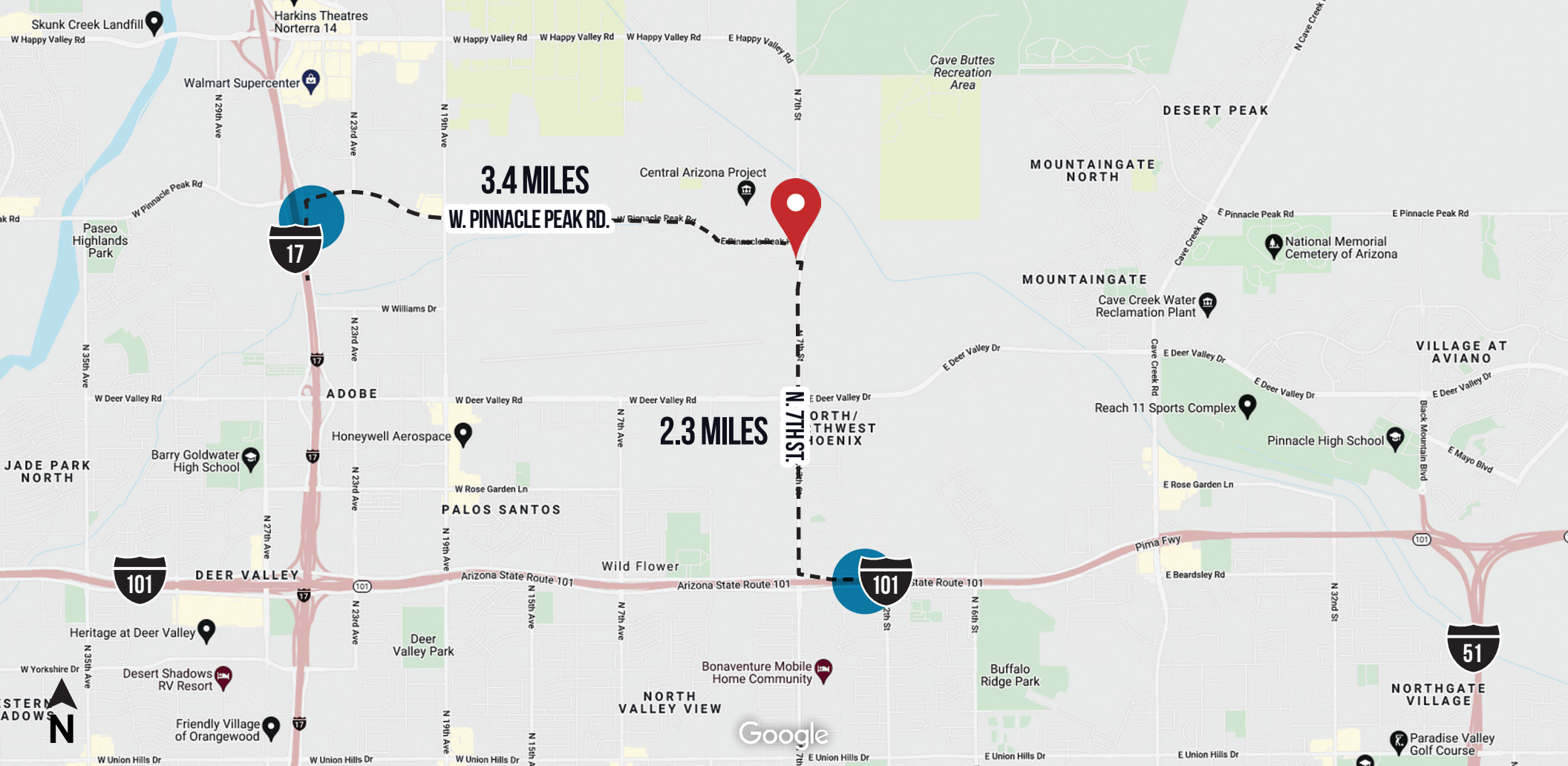

# 76,259 SF INDUSTRIAL SPEC BUILDING

## SWC 7TH ST & PINNACLE PEAK | DEER VALLEY

## LOCATION MAP

FOR MORE INFORMATION PLEASE CONTACT:

**BOB LUNDSTEDT**  
First Vice President  
O: 602.575.2311 | C: 602.363.7238  
E: [RLundstedt@daumcre.com](mailto:RLundstedt@daumcre.com)

**SKIP CORLEY**  
Executive Vice President  
O: 602.575.2303 | C: 602.469.5340  
E: [SCorley@daumcre.com](mailto:SCorley@daumcre.com)

**CHASE HEINEMANN**  
Vice President  
O: 602.575.2333 | C: 602.689.4071  
E: [CHeinemann@daumcre.com](mailto:CHeinemann@daumcre.com)

**DAUM**  
COMMERCIAL REAL ESTATE SERVICES

Although all information is furnished regarding for sale, rental or financing is from sources deemed reliable, such information has not been verified and no express representation is made nor is any to be implied as to the accuracy thereof, and it is submitted subject to errors, omissions, changes of price, rental or other conditions, prior sale, lease or financing, or withdrawal without notice. All Maps provided courtesy of Google Maps, Bing Maps, and Google Earth. D/AQ Corp. # 01129558