

FOR LEASE

FLEX/INDUSTRIAL BUILDING

1554 Juniper Street | Norfolk, VA 23502



S.L. NUSBAUM
REALTY CO.



STEPHANIE SANKER, CCIM, SIOR

Senior Vice President

O. 757.640.2290

ssanker@slnusbaum.com

MARTIN MURDEN

Partner | Commercial Brokerage

O. 757.640.2265

C. 757.333.1523

mmurden@slnusbaum.com

EXECUTIVE SUMMARY

FLEX/INDUSTRIAL BUILDING

1554 Juniper Street | Norfolk, VA 23502



S.L. NUSBAUM

REALTY CO.



OFFERING SUMMARY

Lease Rate:	\$12.00 SF/yr (NNN)
Building Size:	11,648 SF (sub-divisible)
Lot Size:	0.408 Acres
Year Built:	1965
Renovated:	2024
Zoning:	I-L (Industrial - Light)

PROPERTY HIGHLIGHTS

- 11,648 square feet available for lease, divisible into two units
- New roof, electrical, plumbing, exterior painting, and interior buildout
- Three (3) 10' x 8' grade level doors
- 3-phase, 400 amps
- Includes fenced yard space and parking
- Building and property signage available
- 10' - 25' ceiling height throughout the warehouse
- Centrally positioned in close proximity to I-64 and I-264

PROPERTY PHOTOS

FLEX/INDUSTRIAL BUILDING

1554 Juniper Street | Norfolk, VA 23502



S.L. NUSBAUM
REALTY CO.



SINGLE TENANT LAYOUT

FLEX/INDUSTRIAL BUILDING

1554 Juniper Street | Norfolk, VA 23502



S.L. NUSBAUM
REALTY CO.

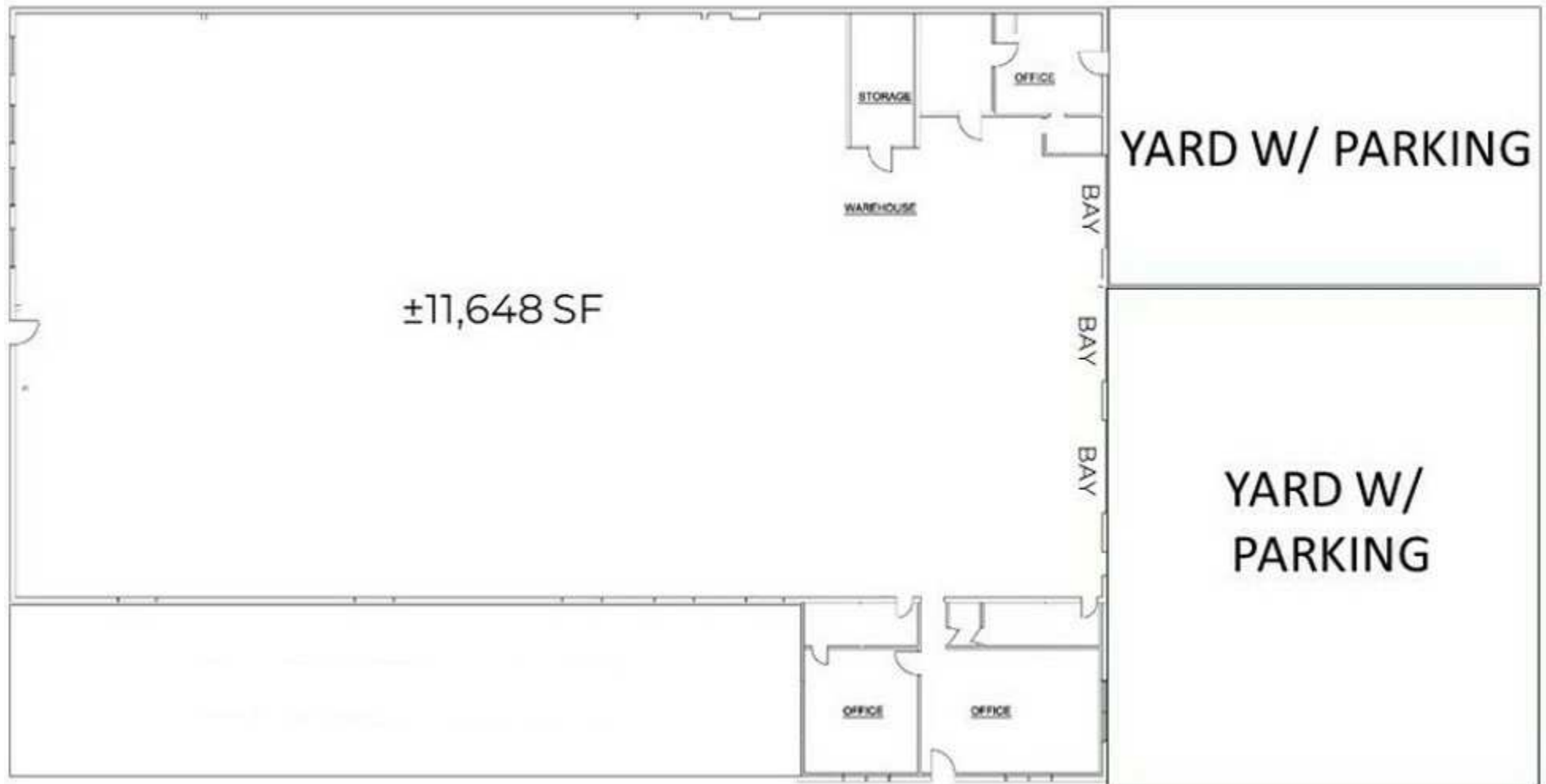

OPTIONAL FLOORPLAN

FLEX/INDUSTRIAL BUILDING

1554 Juniper Street | Norfolk, VA 23502



S.L. NUSBAUM
REALTY CO.

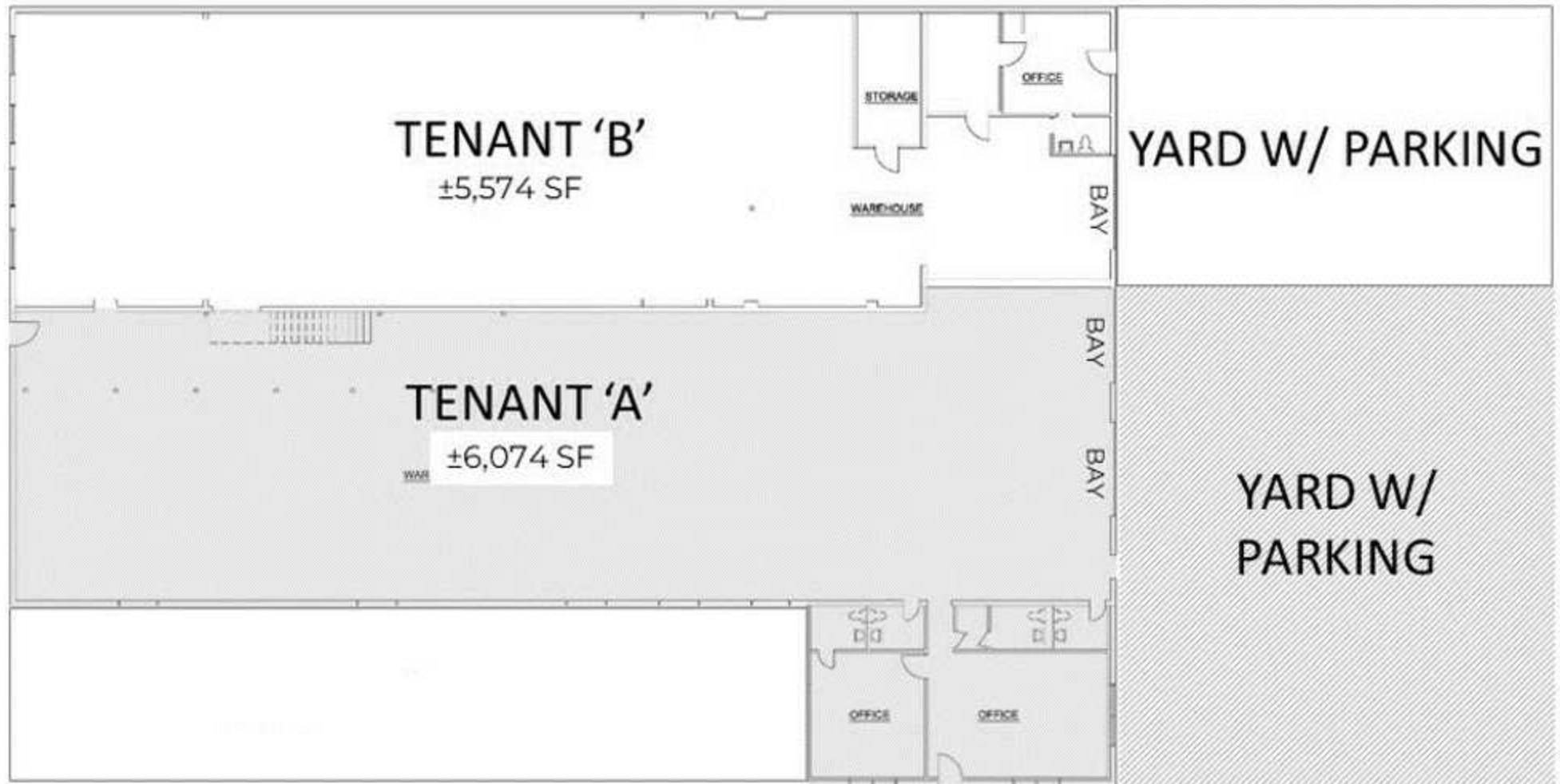

LOCATION MAP

FLEX/INDUSTRIAL BUILDING

1554 Juniper Street | Norfolk, VA 23502



S.L. NUSBAUM
REALTY CO.



DEMOGRAPHICS MAP & REPORT

FLEX/INDUSTRIAL BUILDING

1554 Juniper Street | Norfolk, VA 23502



S.L. NUSBAUM
REALTY CO.

POPULATION	1 MILE	3 MILES	5 MILES
Total Population	12,993	97,352	316,197
Average Age	38	38	38
Average Age (Male)	37	37	37
Average Age (Female)	39	40	39

HOUSEHOLDS & INCOME	1 MILE	3 MILES	5 MILES
Total Households	5,204	38,691	130,212
# Of Persons Per HH	2.5	2.5	2.4
Average HH Income	\$79,678	\$79,599	\$87,590
Average House Value	\$203,427	\$288,813	\$331,237

Demographics data derived from AlphaMap

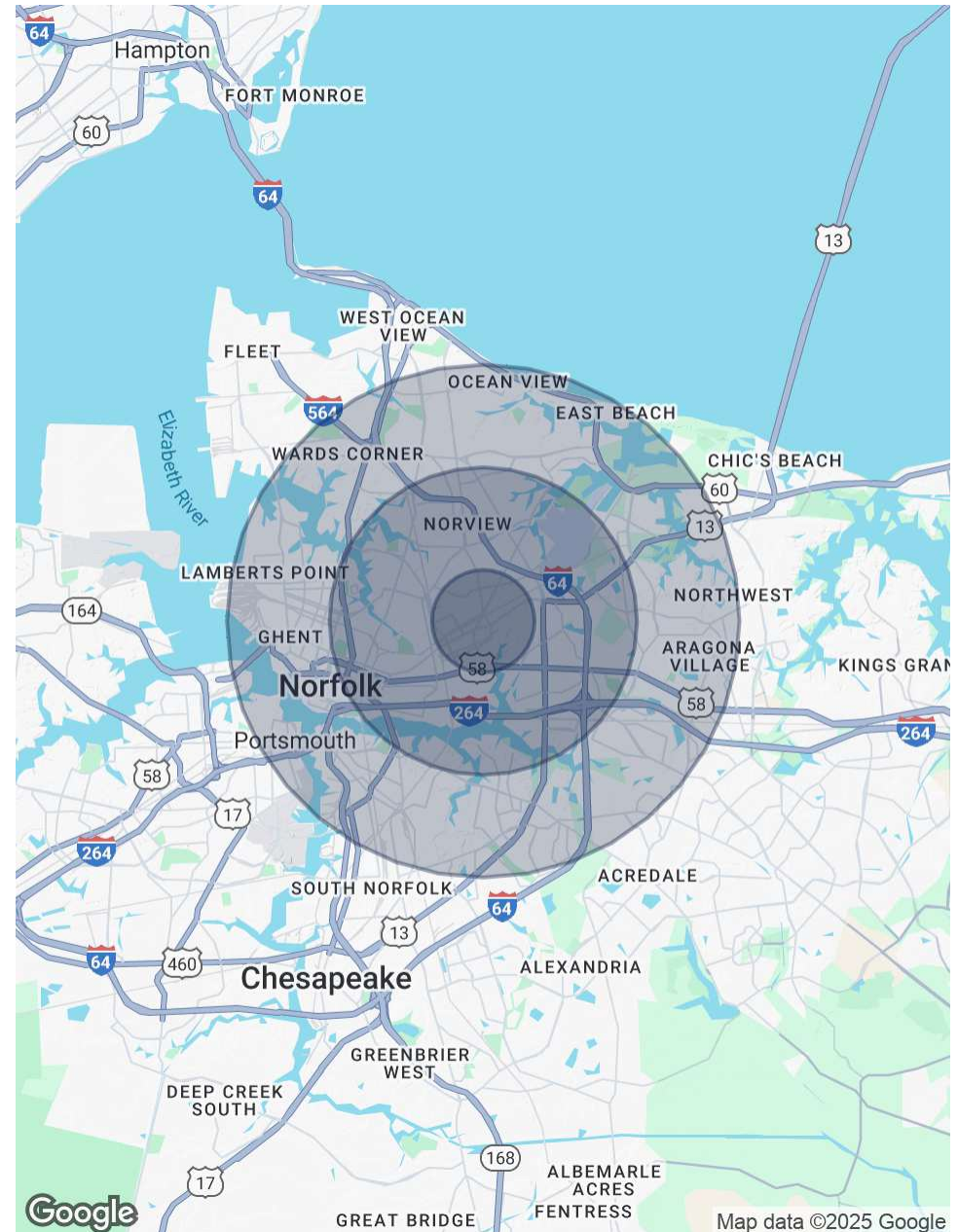

CONTACT INFORMATION

FLEX/INDUSTRIAL BUILDING

1554 Juniper Street | Norfolk, VA 23502



S.L. NUSBAUM

REALTY CO.



STEPHANIE SANKER, CCIM, SIOR
Senior Vice President
O. 757.640.2290
ssanker@slnusbaum.com

MARTIN MURDEN
Partner | Commercial
Brokerage
C. 757.333.1523
O. 757.640.2265
mmurden@slnusbaum.com

COMMITMENT. INTEGRITY. EXCELLENCE. SINCE 1906.

Serving the Southeast and Mid-Atlantic region for well over a century, S.L. Nusbaum Realty Co. continues to provide a comprehensive experience for our clients and customers in all aspects of the multifamily and commercial real estate industry.

CLICK HERE TO LEARN MORE

DISCLAIMER:

No warranty or representation, expressed or implied, is made to the accuracy or completeness of the information contained herein, and same is submitted subject to errors, omissions, change of price, rental or other conditions, withdrawal without notice, and to any special listing conditions imposed by the property owner(s). As applicable, we make no representation as to the condition of the property (or properties) in question or the property's (or properties') compliance with applicable laws, regulations, and codes.