

FOR LEASE

# 1200 County Road 523

Flemington, NJ



CUSHMAN &  
WAKEFIELD

Asking \$15.00/SF Net



Occupancy 30-Days from Lease Signing

**± 58,502 TOTAL AVAILABLE**

## Property Highlights

- ± 851,705 SF Total Building Size
- ± 58,502 SF Available
- ± 3,000 SF Office Space
- 50' Clear Ceiling Height
- 13 Tailgate Docks
- Wet Sprinkler System
- Fully Racked
- Taxes & CAM: \$.95/SF



12,000 Pallet Positions Remain In Place

## Contact

CHARLES FERN  
+1 732 243 3101  
chuck.fern@cushwake.com

JASON BARTON, SIOR  
+1 732 243 3104  
jason.barton@cushwake.com

JACK WINGE  
+1 732 243 3114  
jack.winge@cushwake.com

99 Wood Avenue South, 8th Floor, Iselin, NJ 08830 | One Meadowlands Plaza, 7th Floor, East Rutherford, NJ 07073  
[cushmanwakefield.com](http://cushmanwakefield.com)

Cushman & Wakefield Copyright 2024. No warranty or representation, express or implied, is made to the accuracy or completeness of the information contained herein, and same is submitted subject to errors, omissions, change of price, rental or other conditions, withdrawal without notice, and to any special listing conditions imposed by the property owner(s). As applicable, we make no representation as to the condition of the property (or properties) in question.



FOR LEASE

# 1200 County Road 523

Flemington, NJ

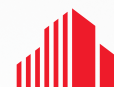

CUSHMAN &  
WAKEFIELD

## Floor Plan

 = ± 58,502 SF Total Available

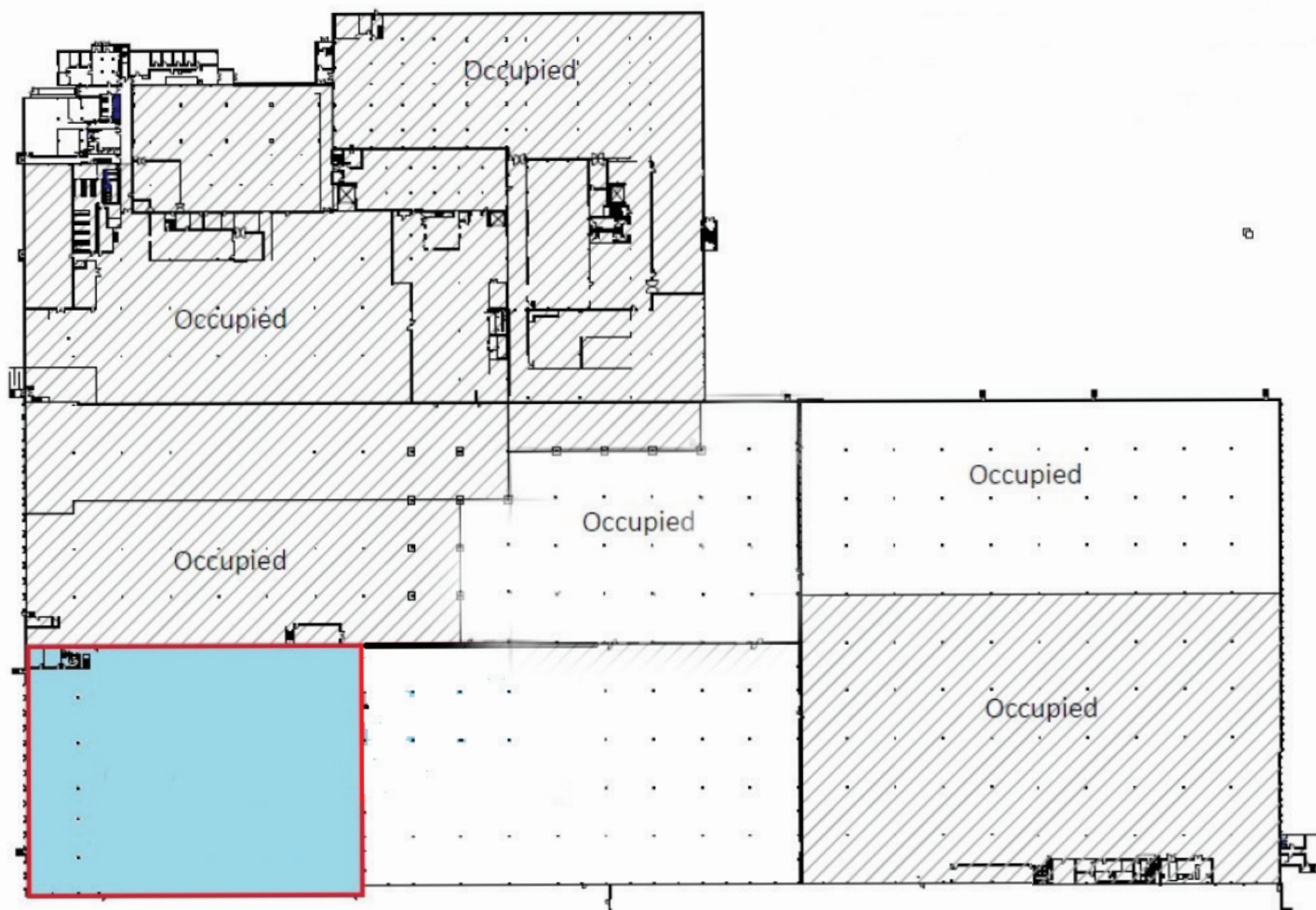



FOR LEASE

# 1200 County Road 523

Flemington, NJ

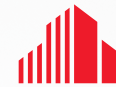

**CUSHMAN &  
WAKEFIELD**

## Location

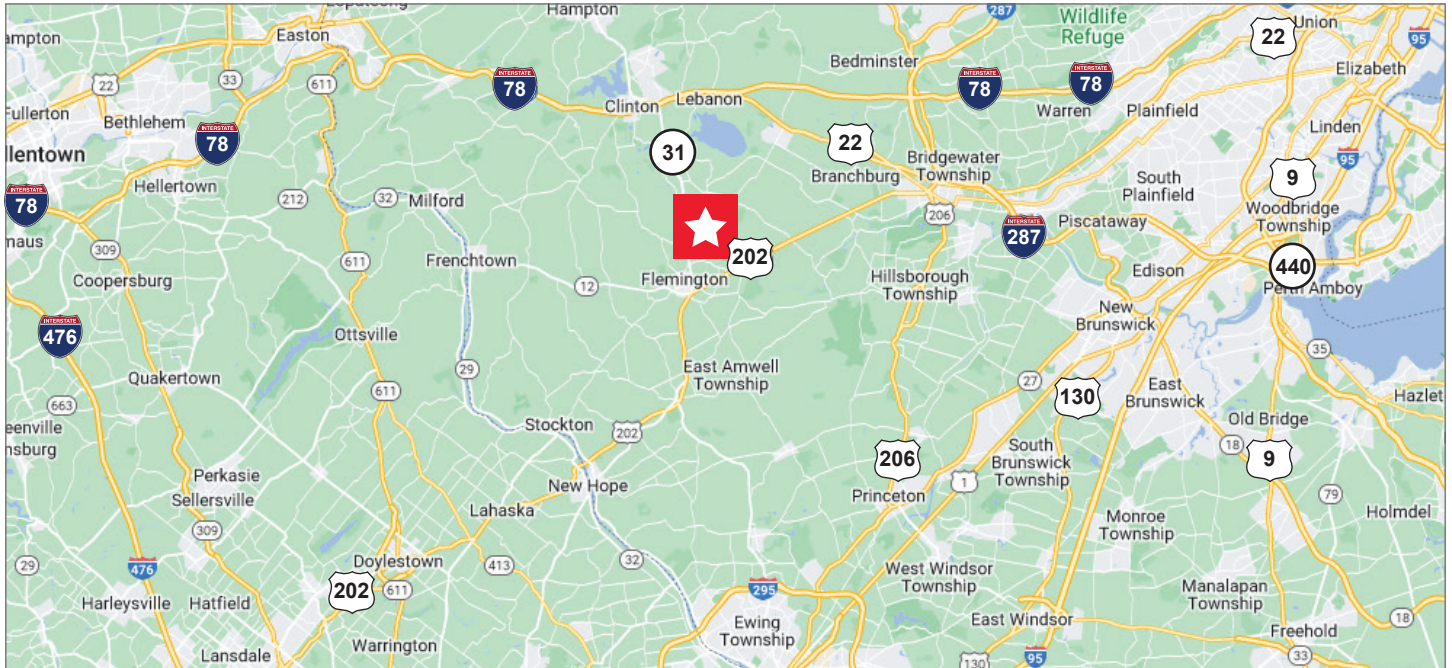

## Access to:

- Route 202
- Route 31
- I-78
- 40 Minutes to Ports without Tolls
- Midway between NYC and Philadelphia metropolitan areas

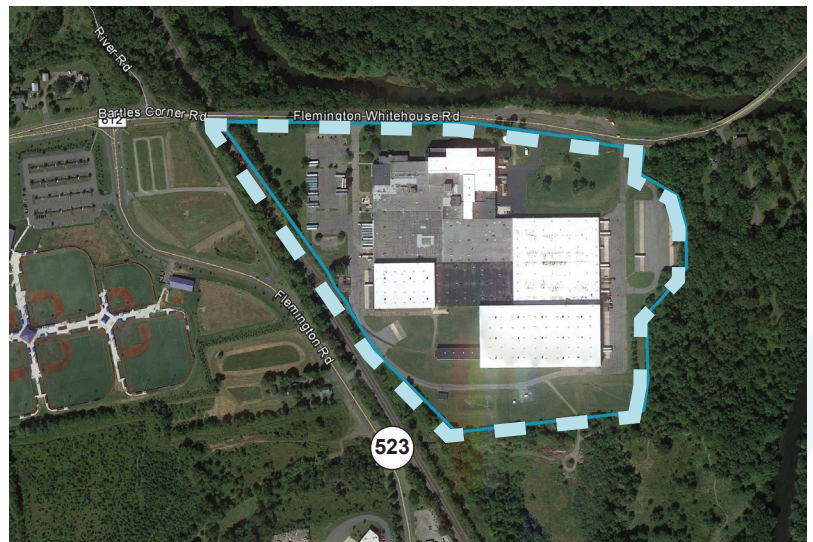

## Contact

**CHARLES FERN**  
+1 732 243 3101  
chuck.fern@cushwake.com

**JASON BARTON, SIOR**  
+1 732 243 3104  
jason.barton@cushwake.com

**JACK WINGE**  
+1 732 243 3114  
jack.winge@cushwake.com