

FOR SALE

MEMORIAL RD & I35, EDMOND, OKLAHOMA 73013

I-35

E Frontage Rd

2 ACRES

E Memorial Road

HORIZON
COMMERCIAL REAL ESTATE

Nicole Mayes
Senior Vice President
405.209.3992

Spencer Bost
Associate
405.628.7481

www.horizoncreek.com

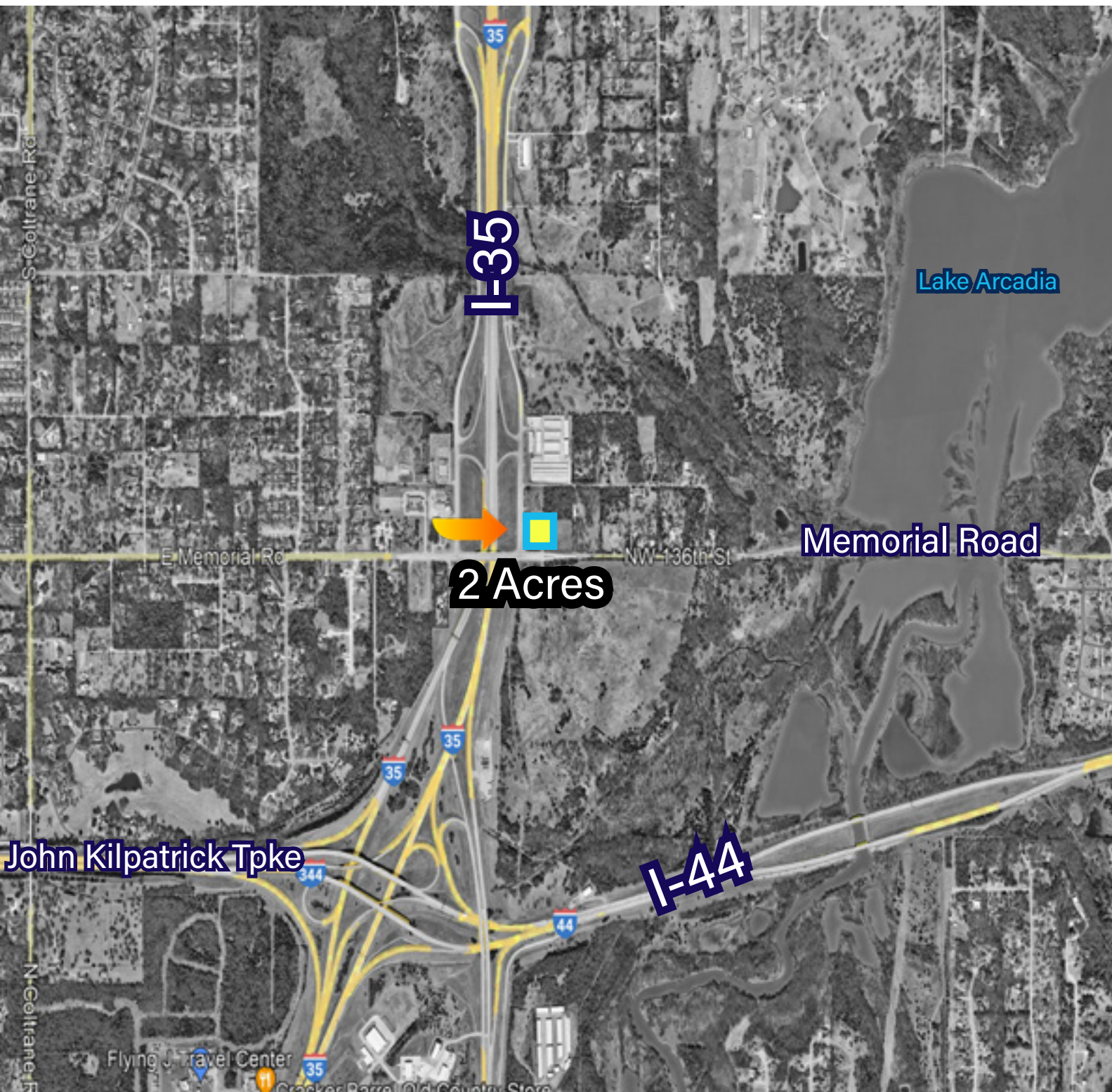

PROPERTY INFORMATION

\$871,200

PROPERTY TYPE	VACANT LAND
PRICE/ACRE	\$435,500
PRICE/SF	\$10.00
LOT SIZE	2 ACRES
ZONING	SPUD 894 / I-1



87,120 Sf of Vacant Industrial Land In Edmond, Oklahoma



The Seamless Access To The Highway Makes The Property Easily Accessible From OKC & Edmond



Well Suited To Host Various Developments (See SPUD)



Land Does Not Currently Include Water / Sewer Utility Lines On Site



Near Global Self Storage, Cracker Barrel, The Flying J Travel Center, & Integris Health Hospital



Located near Memorial Road and I-35 Highway just North of Kilpatrick Turnpike

ALTHOUGH THE INFORMATION HAS BEEN OBTAINED FROM TRUSTWORTHY SOURCES, HORIZON CRE MAKES NO GUARANTEES, ASSURANCES, OR WARRANTIES ABOUT THE COMPLETENESS OR ACCURACY OF THE DATA. THIS PROPERTY IS BEING PRESENTED WITH THE POSSIBILITY OF ERRORS AND OMISSIONS. MODIFICATIONS MAY OCCUR THAT ALTER THE FACTS OF THIS PRESENTATION WITHOUT NOTICE.

HORIZON
COMMERCIAL REAL ESTATE

Nicole Mayes | **Spencer Bost**
Senior Vice President | Associate
405.209.3992 | 405.628.7481
www.horizoncreek.com



HORIZON
COMMERCIAL REAL ESTATE

Nicole Mayes | **Spencer Bost**
Senior Vice President | Associate
405.209.3992 | 405.628.7481
www.horizoncreek.com

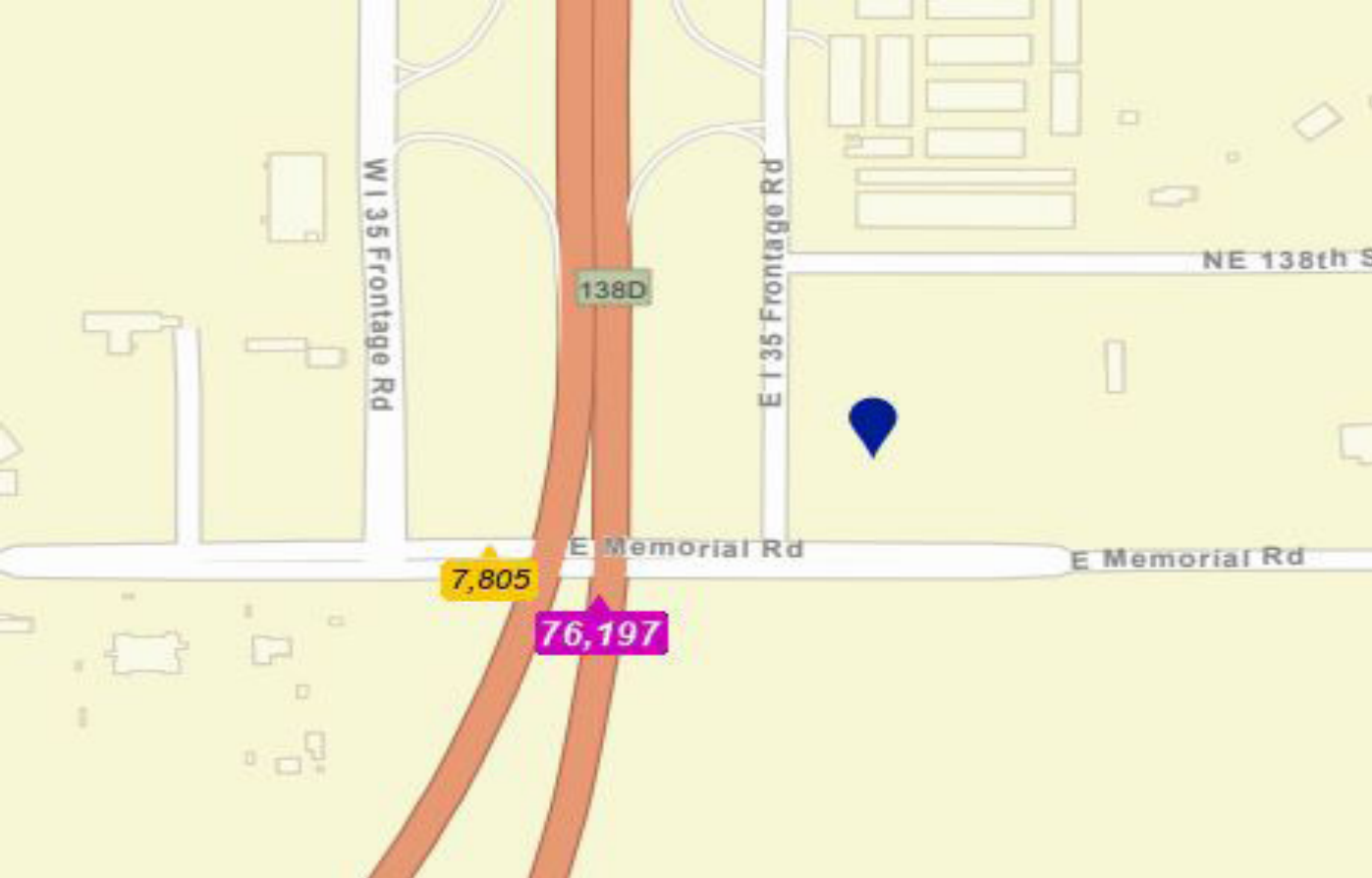

TRACT 2
Also Available For Sale

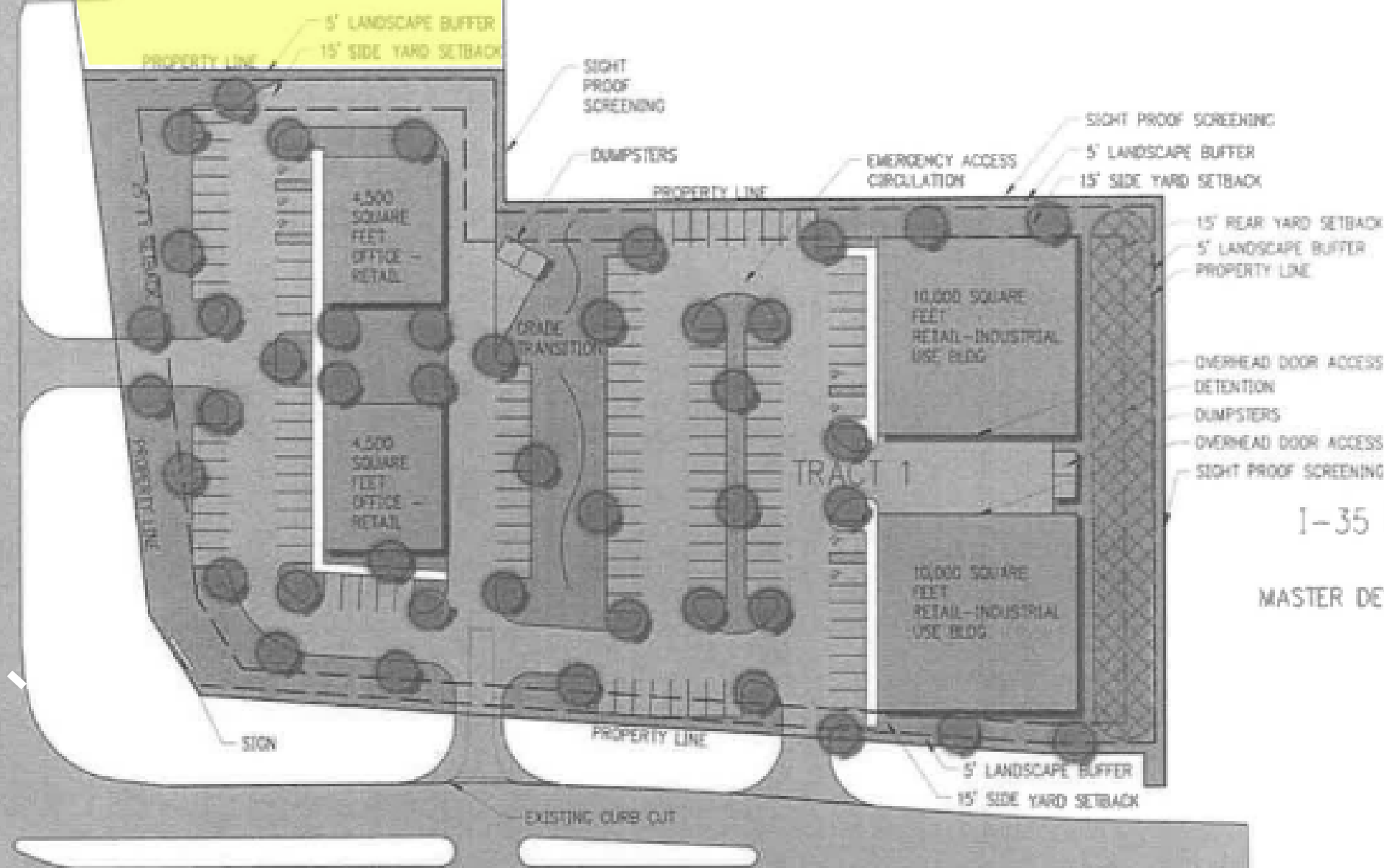

Nicole Mayes
Senior Vice President
405.209.3992
nicole.mayes@horizoncreek.com

Spencer Bost
Associate
405.628.7481
spencer.bost@horizoncreek.com

301 Lilac Drive
Suite 200
Edmond, OK 73034
horizoncreek.com

