

COWORKING AT CENTURY CAMPUS



4-5-6 CENTURY DRIVE, PARSIPPANY NJ 07054

COWORKING AT CENTURY CAMPUS

FLOOR PLAN

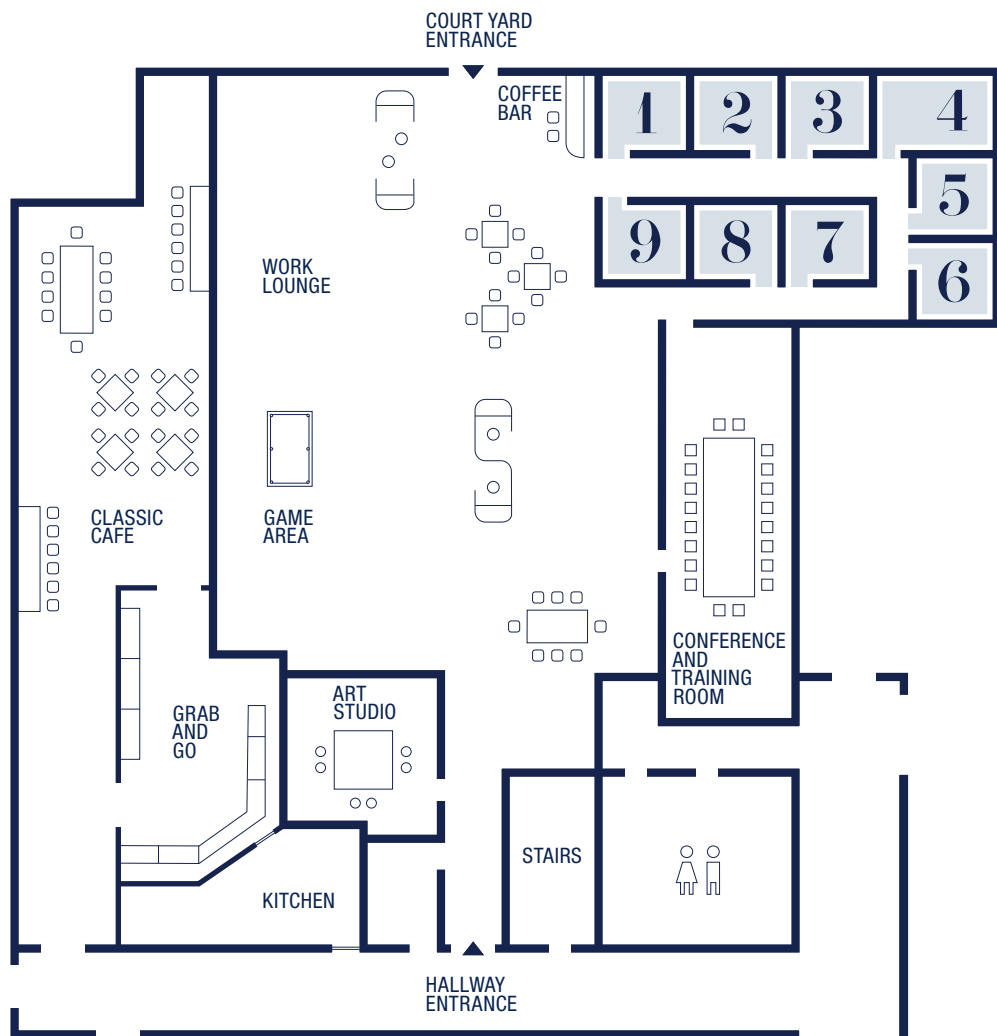

AMENITIES

BUILDING FEATURES

- The coworking suites are located on the first floor of 6 Century Drive, part of the 3-building office park Century Campus in Parsippany, NJ
- The brand new space includes a state-of-the-art business lounge open to all tenants 24/7
- Flexible conference & training room
- Fully outfitted with Steelcase furniture
- On-site bike share program
- Full service cafeteria with seating
- Stocked art studio for tenant use
- Barista-staffed coffee bar
- Newly remodeled common areas (lobbies, corridors, restrooms, cafeteria)
- Extensive upgrades planned for the landscaping and outdoor spaces
- 24/7 security card access and CCTV
- On site property management and ownership
- Free wifi throughout

LOCATION FEATURES

- Situated at intersection of I-287 and Routes 10 and 202
- Close proximity to Route 24, I-80, and I-78 leading to New Jersey Turnpike and Garden State Parkway
- 5 miles from Morristown Train Station
- Minutes to hotels, shopping, restaurants, banks, and airports

OFFICE	PERSON	WINDOWED	OFFICE SIZES	MONTHLY RENT
1	2	X	10'x10'	\$ 1,250.00
2	2	X	10'x10'	\$ 1,250.00
3	2	X	10'x10'	\$ 1,250.00
4	4	X	10'x13'	\$ 1,500.00
5	2		9'x9'	\$ 950.00
6	2		9'x9'	\$ 950.00
7	2		9'x10'	\$ 1,050.00
8	2		9'x10'	\$ 1,050.00
9	2		9'x10'	\$ 1,050.00



Conference Room



Work Lounge



Classic Cafe



Activity Room



Vending Machine



Meditation Room



GYM



Security



Parking



Bike Sharing



Rail Transport



Bus Transport

FOR LEASING



John G. Osborne
Executive Director of Leasing & Marketing
732-855-8600 ext.115
josborne@bergmanrealty.com

Isabel Freire
Assistant Director of Leasing & Marketing
732-855-8600 ext.120
isabel@bergmanrealty.com