

For Lease:

**5924-5930  
YORK BLVD**

HIGHLAND PARK



2nd Gen Restaurant





# LOCATION

## Highland Park

Nestled in the vibrant heart of Highland Park, this second-generation restaurant space offers an unparalleled opportunity for a restaurant operator. Located on the bustling York Blvd, you'll be in great company with renowned neighbors like Café de Leche, Hippo, and Highland Park Bowl.

The neighborhood's blend of culture, art, and community ensures a steady flow of patrons eager to experience new flavors and dining experiences. Don't miss the chance to be part of Highland Park's exciting culinary scene.



## PROPERTY SPECS

- Size: 4,487 sf
  - Restaurant: 2,503 sf (includes large patio)
  - Retail: 1,984 sf
- Rent: Contact Broker
- Hours: M-F 11a-12a & S-S: 8a-12a
- Type 41
- Occupancy: 197
- Large patio
- Large pizza oven
- Street Parking Only
- Former tasting room with 24 tap draft system in place



## Neighboring Tenants



**CAFÉ DE  
LECHE**

**HiPPO,**

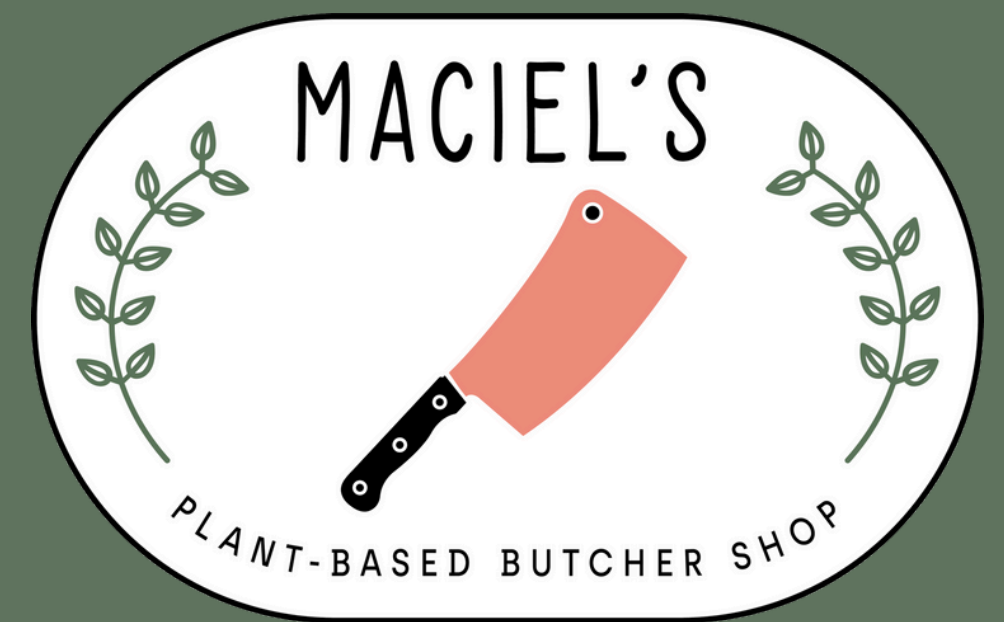



# Floor Plan

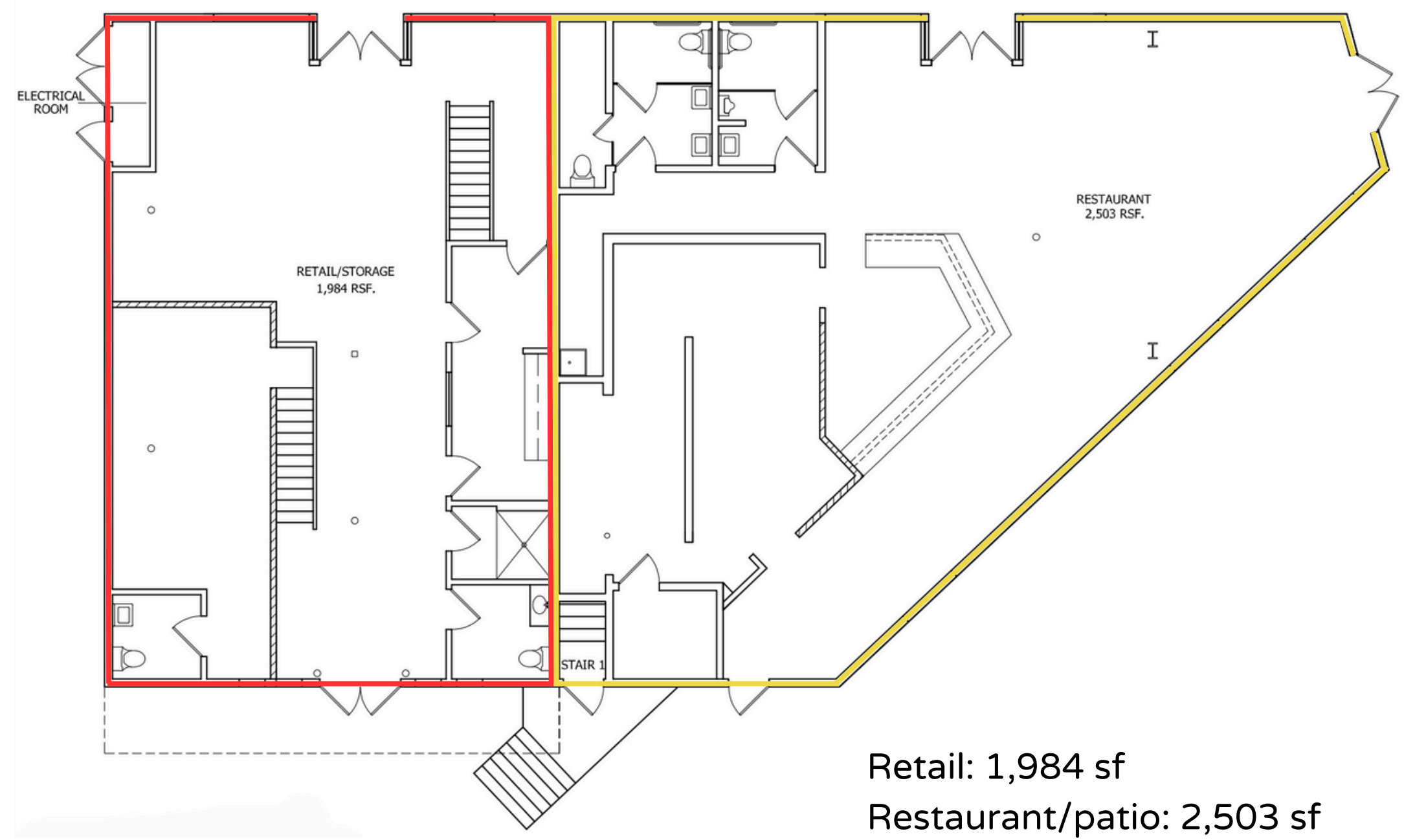

Retail: 1,984 sf  
Restaurant/patio: 2,503 sf

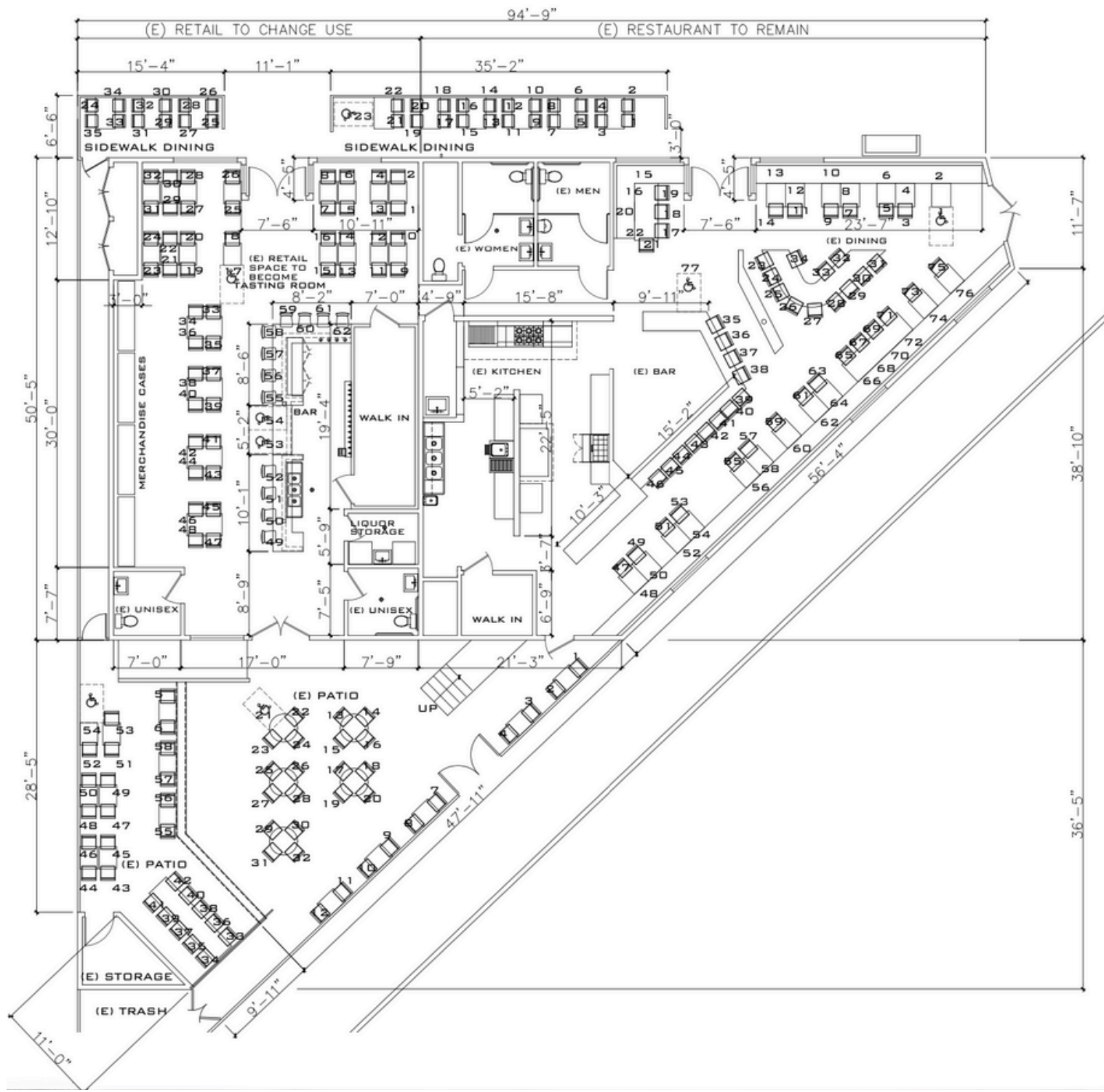



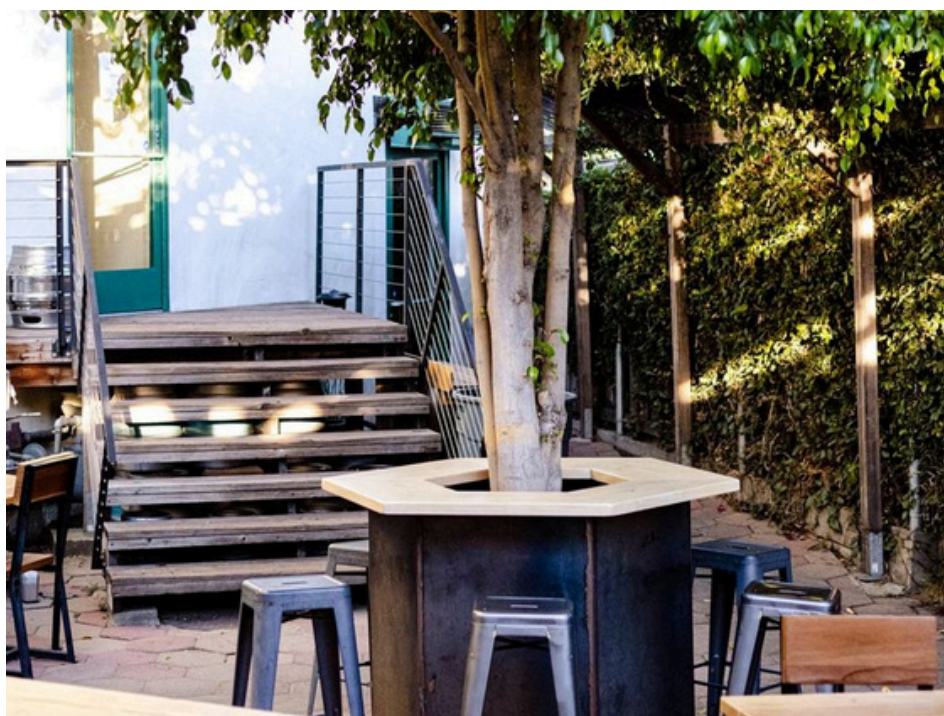
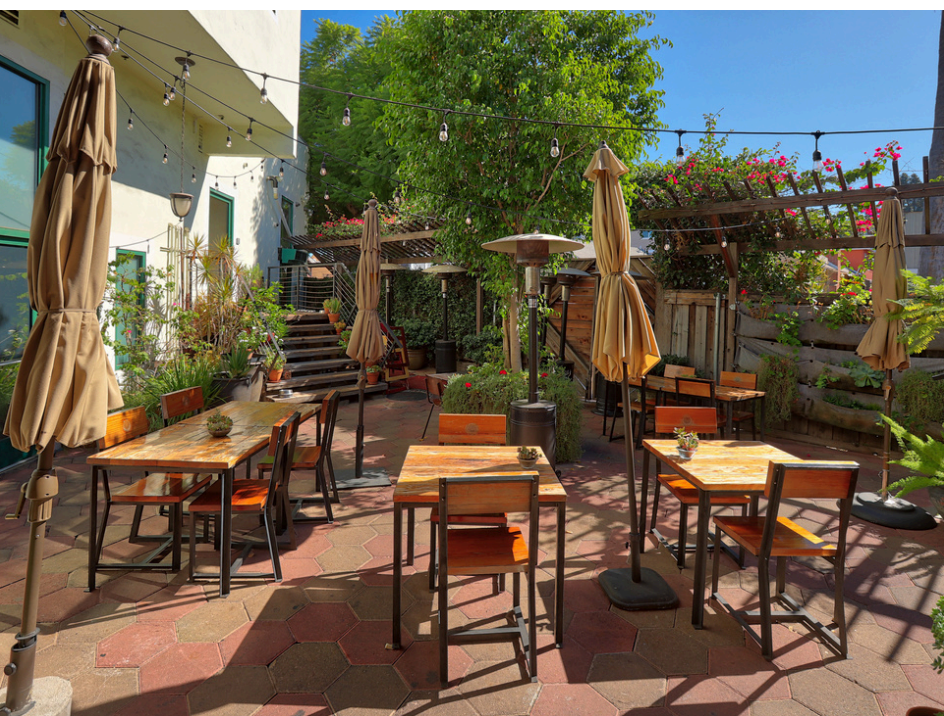



## CONTACT

### Lorena Tomb

213.277.7247 x1

[Lorena@urbanlimere.com](mailto:Lorena@urbanlimere.com)

BRE # 01894475

### Julie Chavez

213.277.7247 x6

[Julie@urbanlimere.com](mailto:Julie@urbanlimere.com)

BRE # 02053293