

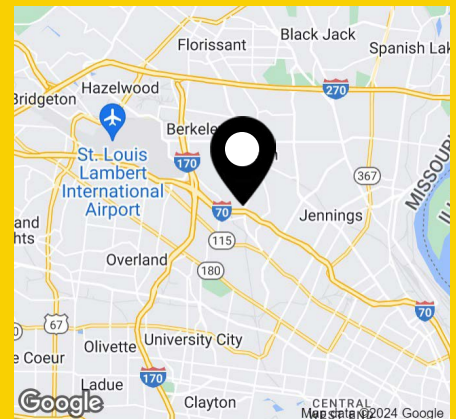

### Offering Summary - Building 2

Lease Rate:	\$4.95/SF, NNN
Available Space:	36,496 SF
Outside Storage:	Contact Broker for Details

- 15' clear height
- 4 dock doors
- 1 drive-in door
- 100% climate controlled
- Heavy power (2,200 amps)



### Get more information

#### Ben Cahill, SIOR, CCIM

Principal  
D 314 785 7637  
ben.cahill@avisonyoung.com

#### Dan Cahill, CCIM

Senior Vice President  
D 314 785 7639  
dan.cahill@avisonyoung.com

#### Ford Maune

Associate  
D 314 785 7640  
ford.maune@avisonyoung.com

#### Ben Albers, SIOR

Senior Vice President  
D 314 785 7695  
ben.albers@avisonyoung.com

# Building 2 Floorplan

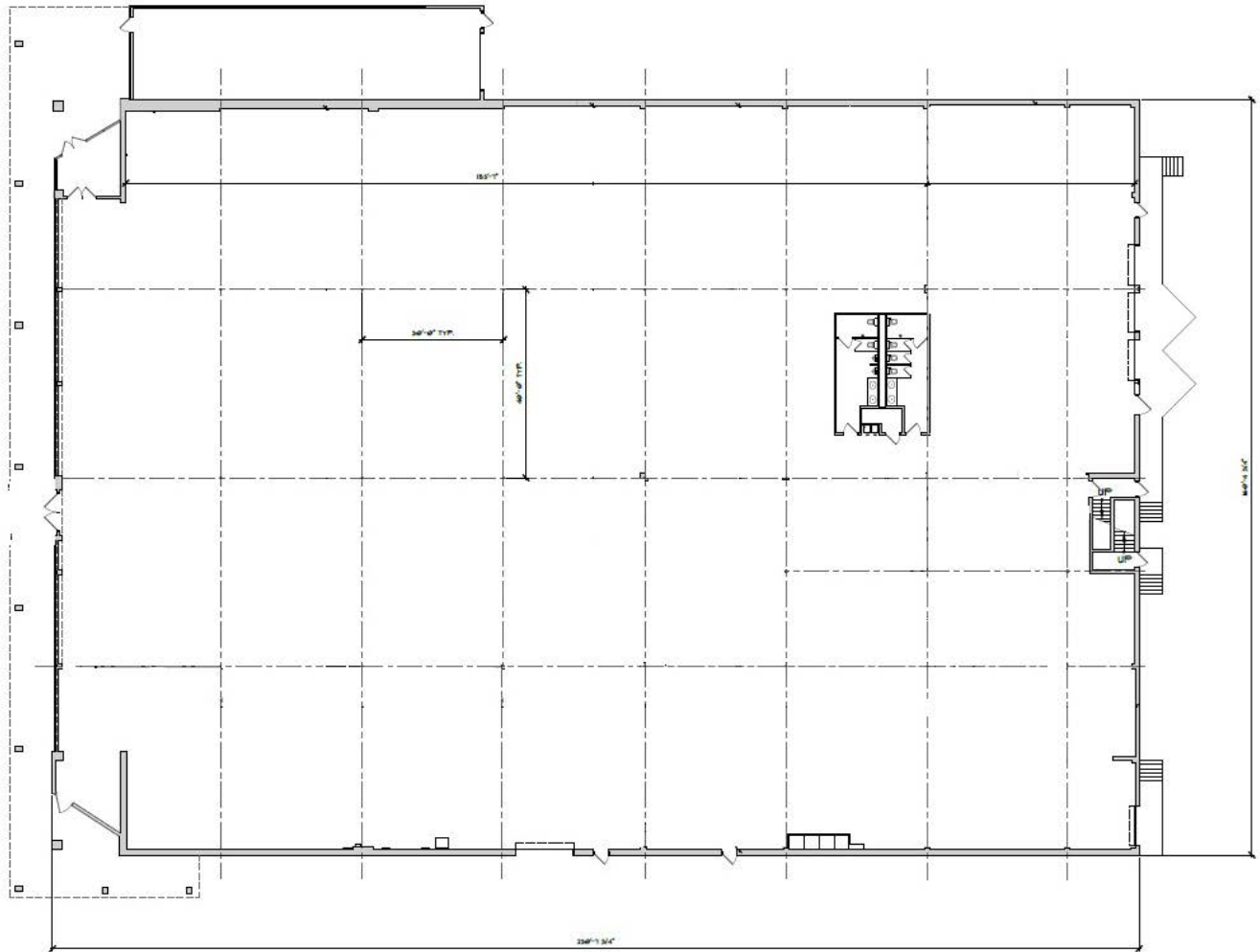

## Get more information

### Ben Cahill, SIOR, CCIM

Principal  
D 314 785 7637  
ben.cahill@avisonyoung.com

### Dan Cahill, CCIM

Senior Vice President  
D 314 785 7639  
dan.cahill@avisonyoung.com

### Ford Maune

Associate  
D 314 785 7640  
ford.maune@avisonyoung.com

### Ben Albers, SIOR

Senior Vice President  
D 314 785 7695  
ben.albers@avisonyoung.com