

Brian Funk

From: Brian Funk
Sent: Thursday, September 22, 2022 12:20 PM
To: Berlin, Nicole
Cc: Dick Funk
Subject: FW: 09212022 Agenda
Attachments: 09212022 Agenda.docx

From: Watson, Donna <WatsonD@HillsboroughCounty.ORG>
Sent: Wednesday, September 21, 2022 2:58 PM
To: Brian Funk <bfunk@bradleyconstruction.com>
Subject: 09212022 Agenda

[Concurrency & Utility Service Application \(hillsboroughcounty.org\)](https://hillsboroughcounty.org)

Parcel 71593.0100 lies within the Urban Service Area of Hillsborough County.
 Records indicate a private onsite 6" sanitary sewer gravity collector and a private onsite 8" sanitary sewer force main and an 8" potable water main.
 Per your request for record asbuilt utility drawings for your project, Anthony Artau is copied here.

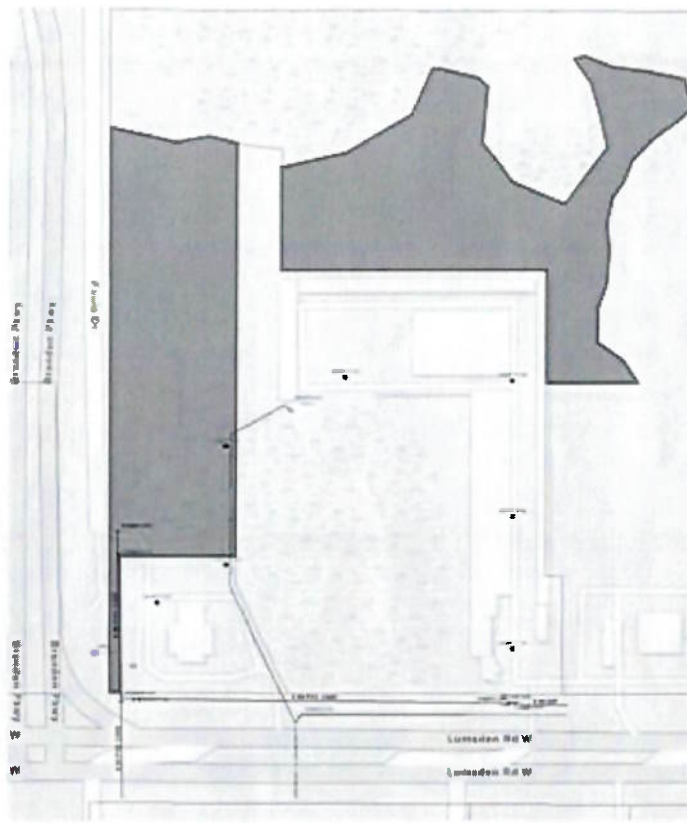
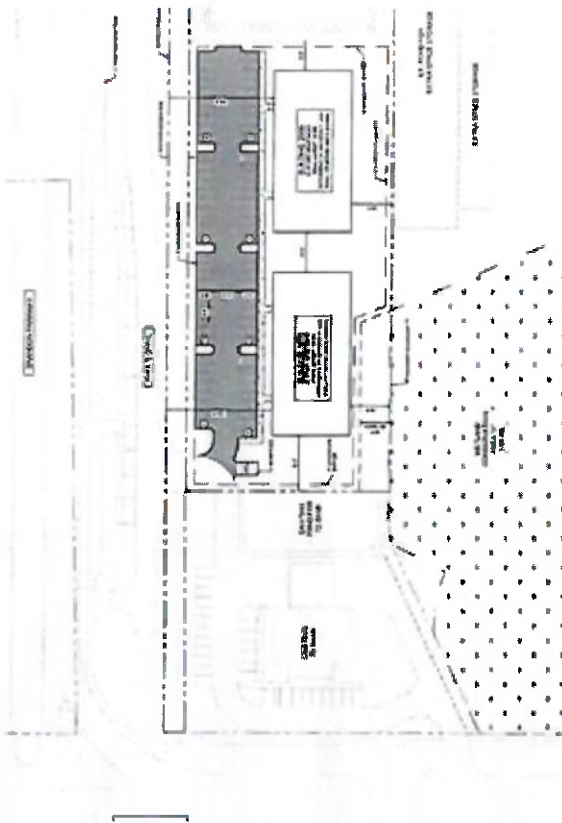

Donna Watson, CFM
Engineering Associate
 Development Review Division

**WATER RESOURCE SERVICES
REZONING REVIEW COMMENT SHEET: WATER & WASTEWATER**

PETITION NO.: RZ-STD 23-0407 **REVIEWED BY:** Clay Walker, E.I. **DATE:** 10/6/2023

FOLIO NO.: 71593.0100, 71593.0000, 71593.0300, 71593.0200

WATER

- ☐ The property lies within the _____ Water Service Area. The applicant should contact the provider to determine the availability of water service.
- ☒ A 8 inch water main exists ☒ (adjacent to the site), ☐ (approximately _____ feet from the site) and is located south of the subject property within the north Right-of-Way of West Lumsden Road. This will be the likely point-of-connection, however there could be additional and/or different points-of-connection determined at the time of the application for service. This is not a reservation of capacity.
- ☐ Water distribution system improvements will need to be completed prior to connection to the County's water system. The improvements include _____ and will need to be completed by the _____ prior to issuance of any building permits that will create additional demand on the system.

WASTEWATER

- ☐ The property lies within the _____ Wastewater Service Area. The applicant should contact the provider to determine the availability of wastewater service.
- ☒ A 4 inch wastewater force main exists ☒ (adjacent to the site), ☐ (approximately _____ feet from the site) and is located south of the subject property within the north Right-of-Way of West Lumsden Road. This will be the likely point-of-connection, however there could be additional and/or different points-of-connection determined at the time of the application for service. This is not a reservation of capacity.
- ☐ Wastewater collection system improvements will need to be completed prior to connection to the County's wastewater system. The improvements include _____ and will need to be completed by the _____ prior to issuance of any building permits that will create additional demand on the system.

COMMENTS: The subject rezoning includes parcels that are within the Urban Service Area and would require connection to the County's potable water and wastewater systems. The subject area is located within the Hillsborough County Wastewater Service Area and will be served by the Falkenburg Wastewater Treatment Plant. If all of the development commitments for the referenced facility are added together, they would exceed the existing reserve capacity of the facility. However, there is a plan in place to address the capacity prior to all of the existing commitments connecting and sending flow to the referenced facility. As such, an individual permit will be required based on the following language noted on the permits: The referenced facility currently does not have, but will have prior to placing the proposed project into operation, adequate reserve capacity to accept the flow from this project.