

FOR LEASE

3,136 Square Feet

16135 New Avenue, Unit #11, Lemont, IL



- | | |
|--|--|
| <ul style="list-style-type: none">• 240 sq. ft. office space• 200 AMP, three-phase power• 13' ceiling height• Exterior dock with leveler• LED lighting• Easy highway access | <ul style="list-style-type: none">• Epoxy coated floor• Energy efficient suspended ceiling with 6" insulation• 100% air conditioned unit• Separately metered gas/electric utilities• Ample parking• LEASE RATE: \$3,300 per month |
|--|--|



Exclusively Offered by:
Daniel Chopp
(708) 387-2640
dan@choppcommercial.com

All information herein is from sources deemed reliable but not guaranteed accurate.
Subject to errors, omissions, and to change of price and terms, prior sale or lease, all without notice.
Agent has an ownership interest in the property.

Floor Plan

16135 New Avenue, Unit #11, Lemont, Illinois

NOTE: THIS DRAWING NOT TO SCALE.

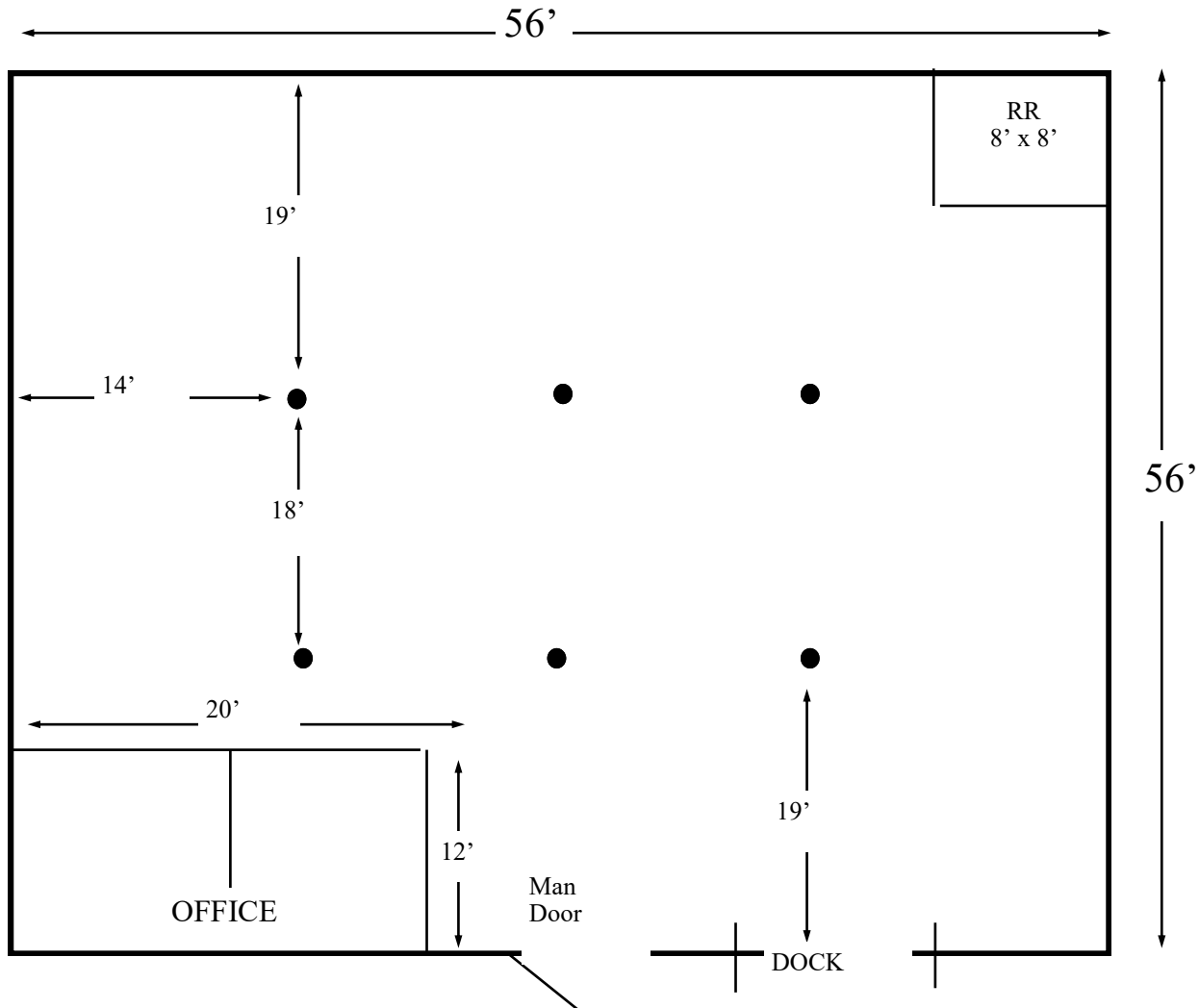

Exclusively Offered by:
Daniel Chopp
(708) 387-2640
dan@choppcommercial.com

All information herein is from sources deemed reliable but not guaranteed accurate.
Subject to errors, omissions, and to change of price and terms, prior sale or lease, all without notice.
Agent has an ownership interest in the property.

Interior Photos

16135 New Avenue, Unit #11, Lemont, Illinois

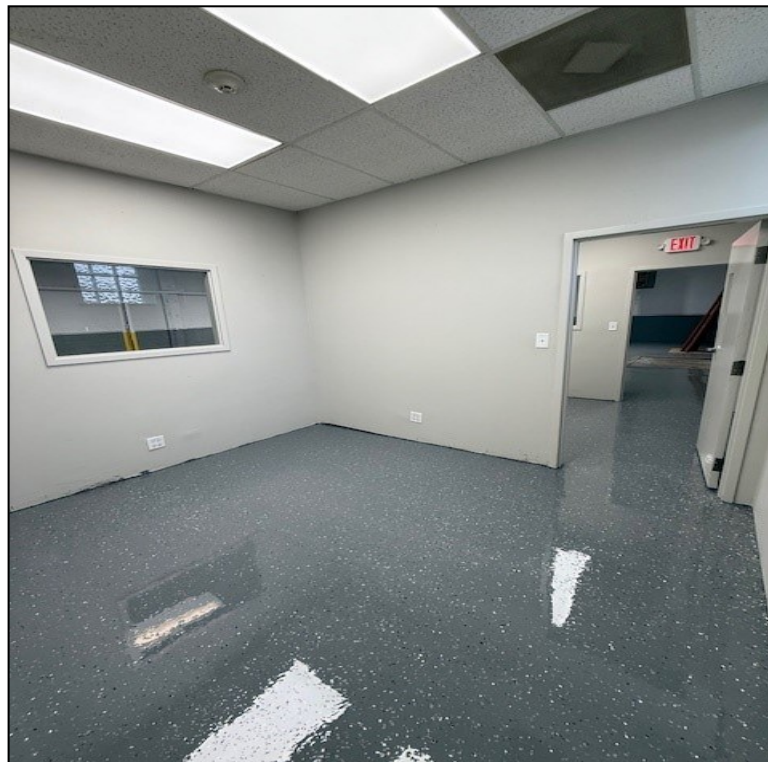

Exclusively Offered by:
Daniel Chopp
(708) 387-2640
dan@choppcommercial.com

All information herein is from sources deemed reliable but not guaranteed accurate.
Subject to errors, omissions, and to change of price and terms, prior sale or lease, all without notice.
Agent has an ownership interest in the property.

Interior Photos

16135 New Avenue, Unit #11, Lemont, Illinois



Exclusively Offered by:
Daniel Chopp
(708) 387-2640
dan@choppcommercial.com

All information herein is from sources deemed reliable but not guaranteed accurate.
Subject to errors, omissions, and to change of price and terms, prior sale or lease, all without notice.
Agent has an ownership interest in the property.