

Build-to-Suit

Maple Grove & Ustick Development Opportunity

3212 N. Maple Grove Road | Boise, ID

Highlights

- Pad available for future development on heavily traveled Ustick Road & Maple Grove Road - 21,000 VPD (Ustick Rd), 16,000 VPD (Maple Grove)
- On-site parking
- Great visibility
- Signage available



Site

Lew Manglos, MBA, CCIM, SIOR
208 472 2841
lew.manglos@colliers.com

Colliers

755 West Front Street, Suite 300
Boise, Idaho 83702
208 345 9000
colliers.com/idaho

Property Overview

Property Type	Land — Office/Retail
Building Size	Can accommodate up to a 5,000 SF building
Lease Rate	Contact Agent
Zoning	C1-Neighborhood Commercial

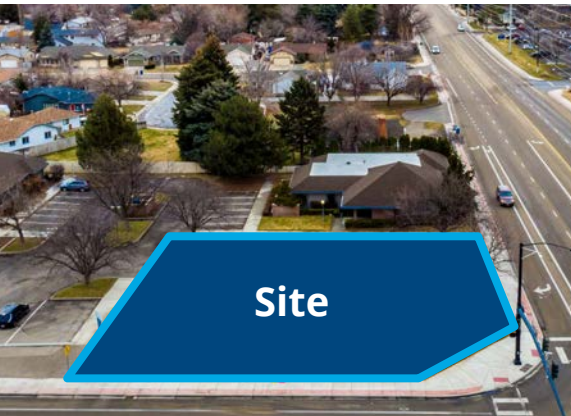

Site



Site

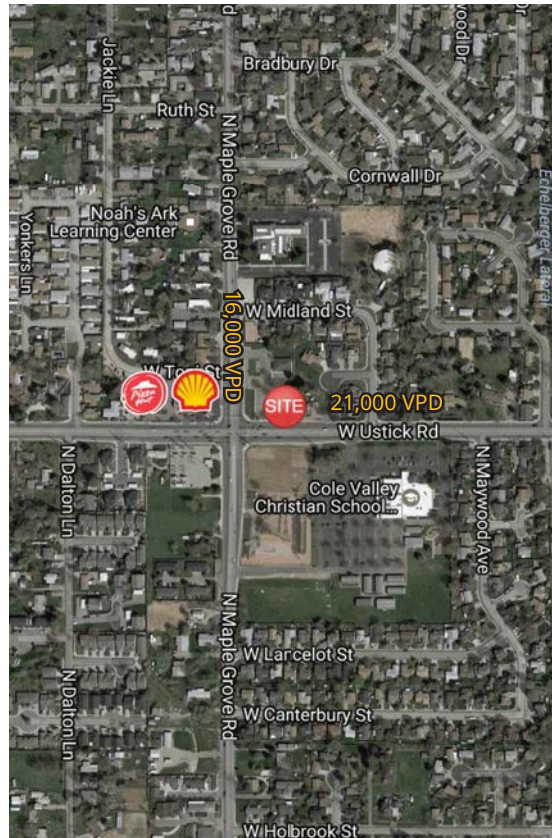

Site Plan

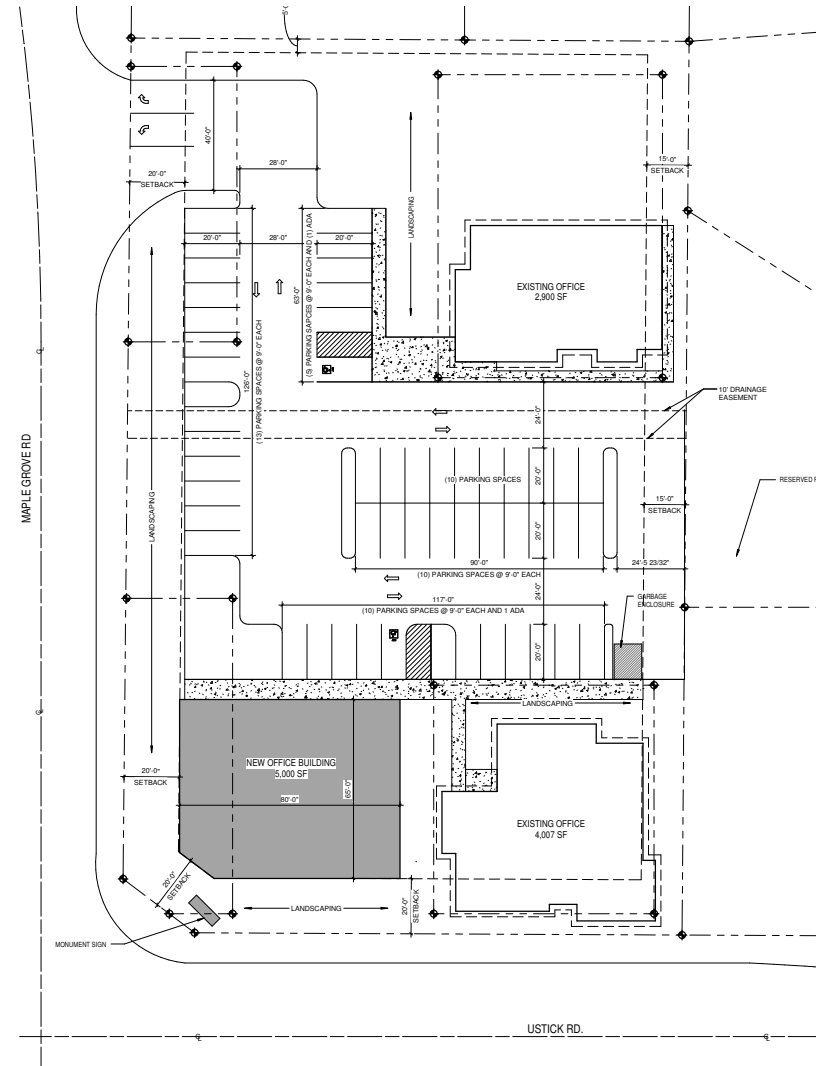

Renderings



755 West Front Street, Suite 300
Boise, Idaho 83702
208 345 9000
colliers.com/idaho

This document has been prepared by Colliers for advertising and general information only. Colliers makes no guarantees, representations or warranties of any kind, expressed or implied, regarding the information including, but not limited to, warranties of content, accuracy and reliability. Any interested party should undertake their own inquiries as to the accuracy of the information. Colliers excludes unequivocally all inferred or implied terms, conditions and warranties arising out of this document and excludes all liability for loss and damages arising there from. This publication is the copyrighted property of Colliers and /or its licensor(s). © 2023. All rights reserved. This communication is not intended to cause or induce breach of an existing listing agreement. Colliers Treasure Valley, LLC.