

INDUSTRIAL FOR LEASE 20801 SALISBURY ROAD

Bedford, OH 44146



OFFERING SUMMARY

Lease Rate:	\$7.32 SF/yr (Gross)
Building Size:	8,200 SF
Available SF:	8,200 SF
Renovated:	2025

PROPERTY OVERVIEW

8,200 SF Industrial Building Available for Lease. Recently renovated under new ownership, this industrial facility offers 8,200 square feet of functional space, including approximately 800 SF of office area. The building features two large drive-in doors, two dock-high doors, and two existing overhead cranes, making it ideal for a range of industrial or manufacturing users. Additional parking is available for lease if needed.

PROPERTY HIGHLIGHTS

- 8,200 SF Industrial Building
- Recently Renovated Under New Ownership
- (2) Large Drive-In Doors
- (2) Dock Doors
- (2) Cranes Existing in the Building
- 800 SF of Office Space
- Additional Parking Available for Lease if Required

Connor Krouse
ckrouse@lee-associates.com
D 216.282.0125

All information furnished regarding property for sale, rental or financing is from sources deemed reliable, but no warranty or representation is made to the accuracy thereof and same is submitted to errors, omissions, change of price, rental or other conditions prior to sale, lease or financing or withdrawal without notice. No liability of any kind is to be imposed on the broker herein.

INDUSTRIAL FOR LEASE
20801 SALISBURY ROAD

Bedford, OH 44146

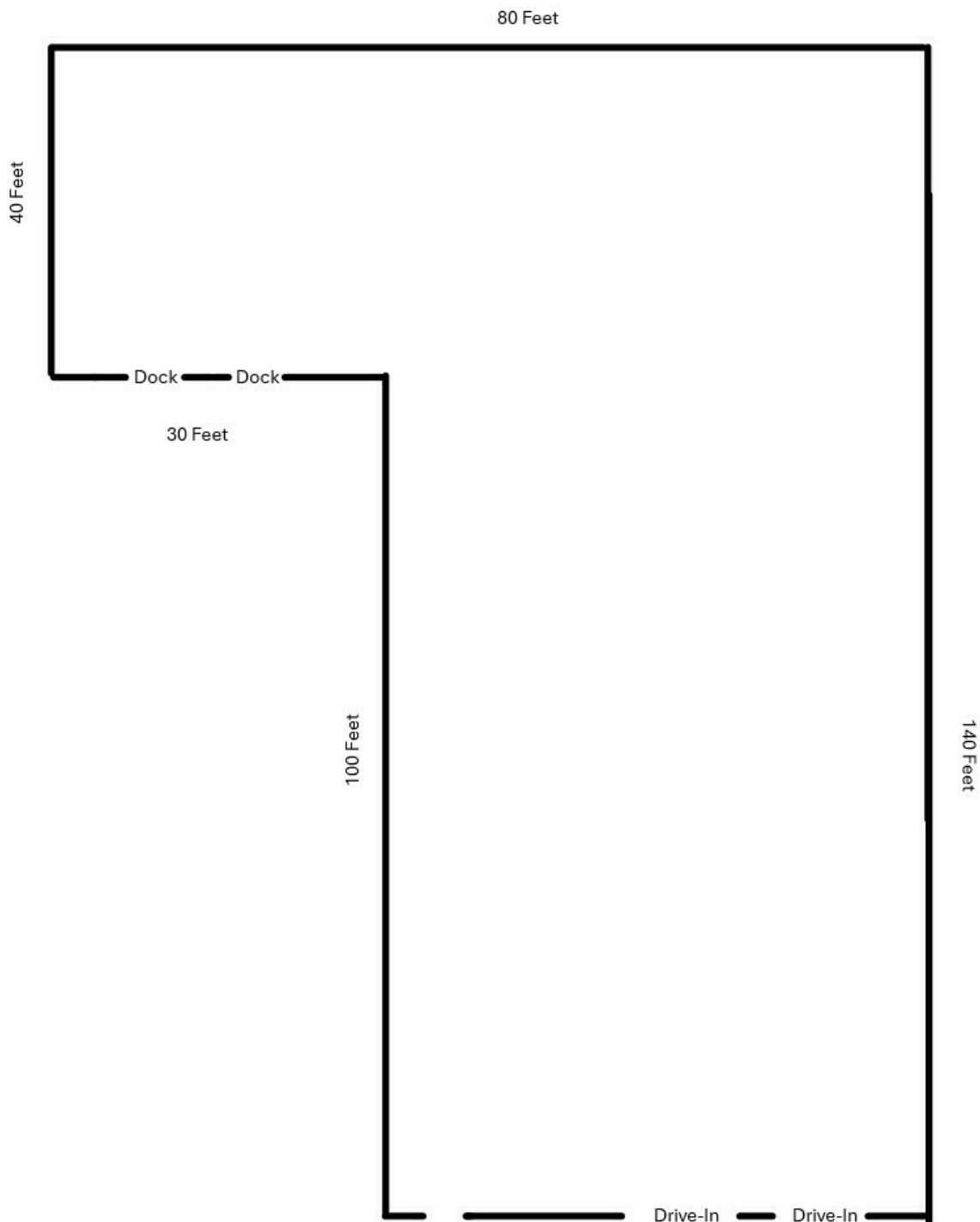

Connor Krouse
ckrouse@lee-associates.com
D 216.282.0125

All information furnished regarding property for sale, rental or financing is from sources deemed reliable, but no warranty or representation is made to the accuracy thereof and same is submitted to errors, omissions, change of price, rental or other conditions prior to sale, lease or financing or withdrawal without notice.
No liability of any kind is to be imposed on the broker herein.

Bedford, OH 44146

COMMERCIAL REAL ESTATE SERVICES
LEE CLEVELAND



D 216.282.0125

No liability of any kind is to be imposed on the broker herein.