

FOR SALE: 2,165-8,765 SF | CALL FOR PRICING



COMPASS
COMMERCIAL

**REAL
ESTATE
SERVICES**

LIGHT INDUSTRIAL CONDOS IN PRIME BEND LOCATION

Versatile Industrial Condos with High Visibility & Modern Design



FALCON INDUSTRIAL CONDOS | 20489 NE FUNNER PL | BEND, OR 97701



FALCON INDUSTRIAL CONDOS



IL ZONING

Versatile spaces ideal for hobby shops, showrooms, and service businesses



FLEXIBLE CONFIGURATIONS

Suites available separately or combined for larger users



GREAT EXPOSURE

Excellent visibility from Boyd Acres Rd.



MODERN DESIGN

Newly built industrial condos with a roll up door, high ceilings and quality finishes



CONVENIENT ACCESS

Quick connections to Empire Ave. and Hwy 97



PROMINENT SIGNAGE

Monument and building signage available



FINAL DELIVERY

Each unit is delivered with 400 amps of power and ADA restroom



ADDITIONAL STORAGE

High-end storage units also available for sale in adjacent Building C



**SPACE AVAILABLE:
2,165-8,765 SF
CALL FOR PRICING**

FALCON INDUSTRIAL CONDOS

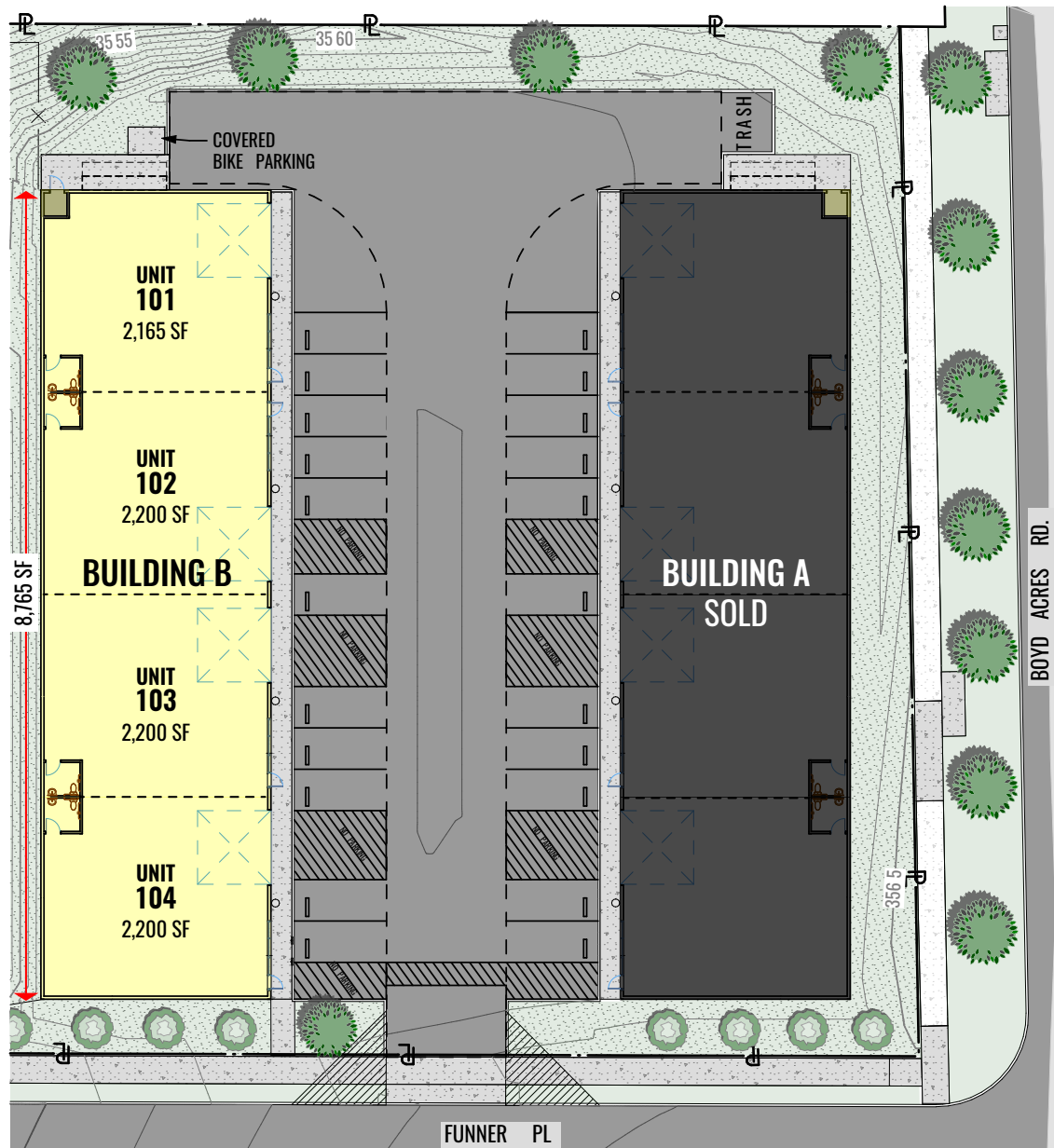

BRAND-NEW LIGHT INDUSTRIAL CONDOS

Falcon Building B offers brand-new light industrial condos for sale in a prime Bend location. Each unit ranges from 2,165 to 2,200 SF and features a roll-up door, providing easy access for a variety of industrial and business uses. Designed for flexibility, suites can be combined to accommodate larger space needs, with a maximum contiguous space of 8,765 SF.

All units will be delivered with 400 amps of power and a fully built-out ADA-compliant restroom, making them move-in ready and functional for a wide range of users.

Positioned just off Boyd Acres Road, these modern condos provide excellent visibility and offer prominent monument and building signage to enhance business exposure. With quick access to Empire Avenue and Highway 97, this location ensures seamless connectivity to Bend's business community and major transportation routes.

These industrial condos present a rare opportunity for business owners to secure high-quality, long-term space in Bend's industrial market.

PROPERTY	Address	20489 NE Funner Pl, Bend, OR 97701	
	Parking	22 surface spaces, plus street parking	
	Zoning	Light Industrial (IL)	
	Date Available	March 2026	
BUILDING B	Unit 101	2,165 SF	Call for Pricing
	Unit 102	2,200 SF	Call for Pricing
	Unit 103	2,200 SF	Call for Pricing
	Unit 104	2,200 SF	Call for Pricing
	Total Available	8,765 SF	Call for Pricing

LOCATION





EXCLUSIVELY LISTED BY:

FALCON INDUSTRIAL CONDOS | 20489 NE FUNNER PL, BEND, OR 97701

DAN KEMP, CCIM

Partner, Principal Broker

Cell 541.550.8413

dkemp@compasscommercial.com

RUSSELL HUNTAMER, CCIM

Partner, Principal Broker

Cell 541.419.2634

rh@compasscommercial.com

ELI HARRISON

Broker

Cell 541.977.2890

eharrison@compasscommercial.com

EMILIO TISCARENO

Broker

Cell 541.213.9640

etiscareno@compasscommercial.com

COMPASS
COMMERCIAL

**REAL
ESTATE
SERVICES**

Brokers are licensed in the state of Oregon. This information has been furnished from sources we deem reliable, but for which we assume no liability. This is an exclusive listing. The information contained herein is given in confidence with the understanding that all negotiations pertaining to this property be handled through Compass Commercial Real Estate Services. All measurements are approximate.