

2027 E. Cedar Street

Tempe, AZ 85281

Rental Rate: \$1.15/SF NNN



Space Features

- + ±7,390 SF available (divisible)
 - Suite 101: ±3,500 SF office/warehouse
 - Suite 104: ±3,890 SF office/warehouse
- + Grade level loading and truck well
- + ±16' clear height in warehouse (evaporative cooled)
- + Fire sprinklered
- + Heavy power
- + Built in 1998
- + Zoned: GID (General Industrial), City of Tempe

Floor Plan

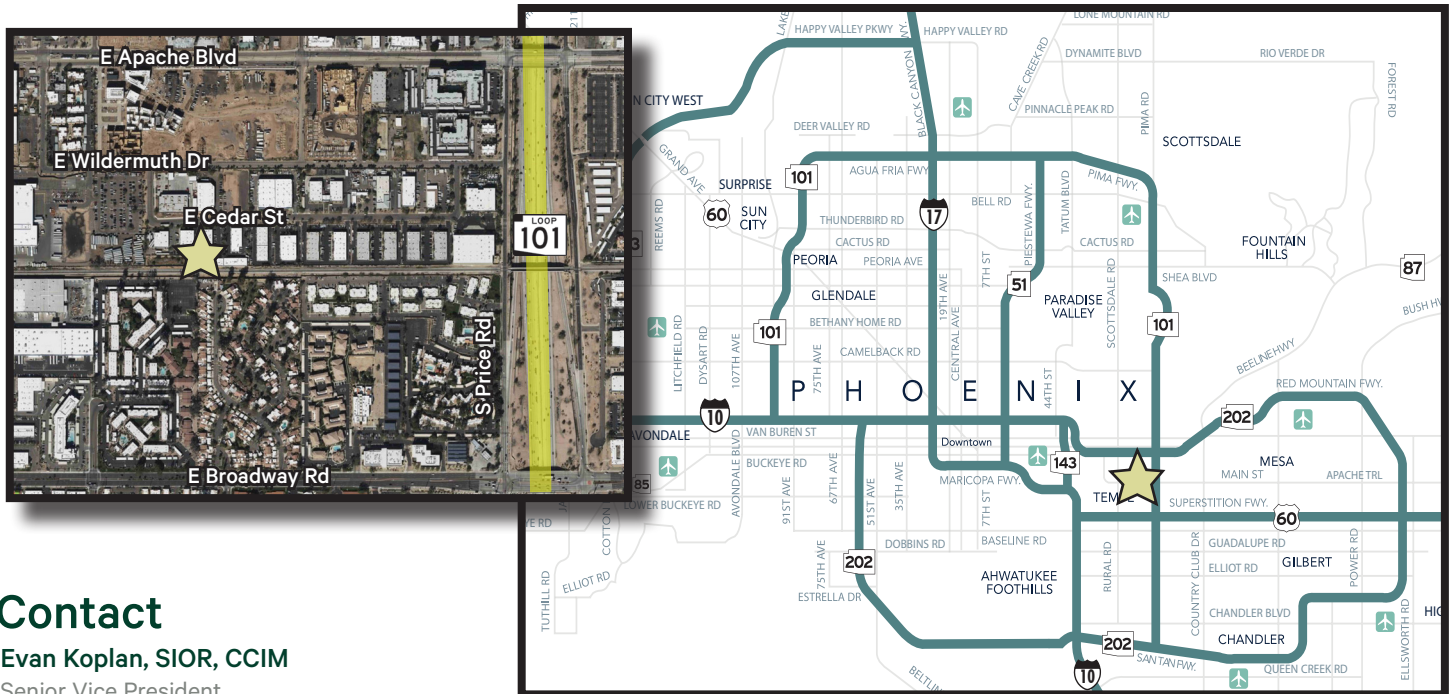
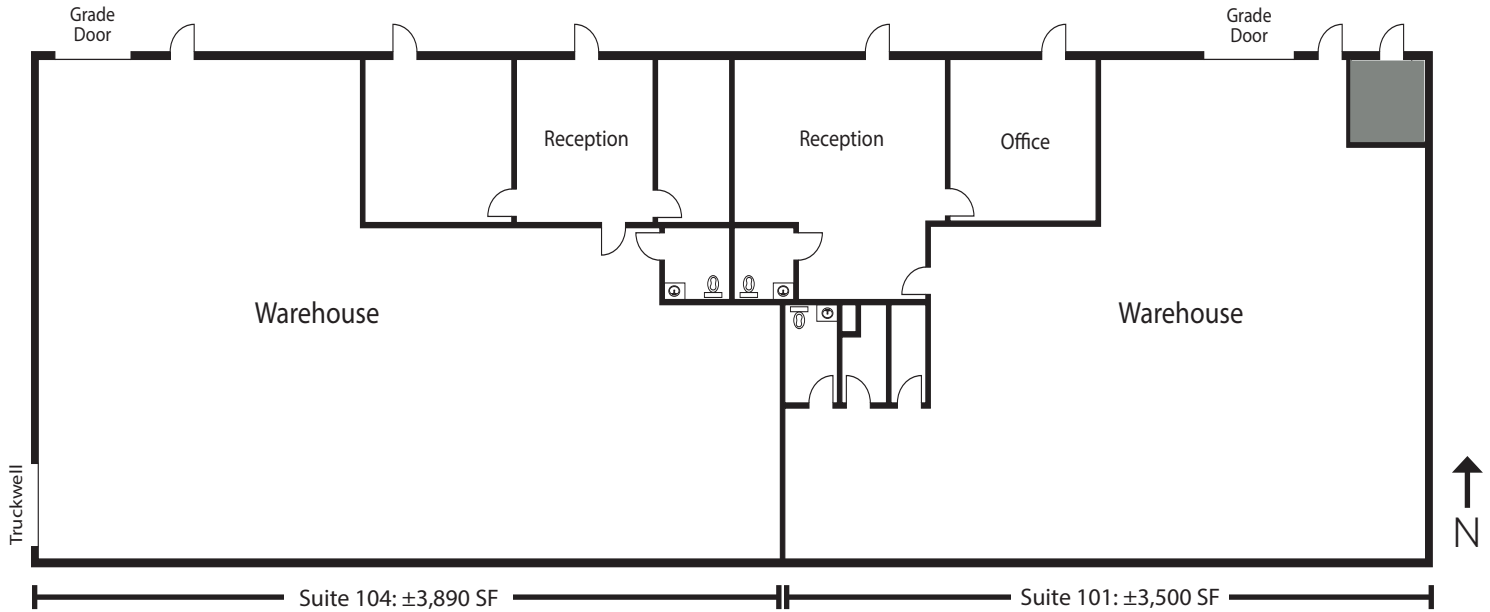

Contact

Evan Koplan, SIOR, CCIM
Senior Vice President
+1 602 735 5232
evan.koplan@cbre.com

© 2024 CBRE, Inc. All rights reserved. This information has been obtained from sources believed reliable, but has not been verified for accuracy or completeness. You should conduct a careful, independent investigation of the property and verify all information. Any reliance on this information is solely at your own risk. CBRE and the CBRE logo are service marks of CBRE, Inc. All other marks displayed on this document are the property of their respective owners, and the use of such logos does not imply any affiliation with or endorsement of CBRE. Photos herein are the property of their respective owners. Use of these images without the express written consent of the owner is prohibited.