



**1630 Cleveland Ave SW**  
Canton, Ohio 44706

---

PARCELS 0246134

---

ACRES 2 ±

---

ZONING CC - I1

---

- Rent to be established when building is approved
- Utilities Available
- Located close to I-77

**Dan Spring, SIOR**

P 330 497 6249  
dan@naispring.com

**Kelly Sober, CCIM**

P 330 497 9837  
kelly@naispring.com



For Sale/Build to Suit  
**Vacant Land**

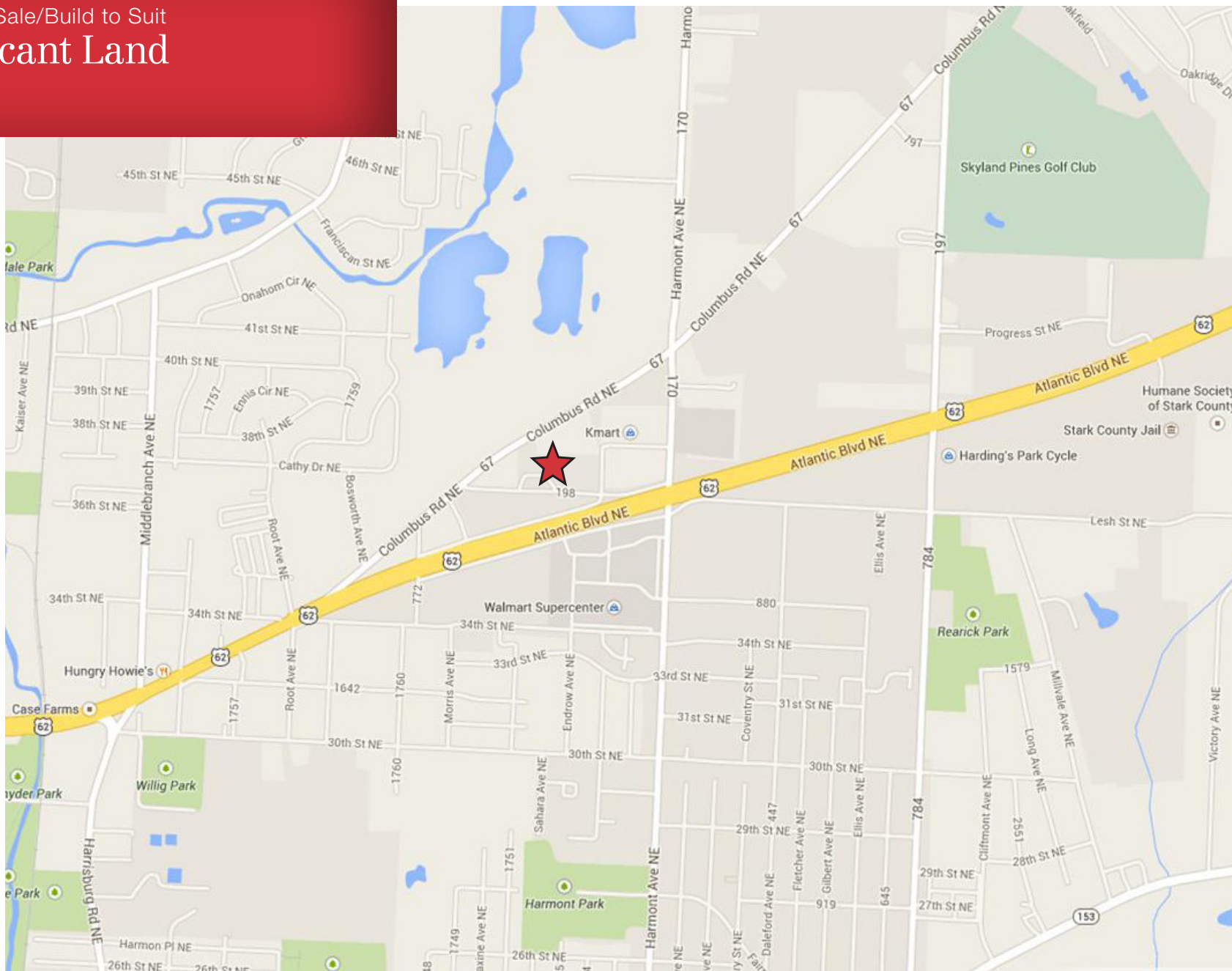

NO WARRANTY OR REPRESENTATION, EXPRESS OR IMPLIED, IS MADE AS TO THE ACCURACY OF THE INFORMATION CONTAINED HEREIN, AND THE SAME IS SUBMITTED SUBJECT TO ERRORS, OMISSIONS, CHANGE OF PRICE, RENTAL OR OTHER CONDITIONS, PRIOR SALE, LEASE OR FINANCING, OR WITHDRAWAL WITHOUT NOTICE, AND OF ANY SPECIAL LISTING CONDITIONS IMPOSED BY OUR PRINCIPALS NO WARRANTIES OR REPRESENTATIONS ARE MADE AS TO THE CONDITION OF THE PROPERTY OR ANY HAZARDS CONTAINED THEREIN ARE ANY TO BE IMPLIED.

8234 Pittsburg Ave NW  
North Canton, OH 44720  
+1 330 966 8800  
naispring.com