

160 E TASMAN DRIVE

SAN JOSE, CA

FOR LEASE

TRANSWESTERN
REAL ESTATE
SERVICES



CONTACT

Andrew Wheeler

CA DRE # 02048909
415.489.1831
andrew.wheeler@transwestern.com

Mairaj Din

CA DRE # 02197939
415.489.1769
mairaj.din@transwestern.com

Q Bay Center

FOR LEASE: ±194 – ±13,094 SF
Class A Office / R&D

Copyright © 2023 Transwestern. All data is derived from sources deemed to be reliable but is not guaranteed.



160 E TASMAN DRIVE
SAN JOSE, CA



Q Bay Center is a Silicon-Valley-based platform to connect and support innovation and entrepreneurship. With a tripartite mission of “Platform + Investment + Services,” Q Bay Center is designed as an innovative business model which combines real property, business exhibition, financial activity, technology cooperation, business services and startups incubation. By leveraging the synergy of technology, finance, industrial ecology and culture, the center is committed to enhancing connection and empowering development.



Space Details

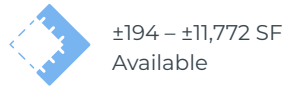

±194 – ±11,772 SF Available



Shared & Private Wet Lab Space



Fully Remodeled in 2018-2019



Low Operating Expenses



CDA/DI/N2 Distributed to Benches



Fume hoods



Shared Glass Wash & Equipment Room



500 KW backup Generator

Building Amenities



New Break Room / Amenity Space



Outdoor Courtyard / BBQ



On-Site Full-Service Gym



Locker Room & Showers



Beautiful 2-story lobby



Fully Equipped 2,500 SF Event Room (100-150 Person Capacity)



Common Area Conference Rooms with A/V Equipment



Dock Loading



Backup Power

Location & Transportation



Baypointe VTA Station



Walk to Local Restaurants



3.3/1,000 Parking



Highway 237 & 880 Access



4 Tesla & 4 Universal Chargers

160 E TASMAN DRIVE

SAN JOSE, CA

FOR LEASE

TRANSWESTERN
REAL ESTATE
SERVICES





160 E TASMAN DRIVE

SAN JOSE, CA



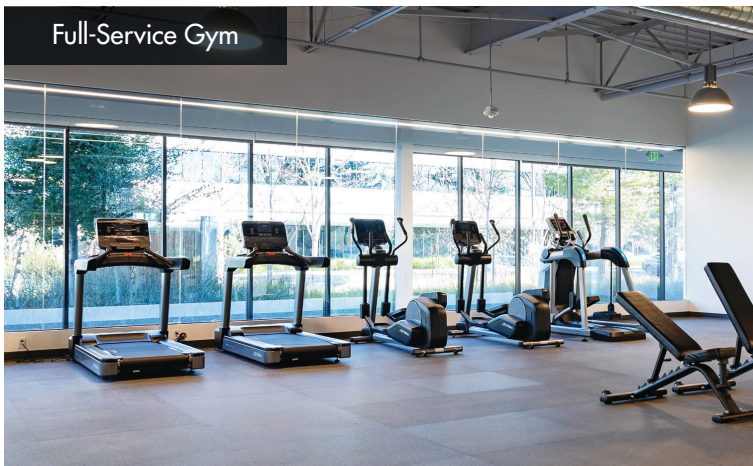

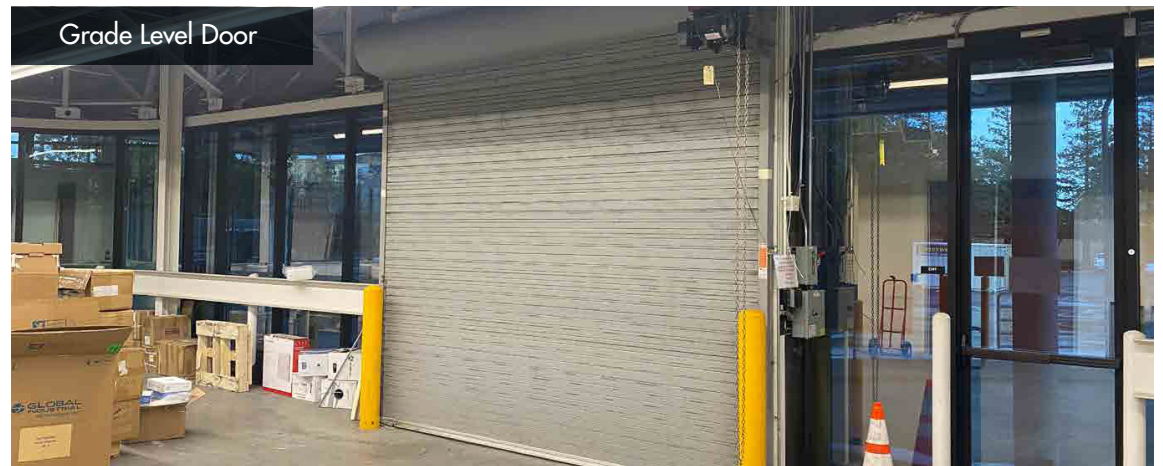

1st Floor

- Available Wet Lab Spaces
- Available Flex Spaces
- Common Areas
- Available Suite:
Suite 105: ±1,998 SF

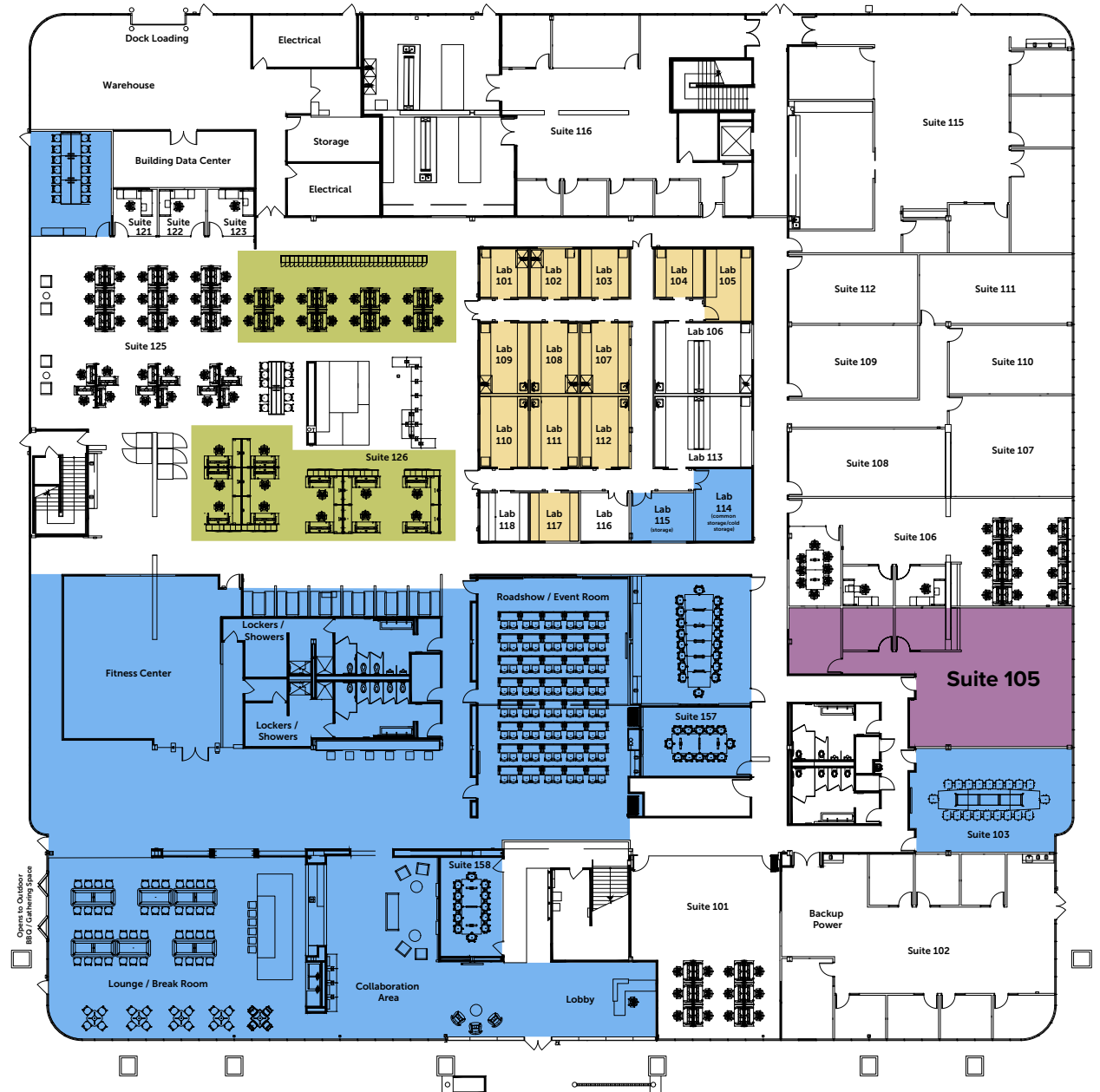

1st Floor: Wet Labs

Available Wet Lab Spaces

- CDA/DI/N2 Distributed to Benches
- 6 Fume Hoods
- Shared Glass Wash & Equipment Room
- 500 KW Backup Generator
- 4,000 Amp Transformer
- Sinks

Available Flex Spaces

Common Areas

360° Matterport virtual tour

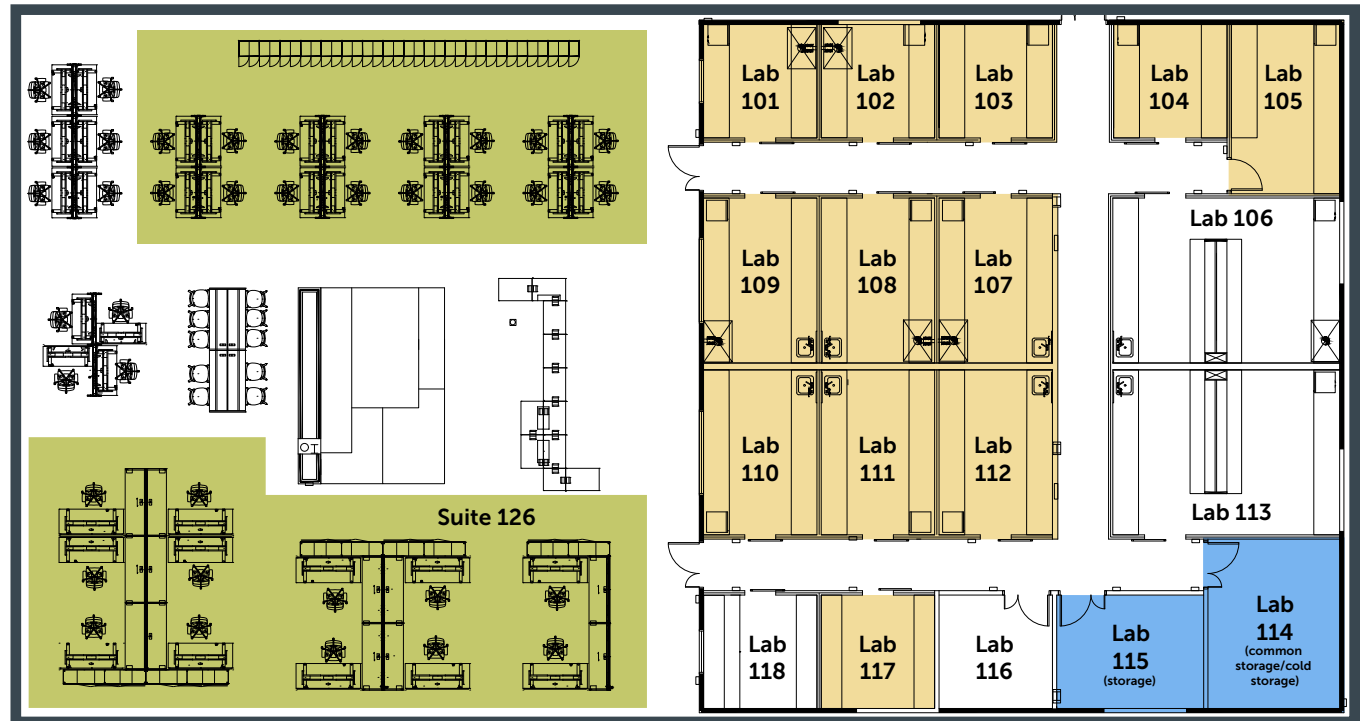
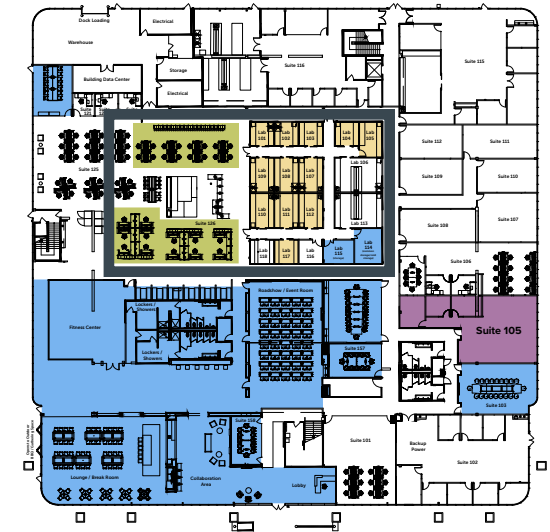

2nd Floor: Available Suites

- Suite 200:** ±13,094 SF
- Suite 202:** ±6,228 SF
- Suite 210:** ±11,772 SF
- Suite 212:** ±1,661 SF
- Suite 215:** ±12,091 SF

