

688 E Gish Rd

Suite 10, 30 & 70, San Jose, CA 95112



±3,500 - ±7,000 Square Feet of Office & Warehouse Space



Property Highlights

- + ±3,500 square feet of Office and Warehouse
- + 1 Grade Level Door
- + Fenced Rear Access
- + HVAC in the Office Core
- + 3 Phase, 240 Volt Power (tenant to verify)
- + 15' to 16' Clear Height
- + In suite restroom
- + Glass office storefront
- + Gated rear parking area
- + Multiple offices
- + Warehouse
- + Nice landscaping and monument signage

Floor Plan - Unit 10

- + 2 Bathrooms
- + 2 Workshop Rooms
- + 3 Offices
- + Power Outlets throughout the Workshop Rooms
- + Potential to combine with Unit 30 for ±7,000 SF

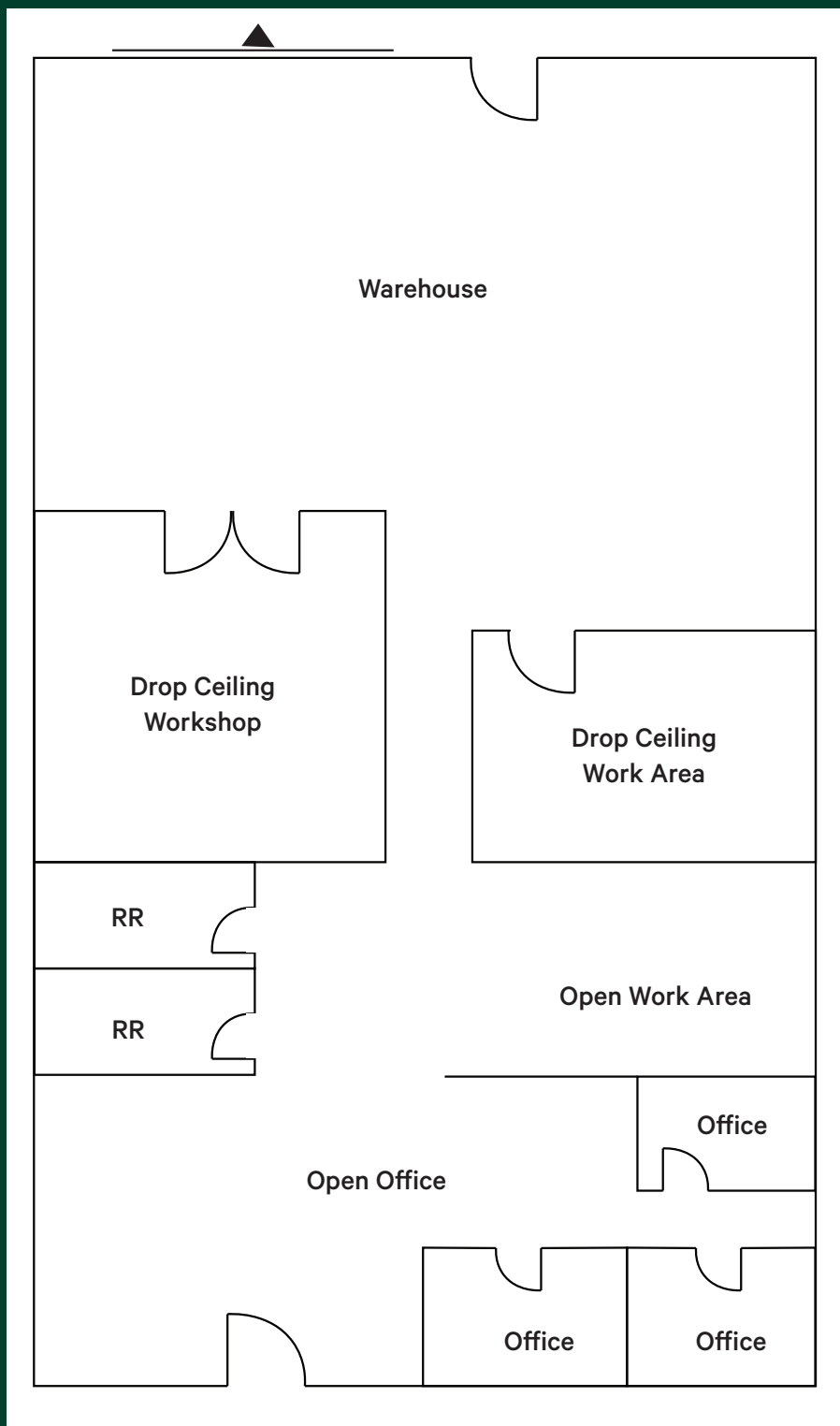

Floor Plan - Unit 30

- + Open Warehouse
- + 2 Office Rooms
- + 1 Roll Up Door
- + Potential to combine with Unit 10
for ±7,000 SF

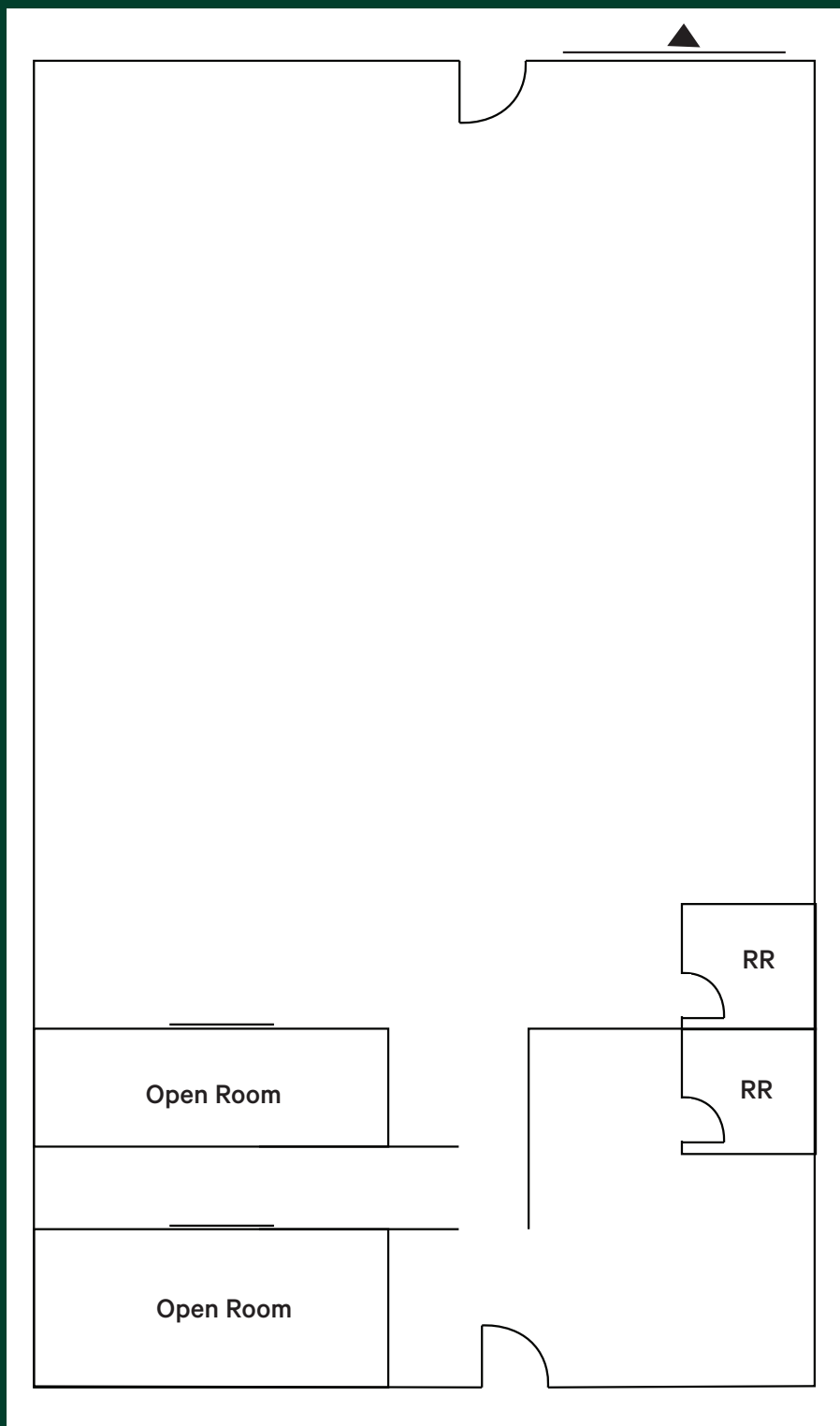

Floor Plan - Unit 70

- + 2 Restrooms
- + 4 Offices
- + 1 Roll Up Door

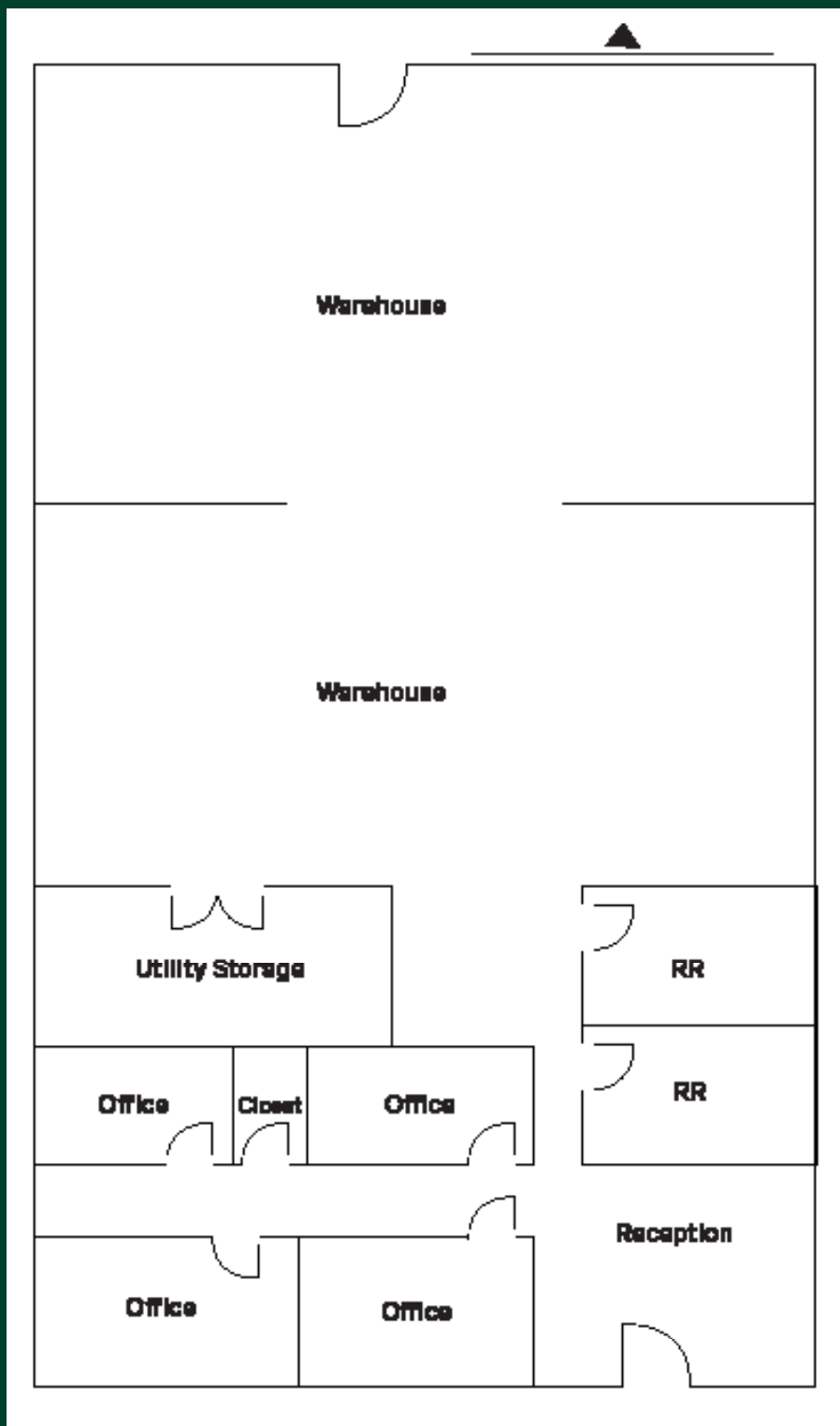

688 E Gish Rd
San Jose, CA 95112

For Lease

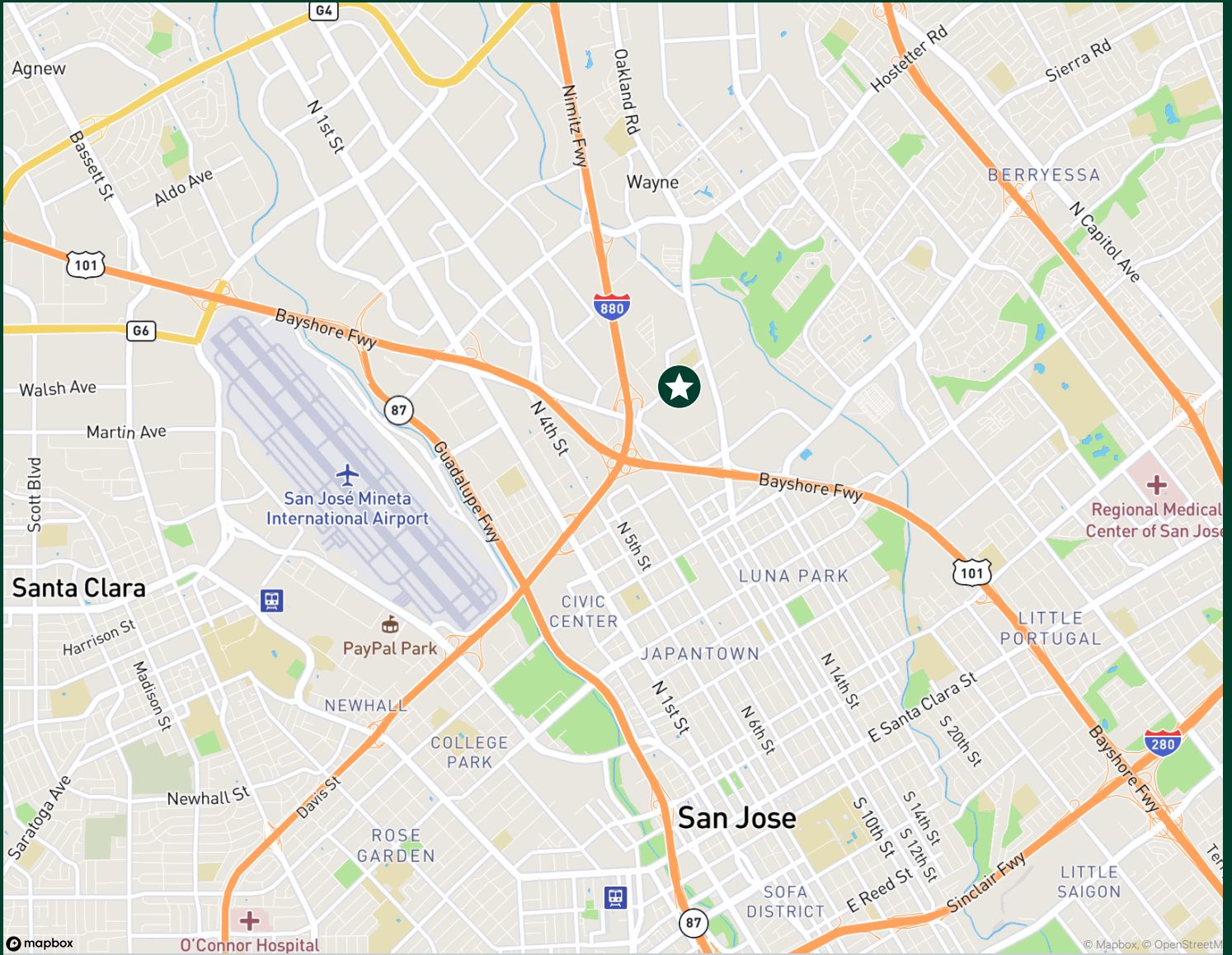

Contact Us

Terence Fox

Vice President

+1 408 453 7477 | C +1 408 591 2901

Terence.Fox@cbre.com

Lic. 02068798

© 2026 CBRE, Inc. All rights reserved. This information has been obtained from sources believed reliable, but has not been verified for accuracy or completeness. You should conduct a careful, independent investigation of the property and verify all information. Any reliance on this information is solely at your own risk. CBRE and the CBRE logo are service marks of CBRE, Inc. All other marks displayed on this document are the property of their respective owners, and the use of such logos does not imply any affiliation with or endorsement of CBRE. Photos herein are the property of their respective owners. Use of these images without the express written consent of the owner is prohibited.

www.cbre.com

CBRE